

**CROSSWALK DETAIL**

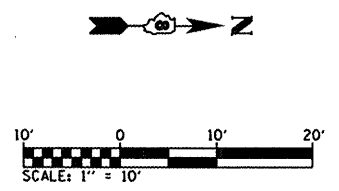
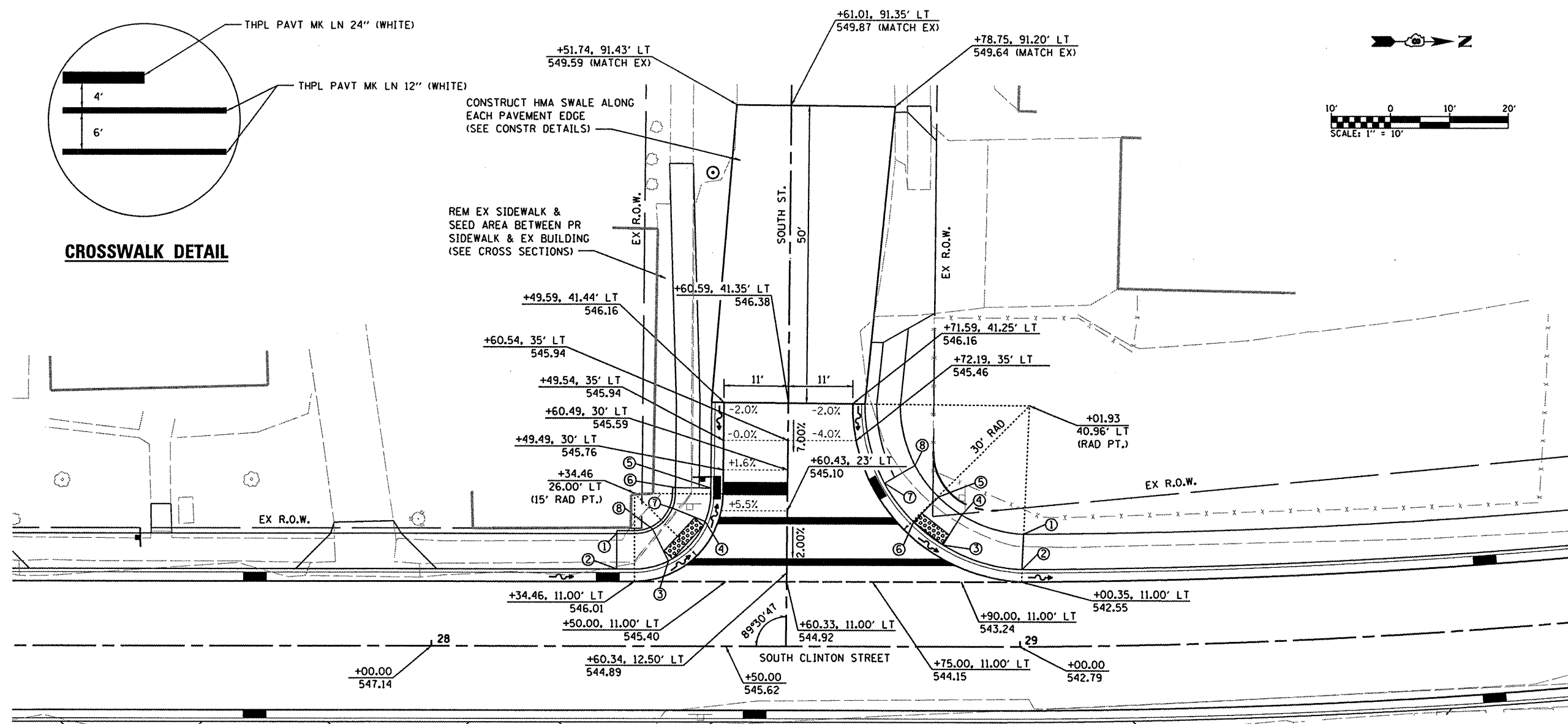

**SOUTH RADIUS RETURN**

PT. NO.	STATION	OFFSET	ELEVATION	
1	28+31.46	19.08'	546.61	(SW/TC)
2	28+31.46	13.08'	546.61 546.11	(SW/TC) (EOP)
3	28+41.18	12.59'	545.98 545.98	(SW/TC) (EOP)
4	28+48.37	20.39'	545.88 545.88	(SW/TC) (EOP)
5	28+47.38	26.89'	546.14 545.64	(SW/TC) (EOP)
6	28+41.38	26.94'	546.26	(SW/TC)
7	28+40.87	23.41'	546.00 546.50	(SW) (TC)
8	28+40.93	16.08'	546.10 546.60	(SW) (TC)

**NORTH RADIUS RETURN**

PT. NO.	STATION	OFFSET	ELEVATION	
1	29+00.73	19.08'	543.17	(SW)
2	29+00.40	13.08'	543.05	(SW/TC)
3	28+86.92	17.25'	543.75 543.75	(SW/TC) (EOP)
4	28+90.07	22.36'	543.87	(SW)
5	28+86.15	25.44'	543.97	(SW)
6	28+81.92	21.18'	543.85 543.85	(SW/TC) (EOP)
7	28+77.00	27.78'	544.53 544.03	(SW/TC) (EOP)
8	28+82.19	30.81'	544.53	(SW)

**INTERSECTION LAYOUT  
SOUTH CLINTON STREET AND SOUTH STREET**

FILE NAME =	USER NAME = randy	DESIGNED -	REVISED -
H:\P\28010\Microstation\CADD\Sheets\082810-shz-intersec.dgn		DRAWN -	REVISED -
PLOT SCALE = 20.0000' / 1"		CHECKED -	REVISED -
PLOT DATE = 4/9/2012		DATE -	REVISED -

**STATE OF ILLINOIS  
DEPARTMENT OF TRANSPORTATION**

**INTERSECTION DETAILS**

SCALE: 1"=10'      SHEET NO. 1 OF 1 SHEETS      STA.      TO STA.

F.A.U. RTE.	SECTION	COUNTY	TOTAL SHEETS	SHEET NO.
9025	09-00091-00-PV	MADISON	35	18
S CLINTON ST RECONSTR - PH 1      CONTRACT NO. 97483				
ILLINOIS FED. AID PROJECT				