

DATE	
BY	
SURVEYED	
PLOTTED	
NOTE BOOK	
AREAS CHECKED	
NO.	

DATE	
BY	
SURVEYED	
PLOTTED	
NOTE BOOK	
AREAS CHECKED	
NO.	

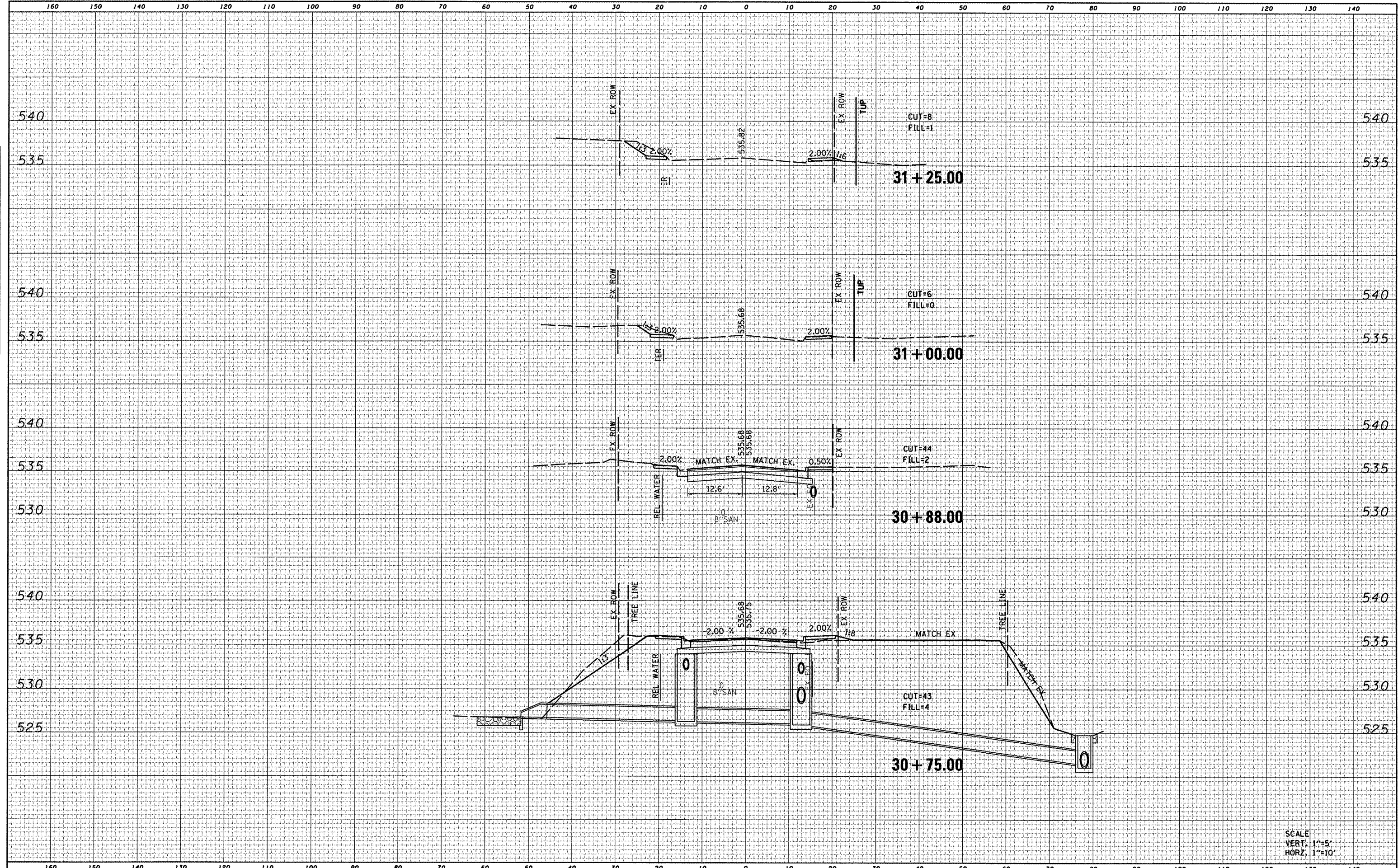

SCALE  
VERT. 1"=5'  
HORZ. 1"=10'

FILE NAME = D028010-sht-xssh1.clin.dgn	USER NAME = randy	DESIGNED -	REVISED -	<b>STATE OF ILLINOIS</b> <b>DEPARTMENT OF TRANSPORTATION</b>	<b>CROSS SECTIONS</b>	F.A.U. RTE. 9025	SECTION 09-00091-00-PV	COUNTY MADISON	TOTAL SHEETS 35	SHEET NO. 34		
	PLOT TIME = 9:55:02 AM	DRAWN -	REVISED -			SCALE:	SHEET NO. 15 OF 16 SHEETS	STA. 30+75.00	TO STA. 31+25.00	ILLINOIS FED. AID PROJECT		
	PLOT SCALE = 20.0000' / IN.	CHECKED -	REVISED -									
	PLOT DATE = 4/9/2012	DATE -	REVISED -									