

MATCHLINE 358+50

MATCHLINE 363+50

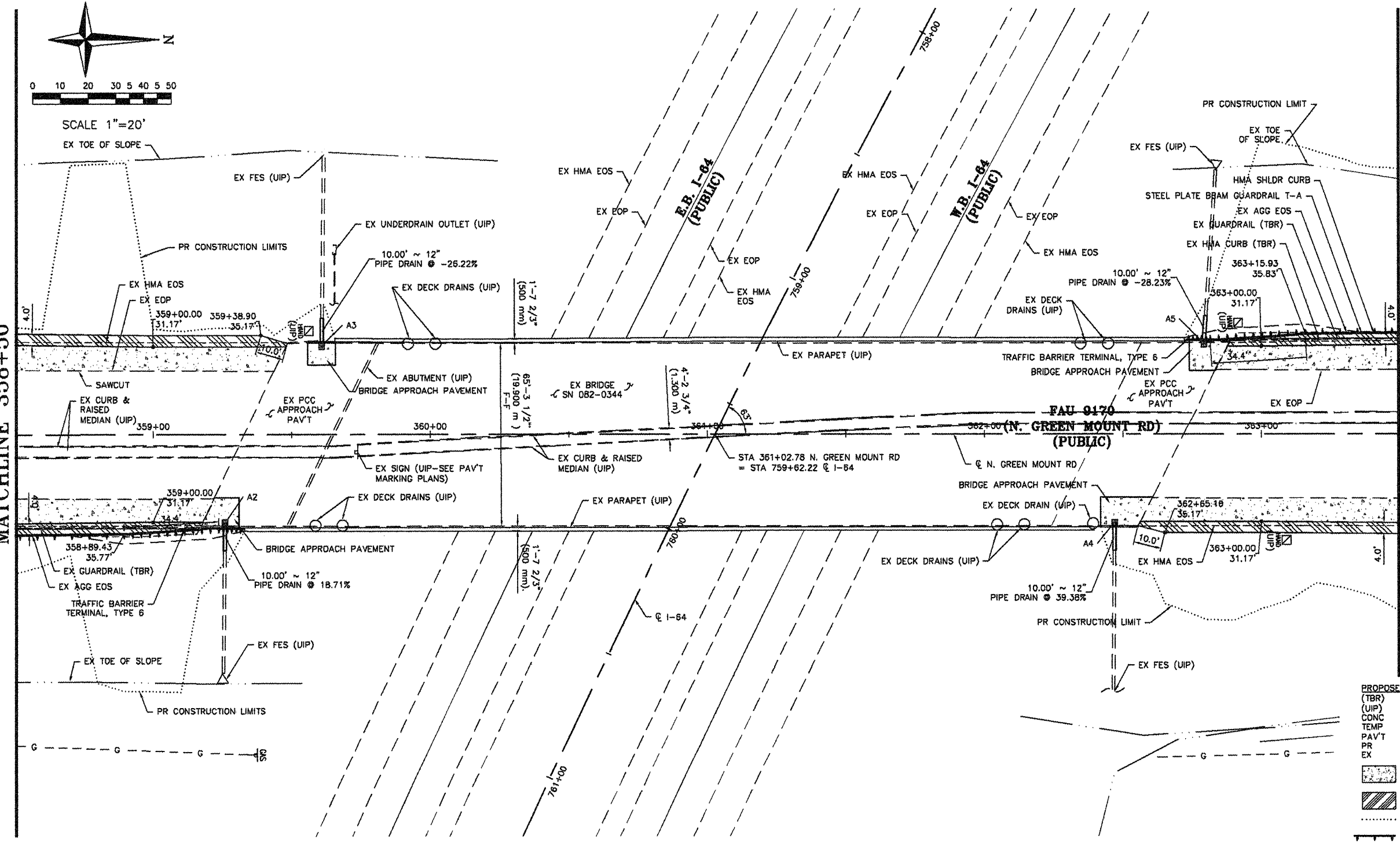

**PROPOSED LEGEND**

(TBR)	- TO BE REMOVED
(UIP)	- USE IN PLACE
CONC	- CONCRETE
TEMP	- TEMPORARY
PAV'T	- PAVEMENT
PR	- PROPOSED
EX	- EXISTING
	- PR PCC
	- PR HMA SHOULDERS
	- PR CONSTRUCTION LIMIT
	- PR GUARDRAIL

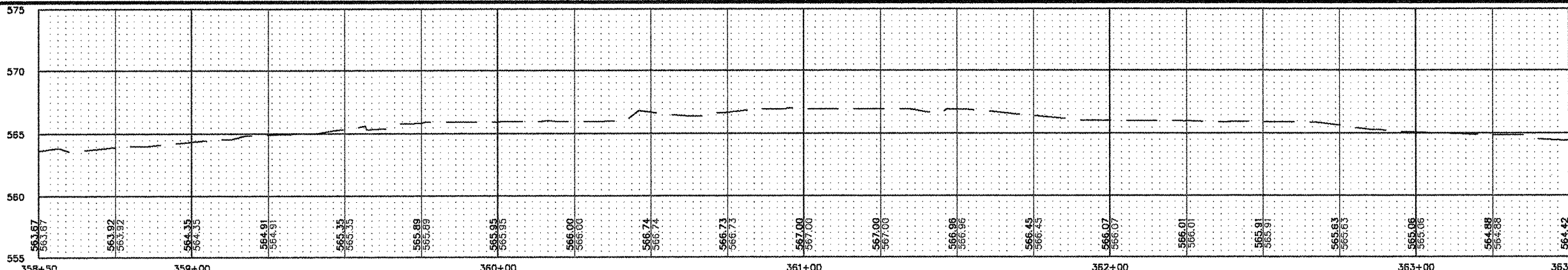

FAU RTE.	SECTION	COUNTY
9170	08-00333-12-PW	ST. CLAIR
ILLINOIS	CONTRACT NO. 97492	

SHEET NO.  
**13 of 55**

Job No. 086-09  
Scale: 1"=20'  
Drawn by: BEC  
Design by: BEC  
Approved by: CMB  
File Name: Shloh Plans

**ISSUE RECORD**

DATE	DESCRIPTION
4/20/12	FS&E

Corporate Engineering Certificate # 000387

CIVIL ENGINEER  
4/20/12

**CBB** Crawford, Bunte, Brammeier  
Traffic and Transportation Engineers

St. Louis, Missouri/Glen Carbon, Illinois  
314-878-6644 618-656-2612  
Fax: 314-878-5876 E-Mail: cbb@cbbtraffic.com

**PLAN/PROFILE SHEETS**

N. GREEN MOUNT ROAD & I-64  
E.B. RAMP, W.B. RAMP &  
REGENCY PARK/PIERCE BLVD  
SHILOH, ILLINOIS