

ROUTE	SECTION	COUNTY	TOTAL SHEETS	SHEET NO.
FAS 1790	12-00131-02 RS	MARION	3	1

FEDERAL-AID PROJECT CONTRACT NO. 97497

STATE OF ILLINOIS
DEPARTMENT OF TRANSPORTATION
DIVISION OF HIGHWAYS

**PROPOSED LOCAL AGENCY
FEDERAL-AID SECONDARY PROJECT**

STR PROGRAM / LAFO CRITERA

ROUTE FAS 1790
SECTION 12-00131-02 RS
PROJECT RS-1790(104)
MARION COUNTY
JOB NO. C-98-334-12
CH 32 WALNUT HILL ROAD
R. I. E.

INDEX OF SHEETS

COVER SHEET	1
SUMMARY OF QUANTITIES/TYPICAL SECTIONS	2
GENERAL NOTES	2
SCHEDULES	3

STANDARDS

000001-06	STANDARD SYMBOLS, ABBREVIATIONS, PATTERNS
442201-03	CLASS C AND CLASS D PATCHES
701201-04	LANE CLOSURE, 2L, 2W, DAY ONLY
701301-04	LANE CLOSURE, 2L, 2W, SHORT TIME OPERATIONS
701306-03	LANE CLOSURE, 2L, 2W, SLOW MOVING OPERATIONS DAY ONLY FOR SPEEDS > 45 MPH
701311-03	LANE CLOSURE, 2L, 2W, SLOW MOVING OPERATIONS DAY ONLY
701901-02	TRAFFIC CONTROL DEVICES
780001-03	TYPICAL PAVEMENT MARKINGS

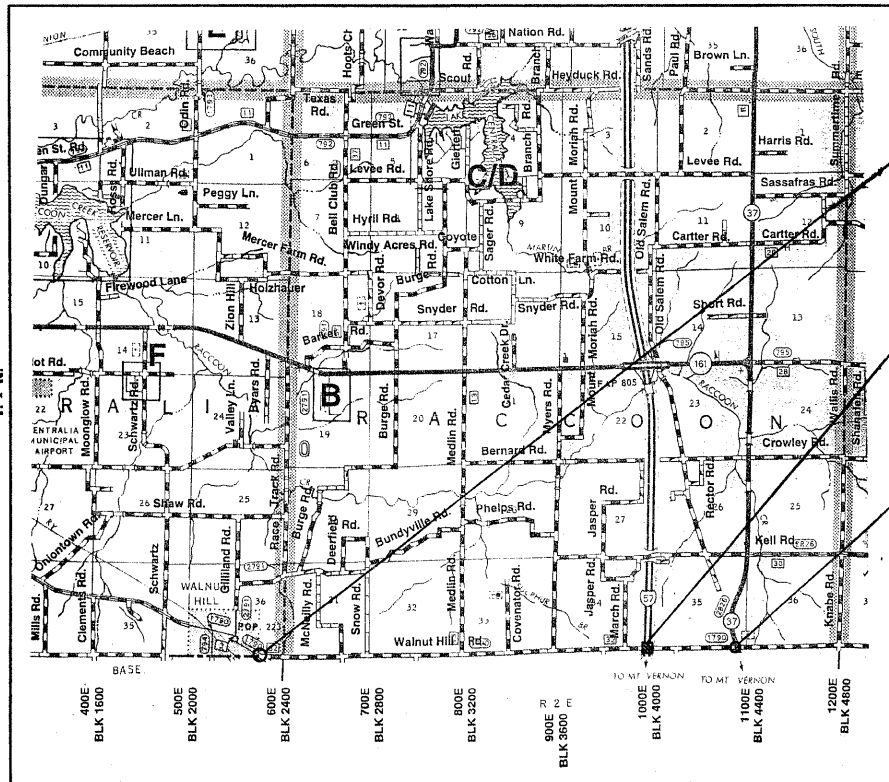
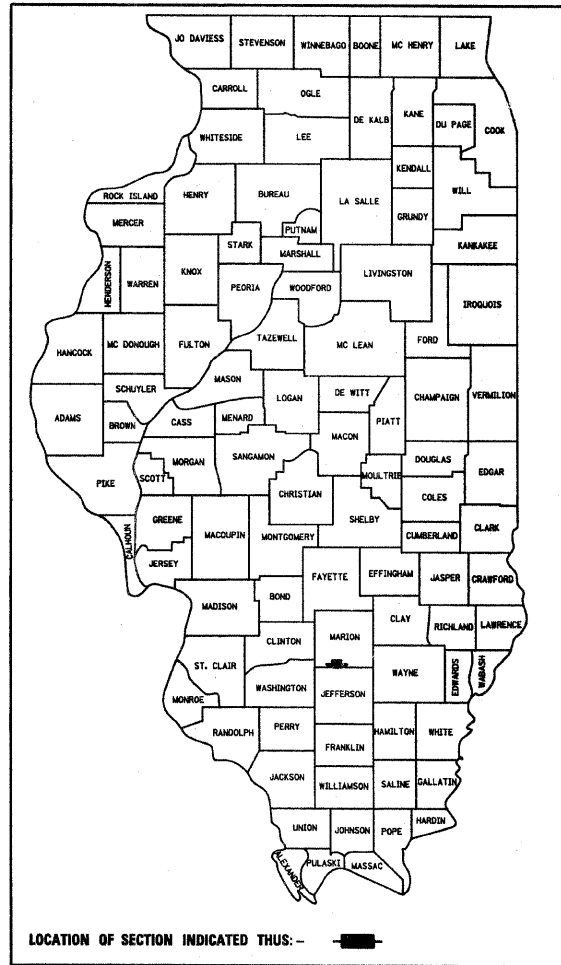

LOCATION MAP
GROSS LENGTH 28,800 FT = 5.45 MILES
NET LENGTH 28,371 FT = 5.41 MILES

FUNCTIONAL CLASSIFICATION: RURAL MAJOR COLLECTOR
ADT 800

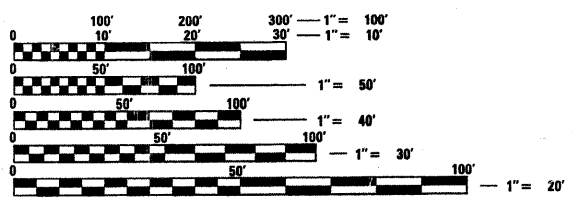

FULL SIZE PLANS HAVE BEEN PREPARED USING STANDARD ENGINEERING SCALES. REDUCED SIZED PLANS WILL NOT CONFORM TO STANDARD SCALES. IN MAKING MEASUREMENTS ON REDUCED PLANS, THE ABOVE SCALES MAY BE USED.

J.U.L.I.E.
JOINT UTILITY LOCATION INFORMATION FOR EXCAVATION
1-800-892-0123

BEGIN STA 0+00
OMISSION STA 240+50 TO 242+80
END STA 288+00

THESE PLANS WERE PREPARED BY ME OR A FULL-TIME MEMBER OF MY STAFF UNDER MY PERSONAL SUPERVISION.

COUNTY ENGINEER, MARION COUNTY
ILLINOIS LICENSED PROFESSIONAL ENGINEER
NO. _____
LICENSE EXPIRES 11/2013

ILLINOIS DEPARTMENT OF TRANSPORTATION	
APPROVED	4-12-12, 2012 JEFFERSON COUNTY ENGINEER
APPROVED	4-12-12, 2012 MARION COUNTY ENGINEER
PASSED	4-17-12, 2012 DISTRICT B ENGINEER OF LOCAL ROADS & STREETS
RELEASED FOR BID BASED ON LIMITED REVIEW	4-17-12, 2012 DEPUTY DIRECTOR OF HIGHWAYS, REGION FIVE ENGINEER

PRINTED BY AUTHORITY OF THE STATE OF ILLINOIS