

STATE OF ILLINOIS
DEPARTMENT OF TRANSPORTATION
DIVISION OF HIGHWAYS

**PROPOSED LOCAL AGENCY
FEDERAL-AID SECONDARY PROJECT**

STR PROGRAM / LAFO CRITERA

ROUTE FAS 1790
SECTION 12-00131-02 RS
PROJECT RS-1790(104)
MARION COUNTY
JOB NO. C-98-334-12
CH 32 WALNUT HILL ROAD
R. I. E.

ROUTE	SECTION	COUNTY	TOTAL SHEETS	SHEET NO.
FAS 1790	12-00131-02 RS	MARION	3	1

FEDERAL-AID PROJECT CONTRACT NO. 97497

INDEX OF SHEETS

COVER SHEET	1
SUMMARY OF QUANTITIES/TYPICAL SECTIONS	2
GENERAL NOTES	2
SCHEDULES	3

STANDARDS

000001-06	STANDARD SYMBOLS, ABBREVIATIONS, PATTERNS
442201-03	CLASS C AND CLASS D PATCHES
701201-04	LANE CLOSURE, 2L, 2W, DAY ONLY
701301-04	LANE CLOSURE, 2L, 2W, SHORT TIME OPERATIONS
701306-03	LANE CLOSURE, 2L, 2W, SLOW MOVING OPERATIONS DAY ONLY FOR SPEEDS > 45 MPH
701311-03	LANE CLOSURE, 2L, 2W, SLOW MOVING OPERATIONS DAY ONLY
701901-02	TRAFFIC CONTROL DEVICES
780001-03	TYPICAL PAVEMENT MARKINGS

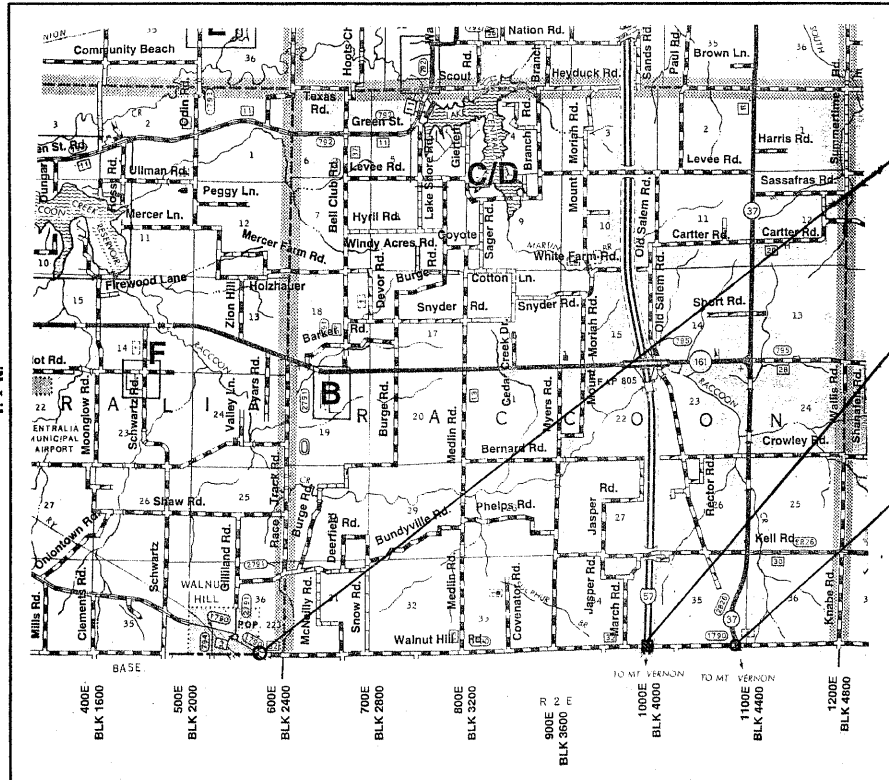
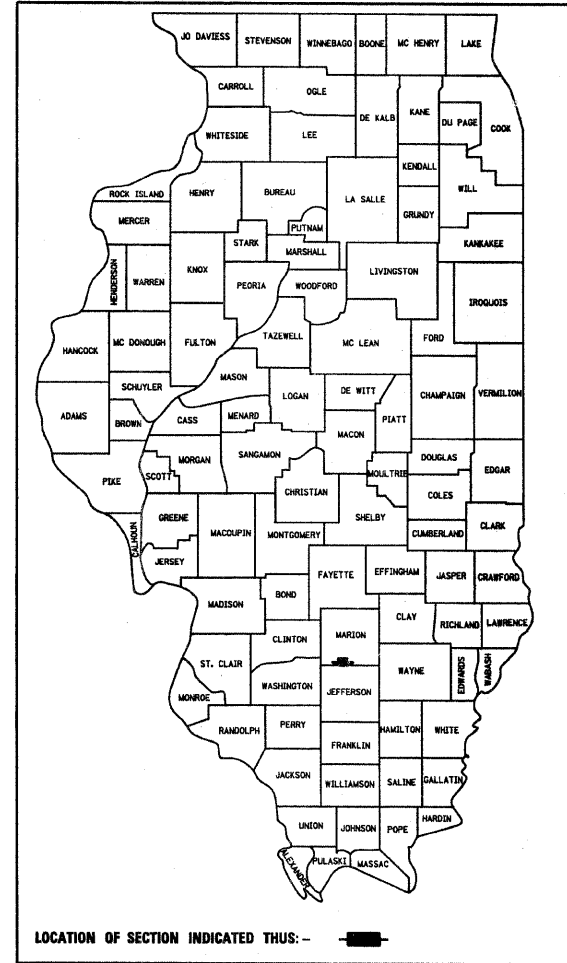

BEGIN STA 0+00

OMISSION STA 240+50 TO 242+80

END STA 288+00

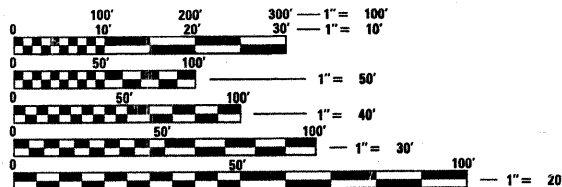

FULL SIZE PLANS HAVE BEEN PREPARED USING STANDARD ENGINEERING SCALES. REDUCED SIZED PLANS WILL NOT CONFORM TO STANDARD SCALES. IN MAKING MEASUREMENTS ON REDUCED PLANS, THE ABOVE SCALES MAY BE USED.

J.U.L.I.E.
JOINT UTILITY LOCATION INFORMATION FOR EXCAVATION
1-800-892-0123

LOCATION MAP
GROSS LENGTH 28,800 FT = 5.45 MILES
NET LENGTH 28,571 FT = 5.41 MILES

FUNCTIONAL CLASSIFICATION: RURAL MAJOR COLLECTOR
ADT 800

THESE PLANS WERE PREPARED BY ME OR A FULL-TIME MEMBER OF MY STAFF UNDER MY PERSONAL SUPERVISION.

[Signature]
COUNTY ENGINEER, MARION COUNTY
ILLINOIS LICENSED PROFESSIONAL ENGINEER
NO. _____
LICENSE EXPIRES 11/2013

ILLINOIS DEPARTMENT OF TRANSPORTATION	
APPROVED	4-12-12 2012 <i>[Signature]</i> JEFFERSON COUNTY ENGINEER
APPROVED	4-12-12 2012 <i>[Signature]</i> MARION COUNTY ENGINEER
PASSED	4-17-12 2012 <i>[Signature]</i> DISTRICT 8 ENGINEER OF LOCAL ROADS & STREETS
RELEASED FOR BID BASED ON LIMITED REVIEW	4-17-12 2012 <i>[Signature]</i> DEPUTY DIRECTOR OF HIGHWAYS, REGION FIVE ENGINEER

PRINTED BY AUTHORITY OF THE STATE OF ILLINOIS

FAS 1790 CH 32 (WALNUT HILL ROAD)
SECTION 12-00131-02-RS

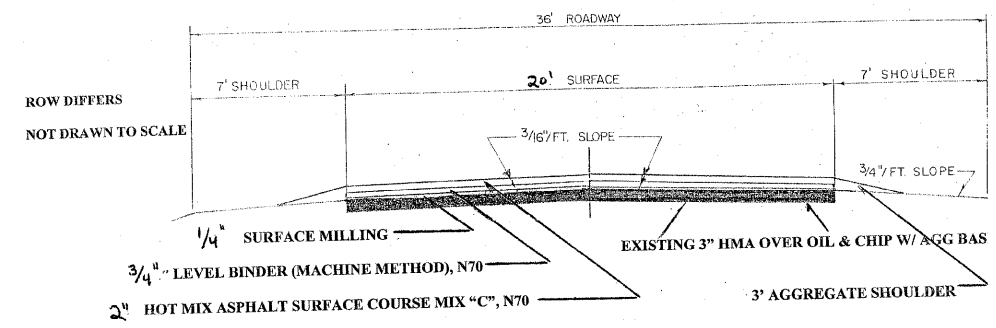

C.H. 32 TYPICAL SECTION
STA. 0+00 TO STA. 288+00

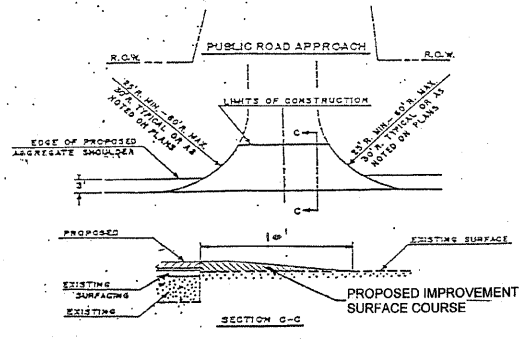
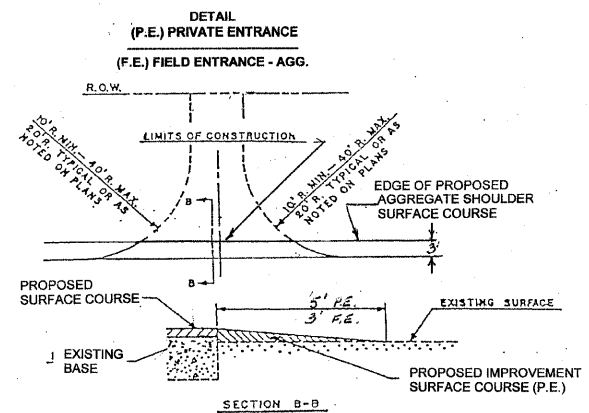

GENERAL NOTES

THIS SECTION SHALL BE CONSTRUCTED IN ACCORDANCE WITH THE PLANS, THE "STANDARD SPECIFICATIONS FOR ROAD AND BRIDGE CONSTRUCTION", ADOPTED JANUARY 1, 2012, THE "SUPPLEMENTAL SPECIFICATIONS AND RECURRING SPECIAL PROVISIONS", ADOPTED JANUARY 1, 2012, AND THE SPECIAL PROVISIONS INCLUDED IN THE PROPOSAL.

THE PROPOSED PROJECT ON F.A.S. 1790, COUNTY HIGHWAY 32, BEGINS AT THE INTERSECTION OF HARRISON STREET ON THE EAST SIDE OF WALNUT HILL VILLAGE LIMITS AT STATION 0+00 AND EXTENDS IN AN EASTERLY DIRECTION FOR A DISTANCE OF 4.55 MILES TO A POINT JUST WEST OF THE OVERHEAD OVER INTERSTATE 57, AT STATION 240+50, THEN CONTINUE AGAIN JUST EAST OF THE OVERHEAD, AT STATION 242+80, IN AN EASTERLY DIRECTION TO A POINT ADJOINING THE WEST EDGE OF IL ROUTE 37 AT STATION 288+00, A TOTAL PROJECT LENGTH OF 5.41 MILES

THE WORK INCLUDED IN THIS PROJECT CONSISTS OF 1/4" BITUMINOUS SURFACE REMOVAL, 3/4" LEVEL BINDER (MACHINE METHOD), 2" HOT-MIX ASPHALT SURFACE COURSE, AGGREGATE SHOULDERS AND ANY OTHER WORK NECESSARY TO COMPLETE THE PROJECT.

THE EXISTING GRADE, ALIGNMENT, DRAINAGE STRUCTURES, BASE AND SURFACE WERE CONSTRUCTED UNDER THE ILLINOIS DEPARTMENT OF TRANSPORTATION'S DESIGN REQUIREMENTS FOR LOCAL ROUTE'S AT THE TIME OF THEIR INTIAL CONSTRUCTION. THE ORIGINAL PLANS ARE AVAILABE FOR INSPECTION AT THE MARION COUNTY HIGHWAY DEPARTMENT, 901 WEST ELM STREET, SALEM, ILLINOIS.

COMPUTATION OF HOT-MIX ASPHALT QUANTITIES IS BASED UPON 112 POUNDS/SQUARE YARD/1" THICK.

COMPUTATION OF AGGREGATE SHOULDER, TYPE B, IS BASED UPON 2.05 TONS/CUBIC YARD.

THE FOLLOWING MIXTURE REQUIREMENTS ARE APPLICABLE FOR THIS PROJECT:

MIXTURE USE	SURFACE	LEVELING BINDER & PATCHES
AC/PG	PG 64-22	PG 64-22
RAP % (MAX)	10%	15%
DESIGN AIR VOIDS	4.0% @ Ndes=70	4.0% @ Ndes=70
MIX COMPOSITION (GRADATION MIXTURE)	9.5	
FRICTION AGG	MIX "C"	MIX "B"

SUMMARY OF QUANTITIES

ITEM	PAY ITEM	UNIT	QUANTITY
40600100	BITUMINOUS MATERIAL (PRIME COAT)	GALLON	3175
40600300	AGGREGATE (PRIME COAT)	TON	127
40600635	LEVELING BINDER (MACHINE METHOD), N70	TON	4745
40600895	CONSTRUCTING TEST STRIP	EACH	1
40600990	TEMPORARY RAMP	SQ YD	30
40603315	HOT-MIX ASPHALT SURFACE COURSE, MIX "C", N70	TON	7370
44000150	HOT-MIX ASPHALT SURFACE REMOVAL 1/4"	SQ YD	63497
44201741	CLASS D PATCHES, TYPE II, 8"	SQ YD	13.3
44201747	CLASS D PATCHES, TYPE IV, 8"	SQ YD	6365.3
48101200	AGGREGATE SHOULDERS, TYPE B	TON	1625
67100100	MOBILIZATION	LUMP SUM	1
70100450	TRAFFIC CONTROL AND PROTECTION STNRD 701201	LUMP SUM	1
70100460	TRAFFIC CONTROL AND PROTECTION STNRD 701306	LUMP SUM	1
70300220	TEMPORARY PAVEMENT MARKING - 4"	FOOT	4616
78000200	THERMOPLASTIC PAVEMENT MARKING-LINE 4"	FOOT	76302

Δ SPECIALTY ITEMS

KNOWN UTILITIES

ATT DISTRIBUTION	888-944-0447
CHARTER COMMUNICATION - CENTRALIA, IL	888-432-2427
DIX-KELL WATER/SEWER - DIX, IL	618-266-7701
COUNTRYMARK COOP, LLP - INDIANAPOLIS, IN	800-832-5490
AMEREN IP	888-659-4540
RACCOON WATER CO - CENTRALIA, IL	618-532-9201
SHELL PIPELINE CO, LP - CLAY CITY, IL	618-675-1005
TRI-COUNTY ELECTRIC COOP - SALEM, IL	618-548-3508
VILLAGE OF WALNUT HILL - 201 MAIN ST	618-532-2013

IT IS CONTRACTORS RESPONSIBILITY TO COORDINATE WITH AND LOCATE ALL UTILITIES WITHIN THIS PROJECT.

ILLINOIS ONE CALL UTILITY LOCATE COMPANY
J.U.L.I.E. 1-800-892-0123

SCHEDULE OF SIDE ROADS

NAME	SIDE	STATION	HMA SURFACE COURSE MIX "C" N70 TON
STREET	RT	2+50	9.0
STREET	RT	2+53	11.2
OLD CENTRALIA RD	RT	20+67	19.7
MCNEILL ROAD	LT	65+05	6.7
HOMER ROAD	RT	66+06	7.8
SNOW ROAD	LT	77+88	6.8
DECATOR ROAD	RT	105+81	9.0
MEDLIN ROAD	LT	131+42	13.1
COVENATOR ROAD	LT	158+53	8.8
BUCHANAN ROAD	RT	172+66	8.1
MEYERS ROAD	LT	185+11	11.2
MARGE ROAD	RT	214+89	12.6
MARCH ROAD	LT	225+89	11.2

TOTAL 135.0

ENTRANCE SCHEDULE

TYPE	SIDE	STATION	HMA SURFACE COURSE MIX "C" N70 TON
PE	LT	0+04	2.6
PE	LT	2+81	1.9
PE	LT	3+00	2
PE	RT	5+63	2.6
PE	LT	7+25	2.6
PE	RT	7+30	2.6
PE	LT	8+53	2.5
PE	RT	12+36	2.3
PE	RT	13+16	2.6
PE	LT	19+82	3.1
PE	LT	40+65	2.8
PE	RT	51+69	2.6
PE	LT	52+17	2.3
PE	LT	57+64	2.6
PE	LT	59+32	3.2
PE	LT	68+76	2.8
PE	LT	90+05	2.8
PE	LT	106+71	2.8
PE	LT	107+37	2.6
PE	LT	163+99	2.8
PE	LT	163+70	2.8
PE	LT	161+75	2.3
PE	RT	140+85	2.6
PE	LT	146+69	2.3
PE	LT	151+79	2.6
PE	RT	154+16	2.3
PE	RT	156+00	2.3
PE	RT	158+53	3.1
PE	RT	165+61	2.3
PE	RT	171+36	2.8
PE	LT	191+18	2.8
PE	LT	206+12	3.1
PE	LT	211+26	3.1
PE	LT	234+02	4.4
PE	LT	235+82	2.3
PE	RT	252+80	2.8
PE	LT	252+90	2.8
PE	RT	254+47	4.2
PE	LT	259+11	3.9
PE	RT	260+45	2.6
PE	RT	263+91	2.3
PE	RT	265+13	2.6
PE	RT	282+94	2.8
PE	RT	285+25	2.8

TOTAL 119.8

Pavement Patching Schedule

Class D Patches		Type IV	
Station	Location	SQ FT	SQ YD
0+90	R	550	183.3
3+36	L	385	128.3
7+04	R	252	84.0
7+73	C	350	116.7
8+40	C	1320	440.0
9+54	R	560	186.7
13+45	R	425	141.7
14+41	R	225	75.0
14+64	R	800	266.7
22+51	C	414	138.0
43+18	R	216	72.0
89+28	R	90	30.0
89+13	C	384	128.0
90+45	L	250	83.3
101+24	R	180	60.0
103+69	R	336	112.0
107+69	R	300	100.0
108+31	R	110	36.7
108+49	R	660	220.0
112+96	R	240	80.0
120+96	R	280	93.3
126+13	L	715	238.3
127+02	C	650	216.7
150+75	C	375	125.0
151+52	C	450	150.0
167+13	R	165	55.0
172+58	L	264	88.0
180+97	L	220	73.3
199+33	R	360	120.0
201+13	R	360	120.0
201+72	R	420	140.0
203+92	R	108	36.0
204+86	R	750	250.0
223+00	C	180	60.0
225+19	L	210	70.0
230+00	C	1485	495.0
231+60	C	1500	500.0
260+88	R	675	225.0
276+30	R	224	74.7
276+06	R	258	86.0
276+92	R	396	132.0
279+15	R	456	152.0
284+19	R	84	28.0
284+44	R	84	28.0
285+14	R	180	60.0

Total Patching Quantity = 6366.3 SQ YD

Pavement Patching Schedule

Class D Patches		Type II	
Station	Location	SQ FT	SQ YD
105+18	R	40	13.3

Total Patching Quantity = 13.3 SQ YD

SCHEDULE OF PAVEMENT MARKING LINE 4"

TYPE OF LINE	YELLOW LENGTH(FT)	WHITE LENGTH(FT)
CENTERLINE SKIP-DASH*	7200	
NO PASSING ZONE STRIPE	5817	
EDGE LINE		57468
* 10'-30' Cycle for skip-dash		
TOTAL	13017	57468

SCHEDULE OF NO PASSING ZONE STRIPES

BEGIN STATION	END STATION	LENGTH (FT)
EBL 0+00	EBL 2+60	260
WBL 2+60	WBL 7+95	535
EBL 14+96	EBL 19+92	496
WBL 19+92	WBL 24+86	497
EBL 127+76	EBL 132+76	500
WBL 135+63	WBL 140+68	505
EBL 217+55	EBL 222+36	481
WBL 228+80	WBL 233+73	493
EBL 235+60	EBL 240+50	490
WBL 242+80	WBL 248+13	533
EBL 256+22	EBL 261+10	488
WBL 265+31	WBL 270+70	539

TOTAL = 5817