

ROGER V. DANIEL & JANICE K. DANIEL  
SE 1/4, NE 1/4, SEC 21, T. 3 S., R. 3 E., 3RD P.M.

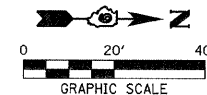

PLAN	SURVEYED	DATE
	PLOTTED	
	CHECKED	
	BY	
	NO. OF	
	FILE	
	NAME	

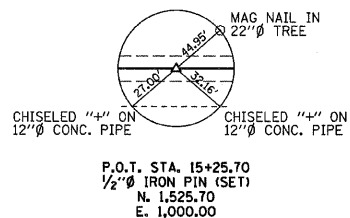
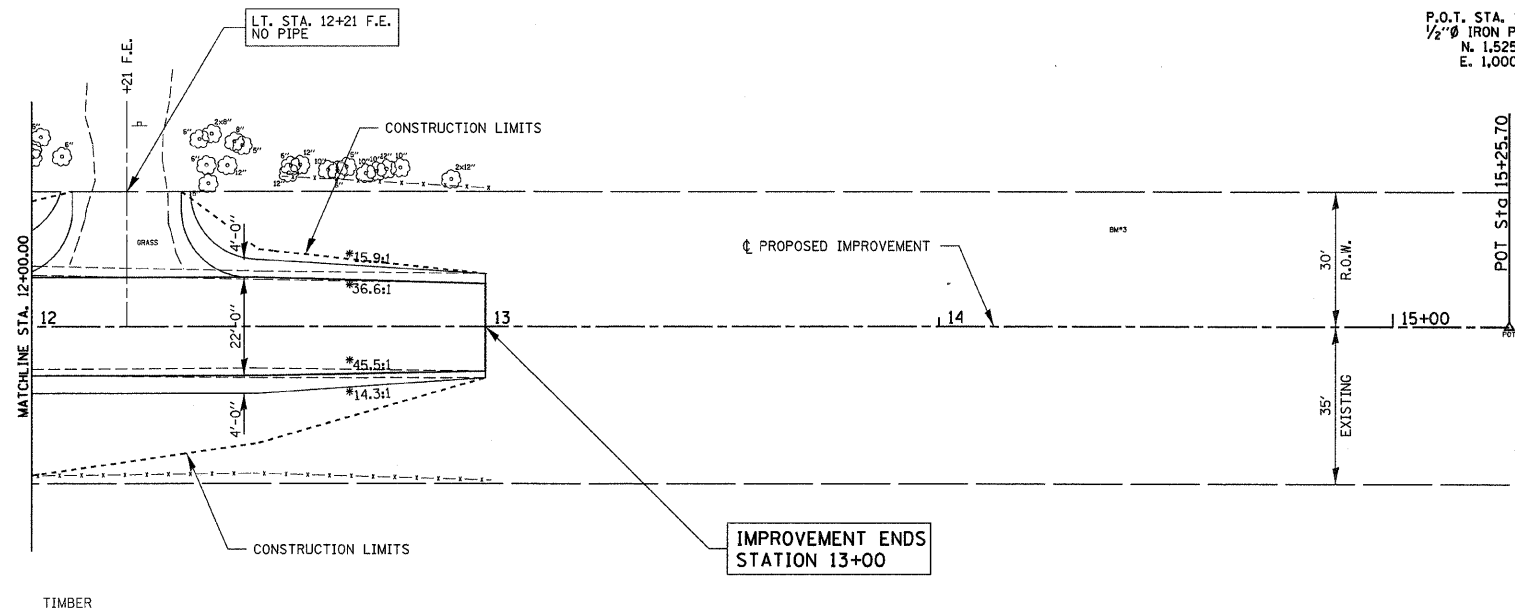

\*TRANSITION FROM THE PROPOSED ROADWAY TO THE EXISTING ROADWAY IS TO BE CONSTRUCTED FROM STA. 12+50 TO 13+00.

CAYLON R. SEAGRAVES & JANET KAY SEAGRAVES  
N 1/2, SW 1/4, NW 1/4, SEC 22, T. 3 S., R. 3 E., 3RD P.M.

PROFILE	SURVEYED	DATE
	PLOTTED	
	CHECKED	
	BY	
	NO. OF	
	FILE	
	NAME	

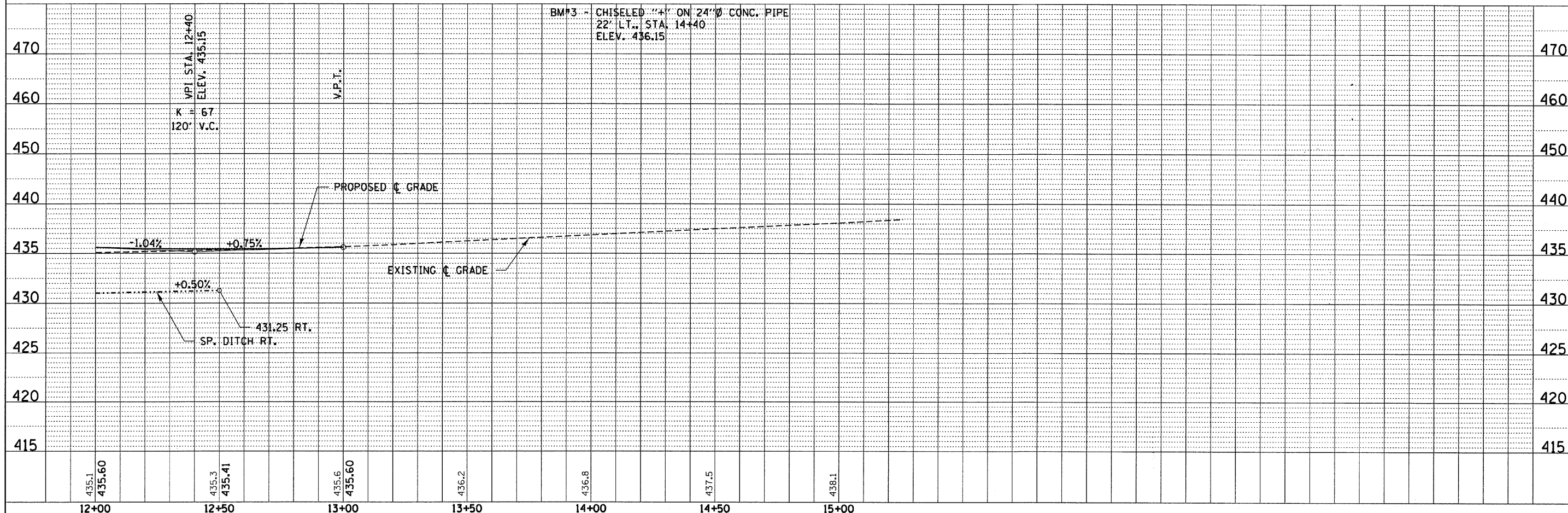

FILE NAME = 100238-eh-pp2.dgn	USER NAME =	DESIGNED - J.W.F.	REVISED -	<p align="center"><b>STATE OF ILLINOIS</b> <b>JEFFERSON COUNTY HIGHWAY DEPARTMENT</b></p>	<p align="center"><b>PLAN &amp; PROFILE</b> <b>SPRING GARDEN LANE</b></p>	T.R.	SECTION	COUNTY	TOTAL SHEETS	SHEET NO.
HAMPTON, LENZINI AND RENWICK, INC. 305 STEVENSON DRIVE, SUITE 201 SPRINGFIELD, ILLINOIS 62703	PLLOT SCALE =	DRAWN - D.T.M.	REVISED -			364	10-04106-00-BR	JEFFERSON	27	6
ILLINOIS PROFESSIONAL DESIGN FIRM L.S. / P.E. / S.E. CORP. 184.000599	PLLOT DATE = 3/1/2012	CHECKED - S.W.M.	REVISED -			DODDS ROAD DISTRICT		CONTRACT NO. 99472		
		DATE - 02/29/12	REVISED -			SCALE: H20xV5 SHEET NO. 1 OF 1 SHEETS STA. 7+00.00 TO STA. 13+00.00		ILLINOIS FED. AID PROJECT BR05-00810671		