

**DETAIL "F"**  
 HALF SCALE 1" = 40'  
 FULL SCALE 1" = 20'

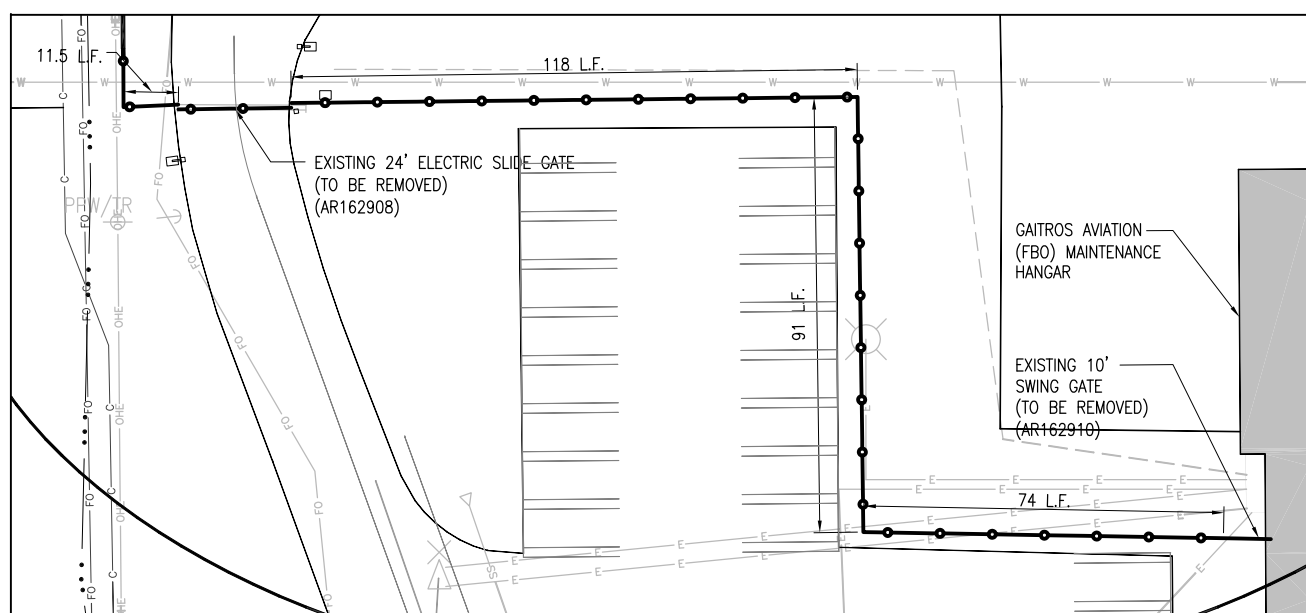

**DETAIL "E"**  
 HALF SCALE 1" = 40'  
 FULL SCALE 1" = 20'

- LEGEND**
- x — EXISTING FENCE (TO REMAIN IN PLACE)
  - o — EXISTING CLASS E FENCE (TO BE REMOVED)
  - ▭ EXISTING PAVEMENT
  - ▭ EXISTING BUILDINGS
  - E — EXISTING ELECTRICAL CABLES
  - SS — EXISTING STORM SEWER
  - SAN — EXISTING SANITARY SEWER
  - W — EXISTING WATER LINE
  - T — EXISTING TELEPHONE LINE
  - G — EXISTING GAS LINE
  - FO — EXISTING FIBER OPTIC
  - C — EXISTING COMMUNICATION/CONTROL CABLE
  - ··· — EXISTING DRAINAGE DITCH
  - EXISTING POWER POLE
  - ⊗ EXISTING LIGHT POLE
  - ⊠ EXISTING ELECTRICAL HANDHOLE/MANHOLE
  - ⊞ EXISTING TRANSFORMER

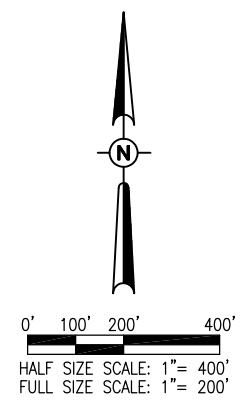

REVISION					
DATE					
<b>DECATUR, ILLINOIS</b>					
I.L. PROJ.: DEC-4167      A.I.P. PROJ.: 3-17-0033-B4					
Hanson Proj. No.	11A0083D				
Filename	C-171-FEN-REV.DWG				
Scale	1" = 200'				
Date	05/08/2012				
LAYOUT	KDM	02/02/12			
DRAWN	KDM	02/02/12			
REVIEWED	KNL/RAW	04/19/12			
© Copyright Hanson Professional Services Inc. 2012 <b>HANSON Professional Services Inc.</b> 1525 South Sixth Street Springfield, Illinois 62703-2886 Ph: (217) 788-2450 Fax: (217) 788-2503 www.hanson-inc.com Offices Nationwide					
<b>REPLACE PERIMETER FENCE</b>			<b>EXISTING FENCE REMOVAL PLAN SHEET 3</b>		
<span style="font-size: 2em; font-weight: bold;">6</span>					
6 of 38 sheets					

MAY 08, 2012 12:50 PM HARR01115  
 p:\s\svr306\hanson.dom\hanson\_projects\Documents\11A0083D\CAD\_Airport\Sheet\C-171-FEN-FEY