

STATE OF ILLINOIS
DEPARTMENT OF TRANSPORTATION

F.A.P. RTE.	SECTION	COUNTY	TOTAL SHEETS	SHEET NO.
673(317)	(102,103;17,18)PP	WOODFORD/TAZEWELL	19	1
		ILLINOIS	CONTRACT NO. 68E10	

1. COVER SHEET
2. COMMITMENTS, GENERAL NOTES, & HMA MIXTURE REQUIREMENTS
- 3-4. SUMMARY OF QUANTITIES
- 5-7. SCHEDULE OF QUANTITIES
8. TC&P APPROACH TAPER DETAILS
9. US 24 LINE DIAGRAM
- 10-13. US 24 TYPICAL SECTIONS
14. IL 116 LINE DIAGRAM
- 15-16. IL 116 TYPICAL SECTIONS
17. LONGITUDINAL JOINT REPAIR DETAIL
- 18-19. CADD STANDARDS

HIGHWAY STANDARDS

000001-06	701411-09
001006	701421-08
353001-05	701422-10
420001-09	701428-01
420101-06	701456-05
420701-03	701701-10
421001-03	701901-07
421101-10	720011-01
442101-08	780001-05
442201-03	781001-04
701336-06	

DESIGN DESIGNATION

US 24 OTHER PRINCIPAL ARTERIAL
2017 ADT = 22,000
MU = 350
SU = 650
IL 116 MINOR PRINCIPAL ARTERIAL
2017 ADT = 14,600
MU = 325
SU = 325

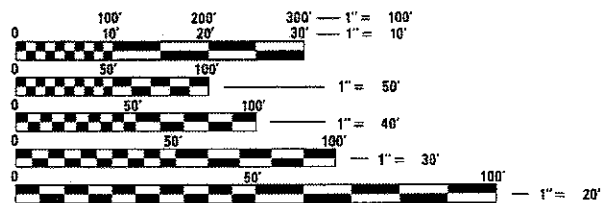

FULL SIZE PLANS HAVE BEEN PREPARED USING STANDARD ENGINEERING SCALES. REDUCED SIZED PLANS WILL NOT CONFORM TO STANDARD SCALES. IN MAKING MEASUREMENTS ON REDUCED PLANS, THE ABOVE SCALES MAY BE USED.

J.U.L.I.E.
JOINT UTILITY LOCATION INFORMATION FOR EXCAVATION
1-800-892-0123
OR 811

PROJECT ENGINEER: RICH DOTSON (309-671-3455)
PROJECT MANAGER: KRISTINA POPURELLA (309-671-3471)
CATALOG NUMBER: 035591-00D
CONTRACT NO. 68E10

PROPOSED HIGHWAY PLANS

FAP ROUTE 673 (IL 116)
FAP ROUTE 317 (US 24)
SECTION (102,103;17,18)PP
PROJECT

WOODFORD & TAZEWELL COUNTY

C-94-044-18

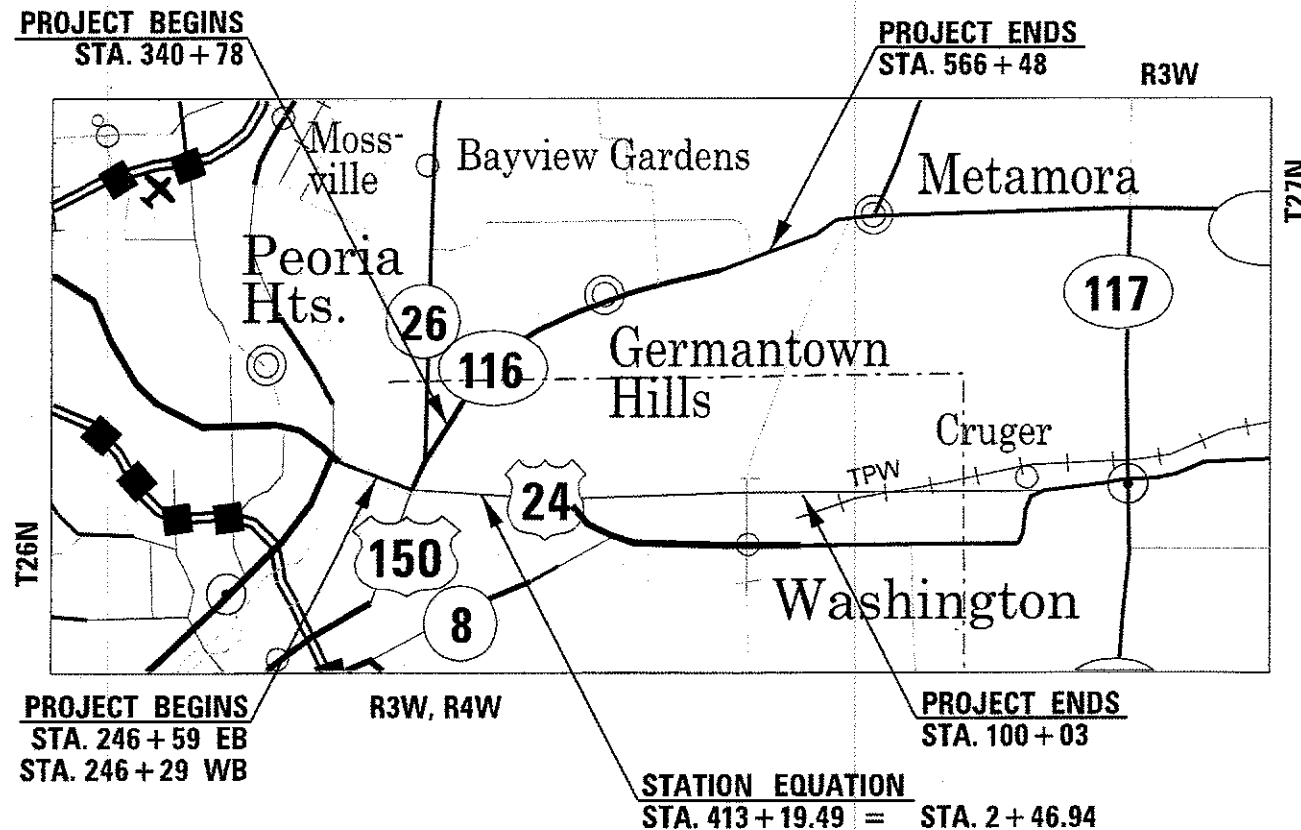

GROSS LENGTH (US 24) = 26,400 FT. = 5.00 MILES
GROSS LENGTH (IL 116) = 22,600 FT. = 4.28 MILES
NET LENGTH (US 24) = 26,400 FT. = 5.00 MILES
NET LENGTH (IL 116) = 22,600 FT. = 4.28 MILES

D-94-023-18

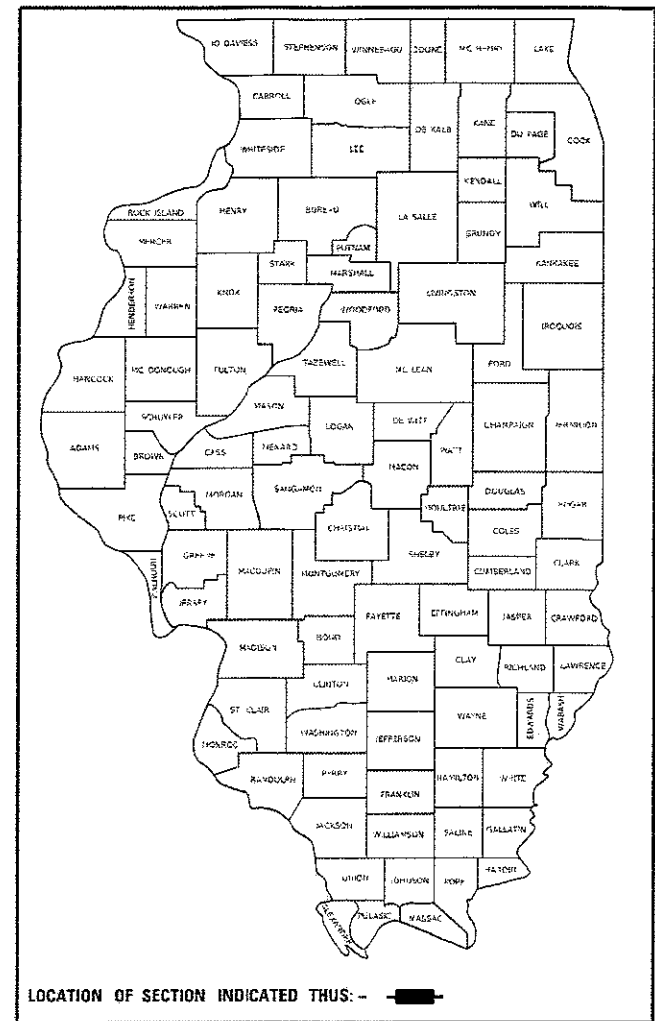

PROJECT DESCRIPTION: This project consist of Class B & D Full Depth Patching, Partial Depth Patching, Longitudinal Joint Repair, and other related collateral work necessary to complete the project as shown in the plans.

STATE OF ILLINOIS
DEPARTMENT OF TRANSPORTATION

SUBMITTED March 29, 2018
Frank A. James
REGION THREE ENGINEER

May 11, 2018
Scott E. Etk
ENGINEER OF DESIGN AND ENVIRONMENT

May 11, 2018
Frank A. James
DIRECTOR OF HIGHWAYS PROJECT IMPLEMENTATION

PRINTED BY THE AUTHORITY
OF THE STATE OF ILLINOIS

MODEL: D:\p1\11084848\INTEG\11084848\p1\11084848\Documents\11084848\District 4\Projects\Sound 6\68E10\S00.dwg
 FILE NAME: P:\11084848\INTEG\11084848\p1\11084848\Documents\11084848\District 4\Projects\Sound 6\68E10\S00.dwg

CODE NO.	ITEM	UNIT	TOTAL QUANTITY	CONSTRUCTION CODE		
				0005	0005	
				ROADWAY	ROADWAY	
				100% STATE WOODFORD COUNTY	100% STATE TAZEWELL COUNTY	
44200050	WELDED WIRE REINFORCEMENT	SO YD	19		19	
44201007	CLASS B PATCHES, TYPE II, 13 INCH	SO YD	179		179	
44201011	CLASS B PATCHES, TYPE III, 13 INCH	SO YD	19		19	
44201299	DOWEL BARS 1 1/2"	EACH	432		432	
44201815	CLASS D PATCHES, TYPE II, 14 INCH	SO YD	427	395	32	
44201819	CLASS D PATCHES, TYPE III, 14 INCH	SO YD	117	117		
44213200	SAW CUTS	FOOT	944		944	
67100100	MOBILIZATION	L SUM	1	0.4	0.6	
70103815	TRAFFIC CONTROL SURVEILLANCE	CAL DA	10	4	6	
70300100	SHORT-TERM PAVEMENT MARKING	FOOT	2156		2156	
70300150	SHORT TERM PAVEMENT MARKING REMOVAL	SO FT	719		719	
* 78009006	MODIFIED URETHANE PAVEMENT MARKING - LINE 6"	FOOT	9520		9520	
* 78100100	RAISED REFLECTIVE PAVEMENT MARKER	EACH	529	3	526	
78300200	RAISED REFLECTIVE PAVEMENT MARKER REMOVAL	EACH	529	3	526	

* SPECIALTY ITEMS

USER NAME : bergsjekaroo	DESIGNED -	REVISED -
	DRAWN -	REVISED -
PLOT SCALE = 1000.0000 ' / in.	CHECKED -	REVISED -
PLOT DATE = 3/28/2018	DATE -	REVISED -

STATE OF ILLINOIS
DEPARTMENT OF TRANSPORTATION

SUMMARY OF QUANTITIES

F.A.P. RTE.	SECTION	COUNTY	TOTAL SHEETS	SHEET NO.
673/317	(102,103;17,18)PP	WOODFORD/TAZEWELL	19	3
			CONTRACT NO. 68E10	
ILLINOIS FED. AID PROJECT				

COMMITMENTS

107.00 Commitments are not to be altered without the written approval of all parties to which the commitment was made.

GENERAL NOTES

107.09 PROPERTY OWNER ACCESS REQUIREMENTS

Access must be maintained to all existing properties during construction per Article 107.09 unless arrangements are made in writing by the Contractor with the property owners with a copy to the Engineer for short-term closures.

107.09A CONSECUTIVE SIDE STREET (ROAD) CLOSURE – PROHIBITED

1. No two consecutive side streets (roads) may be closed at the same time during construction. The Contractor must alternate streets (roads).
2. Adjacent side roads will not be closed simultaneously. BLR Standard 21 shall be used for all local road closures without any entrances within the closed area. BLR Standard 22 can be used where it is necessary to allow local traffic access.

204.00 ENVIRONMENTAL REVIEWS

Prior to the use of any proposed borrow areas, use areas (temporary access roads, detours, run-arounds, etc.) and/or waste areas, the Contractor shall file the required environmental resource request surveys according to Section 107.22 of the Standard Specifications. These surveys are required in order for the Department to conduct cultural and biological resource surveys for the proposed site.

Prior to any waste materials being removed from the construction site the required environmental resource surveys will need to be obtained and filed by the Contractor. Excess waste products removed from the construction site shall be disposed of as required in Section 202.03 of the Standard Specifications.

Any protruding metal bars shall be removed prior to the disposal of broken concrete at approved disposal sites.

The required environmental resource documentation shall include the following:

- * BDE Form 2289 (Environmental Survey Request)
- * BDE Form 2290 (Waste/Use Area Review)
- * A location map showing the size limits and location of the use area
- * Color photographs depicting the use area
- * Borrow Area Entry Agreement form-D4 PI0101

Please note that a minimum of four weeks shall be allowed for the District to obtain the required environmental clearances and six weeks for the required borrow site environmental clearances.

701.01 ADDITIONAL SUPPLEMENTAL TRAFFIC CONTROL

The Department reserves the right at any time to add additional Traffic Control Systems or devices within the active contract limits, by means of an additional contract. All terms of Article 105.08 of the Standard Specifications shall be followed by each Contractor.

HOT-MIX ASPHALT MIXTURE REQUIREMENTS

The following mixture requirements are applicable for this project:

Mixture Use(s):	Partial Depth Patch 4" (two 2" lifts)	Centerline Joint Repair 3" (one lift)	Full Depth Patch (All lifts)	
AC/PG:	PG 64-22	PG 64-22	PG 64-22	
Design Air Voids:	4.0% @ N=50	4.0% @ N=50	4.0% @ N=50	
Mixture Composition: (Mixture Gradation)	IL 9.5	IL 9.5	IL 9.5	
Friction Aggregate:	Mix D	Mix D	Mix D	
Quality Management Program:	QCQA	QCQA	QCQA	

- Note: 1) Individual lift thickness of each mix type will be no less than 3 times nominal maximum aggregate size and no more than 6 times nominal maximum aggregate size, unless otherwise approved by the Engineer.
 2) For design purposes, mixture weight for all mixes is determined to be 112.0 lb/s.y./in., unless otherwise noted.
 3) Sublot sizes for FFP and QCP mixes will be 1000 tons, unless otherwise agreed to by the Engineer and the paving contractor.

MODEL: D:\PMT\108\BESID\INTEG_illinois.gov\p10101\Documents\DOT_Offices\District_4\Projects\Squad_68\68E10\Sheets.dgn

USER NAME = berglekerac	DESIGNED -	REVISED -
DRAWN -	REVISION -	
PLOT SCALE = 100,0000' / in.	CHECKED -	REVISED -
PLOT DATE = 3/28/2018	DATE -	REVISED -

**STATE OF ILLINOIS
DEPARTMENT OF TRANSPORTATION**

COMMITMENTS, GENERAL NOTES, & HMA MIXTURE REQUIREMENTS

SCALE: SHEET OF SHEETS STA. TO STA.

F.A.P. RTE.	SECTION	COUNTY	TOTAL SHEETS	SHEET NO.
673/317	(102,103;17,18)PP	WOODFORD/TAZEWELL	19	2
CONTRACT NO. 68E10				
ILLINOIS FED. AID PROJECT				

MODEL: Def ends
 FILE NAME: pos\il_084EBIDINTEG\il_084EBIDINTEG\DWG\DOT Documents\DOT Documents\District 4\Projects\Speed 6\ABRE\W300.dwg

CODE NO.	ITEM	UNIT	TOTAL QUANTITY	CONSTRUCTION CODE	
				0005	0005
				ROADWAY	ROADWAY
				100% STATE WOODFORD COUNTY	100% STATE TAZEWELL COUNTY
		URBAN			
X0556100	PARTIAL DEPTH PATCHING (SPECIAL)	SO YD	1042	112	930
X4421000	PARTIAL DEPTH PATCHING	TON	234.6	28.7	205.9
X7010216	TRAFFIC CONTROL AND PROTECTION (SPECIAL)	L SUM	1	0.4	0.6
X7015005	CHANGEABLE MESSAGE SIGN	CAL DA	175	35	140
Z0033600	LONGITUDINAL JOINT REPAIR	FOOT	37750		37750

USER NAME = bergstekerac	DESIGNED -	REVISED -
PLOT SCALE = 100.0000' / 1" =	DRAWN -	REVISED -
PLOT DATE = 3/26/2019	CHECKED -	REVISED -
	DATE -	REVISED -

STATE OF ILLINOIS
 DEPARTMENT OF TRANSPORTATION

SUMMARY OF QUANTITIES

F.A.P. RTE. 673/317	SECTION (102,103;17,18)PP	COUNTY WOODFORD/TAZEWELL	TOTAL SHEETS 19	SHEET NO. 4
CONTRACT NO. 68E10			ILLINOIS FED. AID PROJECT	

IL 116 - CLASS D PATCHES, 14"							
APPROX. LOCATION RANGE	PATCH SIZES AND QTY						
	WOODFORD				TAZEWELL		
	TYPE II		TYPE III		TYPE II		
	PATCH SIZE (LxW) & QTY						
	6X12	8X12	10X12	12X12	16X12	8x12	16x6
IL 116 WESTBOUND							
0.00 (LOURDES RD)							
SCHMITT							
0.9	3						
1.3	2						
1.60 (ACCESS RD. 17)	2				2		
1.7	3						
2.6	1						
2.7 (ST. FRANCIS)	3	2	2				
3.9 (HOPPE LANE)	2		2			2	
4.3 (UPPER SPRING BAY)							
IL 116 EASTBOUND							
0.00 (UPPER SPRING BAY)							1
1.0 (ACCESS RD. 13)	1	1	2				
1.4	1						
1.5 (ST. FRANCIS)				2			
FAR HILLS	2						
MAPLE	3		2				
2.6 (ACCESS RD. 17)	3						
2.9 (ACCESS RD. 18)	1	1					
3.3 (TIMBERAN RD.)							
		2			2		
SUBTOTAL	28	6	8	2	4	2	1
TOTAL NO. PATCHES		42		6		2	1
TAZEWELL COUNTY							
WESTBOUND IL 116 SUB-TOTAL (SQ YD)						21.33	-
EASTBOUND IL 116 SUB-TOTAL (SQ YD)						-	10.67
WOODFORD COUNTY							
WESTBOUND IL 116 SUB-TOTAL (SQ YD)		210.67		42.67		-	-
EASTBOUND IL 116 SUB-TOTAL (SQ YD)		184.00		74.67		-	-
JOB TOTAL (WOODFORD COUNTY)		395.00		117.00		-	-
JOB TOTAL (TAZEWELL COUNTY)		-		-			32.00

US 24 - CLASS B PATCHES, 13"							
APPROX. LOCATION RANGE	PATCH SIZES AND QTY						
	TYPE II			TYPE III	SAW CUTS	DOWEL BARS	WELDED WIRE REINFORCEMENT
	PATCH SIZE (LxW) & QTY					1 1/2"	
	6X12	8X12	10X12	14X12	FOOT	EACH 12" CTS	SQ YD
US 24 WESTBOUND							
0.00 (US 24)							
1.50 (HOLLAND RD)		2			104	48	
1.90 (GROSENBACH)		4	3		376	168	
IL 116 EAST EXIT RAMP	3		1	1	264	120	18.67
MCCLUGAGE BRIDGE (WB JOB LIMITS)							
US 24 EASTBOUND							
0.00 (US 24)	2				96	48	
IL 116 WEST EXIT RAMP		2			104	48	
COLLEGE							
SUBTOTAL	5	8	4	1	944	432	18.67
TOTAL NO. PATCHES		17		1	-	-	-
WESTBOUND US 24 SUB-TOTAL (SQ YD)		141.33		18.67	744	336	18.67
EASTBOUND US 24 SUB-TOTAL (SQ YD)		37.33		-	200	96	
JOB TOTAL (TAZEWELL COUNTY)		179.00		19.00	944.00	432.00	19.00

MODEL: Default
 FILE: \\nas101.pva\illinois\B&E\BIDD\ITEC\Illinois\gov\PIWDOT\Documents\BIDD\Office\BIDD\ref\2\Projects\515\quad_68E10\Schedule.dgn

USER NAME = bergsieker	DESIGNED -	REVISED -
PLOT SCALE = 100,0000' / in.	CHECKED -	REVISED -
PLOT DATE = 3/28/2018	DATE -	REVISED -

**STATE OF ILLINOIS
DEPARTMENT OF TRANSPORTATION**

SCHEDULE OF QUANTITIES			
SCALE:	SHEET	OF SHEETS	STA. TO STA.

F.A.P. RTE.	SECTION	COUNTY	TOTAL SHEETS	SHEET NO.
673/317	(102, 103; 17,18)PP	WOODFORD/TAZEWELL	19	5
CONTRACT NO. 68E10				
ILLINOIS		FED. AID PROJECT		

US 24 AND IL 116 PARTIAL DEPTH PATCHING (SPECIAL)

APPROX. LOCATION RANGE	TAZEWELL COUNTY																		WOODFORD COUNTY
	TYPE II									TYPE III					TYPE IV				TYPE II
	PATCH SIZE (LxW) & QTY									PATCH SIZE (LxW) & QTY					PATCH SIZE (LxW) & QTY				PATCH SIZE (LxW) & QTY
	4X12	6X12	8X6	8X12	10X12	16X6	16X8	20X4	30X4	12X12	14X12	16X12	18X12	40X4	30X8	30X12	120X4	200X4	6X12
US 24 WESTBOUND																			
0.00 (US 24)																			
1.50 (HOLLAND RD)	7	8									2								
1.90 (GROSENBACH)	6	2								2									
EXIT RAMP TO IL 116	7	4								1		1							
US 24 WB ENTRANCE RAMP	2	3	4	6		1		1	1		1				1	1			
MCCLUGAGE BRIDGE (WB JOB LIMITS)	1												1	1					
US 24 EASTBOUND																			
0.00 (US 24)																			
EXIT RAMP TO IL 116 WEST		1								1									
COLLEGE	7	3				2	1											1	
GROSENBACH	2	2		1	1														
CUMMINGS (EB JOB LIMIT)	2																		
IL 116 WESTBOUND																			
0.00 (IL 116)																			6
IL 116 EASTBOUND																			
2.60 (ACCESS RD. 17)																			6
VARIOUS LOCATIONS																			2
SUBTOTAL	34	23	4	7	1	3	1	1	1	1	3	3	1	1	1	1	1	1	14
TOTAL NO. PATCHES	75									9					18				14
WESTBOUND US 24 SUB-TOTAL (SQ YD)	376.89									161.78					120.00				
EASTBOUND US 24 SUB-TOTAL (SQ YD)	166.22									16.00					88.89				
WESTBOUND IL 116 SUB-TOTAL (SQ YD)																			48.00
EASTBOUND IL 116 SUB-TOTAL (SQ YD)																			64.00
US 24 SUB-TOTAL (TAZEWELL COUNTY)										930.00									
IL 116 SUB-TOTALS (WOODFORD COUNTY)										112.00									
JOB TOTAL (SQ YD)										1042.00									

MODEL: Default
 FILE: \\nas01c.pva.illinois.gov\pww\DOT\Documents\DOT_Offices\Director\Projects\68E10\Schedule.dgn

USER NAME = bergsieker	DESIGNED -	REVISED -
PLOT SCALE = 100,0000' / in.	DRAWN -	REVISED -
PLOT DATE = 3/28/2018	CHECKED -	REVISED -
	DATE -	REVISED -

**STATE OF ILLINOIS
DEPARTMENT OF TRANSPORTATION**

SCHEDULE OF QUANTITIES

SCALE: SHEET OF SHEETS STA. TO STA.

F.A.P. RTE.	SECTION	COUNTY	TOTAL SHEETS	SHEET NO.
673/317	(102,103;17,18)PP	WOODFORD/TAZEWELL	19	6
CONTRACT NO. 68E10			ILLINOIS FED. AID PROJECT	

PARTIAL DEPTH PATCHING		
APPROX. LOCATION RANGE	SY	TON
US 24 WESTBOUND		
0.00 (US 24)		
	144.00	32.26
HOLLAND		
	85.33	19.11
GROSENBACH		
	112.00	25.09
IL 116 EAST EXIT RAMP		
	306.67	68.69
MCCLUGAGE BRIDGE		
US 24 EASTBOUND		
0.00 (US 24)		
	24.00	5.38
IL 116 WEST EAXIT RAMP		
	185.78	41.61
COLLEGE		
	50.67	11.35
GROSENBACH		
	10.67	2.39
IL 116 WESTBOUND		
IL 116 Various Locations	48.00	10.75
IL 116 EASTBOUND		
2.60 (Access Rd. 17)	16.00	3.58
IL 116 Various Locations	64.00	14.34
<i>US 24 SUB-TOTAL (TAZEWELL COUNTY)</i>		205.90
<i>IL 116 SUB-TOTAL (WOODFORD COUNTY)</i>		28.70
JOB TOTAL		234.60

APPROX. LOCATION RANGE		LONGITUDINAL JOINT REPAIR	SHORT TERM PAVEMENT MARKING	SHORT TERM PAVEMENT MARKING REMOVAL	MODIFIED URETHANE PAVEMENT MARKING - LINE 6"	
FROM	TO	AREA	FOOT	TYPE IV TAPE FOOT	SQ FT	FOOT
US 24 WESTBOUND						
250' EAST OF CUMMINGS	SPRING CREEK	CENTERLINE	5,700	520	173	1,430
SPRING CREEK	GRANGE	CENTERLINE	5,300	484	161	1,330
GRANGE	250' EAST OF GROSENBACH	CENTERLINE	5,400	492	164	1,350
US 24 WB						
US 24 WB	CUMMINGS	RT TURN LN	150			40
24 WB	BUSINESS 24	LT TURN LN	650			170
BUSINESS 24	US 24WB	ON RAMP	600			150
US 24 WB	HOLLAND GROVE	RT TURN LN	650			170
US 24 WB	GROSENBACH	RT TURN LN	550			140
US 24 WB	AT GROSENBACH	MEDIAN AREA	150			40
US 24 WB	AT GROSENBACH	MEDIAN AREA	500			130
US 24 WB	GROSENBACH	EXTRA PAVEMENT AREA	200			50
US 24 EASTBOUND						
250' WEST OF GROSSENBACH	BUSINESS 24	CENTERLINE	7,250	660	220	1,820
US 24 EB	GRANGE	LT TURN LN	450			120
US 24 EB	GRANGE	RT TURN LN	650			170
US 24 EB	BUSINESS 24	ON RAMP	450			120
BUSINESS 24 ON RAMP	250' WEST OF CUMMINGS	CENTERLINE US 24 EB	8,250			2,070
US 24 EB	CUMMINGS	RT TURN LN	850			220
WESTBOUND US 24 SUB-TOTAL			19,850	1,496	499	5,000
EASTBOUND US 24 SUB-TOTAL			17,900	660	220	4,520
JOB TOTAL (TAZEWELL COUNTY)			37,750	2,156	719	9,520

LOCATION	RPM REMOVAL	RAISED REFLECTIVE PAVEMENT MARKER
	EACH	EACH
US 24		
LONGITUDINAL JOINT REPAIR	399	399
107 TOTAL PATCHES (TAZEWELL COUNTY)	76	76
IL 116		
100 TOTAL PATCHES (TAZEWELL COUNTY)	51	51
3 TOTAL PATCHES (WOODFORD COUNTY)	3	3
WOODFORD COUNTY SUB-TOTAL	3	3
TAZEWELL COUNTY SUB-TOTAL	526	526
JOB TOTAL	529	529

JOBSITE				
LOCATION	MOBILIZATION	TRAFFIC CONTROL SURVEILLANCE	TRAFFIC CONTROL AND PROTECTION (SPECIAL)	CHANGEABLE MESSAGE SIGN*
	LSUM	CAL DA	LSUM	CAL DAY
IL 116				
WOODFORD	0.4	4	0.4	35
TAZEWELL	0.1	1	0.1	35
US 24				
TAZEWELL	0.5	5.0	0.5	105.0
SUB-TOTAL WOODFORD	0.4	4.0	0.4	35.0
SUB-TOTAL TAZEWELL	0.6	6.0	0.6	140.0
TOTALS	1.0	10.0	1.0	175.0

*There will be 5 total message boards @ 35 days each

MODEL: Default
 FILE: Model - Proj\IL08\B&E\BIDD\ITC\Illinois.gov\FWIDOT\Documents\BIDD\Office\BIDD\TCT - Projects\Squard_668E\0\Schedule.dgn

USER NAME = bergsieker	DESIGNED -	REVISED -
	DRAWN -	REVISED -
PLOT SCALE = 100,0000' / in.	CHECKED -	REVISED -
PLOT DATE = 3/28/2018	DATE -	REVISED -

**STATE OF ILLINOIS
DEPARTMENT OF TRANSPORTATION**

SCHEDULE OF QUANTITIES

SCALE:	SHEET	OF	SHEETS	STA.	TO	STA.
--------	-------	----	--------	------	----	------

F.A.P. RTE.	SECTION	COUNTY	TOTAL SHEETS	SHEET NO.
673/317	(102,103;17,18)PP	WOODFORD/TAZEWELL	19	7
CONTRACT NO. 68E10				
ILLINOIS FED. AID PROJECT				



DETAIL A

DETAIL A:

LANE CLOSURES REQUIRED FOR WORK IN THE SHADED AREAS AS SHOWN FOR EASTBOUND TRAFFIC SHALL COMMENCE WITH THE TAPER PLACED ON OR BEFORE THE CREST OF THE MCCLUGAGE BRIDGE.



DETAIL B

DETAIL B:

LANE CLOSURES REQUIRED FOR WORK IN THE SHADED AREAS AS SHOWN FOR EASTBOUND TRAFFIC SHALL COMMENCE WITH THE TAPER PLACED EAST OF THE EXIT RAMP TO EB IL 116.

MODEL: Default
 FILE: \\nas01.cba.uillinois.edu\B&E\DOT\Documents\DOT_Offices\District 4\Projects\Squad_668E\03Sheets.dgn

USER NAME = bergsieker	DESIGNED -	REVISED -
	DRAWN -	REVISED -
PLOT SCALE = 100,0000' / in.	CHECKED -	REVISED -
PLOT DATE = 3/28/2018	DATE -	REVISED -

**STATE OF ILLINOIS
DEPARTMENT OF TRANSPORTATION**

TC&P APPROACH TAPER DETAILS

SCALE: SHEET OF SHEETS STA. TO STA.

F.A.P. RTE.	SECTION	COUNTY	TOTAL SHEETS	SHEET NO.
673/317	(102,103;17,18)PP	WOODFORD/ TAZEWELL	19	8
CONTRACT NO. 68E10			ILLINOIS FED. AID PROJECT	

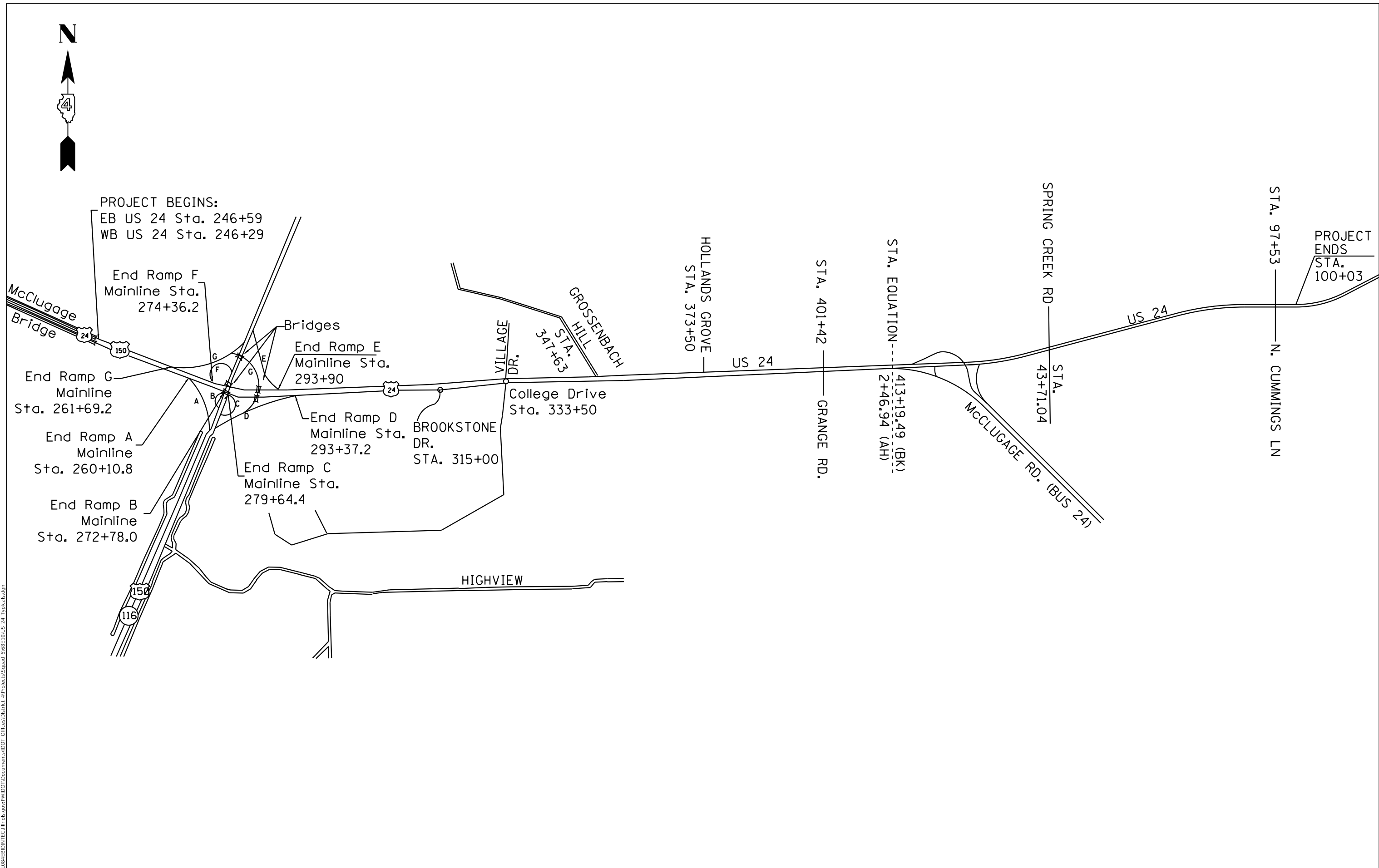

PROJECT BEGINS:
 EB US 24 Sta. 246+59
 WB US 24 Sta. 246+29

PROJECT ENDS
 STA. 100+03

End Ramp F
 Mainline Sta. 274+36.2

End Ramp E
 Mainline Sta. 293+90

End Ramp G
 Mainline Sta. 261+69.2

End Ramp D
 Mainline Sta. 293+37.2

End Ramp A
 Mainline Sta. 260+10.8

End Ramp C
 Mainline Sta. 279+64.4

End Ramp B
 Mainline Sta. 272+78.0

BROOKSTONE DR.
 STA. 315+00

College Drive
 Sta. 333+50

HOLLANDS GROVE
 STA. 373+50

STA. 401+42
 GRANGE RD.

STA. EQUATION -
 413+19.49 (BK)
 2+46.94 (AH)

SPRING CREEK RD
 STA. 43+71.04

STA. 97+53
 N. CUMMINGS LN

MODEL: Default
 FILE NAME: p:\116\68E10\B6E10\NTEC\Illinois.gov\PWIDOT\Documents\116DOT_Offices\116\116\US 24_Typical.dgn

USER NAME = bergsieker	DESIGNED -	REVISED -
	DRAWN -	REVISED -
PLOT SCALE = 100,0000' / in.	CHECKED -	REVISED -
PLOT DATE = 3/28/2018	DATE -	REVISED -

**STATE OF ILLINOIS
 DEPARTMENT OF TRANSPORTATION**

US 24 LINE DIAGRAM

SCALE: SHEET OF SHEETS STA. TO STA.

F.A.P. RTE.	SECTION	COUNTY	TOTAL SHEETS	SHEET NO.
673/317	(102,103;17,18)PP	WOODFORD/ TAZEWELL	19	9
CONTRACT NO. 68E10				
ILLINOIS FED. AID PROJECT				

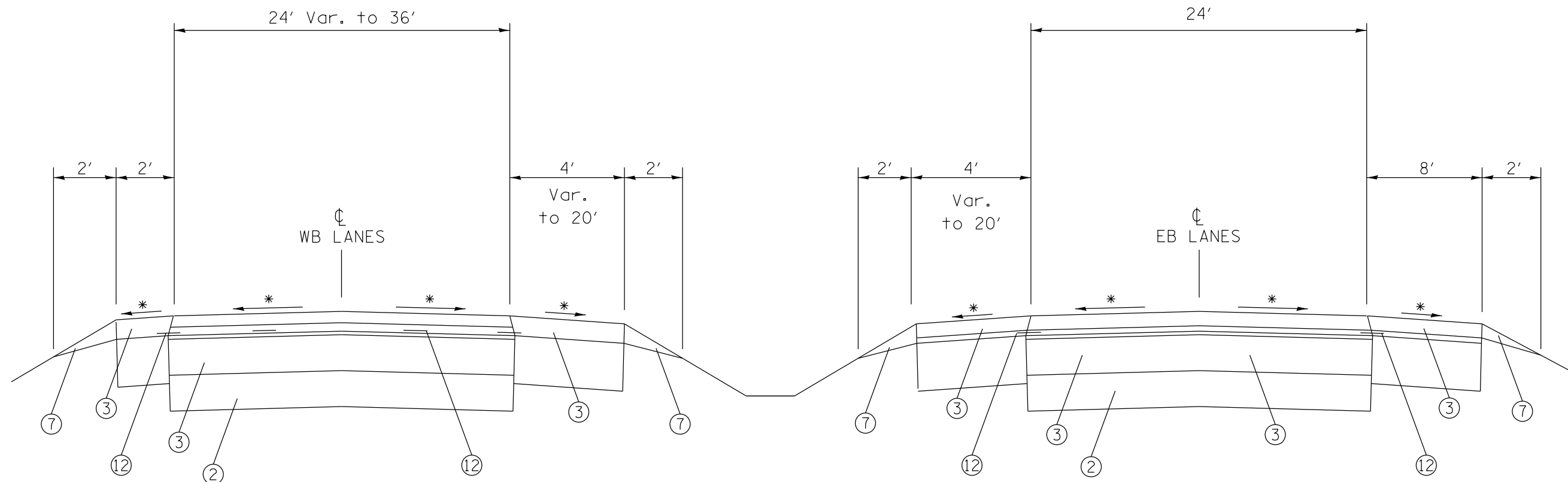

US 24 TYPICAL #1
 EB STA. 246+59 TO STA. 253+38
 WB STA. 246+29 TO STA. 253+38

LEGEND

- | | |
|-------------------------------|---|
| ① EXIST. 4" GRANULAR SUB-BASE | ⑦ EXIST. AGG. SHOULDER |
| ② EXIST. 10" P.C.C. PAVEMENT | ⑧ EXIST. FULL DEPTH BIT. PAVEMENT (14") |
| ③ EXIST. BITUMINOUS OVERLAY | ⑨ EXIST. SUB-BASE GRANULAR MATL |
| ④ EXIST. 9" BIT. BASE COURSE | ⑩ EXIST. LIME MODIFIED SOIL |
| ⑤ EXIST. 4" PIPE UNDERDRAIN | ⑪ EXIST. CONCRETE MEDIAN |
| ⑥ EXIST. 8" BIT. SHOULDER | ⑫ EXIST. STRIP REFLEC. CRACK CONT. TREAT. |

* MATCH EXISTING SLOPE

DRAWING NOT TO SCALE

MODEL: Default
 FILE NAME: p:\u0000\B&E\BID\TEC\Illinois\pwr\WID\DOT\Documents\BID\T\Office\BID\T\T\Projects\US24_Typical.dgn

USER NAME = bergsieker	DESIGNED -	REVISED -
	DRAWN -	REVISED -
PLOT SCALE = 100,0000' / in.	CHECKED -	REVISED -
PLOT DATE = 3/28/2018	DATE -	REVISED -

**STATE OF ILLINOIS
 DEPARTMENT OF TRANSPORTATION**

US 24 TYPICAL SECTIONS			
SCALE:	SHEET	OF SHEETS	STA. TO STA.

F.A.P. RTE.	SECTION	COUNTY	TOTAL SHEETS	SHEET NO.
673/317	(102,103;17,18)PP	WOODFORD/ TAZEWELL	19	10
CONTRACT NO. 68E10				
ILLINOIS FED. AID PROJECT				

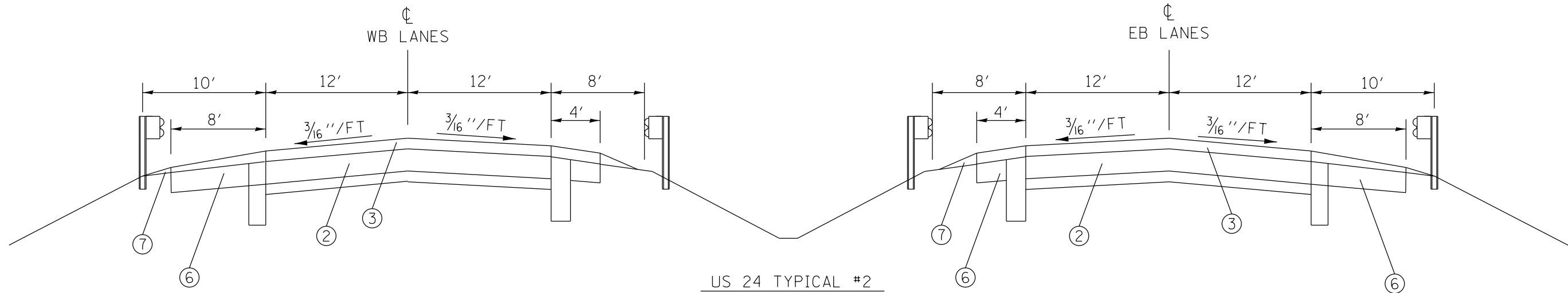

US 24 TYPICAL #2
 STA. 253+38 TO STA. 342+00
 (GUARDRAIL IS INTERMITTENT)

LEGEND

- | | |
|-------------------------------|---|
| ① EXIST. 4" GRANULAR SUB-BASE | ⑦ EXIST. AGG. SHOULDER |
| ② EXIST. 10" P.C.C. PAVEMENT | ⑧ EXIST. FULL DEPTH BIT. PAVEMENT (14") |
| ③ EXIST. BITUMINOUS OVERLAY | ⑨ EXIST. SUB-BASE GRANULAR MATL |
| ④ EXIST. 9" BIT. BASE COURSE | ⑩ EXIST. LIME MODIFIED SOIL |
| ⑤ EXIST. 4" PIPE UNDERDRAIN | ⑪ EXIST. CONCRETE MEDIAN |
| ⑥ EXIST. 8" BIT. SHOULDER | ⑫ EXIST. STRIP REFLEC. CRACK CONT. TREAT. |

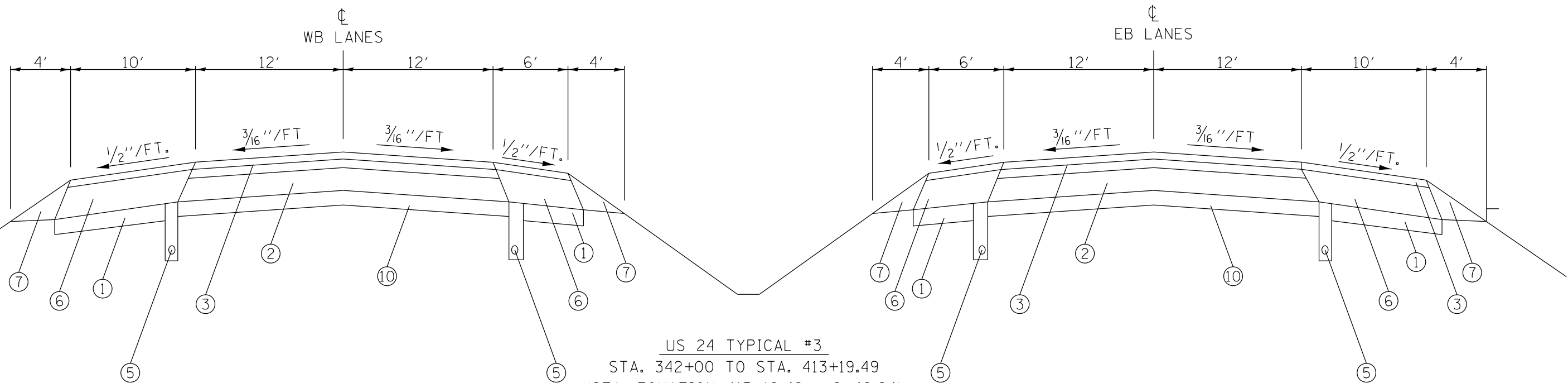

US 24 TYPICAL #3
 STA. 342+00 TO STA. 413+19.49
 (STA. EQUATION 413+19.49 = 2+46.94)
 STA. 2+46.94 TO STA. 99+17

SEE TYPICALS #4 & #5 FOR TURN LANE LOCATIONS

DRAWING NOT TO SCALE

MODEL: Default
 FILE NAME: p:\ILLINOIS\B&E\BIDDING\TEC\Illinois.gov\FWIDOT\Documents\BIDD\Office\BIDD\Tet 688E\US 24 Typical.dgn

USER NAME = bergsieker	DESIGNED -	REVISED -
PLOT SCALE = 100,0000' / in.	DRAWN -	REVISED -
PLOT DATE = 3/28/2018	CHECKED -	REVISED -
	DATE -	REVISED -

**STATE OF ILLINOIS
 DEPARTMENT OF TRANSPORTATION**

US 24 TYPICAL SECTIONS

SCALE: SHEET OF SHEETS STA. TO STA.

F.A.P. RTE.	SECTION	COUNTY	TOTAL SHEETS	SHEET NO.
673/317	(102,103;17,18)PP	WOODFORD/TAZEWELL	19	11
CONTRACT NO. 68E10				
ILLINOIS FED. AID PROJECT				

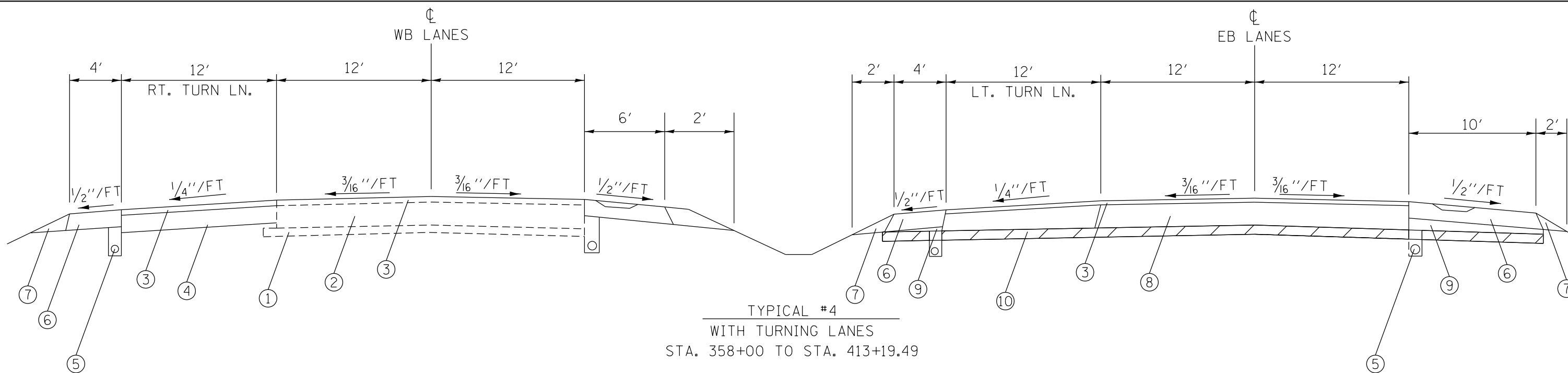

TYPICAL #4
WITH TURNING LANES
STA. 358+00 TO STA. 413+19.49

LEGEND

① EXIST. 4" GRANULAR SUB-BASE	⑦ EXIST. AGG. SHOULDER
② EXIST. 10" P.C.C. PAVEMENT	⑧ EXIST. FULL DEPTH BIT. PAVEMENT (14")
③ EXIST. BITUMINOUS OVERLAY	⑨ EXIST. SUB-BASE GRANULAR MATL
④ EXIST. 9" BIT. BASE COURSE	⑩ EXIST. LIME MODIFIED SOIL
⑤ EXIST. 4" PIPE UNDERDRAIN	⑪ EXIST. CONCRETE MEDIAN
⑥ EXIST. 8" BIT. SHOULDER	⑫ EXIST. STRIP REFLEC. CRACK CONT. TREAT.

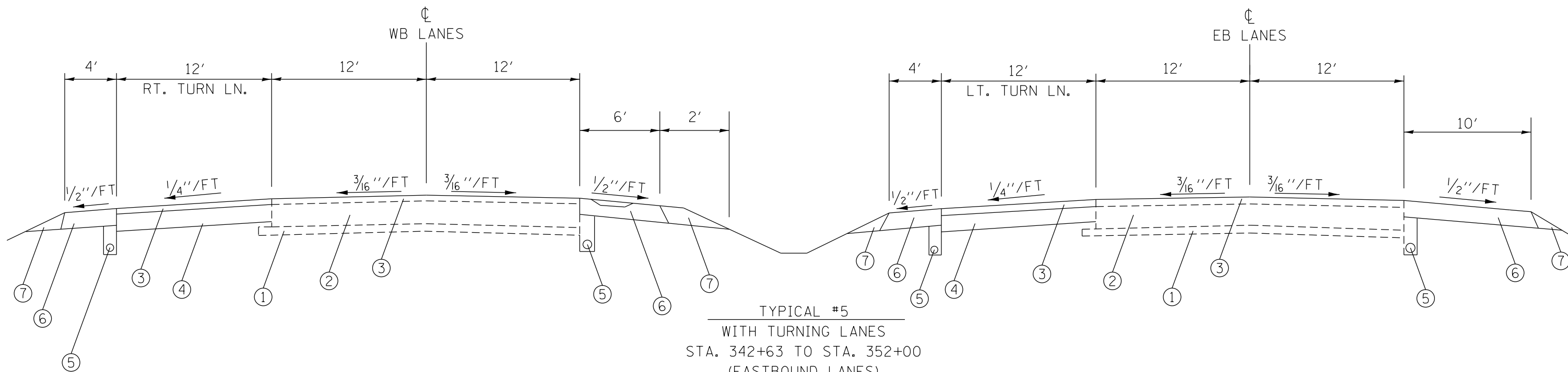

TYPICAL #5
WITH TURNING LANES
STA. 342+63 TO STA. 352+00
(EASTBOUND LANES)
STA. 346+19.67 TO STA. 353+03.46
(WESTBOUND LANES)

DRAWING NOT TO SCALE

MODEL: Default FILE: \\mspc-pw\ulb\B&E\BID\ITEC\Illinois\poc\p\WIDOT\Documents\BID\DOT_Offices\BID\Drawings\24_Typical.dgn 6/8/2018 10:52:24 AM

USER NAME = bergsieker	DESIGNED -	REVISED -
PLOT SCALE = 100.0000' / in.	DRAWN -	REVISED -
PLOT DATE = 3/28/2018	CHECKED -	REVISED -
	DATE -	REVISED -

STATE OF ILLINOIS
DEPARTMENT OF TRANSPORTATION

US 24 TYPICAL SECTIONS

SCALE: SHEET OF SHEETS STA. TO STA.

F.A.P. RTE. 673/317	SECTION (102,103;17,18)PP	COUNTY WOODFORD/TAZEWELL	TOTAL SHEETS 19	SHEET NO. 12
CONTRACT NO. 68E10			ILLINOIS FED. AID PROJECT	

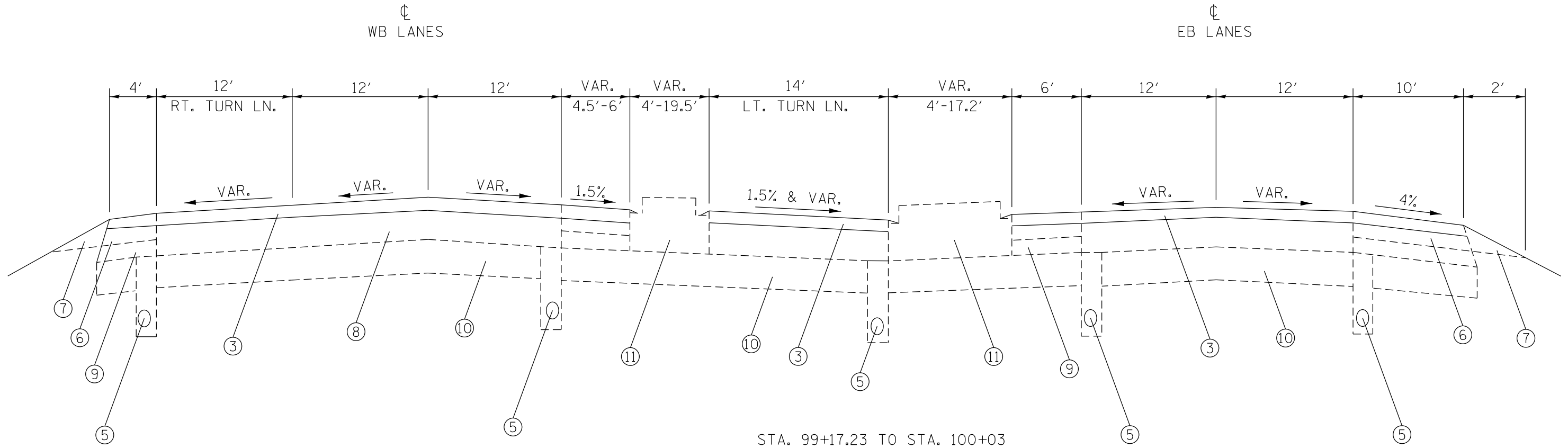

LEGEND

- | | |
|-------------------------------|---|
| ① EXIST. 4" GRANULAR SUB-BASE | ⑦ EXIST. AGG. SHOULDER |
| ② EXIST. 10" P.C.C. PAVEMENT | ⑧ EXIST. FULL DEPTH BIT. PAVEMENT (14") |
| ③ EXIST. BITUMINOUS OVERLAY | ⑨ EXIST. SUB-BASE GRANULAR MATL |
| ④ EXIST. 9" BIT. BASE COURSE | ⑩ EXIST. LIME MODIFIED SOIL |
| ⑤ EXIST. 4" PIPE UNDERDRAIN | ⑪ EXIST. CONCRETE MEDIAN |
| ⑥ EXIST. 8" BIT. SHOULDER | ⑫ EXIST. STRIP REFLEC. CRACK CONT. TREAT. |

DRAWING NOT TO SCALE

MODEL: Default
FILE: \\msc01\B68E10\DOT\Illinois\pwr\pwr\DOT\Documents\1001\DOT\Office\1001\DOT\68E10\US 24 Typical.dgn

USER NAME = bergsieker	DESIGNED -	REVISED -
PLOT SCALE = 100.0000' / in.	DRAWN -	REVISED -
PLOT DATE = 3/28/2018	CHECKED -	REVISED -
	DATE -	REVISED -

**STATE OF ILLINOIS
DEPARTMENT OF TRANSPORTATION**

US 24 TYPICAL SECTIONS

SCALE: SHEET OF SHEETS STA. TO STA.

F.A.P. RTE.	SECTION	COUNTY	TOTAL SHEETS	SHEET NO.
673/317	(102,103;17,18)PP	WOODFORD/ TAZEWELL	19	13
CONTRACT NO. 68E10				
ILLINOIS FED. AID PROJECT				

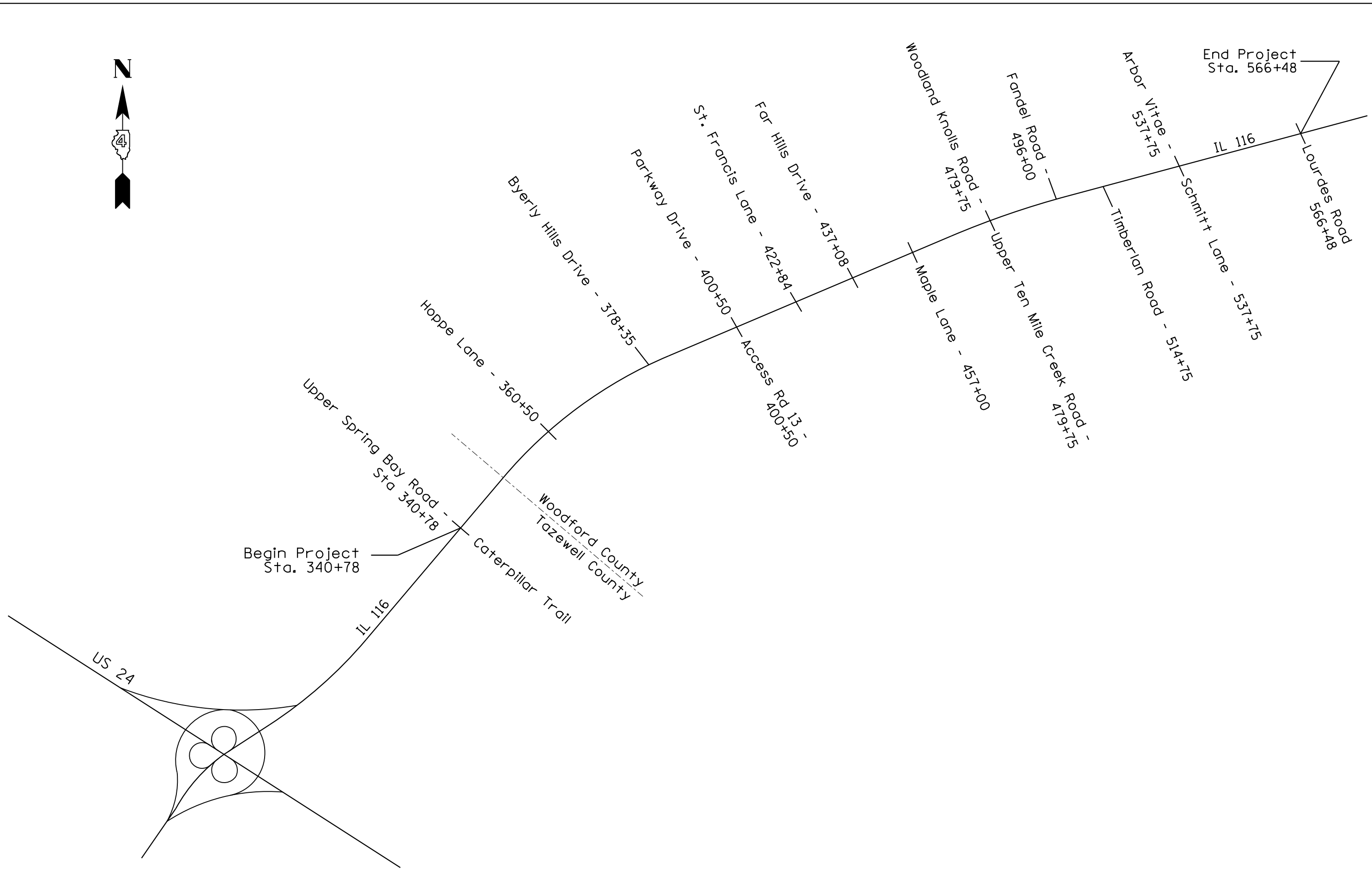

Begin Project
Sta. 340+78

End Project
Sta. 566+48

MODEL: Default
 FILE NAME: p:\116\68E10\B6E10\NTEC\Illinois\pwr\116\DOT\Documents\116DOT\Projects\Squad_68E10\Typical_Details.dgn

USER NAME = bergsieker	DESIGNED -	REVISED -
	DRAWN -	REVISED -
PLOT SCALE = 100,0000' / in.	CHECKED -	REVISED -
PLOT DATE = 3/28/2018	DATE -	REVISED -

**STATE OF ILLINOIS
DEPARTMENT OF TRANSPORTATION**

IL 116 LINE DIAGRAM

SCALE: SHEET OF SHEETS STA. TO STA.

F.A.P. RTE.	SECTION	COUNTY	TOTAL SHEETS	SHEET NO.
673/317	(102,103;17,18)PP	WOODFORD/ TAEWELL	19	14
CONTRACT NO. 68E10				
		ILLINOIS	FED. AID PROJECT	

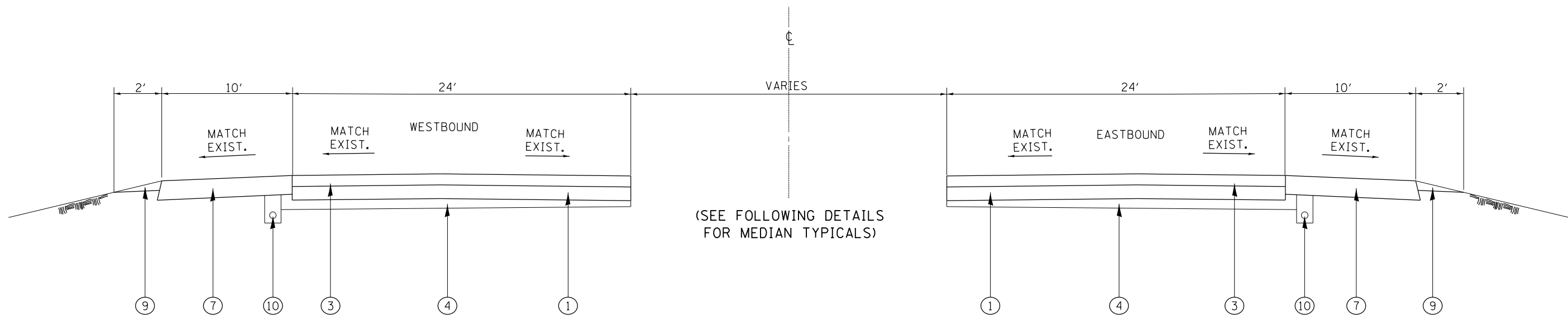

(SEE FOLLOWING DETAILS FOR MEDIAN TYPICALS)

IL 116 WB TYPICAL SECTION
 STA 340+78 TO STA 543+64
 (SEE TURN LANE TYPICALS FOR LOCATIONS)

IL 116 EB TYPICAL SECTION
 STA 340+78 TO STA 343+37
 STA 394+00 TO STA 543+64

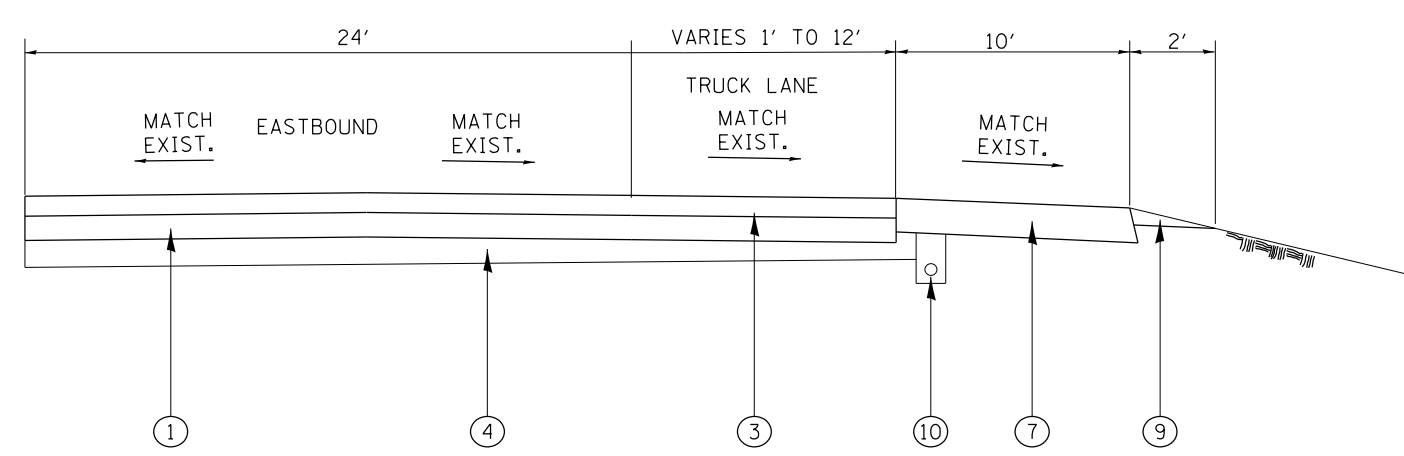

IL 116 EB TYPICAL SECTION
 STA 343+37 TO STA 394+00

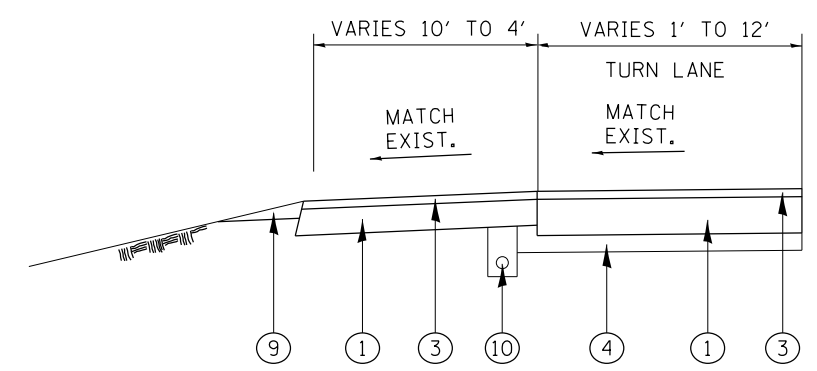

IL 116 WB TYPICAL SECTION
 STA 474+14 TO STA 478+97
 STA 490+18 TO STA 495+07
 STA 509+18 TO STA 514+00
 STA 532+06 TO STA 536+86

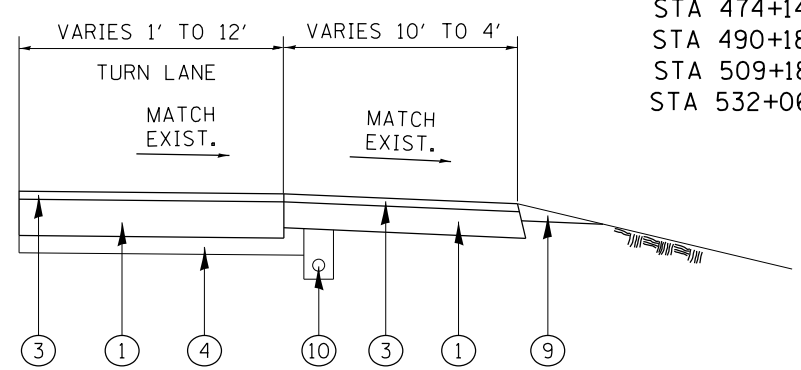

IL 116 EB TYPICAL SECTION
 STA 480+41 TO STA 485+09
 STA 496+66 TO STA 501+47
 STA 538+59 TO STA 543+40

LEGEND

- ① EXISTING PCC PAVEMENT 10"
- ② EXISTING PCC PAVEMENT 9-6-9
- ③ EXISTING BITUMINOUS OVERLAY
- ④ EXISTING SUB-BASE 4"
- ⑤ EXISTING BITUMINOUS BASE COURSE
- ⑥ EXISTING PCC BASE COURSE WIDENING 8"
- ⑦ EXISTING BITUMINOUS SHOULDERS
- ⑧ EXISTING BITUMINOUS MEDIAN
- ⑨ EXISTING AGGREGATE SHOULDERS
- ⑩ EXISTING PIPE UNDERDRAIN
- ⑪ EXISTING GUARDRAIL
- ⑫ EXISTING CONCRETE MEDIAN

DRAWINGS NOT TO SCALE

MODEL: Default
 FILE: \\nas0101\B&E\BID\TEC\Illinois\poc\p\WIDOT\Documents\BID\Office\BID\Detail\68E10\Typical\Detail.dgn

USER NAME = bergsieker	DESIGNED -	REVISED -
PLOT SCALE = 100,0000' / in.	DRAWN -	REVISED -
PLOT DATE = 3/28/2018	CHECKED -	REVISED -
	DATE -	REVISED -

STATE OF ILLINOIS
DEPARTMENT OF TRANSPORTATION

IL 116 TYPICAL SECTIONS				
SCALE:	SHEET	OF	SHEETS	STA. TO STA.

F.A.P. RTE.	SECTION	COUNTY	TOTAL SHEETS	SHEET NO.
673/317	(102,103;17,18)PP	WOODFORD/TAZEWELL	19	15
CONTRACT NO. 68E10				
ILLINOIS FED. AID PROJECT				

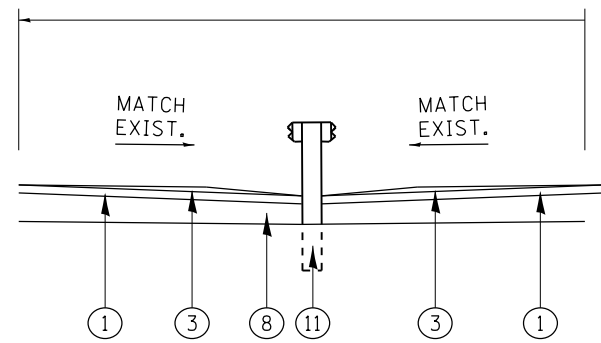

IL 116 TYPICAL SECTION
 STA 340+78 TO STA 394+75
 STA 400+26 TO STA 433+00
 STA 436+80 TO STA 474+14

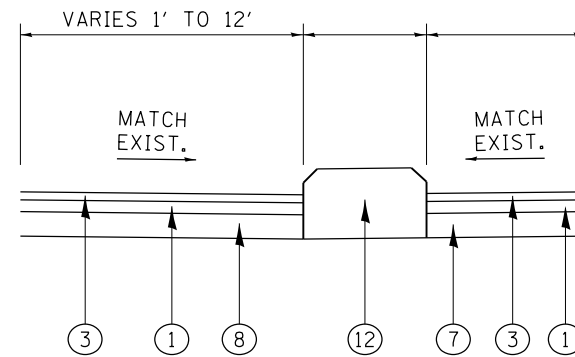

IL 116 TYPICAL SECTION
 STA 480+36 TO STA 485+19
 STA 496+50 TO STA 501+47
 STA 515+34 TO STA 520+17
 STA 538+57 TO STA 543+40

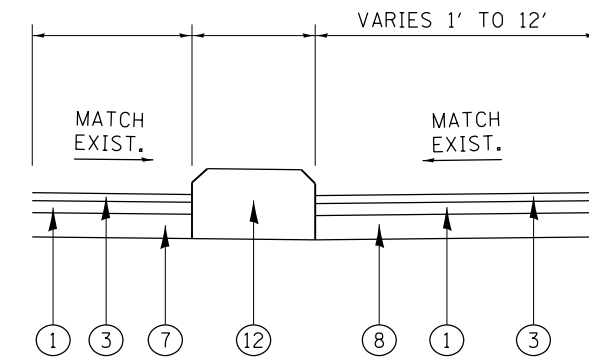

IL 116 TYPICAL SECTION
 STA 334+98 TO STA 340+47
 STA 394+75 TO STA 400+26
 STA 433+00 TO STA 436+80

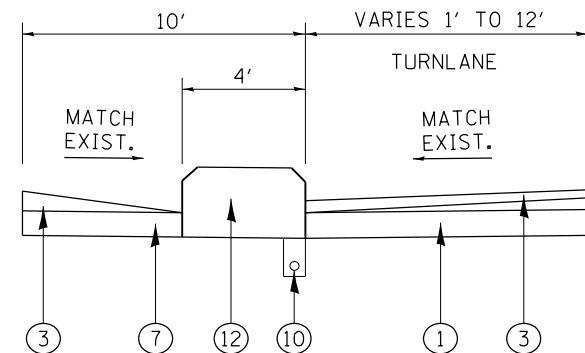

LEFT AND RIGHT TURN LANE
 STA 474+13.7 TO STA 479+05.7 (WOODLAND KNOLLS)
 STA 490+17.7 TO STA 501+47 (FANDEL ROAD)
 STA 509+17.7 TO STA 514.25.3 (TIMBERLAN ROAD)
 STA 532+06.2 TO STA 537+20.1 (ARBOR VITAE / SCHMITT)

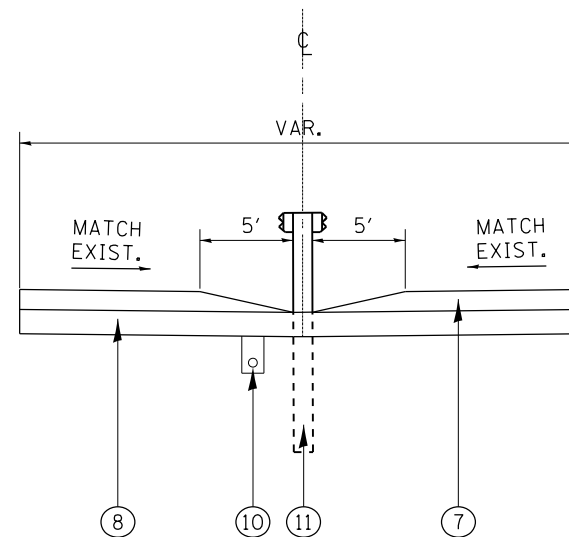

IL 116 EB & WB TYPICAL SECTION
 STA 440+81 TO STA 457+52
 STA 458+19 TO STA 474+13.7
 STA 485+18.7 TO STA 490+17.7
 STA 501+47 TO STA 509+17.7
 STA 520+17.4 TO STA 532+06.2
 STA 543+40.1 TO STA 566+40

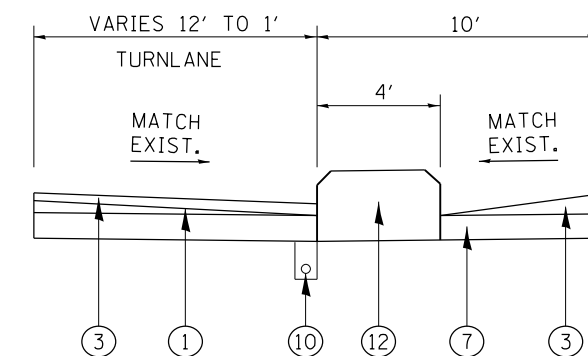

LEFT AND RIGHT TURN LANE
 STA 480+35.7 TO STA 485+18.7 (WOODLAND KNOLLS)
 STA 496+50 TO STA 501+47 (FANDEL ROAD)
 STA 515+34.4 TO STA 520+17.4 (TIMBERLAN ROAD)
 STA 538+57.1 TO STA 543+40.1 (ARBOR VITAE / SCHMITT)

LEGEND

- ① EXISTING PCC PAVEMENT 10"
- ② EXISTING PCC PAVEMENT 9-6-9
- ③ EXISTING BITUMINOUS OVERLAY
- ④ EXISTING SUB-BASE 4"
- ⑤ EXISTING BITUMINOUS BASE COURSE
- ⑥ EXISTING PCC BASE COURSE WIDENING 8"
- ⑦ EXISTING BITUMINOUS SHOULDERS
- ⑧ EXISTING BITUMINOUS MEDIAN
- ⑨ EXISTING AGGREGATE SHOULDERS
- ⑩ EXISTING PIPE UNDERDRAIN
- ⑪ EXISTING GUARDRAIL
- ⑫ EXISTING CONCRETE MEDIAN

DRAWINGS NOT TO SCALE

MODEL: Default
 FILE: \\nas01\p06\B08E10\B08E10\ITC\Illinois\p06\B08E10\DOT\Documents\B08E10\Project\SS\Draw 68E10\Typical\Detail.dgn

USER NAME = bergsjekerae	DESIGNED -	REVISED -
PLOT SCALE = 100.0000' / in.	DRAWN -	REVISED -
PLOT DATE = 3/28/2018	CHECKED -	REVISED -
	DATE -	REVISED -

**STATE OF ILLINOIS
 DEPARTMENT OF TRANSPORTATION**

IL 116 TYPICAL SECTIONS			
SCALE:	SHEET	OF SHEETS	STA. TO STA.

F.A.P. RTE.	SECTION	COUNTY	TOTAL SHEETS	SHEET NO.
673/317	(102,103;17,18)PP	WOODFORD/ TAZEWELL	19	16
CONTRACT NO. 68E10				
ILLINOIS FED. AID PROJECT				

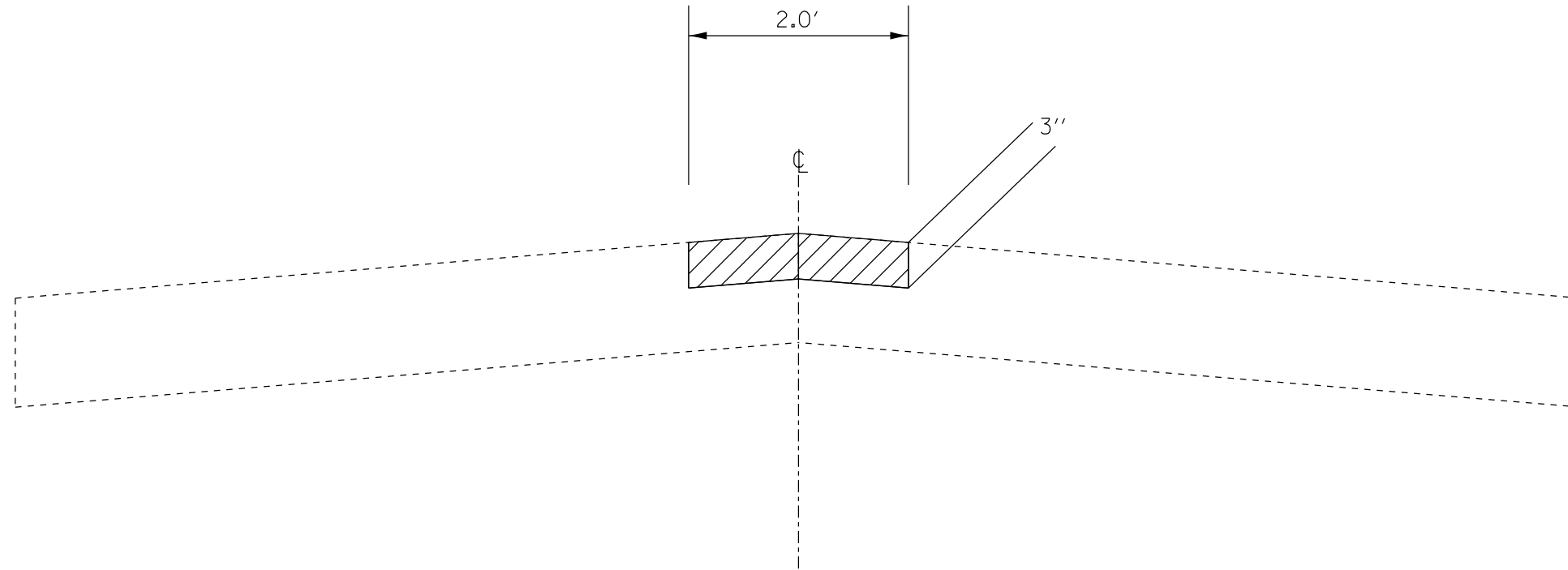

LONGITUDINAL JOINT REPAIR

NOTE:
 JOINT REPAIR LOCATION CAN BE
 ALONG CENTER LINE, EDGE OF
 PAVEMENT, OR PERPENDICULAR TO
 CENTER LINE.

MODEL: Default
 FILE NAME: p:\110808E10\NTEC\Illinois\pwr\pwr\DOT\Documents\110808E10\US 24 Typo.dgn

USER NAME = bergsieker	DESIGNED -	REVISED -
	DRAWN -	REVISED -
PLOT SCALE = 100.0000 ' / in.	CHECKED -	REVISED -
PLOT DATE = 3/28/2018	DATE -	REVISED -

**STATE OF ILLINOIS
 DEPARTMENT OF TRANSPORTATION**

LONGITUDINAL JOINT REPAIR DETAIL

SCALE: SHEET OF SHEETS STA. TO STA.

F.A.P. RTE.	SECTION	COUNTY	TOTAL SHEETS	SHEET NO.
673/317	(102,103;17,18)PP	WOODFORD/ TAEWELL	19	17
CONTRACT NO. 68E10				
ILLINOIS			FED. AID PROJECT	

DESIGNER NOTES:
1. Include State Standard 780001 (Typical Pavement Markings)

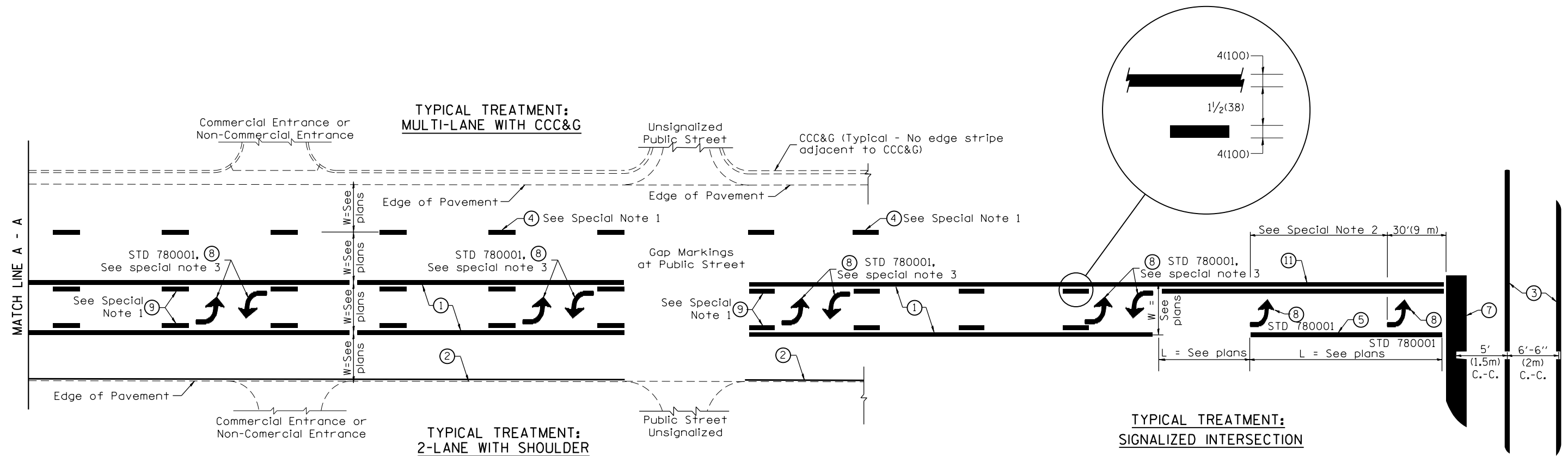

FLUSH PAVED MEDIAN: TWO-WAY LEFT TURN LANE WITH ONE-WAY LEFT TURN LANE AT SIGNALIZED INTERSECTION

TYPICAL PAVEMENT MARKING LEGEND

(Note: This is a District Standard Legend. Some elements may not apply to specific project.)

- ① 4(100) Solid (Yellow)
- ② 4(100) Solid (White)
- ③ 2-6(150) Crosswalk @ 6'-6" (2m)min C.-C. (White)
2-8(200) Crosswalk @ 6'-6" (2m)min C.-C. (White) (When traffic signals are present.)
- ④ 6(150) Skip-Dash (White) (See Special Note 1)
- ⑤ 8(200) Solid (White)
- ⑥ 12(300) Diagonal (White) (Item ⑥ is shown on Std. 780001)
- ⑦ 24(600) Stop Bar (White)
- ⑧ Letters & Arrows (See Std. 780001 and Special Notes 2 & 3)
- ⑨ 4(100) Skip-Dash (Yellow) (See Special Note 1)
- ⑩ 12(300) Diagonal (Yellow) (See Table A) ⑩
- ⑪ 4(100) Double Solid (Yellow) ⑪

SPECIAL NOTES

1. Skip-Dash markings will be centered between both ends of city blocks and shall be placed in alignment transversely across the pavement.
2. The following shall apply to arrows located in one-way left turn lanes:
 - A. A minimum of two (2) arrows is required.
 - B. The maximum spacing between arrows is 80' (24 m).
 - C. Arrows shall be evenly spaced if three (3) or more are required.
3. The following shall apply to arrow pairs located in two-way left turn lanes:
 - A. A minimum of two (2) arrow pairs is required.
 - B. The maximum spacing between arrow pairs is 200' (61 m).
 - C. Arrow pairs shall be evenly spaced if three (3) or more are required.
 - D. The spacing between Bi Directional Left Turn Arrows is 33' (10 m).

GENERAL NOTES

1. Refer to State Standard 780001 for additional Pavement Markings including letters & arrows.
2. See Plans for Pavement Markings adjacent to curbed islands and medians, and through lane reductions.
3. Refer to Article 780.13 for letter, number and symbol areas (sq. ft.)
4. Areas are grooved 1" beyond each edge for the following symbols:
Through Arrow= 14.8 sq. ft.
Large Left or Right Arrow= 21.9 sq. ft.
2 Arrow Combination Left (or Right) and Through= 34.9 sq. ft.
Wrong Way Arrow= 29.5 sq. ft.
Railroad Crossing Symbol= 69.8 sq. ft.
(For further information, refer to BDE Special Provision: Grooving for Recessed Pavement Markings)

01-01-97	RENUM. F-8.03, NEW REVISION BOX	T.P.	10-16-06	REVISED TO 2007 SPEC.	
02-07-97	ADD BI DIRECTIONAL DIMENSION	J.A.	2/29/16	ADDED GROOVING AREAS	R.D.
10-97	CORRECT BI DIRECTIONAL DIMENSION	J.A.			
08-02	ADD CROSSWALK DMNS. WITH T.S.	M.A.			

**STATE OF ILLINOIS
DEPARTMENT OF TRANSPORTATION**

NOT TO SCALE

TYPICAL PAVEMENT MARKINGS

SHT. 1 OF 2
CADD STD. 780001-D4

F.A.P. RTE.	SECTION	COUNTY	TOTAL SHEETS	SHEET NO.
673/317	(102,103;17,18)PP	WOODFORD/TAZEWELL	19	18
FED. ROAD DIST. NO. ILLINOIS FED. AID PROJECT			CONTRACT NO. 68E10	

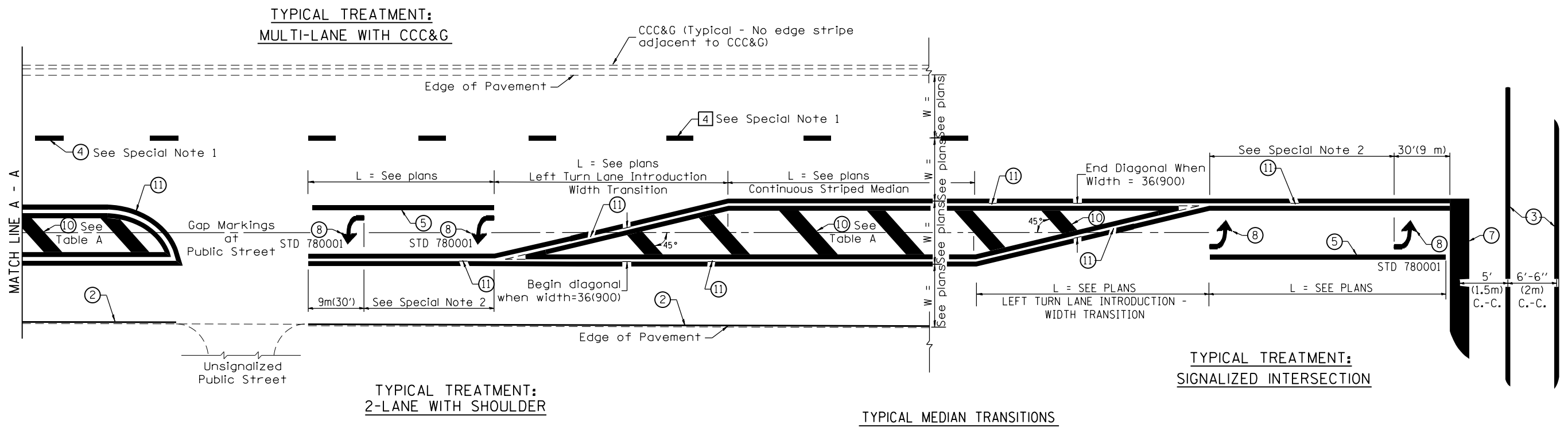

FLUSH PAVED MEDIAN: RESTRICTED LEFT TURN LANE

TABLE A
RECOMMENDED SPACING BETWEEN DIAGONAL LINES

SPEED LIMIT RANGE	INTERSECTION CHANNELIZATION (Includes Width Transitions for Median and Left Turn Lane Introductions)	
	CONTINUOUS	
Less Than 30 mph (50 km/h)	50' (15m)	15' (5m)
30 - 45 mph (50 - 70 km/h)	75' (23m)	20' (6m)
Over 45 mph (70 km/h)	150' (46m)	30' (9m)

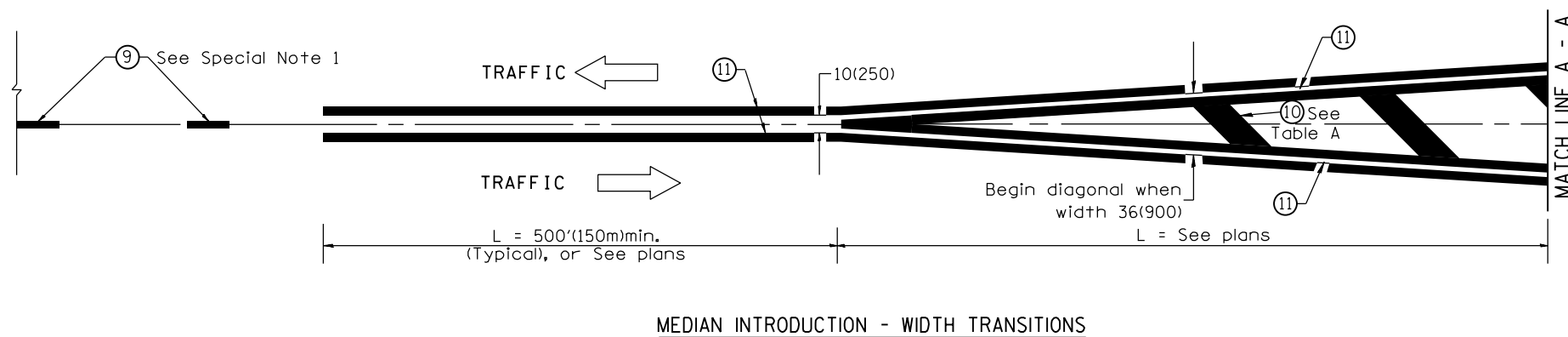

All dimensions are in inches (millimeters) unless otherwise noted.