

06-15-2018 LETTING ITEM 133

INDEX OF SHEETS

SEE SHEET 2 FOR INDEX OF SHEETS

HIGHWAY STANDARDS

SEE SHEET 2 FOR A LIST OF APPLICABLE HIGHWAY STANDARDS

PROJECT DESCRIPTION

REPLACEMENT AND INSTALLATION OF TRAFFIC SIGNAL AND HIGHWAY LIGHTING COMPONENTS AT VARIOUS LOCATIONS IN PEORIA AND TAZEWELL COUNTIES.

J.U.L.I.E. JOINT UTILITY LOCATION INFORMATION FOR EXCAVATION 1-800-892-0123 OR 811

PROJECT ENGINEER: ERIC HOWALD (309) 671-4481 PROJECT MANAGER: BEN TELLEFSON (309) 671-4477 CATALOG NO. 35627-00D CONTRACT NO. 68E39

STATE OF ILLINOIS DEPARTMENT OF TRANSPORTATION DIVISION OF HIGHWAYS PROPOSED HIGHWAY PLANS VARIOUS ROUTES SECTION (17,18)TS-2; (72-7)TS-1; 8TS-1 PEORIA-TAZEWELL COUNTIES C-94-074-18

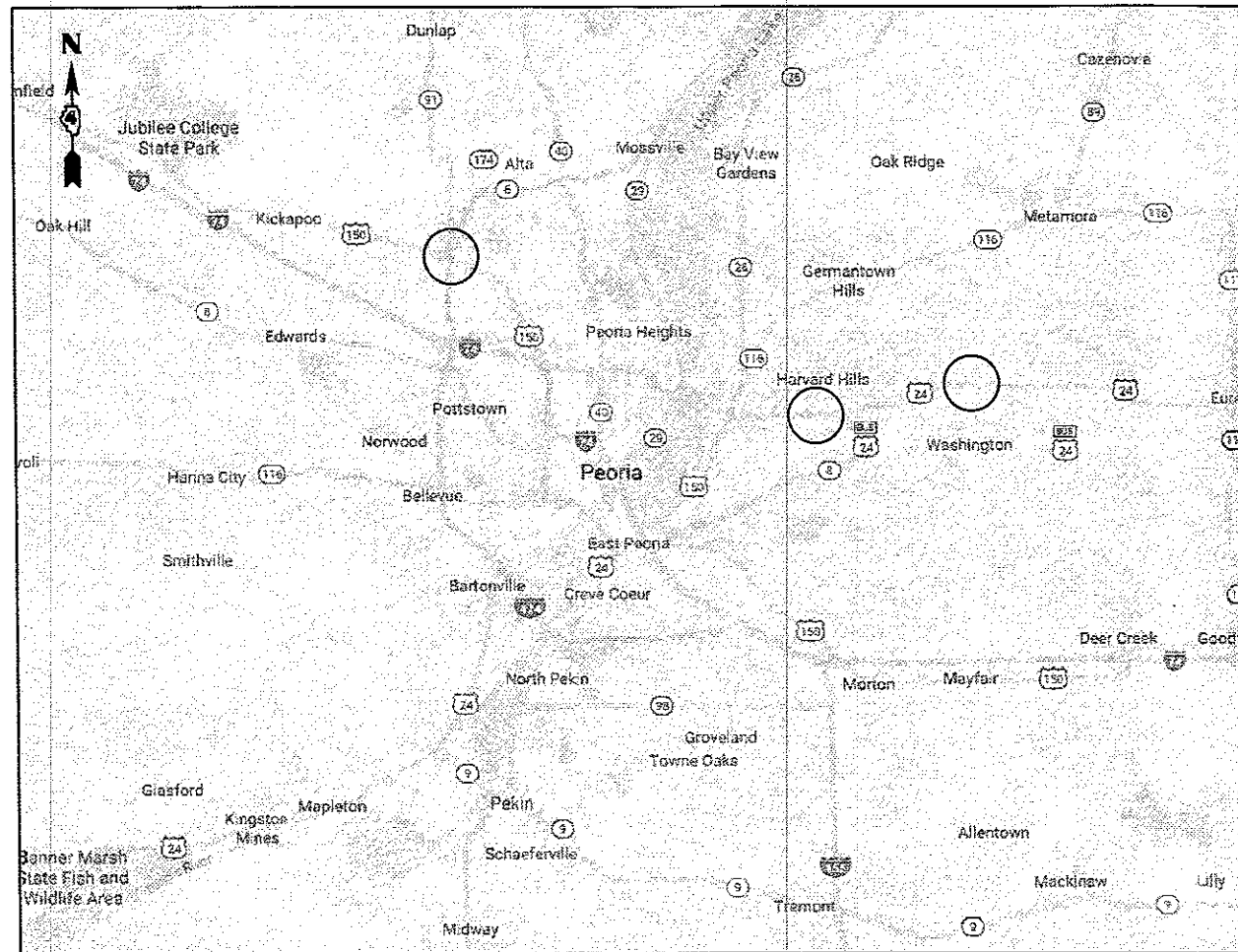
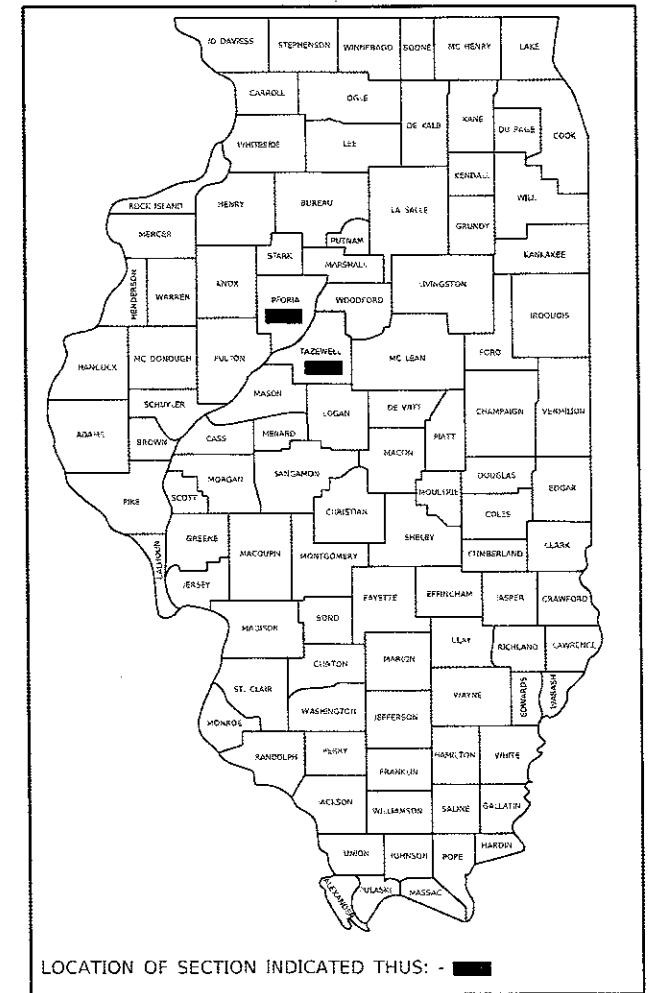

Table with 5 columns: ROUTE, SECTION, COUNTY, TOTAL SHEETS, SHEET NO. Values: VARIOUS, (17,18)TS-2;(72-7)TS-1; 8TS-1, PEORIA-TAZEWELL ILLINOIS, 24, 1

D-94-052-18



LOCATION OF SECTION INDICATED THUS: - [black box]

STATE OF ILLINOIS DEPARTMENT OF TRANSPORTATION SUBMITTED March 29 2018 [Signature] REGION THREE ENGINEER May 11 2018 [Signature] ENGINEER OF DESIGN AND ENVIRONMENT May 10 2018 [Signature] DIRECTOR OF HIGHWAYS PROJECT IMPLEMENTATION 3

PRINTED BY THE AUTHORITY OF THE STATE OF ILLINOIS

NO COMMITMENTS HAVE BEEN MADE IN CONJUNCTION WITH THIS PROJECT.

INDEX OF SHEETS	
PAGE	DESCRIPTION
1	COVER SHEET
2	COMMITMENTS, INDEX OF SHEETS, AND HIGHWAY STANDARDS
3	CONSTRUCTION NOTES
4-5	SUMMARY OF QUANTITIES
6-7	SCHEDULE OF QUANTITIES
8	PROPOSED LED LUMINAIRE & LIGHT POLE INSTALLATION DETAILS
9	PROPOSED TRAFFIC SIGNAL IMPROVEMENTS - US 24 & GRANGE RD., TAZEWELL COUNTY
10	PROPOSED TRAFFIC SIGNAL CABLE AND PHASE DIAGRAMS - US 24 & GRANGE RD., TAZEWELL COUNTY
11	PROPOSED TRAFFIC SIGNAL POST DETAILS - US 24 & GRANGE RD., TAZEWELL COUNTY
12-13	EXISTING TRAFFIC SIGNAL PLANS - US 24 & GRANGE RD., TAZEWELL COUNTY
14	PROPOSED TRAFFIC SIGNAL IMPROVEMENTS - US 24 (BOYD PKWY) & MAIN ST., TAZEWELL COUNTY
15	PROPOSED TRAFFIC SIGNAL CABLE AND PHASE DIAGRAMS - US 24 (BOYD PKWY) & MAIN ST., TAZEWELL COUNTY
16	PROPOSED TRAFFIC SIGNAL POST DETAILS - US 24 (BOYD PKWY) & MAIN ST., TAZEWELL COUNTY
17-18	LED CONVERSION AND LIGHT POLE REPLACEMENT - IL 6 & US 150 (WAR MEMORIAL DR.) INTERCHANGE, PEORIA COUNTY
19-20	EXISTING LIGHTING PLANS - IL 6 & US 150 (WAR MEMORIAL DR.) INTERCHANGE, PEORIA COUNTY
21	PROPOSED TRAFFIC SIGNAL IMPROVEMENTS - IL 29 (MARGARET ST.) & IL 9 (THIRD ST.), TAZEWELL COUNTY
22	PROPOSED TRAFFIC SIGNAL CABLE AND PHASE DIAGRAMS - IL 29 (MARGARET ST.) & IL 9 (THIRD ST.), TAZEWELL COUNTY
23	PROPOSED TRAFFIC SIGNAL POST DETAILS - IL 29 (MARGARET ST.) & IL 9 (THIRD ST.), TAZEWELL COUNTY
24	LIGHTING CONTROLLER DETAIL

HIGHWAY STANDARDS	
STANDARD	APPLICATION
001006	DECIMAL OF AN INCH AND OF A FOOT
000001-06	STANDARD SYMBOLS, ABBREVIATIONS, AND PATTERNS
701001-02	OFF-ROAD OPERATIONS, 2L, 2W, MORE THAN 15' (4.5M) AWAY
701006-05	OFF-ROAD OPERATIONS, 2L, 2W, 15' (4.5m) TO 24" (600mm) FROM PAVEMENT EDGE
701101-05	OFF-ROAD OPERATIONS, MULTILANE, 15' (4.5m) TO 24" (600mm) FROM PAVEMENT EDGE
701106-02	OFF-ROAD OPERATIONS, MULTILANE, MORE THAN 15' (4.5m) AWAY
701456-05	PARTIAL EXIT RAMP CLOSURE FREEWAY/EXPRESSWAY
701601-09	URBAN LANE CLOSURE, MULTILANE, 1W OR 2W WITH NONTRAVERSABLE MEDIAN
701701-10	URBAN LANE CLOSURE, MULTILANE INTERSECTION
701801-06	SIDEWALK, CORNER OR CROSSWALK CLOSURE
701901-07	TRAFFIC CONTROL DEVICES
805001-01	ELECTRICAL SERVICE INSTALLATION DETAILS
814001-03	HANDHOLES
814006-02	DOUBLE HANDHOLES
821101-02	LUMINAIRE WIRING IN POLE
825016-03	LIGHTING CONTROLLER PEDESTAL MOUNTED, 480V
830021-02	LIGHT POLE, STEEL, TENON TOP
838001-01	BREAKAWAY DEVICES
857001-01	STANDARD PHASE DESIGNATION DIAGRAMS AND PHASE SEQUENCE
857006-01	SUPERVISED RAILROAD INTERCONNECT CIRCUIT
862001-01	UNINTERRUPTABLE POWER SUPPLY (UPS)
873001-02	TRAFFIC SIGNAL GROUNDING AND BONDING
878001-10	CONCRETE FOUNDATION DETAILS
880006-01	TRAFFIC SIGNAL MOUNTING DETAILS
886001-01	DETECTOR LOOP INSTALLATIONS
886006-01	TYPICAL LAYOUTS FOR DETECTION LOOPS

SOURCE: ROADWORKS FILE NAME: 811115

USER NAME =	DESIGNED -	REVISED -
	DRAWN -	REVISED -
PLOT SCALE =	CHECKED -	REVISED -
PLOT DATE =	DATE -	REVISED -

STATE OF ILLINOIS
DEPARTMENT OF TRANSPORTATION

COMMITMENTS, INDEX OF SHEETS, AND HIGHWAY STANDARDS

SCALE: _____ SHEET _____ OF _____ SHEETS STA. _____ TO STA. _____

FAP ROUTE	SECTION	COUNTY	TOTAL SHEETS	SHEET NO.
VARIOUS	(17-18)TS-2; (72-7)TS-1; 8TS-1	PEORIA-TAZEWELL ILLINOIS	24	2

CONTRACT NO. 68E39

CONSTRUCTION NOTES

1. THE LOCATION OF ALL UTILITIES AND PRIVATELY OWNED FACILITIES SHALL BE FIELD VERIFIED BY THE CONTRACTOR PRIOR TO THE INSTALLATION OF ANY COMPONENTS.
2. THE CONTRACTOR SHALL BE RESPONSIBLE FOR LOCATING EXISTING IDOT ELECTRICAL FACILITIES AT HIS/HER OWN EXPENSE IF REQUIRED. THE CONTRACTOR SHALL ALSO BE LIABLE FOR ANY DAMAGE TO IDOT FACILITIES RESULTING FROM INACCURATE LOCATING.
3. ELECTRICAL WORK SHALL CONFORM WITH NATIONAL, STATE, AND LOCAL CODES.
4. THE LOCATIONS FOR HANDHOLES, TRAFFIC SIGNAL POST FOUNDATIONS, AND MAST ARM FOUNDATIONS ARE PROVIDED FOR REFERENCE ONLY. THE ENGINEER OF TRAFFIC SHALL BE NOTIFIED FOR LOCATION VERIFICATION BEFORE INSTALLATION.
5. ALL TRAFFIC SIGNAL SECTIONS SHALL HAVE 12" SINGLE LED LENSES.
6. ALL TRAFFIC SIGNAL HEAD BRACKETS ARE TO BE GALVANIZED STEEL WITH A NATURAL FINISH.
7. ALL TRAFFIC SIGNAL STRUCTURES SHALL BE BONDED IN ACCORDANCE WITH NEC REQUIREMENTS. THIS WORK SHALL BE PAID FOR AT THE CONTRACT UNIT PRICE FOR "ELECTRIC CABLE IN CONDUIT, EQUIPMENT GROUNDING CONDUCTOR, NO. 6 1C" AND SHALL INCLUDE ALL LABOR, EQUIPMENT, AND MATERIALS (INCLUDING CLAMPS, HARDWARE, ELECTRICAL CABLE, AND ALL OTHER ITEMS REQUIRED TO BOND THE STRUCTURES).
8. THE CONTRACTOR SHALL PROVIDE ELECTRICAL CABLE SLACK IN ACCORDANCE WITH ARTICLE 873.03.
9. ELECTRICAL CABLE WILL BE MEASURED FOR PAYMENT IN ACCORDANCE WITH ARTICLE 873.04.
10. POTHOLING TO LOCATE EXISTING UNDERGROUND UTILITIES SHALL BE INCLUDED IN THE CONTRACT BID PRICE FOR THE CONDUIT PAY ITEMS.
11. ALL DETECTOR LOOPS SHALL UTILIZE A SEPARATE PAIR OF TWISTED/SHIELDED LEAD-IN CABLE.
12. LEAD-IN CABLE SHALL BE CONTINUOUS FROM THE TYPE II SPLICE LOCATED IN THE HANDHOLE TO THE CONTROLLER CABINET. NO SPLICES WILL BE ALLOWED.
13. ALL DETECTOR LOOPS SHALL BE INSTALLED IN THE CENTER OF THEIR RESPECTIVE TRAVEL LANES. THE ENGINEER OF TRAFFIC SHALL BE NOTIFIED FOR VERIFICATION OF DETECTOR PLACEMENT BEFORE INSTALLATION.
14. THE PROPOSED DETECTOR LOOPS SHALL BE CUT IN THE EXISTING PAVEMENT.
15. THE REMOVAL AND REPLACEMENT OF BITUMINOUS SHOULDER FOR INSTALLATION FOR THE DETECTOR LOOP LEAD-IN AND CONDUIT SHALL BE INCLUDED IN THE COST OF THE DETECTOR LOOPS.
16. PROPOSED HANDHOLES SHALL BE CAST IN PLACE CONCRETE HANDHOLES.
17. THE HANDHOLES SHALL BE CONSTRUCTED SO THAT THE TOP OF THE FRAME WILL BE FLUSH WITH THE SURFACE OF THE SHOULDER OR GROUND LINE.
18. ALL SURPLUS MATERIALS SHALL BE DISPOSED OF IN ACCORDANCE WITH ARTICLE 202.03 OF THE STANDARD SPECIFICATIONS.
19. COILABLE POLYETHYLENE DUCT MAY BE SUBSTITUTED FOR PVC PUSHED OR TRENCHED.
20. THE TRAFFIC SIGNAL CONTROLLER SHALL BE ORIENTED SO THAT THE DOOR IS FACING AWAY FROM TRAFFIC. THE TRAFFIC SIGNAL CONTROLLER CABINET AT IL 29 & IL 9 SHALL BE LOCATED IN A POSITION TO ENSURE ADEQUATE VISIBILITY OF THE CITY OF PEKIN SIGN, WHILE MAINTAINING ADEQUATE VISIBILITY OF THE INTERSECTION FROM THE CONTROLLER CABINET.
21. NO ADDITIONAL COMPENSATION WILL BE ALLOWED FOR PLACING CONDUIT AT GREATER THAN 2 FT. MINIMUM DEPTH TO AVOID OBSTACLES SUCH AS UNDERGROUND UTILITIES.
22. THE CONTRACTOR IS RESPONSIBLE FOR THE COST OF UNCOVERING OR HAND DIGGING AROUND UTILITIES AS NECESSARY. THIS COST OF THIS WORK SHALL BE INCLUDED IN THE UNIT PRICES FOR THE CONDUITS.
23. THE CONTRACTOR SHALL VERIFY FIELD CONDITIONS PRIOR TO BIDDING. THERE WILL BE NO ADDITIONAL COMPENSATION PAID FOR CLAIMS THAT ARISE FROM A FAILURE TO FULLY INVESTIGATE EXISTING FIELD CONDITIONS.
24. REMOVAL OF EXISTING ITEMS (LIGHT POLES, LUMINAIRES, WIRING, ETC.) WILL NOT BE PAID FOR SEPARATELY, BUT SHALL BE INCLUDED IN THE UNIT BID PRICES FOR THE PROPOSED ITEMS.
25. THE CONTRACTOR SHALL COORDINATE WORK DONE FOR THIS CONTRACT WITH WORK DONE FOR IDOT CONTRACTS 68D09 AND 68E10.
26. THE CONTRACTOR SHALL COORDINATE THE RELOCATION OF THE TRAFFIC SIGNAL CABINET WITH THE RAILROAD.
27. THE CONTRACTOR SHALL FURNISH AND INSTALL NEW FUSEHOLDERS, FUSES, SURGE ARRESTORS, AND LUMINAIRE WIRING INSIDE THE POLE. THE COST OF THIS WORK SHALL BE INCLUDED IN THE PRICE OF THE PROPOSED LUMINAIRES.
28. THE CONTRACTOR SHALL DISPOSE OF THE EXISTING LUMINAIRES AND LIGHT POLES OFF THE JOB SITE. THE SALVAGE COST OF THESE ITEMS SHALL BE INCLUDED IN THE BID PRICES FOR THESE ITEMS.

MODEL: Default
FILE NAME: O:\DAGEN\WIKOR\DESIGN\AN\ANSOR\68E39_P18_Contract_Maintenance_P18_FINAL_03-29-19.dgn

USER NAME =	DESIGNED - _____	REVISED - _____
PLOT SCALE =	DRAWN - _____	REVISED - _____
PLOT DATE =	CHECKED - _____	REVISED - _____
	DATE - _____	REVISED - _____

**STATE OF ILLINOIS
DEPARTMENT OF TRANSPORTATION**

CONSTRUCTION NOTES

SCALE: _____ SHEET _____ OF _____ SHEETS STA. _____ TO STA. _____

FAP ROUTE	SECTION	COUNTY	TOTAL SHEETS	SHEET NO.
VARIOUS	(17-18)TS-2; (72-7)TS-1; 8TS-1	PEORIA-TAZEWELL ILLINOIS	24	3
CONTRACT NO. 68E39				

SUMMARY OF QUANTITIES

CODE	ITEM DESCRIPTION	UNIT	TOTAL QTY.	PEORIA COUNTY	TAZEWELL COUNTY	
				CONST. TYPE CODE 0021 100% STATE 0% CITY OVERHEAD LIGHTING URBAN	CONST. TYPE CODE 0021 100% STATE 0% CITY SIGNALS PEKIN URBAN	CONST. TYPE CODE 0021 100% STATE 0% CITY SIGNALS AND LIGHTING URBAN
67100100	MOBILIZATION	LSUM	1.0	0.4	0.2	0.4
72000100	SIGN PANEL - TYPE 1	SQ FT	10.0		10.0	
81028350	UNDERGROUND CONDUIT, PVC, 2" DIA.	FOOT	247.0			247.0
81028370	UNDERGROUND CONDUIT, PVC, 3" DIA.	FOOT	69.0		69.0	
81400700	HANDHOLE, PORTLAND CEMENT CONCRETE	EACH	1.0			1.0
81400720	DOUBLE HANDHOLE, PORTLAND CEMENT CONCRETE	EACH	1.0		1.0	
81702130	ELECTRIC CABLE IN CONDUIT, 600V (XLP-TYPE USE) 1/C NO. 6	FOOT	530.0			530.0
82500340	LIGHTING CONTROLLER, PEDESTAL MOUNTED, 480VOLT, 60AMP	EACH	1.0	1.0		
83060830	LIGHT POLE, GALVANIZED STEEL, 45 FT. M.H., TENON MOUNT	EACH	6.0	6.0		
83800205	BREAKAWAY DEVICE, TRANSFORMER BASE, 15 INCH BOLT CIRCLE	EACH	6.0	6.0		
87301245	ELECTRIC CABLE IN CONDUIT, SIGNAL NO. 14 5C	FOOT	988.0		535.5	452.5
87301255	ELECTRIC CABLE IN CONDUIT, SIGNAL NO. 14 7C	FOOT	2787.0		704.0	2083.0
87301515	ELECTRIC CABLE IN CONDUIT, LEAD-IN, NO. 18 3 PAIR	FOOT	553.0			553.0
87301750	ELECTRIC CABLE IN CONDUIT, RAILROAD, NO. 14 3C	FOOT	204.0		204.0	
87301900	ELECTRIC CABLE IN CONDUIT, EQUIPMENT GROUNDING CONDUCTOR, NO. 6 1C	FOOT	603.0		265.0	338.0
87502500	TRAFFIC SIGNAL POST, GALVANIZED STEEL 16 FT.	EACH	4.0			4.0

MODEL: Default
 FILE NAME: C:\PROGRAMS\WORD\DESIGN\PEORIA\CONTRACT MAINTENANCE\68E39.D4 Contract Maintenance FY18 (FINAL) 03-29-18.dgn

16

USER NAME = _____	DESIGNED - _____	REVISED - _____
PLOT SCALE = _____	DRAWN - _____	REVISED - _____
PLOT DATE = _____	CHECKED - _____	REVISED - _____
	DATE - _____	REVISED - _____

**STATE OF ILLINOIS
DEPARTMENT OF TRANSPORTATION**

SUMMARY OF QUANTITIES

SCALE: _____ SHEET _____ OF _____ SHEETS STA. _____ TO STA. _____

FAP ROUTE	SECTION	COUNTY	TOTAL SHEETS	SHEET NO.
VARIOUS	(17-18)TS-2; (72-7)TS-1; 8TS-1	PEORIA-TAZEWELL ILLINOIS	24	4

CONTRACT NO. 68E39

SUMMARY OF QUANTITIES

				PEORIA COUNTY	TAZEWELL COUNTY	
				CONST. TYPE CODE 0021 100% STATE 0% CITY OVERHEAD LIGHTING URBAN	CONST. TYPE CODE 0021 100% STATE 0% CITY SIGNALS PEKIN URBAN	CONST. TYPE CODE 0021 100% STATE 0% CITY SIGNALS AND LIGHTING URBAN
CODE	ITEM DESCRIPTION	UNIT	TOTAL QTY.			
87800100	CONCRETE FOUNDATION, TYPE A	FOOT	18.0		6.0	12.0
87900200	DRILL EXISTING HANDHOLE	EACH	4.0		1.0	3.0
88040090	SIGNAL HEAD, POLYCARBONATE, LED, 1-FACE, 3-SECTION, MAST ARM MOUNTED	EACH	5.0		5.0	
88040110	SIGNAL HEAD, POLYCARBONATE, LED, 1-FACE, 4-SECTION, BRACKET MOUNTED	EACH	6.0			6.0
88040120	SIGNAL HEAD, POLYCARBONATE, LED, 1-FACE, 4-SECTION, MAST ARM MOUNTED	EACH	2.0			2.0
88200510	TRAFFIC SIGNAL BACKPLATE, RETROREFLECTIVE	EACH	16.0		5.0	11.0
88500100	INDUCTIVE LOOP DETECTOR	EACH	2.0			2.0
88600100	DETECTOR LOOP, TYPE I	FOOT	284.0			284.0
89500100	RELOCATE EXISTING SIGNAL HEAD	EACH	2.0			2.0
89502200	MODIFY EXISTING CONTROLLER	EACH	1.0			1.0
89502210	MODIFY EXISTING CONTROLLER CABINET	EACH	1.0			1.0
X1400113	LUMINAIRE, LED, HORIZONTAL MOUNT, MEDIUM WATTAGE	EACH	22.0	14.0		8.0
X4402815	ISLAND PAVEMENT REMOVAL AND REPLACEMENT	SQ FT	41.0		41.0	
X7010216	TRAFFIC CONTROL AND PROTECTION, (SPECIAL)	LSUM	1.0	0.4	0.2	0.4
X8950224	RELOCATE CONTROLLER CABINET	EACH	1.0		1.0	
Z0048665	RAILROAD PROTECTIVE LIABILITY INSURANCE	LSUM	1.0		1.0	

MODEL: Default
 FILE NAME: D:\WORK\WINWORD\DESIGN\HARRISON\68E39_FY18_Contract_Maintenance\68E39_FY18_Contract_Maintenance_FY18_FINAL_03-29-18.dgn

16

USER NAME -	DESIGNED -	REVISED -
PLOT SCALE -	CHECKED -	REVISED -
PLOT DATE -	DATE -	REVISED -

**STATE OF ILLINOIS
DEPARTMENT OF TRANSPORTATION**

SUMMARY OF QUANTITIES (CONTINUED)

SCALE: _____ SHEET _____ OF _____ SHEETS STA. _____ TO STA. _____

FAP ROUTE	SECTION	COUNTY	TOTAL SHEETS	SHEET NO.
VARIOUS	(17-18)TS-2; (72-7)TS-1; 8TS-1	PEORIA-TAZEWELL ILLINOIS	24	5
CONTRACT NO. 68E39				

SCHEDULE OF QUANTITIES			US 24 & GRANGE ROAD	US 24 & MAIN ST	US 150 & IL 6	IL 29 (THIRD) & IL 9 (MARGARET)
ITEM DESCRIPTION	UNIT	TOTAL QTY.				
MOBILIZATION	LSUM	1.0	0.2	0.2	0.4	0.2
SIGN PANEL - TYPE 1	SQ FT	10.0				10.0
UNDERGROUND CONDUIT, PVC, 2" DIA.	FOOT	247.0	247.0			
UNDERGROUND CONDUIT, PVC, 3" DIA.	FOOT	69.0				69.0
HANDHOLE, PORTLAND CEMENT CONCRETE	EACH	1.0	1.0			
DOUBLE HANDHOLE, PORTLAND CEMENT CONCRETE	EACH	1.0				1.0
ELECTRIC CABLE IN CONDUIT, 600V (XLP-TYPE USE) 1/C NO. 6	FOOT	530.0				530.0
LIGHTING CONTROLLER, PEDESTAL MOUNTED, 480VOLT, 60AMP	EACH	1.0			1.0	
LIGHT POLE, GALVANIZED STEEL, 45 FT. M.H., TENON MOUNT	EACH	6.0			6.0	
BREAKAWAY DEVICE, TRANSFORMER BASE, 15 INCH BOLT CIRCLE	EACH	6.0			6.0	
ELECTRIC CABLE IN CONDUIT, SIGNAL NO. 14 5C	FOOT	988.0		452.5		535.5
ELECTRIC CABLE IN CONDUIT, SIGNAL NO. 14 7C	FOOT	2787.0	1088.0	995.0		704.0
ELECTRIC CABLE IN CONDUIT, LEAD-IN, NO. 18 3 PAIR	FOOT	553.0	553.0			
ELECTRIC CABLE IN CONDUIT, RAILROAD, NO. 14 3C	FOOT	204.0				204.0
ELECTRIC CABLE IN CONDUIT, EQUIPMENT GROUNDING CONDUCTOR, NO. 6 1C	FOOT	603.0	338.0			265.0
TRAFFIC SIGNAL POST, GALVANIZED STEEL 16 FT.	EACH	4.0	4.0			

MODEL: D:\m\h\ FILE NAME: C:\P\CEIN\W\WOD\DESIGN\HANSO\68E39_FY18_Contract_Maintenance\FY18_FINAL_03-29-18.dgn

USER NAME =	DESIGNED - _____	REVISED - _____
	DRAWN - _____	REVISED - _____
PLOT SCALE =	CHECKED - _____	REVISED - _____
PLOT DATE =	DATE - _____	REVISED - _____

**STATE OF ILLINOIS
DEPARTMENT OF TRANSPORTATION**

SCHEDULE OF QUANTITIES

SCALE: _____ SHEET _____ OF _____ SHEETS STA. _____ TO STA. _____

FAP ROUTE	SECTION	COUNTY	TOTAL SHEETS	SHEET NO.
VARIOUS	(17-18)TS-2; (72-7)TS-1; 8TS-1	PEORIA-TAZEWELL ILLINOIS	24	6
CONTRACT NO. 68E39				

SCHEDULE OF QUANTITIES

ITEM DESCRIPTION	UNIT	TOTAL QTY.	US 24 & GRANGE ROAD	US 24 & MAIN ST	US 150 & IL 6	IL 29 (THIRD) & IL 9 (MARGARET)
CONCRETE FOUNDATION, TYPE A	FOOT	18.0	12.0			6.0
DRILL EXISTING HANDHOLE	EACH	4.0	3.0			1.0
SIGNAL HEAD, POLYCARBONATE, LED, 1-FACE, 3-SECTION, MAST ARM MOUNTED	EACH	5.0				5.0
SIGNAL HEAD, POLYCARBONATE, LED, 1-FACE, 4-SECTION, BRACKET MOUNTED	EACH	6.0	4.0	2.0		
SIGNAL HEAD, POLYCARBONATE, LED, 1-FACE, 4-SECTION, MAST ARM MOUNTED	EACH	2.0		2.0		
TRAFFIC SIGNAL BACKPLATE, RETROREFLECTIVE	EACH	16.0	4.0	7.0		5.0
INDUCTIVE LOOP DETECTOR	EACH	2.0	2.0			
DETECTOR LOOP, TYPE I	FOOT	284.0	284.0			
RELOCATE EXISTING SIGNAL HEAD	EACH	2.0		2.0		
MODIFY EXISTING CONTROLLER	EACH	1.0	1.0			
MODIFY EXISTING CONTROLLER CABINET	EACH	1.0		1.0		
LUMINAIRE, LED, HORIZONTAL MOUNT, MEDIUM WATTAGE	EACH	22.0	4.0	4.0	14.0	
ISLAND PAVEMENT REMOVAL AND REPLACEMENT	SQ FT	41.0				41.0
TRAFFIC CONTROL AND PROTECTION, (SPECIAL)	LSUM	1.0	0.2	0.2	0.4	0.2
RELOCATE CONTROLLER CABINET	EACH	1.0				1.0
RAILROAD PROTECTIVE LIABILITY INSURANCE	LSUM	1.0				1.0

MODEL: D:\m\h\l
 FILE NAME: C:\PROJECTS\WV\WV01\DESIGN\PLAN\HARRISON\68E39_FY18_Contract_Maintenance\FY18 (FINAL_03-29-18).dgn

USER NAME =	DESIGNED - _____	REVISED - _____
	DRAWN - _____	REVISED - _____
PLOT SCALE =	CHECKED - _____	REVISED - _____
PLOT DATE =	DATE - _____	REVISED - _____

**STATE OF ILLINOIS
DEPARTMENT OF TRANSPORTATION**

SCHEDULE OF QUANTITIES (CONTINUED)

SCALE: _____ SHEET ___ OF ___ SHEETS STA. _____ TO STA. _____

FAP ROUTE	SECTION	COUNTY	TOTAL SHEETS	SHEET NO.
VARIOUS	(17-18)TS-2; (72-7)TS-1; 8TS-1	PEORIA-TAZEWELL ILLINOIS	24	7

CONTRACT NO. 68E39

PROPOSED LED LUMINAIRE INSTALLATION DETAILS

ROUTE	LOCATION	EX. LUMINAIRE MOUNTING HEIGHT	LUMINAIRE ARM LENGTH	EX. LUMINAIRE TYPE AND WATTAGE	EX. LUMINAIRE VOLTAGE	PROP. LUMINAIRE TYPE	PROP. LUMINAIRE QTY.	NOTES	TRAFFIC CONTROL NOTES
US 24	INTERSECTION OF US 24 & GRANGE ROAD	45 FT. (MAST ARM)	TENON MOUNT	HPS, 250W	240V	LED, MEDIUM WATTAGE	4	INSTALL NEW LUMINAIRE WIRING, ARRESTORS, FUSES, AND FUSEHOLDERS.	HIGHWAY STANDARD 701701
US 24	INTERSECTION OF US 24 & N. MAIN STREET	45 FT. (MAST ARM)	TENON MOUNT	HPS, 250W	240V	LED, MEDIUM WATTAGE	4	INSTALL NEW LUMINAIRE WIRING, ARRESTORS, FUSES, AND FUSEHOLDERS.	HIGHWAY STANDARD 701701
IL 6 & US 150	IL 6 & US 150 INTERCHANGE	45 FT. (POLES)	TENON MOUNT	HPS, 250W	480V	LED, MEDIUM WATTAGE	8	INSTALL NEW LUMINAIRE WIRING, ARRESTORS, FUSES, AND FUSEHOLDERS.	HIGHWAY STANDARDS 701701 AND 701456 FOR RAMPS
IL 6 & US 150	IL 6 & US 150 INTERCHANGE	45 FT. (MAST ARM)	12 FT. (HORIZONTAL MOUNT)	HPS, 250W	480V	LED, MEDIUM WATTAGE	6	INSTALL NEW LUMINAIRE WIRING, ARRESTORS, FUSES, AND FUSEHOLDERS.	HIGHWAY STANDARDS 701701

PROPOSED LIGHT POLE INSTALLATION DETAILS

ROUTE	LOCATION	EX. LIGHT POLE MOUNTING HEIGHT	EX. LIGHT POLE TYPE	PROP. LIGHT POLE MOUNTING HEIGHT	PROP. LIGHT POLE TYPE	PROP. LIGHT POLE QTY.	NOTES	TRAFFIC CONTROL NOTES
IL 6 & US 150	IL 6 & US 150 INTERCHANGE	45 FT.	ALUMINUM, TENON MOUNT	45 FT.	GALVANIZED STEEL, TENON MOUNT	6	INSTALL PROPOSED LIGHT POLE AND TRANSFORMER BASE ON EXISTING FOUNDATION. IN TOTAL SIX LIGHT POLE ASSEMBLIES ARE TO BE REPLACED: TWO ON THE IL 6 NB EXIT RAMP AND FOUR ON THE IL 6 SB EXIT RAMP.	HIGHWAY STANDARDS 701701 AND 701456 FOR RAMPS

THE CONTRACTOR SHALL BE RESPONSIBLE FOR VERIFYING THE EXISTING LIGHT POLE FOUNDATION ANCHOR BOLT DIAMETER AND BOLT CIRCLE PRIOR TO SUBMITTING CATALOG CUT SHEETS.

THE CONTRACTOR SHALL BE RESPONSIBLE FOR VERIFYING THE EXISTING LUMINAIRE VOLTAGES PRIOR TO SUBMITTING CATALOG CUT SHEETS.

MODEL: D:\m\h\ FILE NAME: C:\P\CEIN\W\W\DD\DESP\AN\Hanson\68E39_FY18_Contract_Maintenance\FY18_FINAL_03-29-18.dgn

USER NAME =	DESIGNED - _____	REVISED - _____
	DRAWN - _____	REVISED - _____
PLOT SCALE =	CHECKED - _____	REVISED - _____
PLOT DATE =	DATE - _____	REVISED - _____

**STATE OF ILLINOIS
DEPARTMENT OF TRANSPORTATION**

PROPOSED LED LUMINAIRE & LIGHT POLE INSTALLATION DETAILS

SCALE: _____ SHEET ____ OF ____ SHEETS STA. _____ TO STA. _____

FAP ROUTE	SECTION	COUNTY	TOTAL SHEETS	SHEET NO.
VARIOUS	(17-18)TS-2; (72-7)TS-1; 8TS-1	PEORIA-TAZEWELL ILLINOIS	24	8

CONTRACT NO. 68E39

TRAFFIC SIGNAL MAST ARM AND POST SCHEDULE			
REF	LOCATION	TYPE	LENGTH(S)
TS-1	NE QUADRANT	TS POST GALV S	16 FT.
TS-2	CENTER MEDIAN (EAST)	TS POST GALV S	16 FT.
TS-3	SW QUADRANT	TS POST GALV S	16 FT.
TS-4	CENTER MEDIAN (WEST)	TS POST GALV S	16 FT.

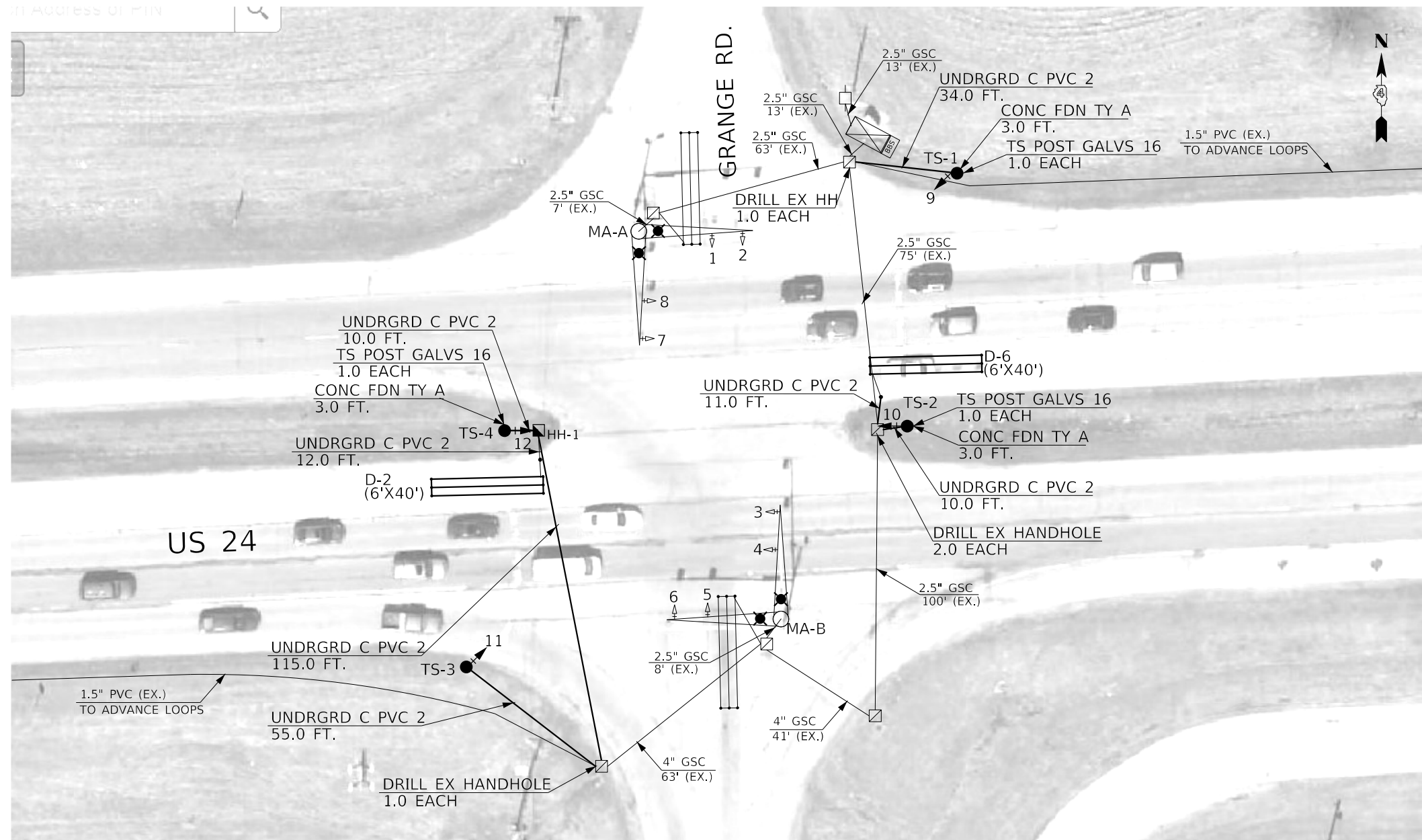

BILL OF MATERIALS		
ITEM DESCRIPTION	UNIT	QUANTITY
SIGN PANEL - TYPE 1	SQ FT	10.0
UNDERGROUND CONDUIT, PVC, 2" DIA.	FOOT	247.0
HANDHOLE, PORTLAND CEMENT CONCRETE	EACH	1.0
ELECTRIC CABLE IN CONDUIT, SIGNAL NO. 14 7C	FOOT	1088.0
ELECTRIC CABLE IN CONDUIT, LEAD-IN, NO. 18 3 PAIR	FOOT	553.0
ELECTRIC CABLE IN CONDUIT, EQUIPMENT GROUNDING CONDUCTOR, NO. 6 1C	FOOT	338.0
TRAFFIC SIGNAL POST, GALVANIZED STEEL 16 FT.	EACH	4.0
CONCRETE FOUNDATION, TYPE A	FOOT	12.0
DRILL EXISTING HANDHOLE	EACH	4.0
SIGNAL HEAD, POLYCARBONATE, LED, 1-FACE, 4-SECTION, BRACKET MOUNTED	EACH	4.0
TRAFFIC SIGNAL BACKPLATE, RETROREFLECTIVE	EACH	4.0
INDUCTIVE LOOP DETECTOR	EACH	2.0
DETECTOR LOOP, TYPE I	FOOT	284.0
LUMINAIRE, LED, HORIZONTAL MOUNT, MEDIUM WATTAGE	EACH	4.0
MODIFY EXISTING CONTROLLER	EACH	1.0

TRAFFIC SIGNAL LEGEND

- PROP. HANDHOLE
- PROP. LUMINAIRE, LED
- PROP. QUADRAPOLE LOOP
- PROP. CONDUIT
- PROP. TRAFFIC SIGNAL HEAD W/ BACKPLATE
- PROP. TRAFFIC SIGNAL POST
- EX. QUADRAPOLE LOOP
- EX. TRAFFIC SIGNAL HEAD W/ BACKPLATE
- EX. STL COMB MAST ARM ASSEMBLY
- EX. CONTROLLER CABINET (SIGNAL)
- EX. ELECTRICAL SERVICE
- EX. BBS AND CABINET

DETECTOR LOOP AND DETECTOR ASSIGNMENT SCHEDULE US 24 & GRANGE ROAD					
LOOP	TYPE	DETECTOR LOOP, TYPE 1 QTY.	LEAD-IN	ASSIGNED PHASE	INDUCTIVE LOOP AMPLIFIER
D-1	6' X 40' (QUAD)	132	10	1	1
D-5	6' X 40' (QUAD)	132	10	5	1
TOTAL:		264	20		2

TRAFFIC SIGNAL HEAD SCHEDULE			
QTY.	UNIT	ITEM	LOCATION
4.0	EACH	SH P LED 1F 4S BM	9,10,11,12 (PROPOSED)
4.0	EACH	TS BACKPLATE RET-REFL	9,10,11,12 (PROPOSED)

HANDHOLE SCHEDULE		
REF	LOCATION	TYPE
HH-1	CENTER MEDIAN (WEST)	STANDARD

NOT TO SCALE

MODEL: D:\m\h\... FILE NAME: C:\PROJECTS\... CONTRACT: MAINTENANCE FY18 (FINAL_03-29-18).dgn

USER NAME =	DESIGNED -	REVISED -
PLOT SCALE =	DRAWN -	REVISED -
PLOT DATE =	CHECKED -	REVISED -
	DATE -	REVISED -

STATE OF ILLINOIS
DEPARTMENT OF TRANSPORTATION

PROPOSED TRAFFIC SIGNAL IMPROVEMENTS
US 24 & GRANGE ROAD - TAZEWELL COUNTY

FAP ROUTE	SECTION	COUNTY	TOTAL SHEETS	SHEET NO.
VARIOUS	(17-18)TS-2; (72-7)TS-1; 8TS-1	PEORIA-TAZEWELL ILLINOIS	24	9

SCALE: _____ SHEET _____ OF _____ SHEETS STA. _____ TO STA. _____

CONTRACT NO. 68E39

MODEL: D:\m\h\...
 FILE NAME: C:\P\CEIN\W\W\DD\DESP\AN\Hanson\68E39_D4 Contract Maintenance FY18 (FINAL_03-29-18).dgn

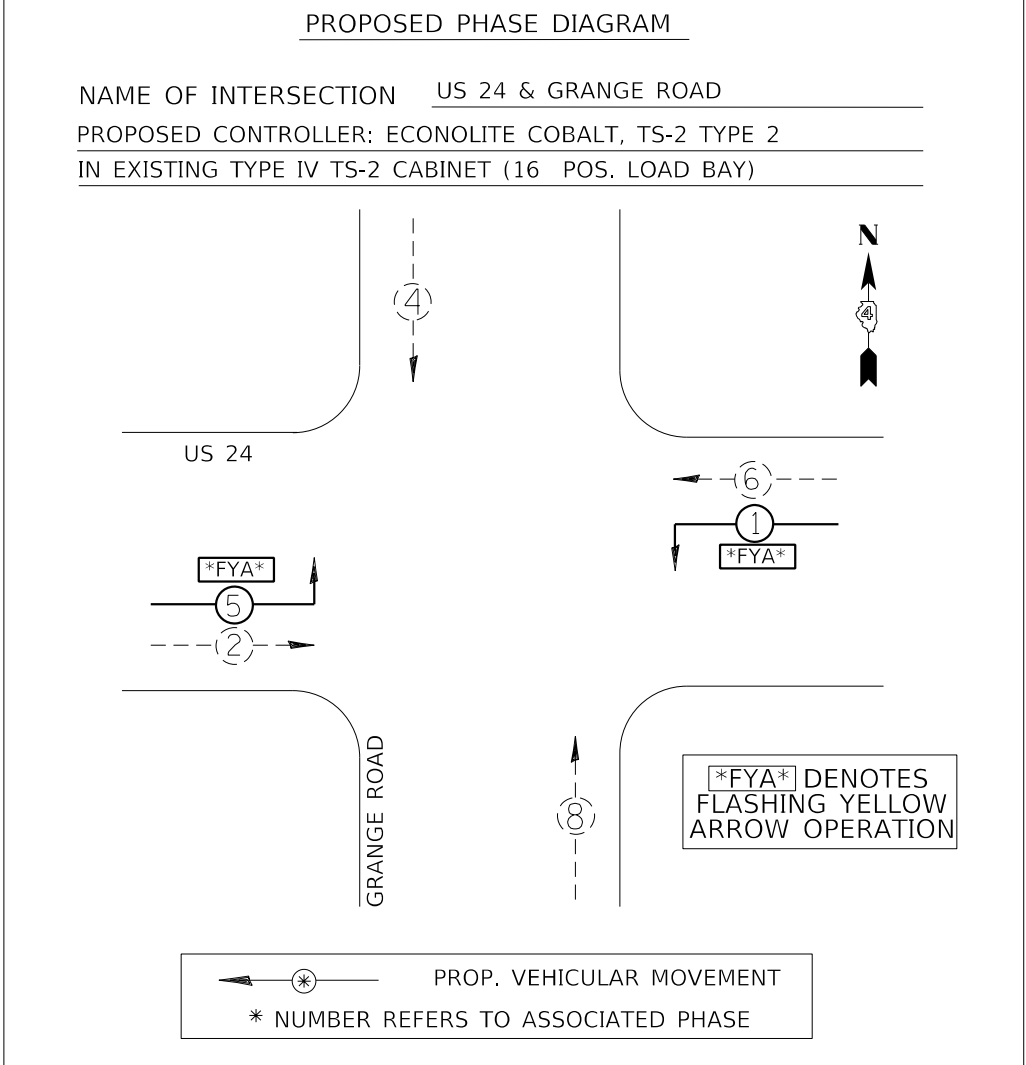
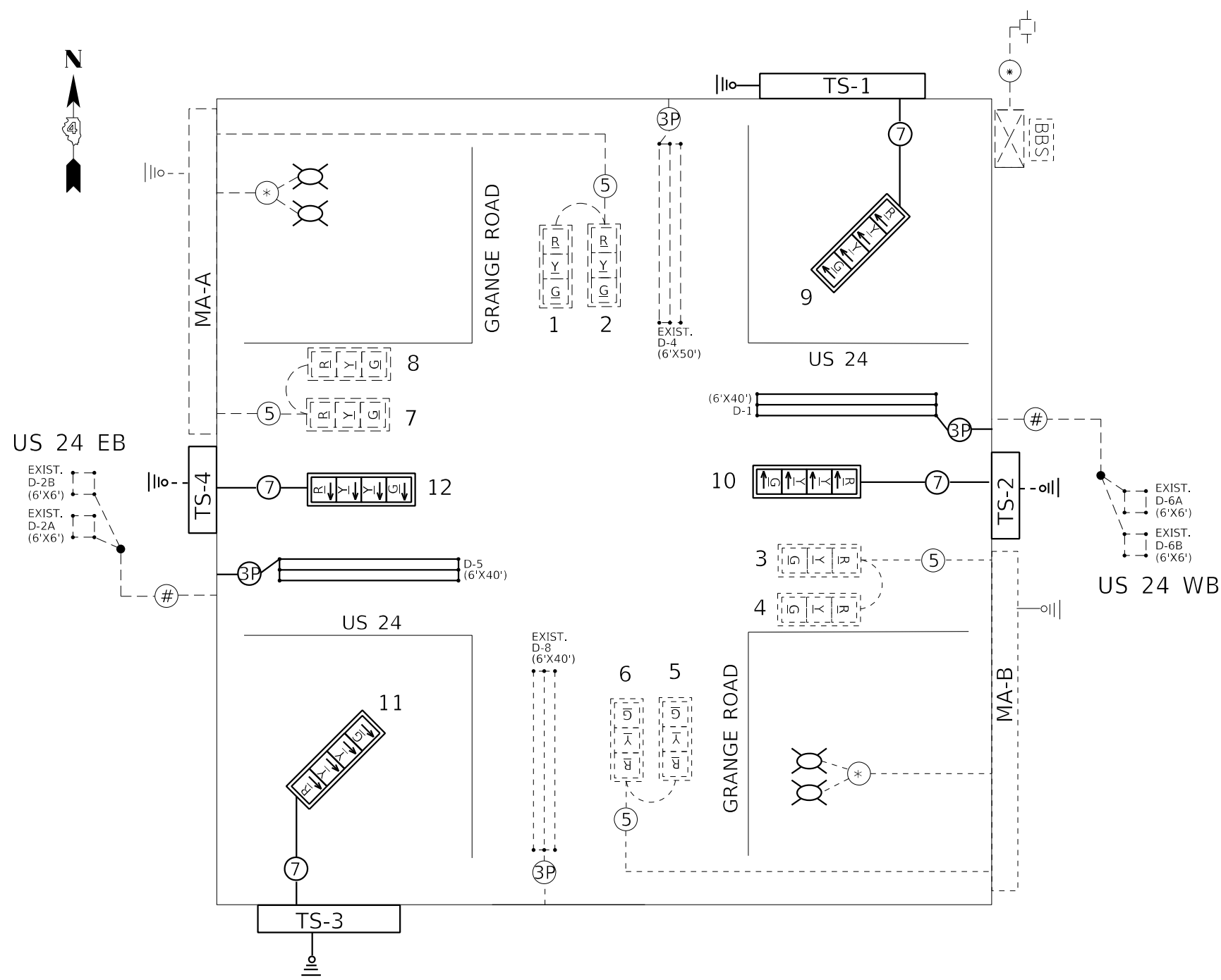

TRAFFIC SIGNALS LEGEND

- | | | | | | |
|--|-------------------------|--|--------------------------------------|--|------------------------------------|
| | EX. CONTROLLER (SIGNAL) | | EX. 3 SEC. SIGNAL HEAD W/BACKPLATE | | PROP. #18 3-PR DETECTOR LOOP CABLE |
| | EX. BBS CABINET | | PROP. 4 SEC. SIGNAL HEAD W/BACKPLATE | | EX. 5/C NO. 14 SIGNAL CABLE |
| | EX. ELECTRIC SERVICE | | EX. QUADRAPOLE LOOP | | PROP. 7/C NO. 14 SIGNAL CABLE |
| | EX. DETECTOR LOOP | | PROP. QUADRAPOLE LOOP | | EX. #18 3-PR TW/SH LEAD-IN CABLE |
| | PROP. LUMINAIRE, LED | | EX. GROUND/SAFETY BOND | | EX. #6 1/C CABLE |
| | | | PROP. GROUND/SAFETY BOND | | |

NOT TO SCALE

USER NAME =	DESIGNED -	REVISED -
DRAWN -	CHECKED -	REVISED -
PLOT SCALE =	DATE -	REVISED -
PLOT DATE =		

STATE OF ILLINOIS
DEPARTMENT OF TRANSPORTATION

PROPOSED TRAFFIC SIGNAL CABLE AND PHASE DIAGRAMS
US 24 & GRANGE ROAD - TAZEWELL COUNTY

SCALE: _____ SHEET _____ OF _____ SHEETS STA. _____ TO STA. _____

FAP ROUTE	SECTION	COUNTY	TOTAL SHEETS	SHEET NO.
VARIOUS	(17-18)TS-2; (72-7)TS-1; 8TS-1	PEORIA-TAZEWELL ILLINOIS	24	10
CONTRACT NO. 68E39				

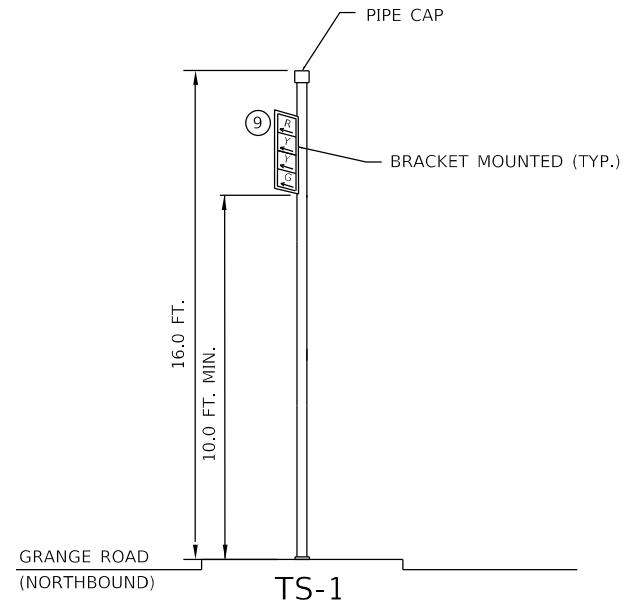

TRAFFIC SIGNAL POST
NORTHEAST CORNER OF US 24 & GRANGE ROAD

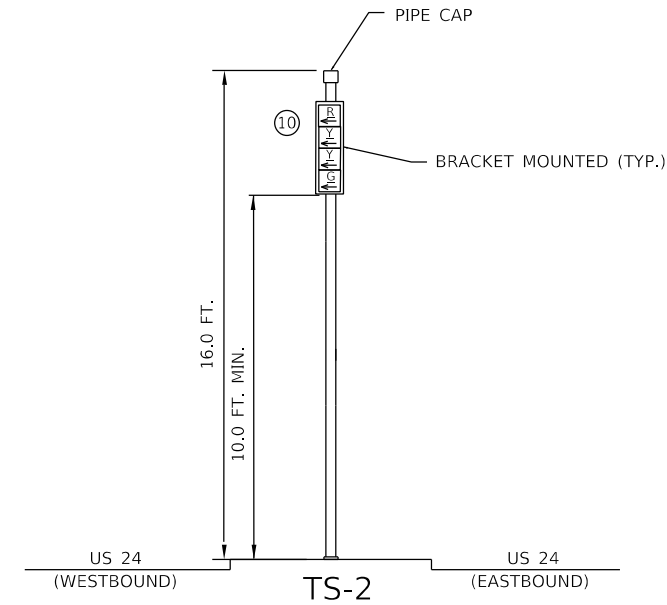

TRAFFIC SIGNAL POST
US 24 CENTER MEDIAN EAST OF INTERSECTION

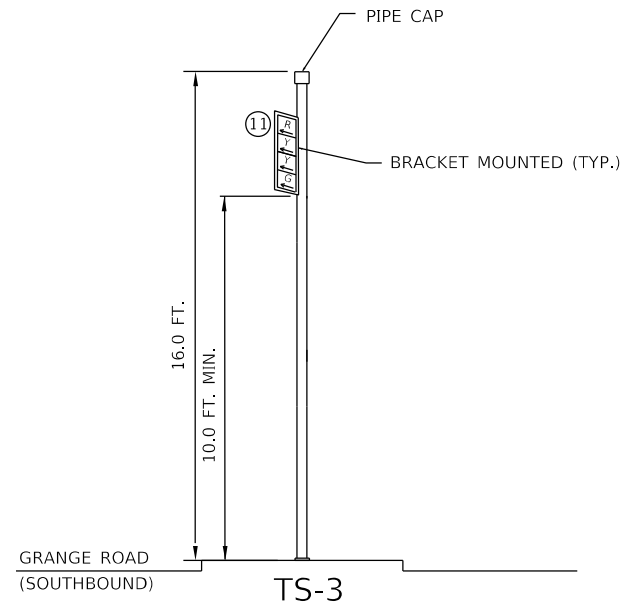

TRAFFIC SIGNAL POST
SOUTHWEST CORNER OF US 24 & GRANGE ROAD

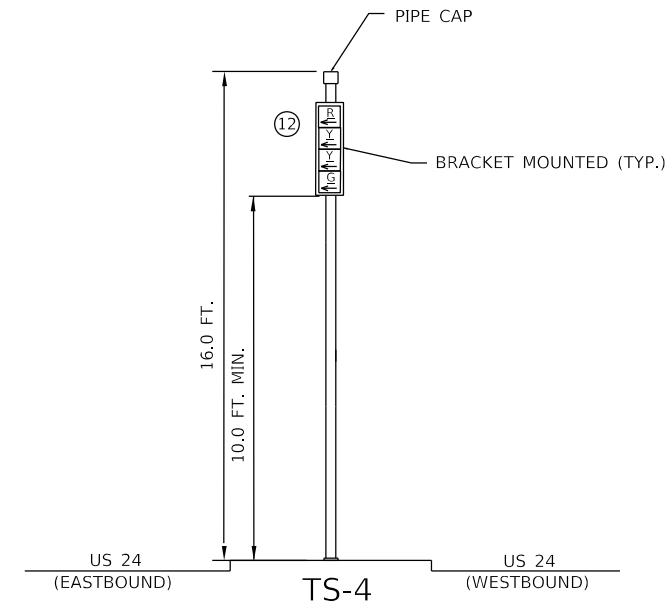

TRAFFIC SIGNAL POST
US 24 CENTER MEDIAN WEST OF INTERSECTION

MODEL: D:\m\h\...
 FILE NAME: C:\ORPCEN\W\W00DD\DESP\AN\H\H0000\68E39_FY18_Contract_Maintenance\FY18 (FINAL_03-29-18).dgn

NOT TO SCALE

USER NAME = _____ PLOT SCALE = _____ PLOT DATE = _____	DESIGNED - _____	REVISED - _____	STATE OF ILLINOIS DEPARTMENT OF TRANSPORTATION	PROPOSED TRAFFIC SIGNAL POST DETAILS US 24 & GRANGE ROAD - TAZEWELL COUNTY		FAP ROUTE	SECTION	COUNTY	TOTAL SHEETS	SHEET NO.
	DRAWN - _____	REVISED - _____		VARIOUS	(17-18)TS-2; (72-7)TS-1- 8TS-1	PEORIA-TAZEWELL	24	11		
	CHECKED - _____	REVISED - _____		SCALE: _____	SHEET _____ OF _____ SHEETS	STA. _____ TO STA. _____	ILLINOIS	CONTRACT NO. 68E39		
	DATE - _____	REVISED - _____								

F.A. #	SECTION	COUNTY	TOTAL SHEETS	SHEET NO.
317	17 TS-1	TAZEWELL	5	3
STA. _____ TO STA. _____		FED. AID PROJECT		

FOR INFORMATION ONLY

ITEMS	UNIT	QUANTITY
SIGNAL HEAD, ALUMINUM, 1-FACE, 3-SECTION, MAST ARM MOUNTED	EACH	8
TRAFFIC SIGNAL BACKPLATE	EACH	8
GALVANIZED STEEL CONDUIT IN TRENCH 2 1/2"	LIN FT	50
GALVANIZED STEEL CONDUIT, PUSHED 2"	LIN FT	140
PVC CONDUIT IN TRENCH 1 1/2"	LIN FT	50
ELECTRIC CABLE IN CONDUIT NO. 6 2/C	LIN FT	595
ELECTRIC CABLE IN CONDUIT NO. 12 1/C	LIN FT	320
ELECTRIC CABLE IN CONDUIT NO. 14 5/C	LIN FT	872
ELECTRIC CABLE IN CONDUIT NO. 18, 3 PAIR TWISTED, SHIELDED	LIN FT	961
CONCRETE FOUNDATION, TYPE E 30-INCH DIAMETER	LIN FT	22
CONCRETE HANDHOLE	EACH	2
TRENCH AND BACKFILL	LIN FT	100
REMOVE EXISTING TRAFFIC SIGNAL EQUIPMENT	EACH	1
DRILL EXISTING HANDHOLE	EACH	4
STEEL COMBINATION MAST ARM ASSEMBLY AND POLE WITH MAST ARMS, 36 FT. AND 38 FT.	EACH	2

INFORMATION ONLY

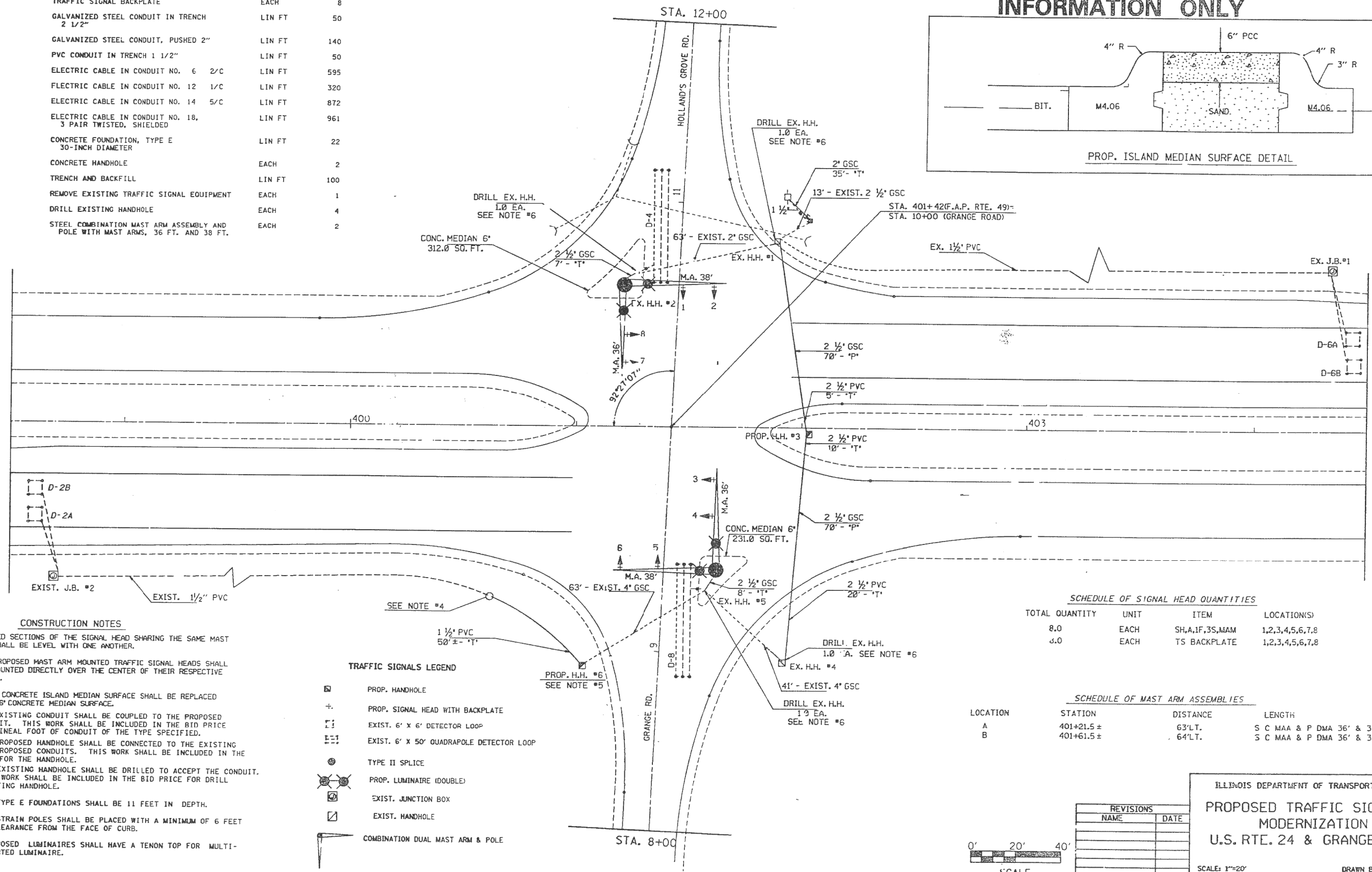
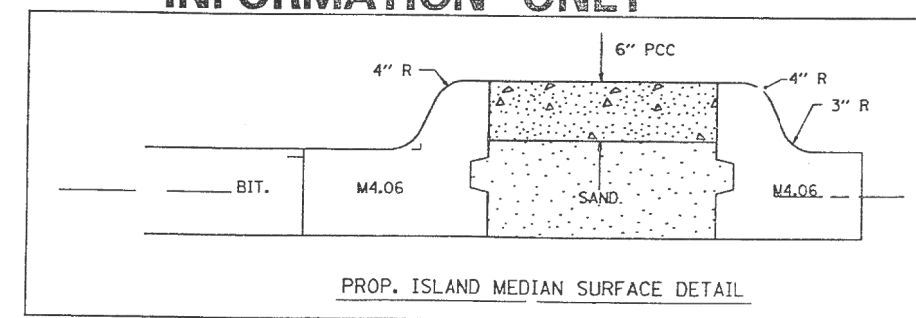

CONSTRUCTION NOTES

- THE RED SECTIONS OF THE SIGNAL HEAD SHARING THE SAME MAST ARM SHALL BE LEVEL WITH ONE ANOTHER.
- THE PROPOSED MAST ARM MOUNTED TRAFFIC SIGNAL HEADS SHALL BE MOUNTED DIRECTLY OVER THE CENTER OF THEIR RESPECTIVE LANES.
- THE 4" CONCRETE ISLAND MEDIAN SURFACE SHALL BE REPLACED WITH 6" CONCRETE MEDIAN SURFACE.
- THE EXISTING CONDUIT SHALL BE COUPLED TO THE PROPOSED CONDUIT. THIS WORK SHALL BE INCLUDED IN THE BID PRICE PER LINEAL FOOT OF CONDUIT OF THE TYPE SPECIFIED.
- THE PROPOSED HANDHOLE SHALL BE CONNECTED TO THE EXISTING AND PROPOSED CONDUITS. THIS WORK SHALL BE INCLUDED IN THE COST FOR THE HANDHOLE.
- THE EXISTING HANDHOLE SHALL BE DRILLED TO ACCEPT THE CONDUIT. THIS WORK SHALL BE INCLUDED IN THE BID PRICE FOR DRILL EXISTING HANDHOLE.
- ALL TYPE E FOUNDATIONS SHALL BE 11 FEET IN DEPTH.
- ALL STRAIN POLES SHALL BE PLACED WITH A MINIMUM OF 6 FEET OF CLEARANCE FROM THE FACE OF CURB.
- PROPOSED LUMINAIRES SHALL HAVE A TENON TOP FOR MULTI-MOUNTED LUMINAIRE.

TRAFFIC SIGNALS LEGEND

- PROP. HANDHOLE
- PROP. SIGNAL HEAD WITH BACKPLATE
- EXIST. 6' X 6' DETECTOR LOOP
- EXIST. 6' X 50' QUADRANGLE DETECTOR LOOP
- TYPE II SPLICE
- PROP. LUMINAIRE (DOUBLE)
- EXIST. JUNCTION BOX
- EXIST. HANDHOLE
- COMBINATION DUAL MAST ARM & POLE

SCHEDULE OF SIGNAL HEAD QUANTITIES

TOTAL QUANTITY	UNIT	ITEM	LOCATION(S)
8.0	EACH	SH, A, IF, 3S, MAM	1, 2, 3, 4, 5, 6, 7, 8
8.0	EACH	TS BACKPLATE	1, 2, 3, 4, 5, 6, 7, 8

SCHEDULE OF MAST ARM ASSEMBLIES

LOCATION	STATION	DISTANCE	LENGTH
A	401+21.5 ±	63' LT.	S C MAA & P DMA 36' & 38'
B	401+61.5 ±	64' LT.	S C MAA & P DMA 36' & 38'

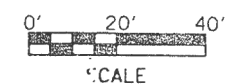

REVISIONS

NAME	DATE

ILLINOIS DEPARTMENT OF TRANSPORTATION
PROPOSED TRAFFIC SIGNALS MODERNIZATION
U.S. RTE. 24 & GRANGE RD.
 SCALE: 1"=20'
 DATE: 03/16/93
 DRAWN BY: CADD
 CHECKED BY: S. KECK

USER NAME =	DESIGNED -	REVISED -
PLOT SCALE =	DRAWN -	REVISED -
PLOT DATE =	CHECKED -	REVISED -
	DATE -	REVISED -

STATE OF ILLINOIS DEPARTMENT OF TRANSPORTATION

EXISTING TRAFFIC SIGNAL PLANS
US 24 & GRANGE ROAD - TAZEWELL COUNTY
 SCALE: _____ SHEET _____ OF _____ SHEETS STA. _____ TO STA. _____

FAP ROUTE	SECTION	COUNTY	TOTAL SHEETS	SHEET NO.
VARIOUS	(17-18)TS-2; (72-7)TS-1; 8TS-1	PEORIA-TAZEWELL ILLINOIS	24	12
CONTRACT NO. 68E39				

MODEL: D:\m\h\... FILE NAME: C:\PROJECTS\... D:\CONTRACT MAINTENANCE\FY18 (FINAL_03-29-18).dgn

TRAFFIC SIGNAL HEAD SCHEDULE			
QTY.	UNIT	ITEM	LOCATION
2.0	EACH	RELOCATE EXISTING SIGNAL HEAD	4,11 (EXISTING)
2.0	EACH	SH P LED 1F 4S BM	15,17 (PROPOSED)
2.0	EACH	SH P LED 1F 4S MAM	16,18 (PROPOSED)
4.0	EACH	TS BACKPLATE RET-REFL	3, 6,10 (EXISTING)
			15,16,17,18 (PROPOSED)

BILL OF MATERIALS			
ITEM DESCRIPTION	UNIT	QUANTITY	
ELECTRIC CABLE IN CONDUIT, SIGNAL NO. 14 5C	FOOT	452.5	
ELECTRIC CABLE IN CONDUIT, SIGNAL NO. 14 7C	FOOT	995.0	
SIGNAL HEAD, POLYCARBONATE, LED, 1-FACE, 4-SECTION, BRACKET MOUNTED	EACH	2.0	
SIGNAL HEAD, POLYCARBONATE, LED, 1-FACE, 4-SECTION, MAST ARM MOUNTED	EACH	2.0	
TRAFFIC SIGNAL BACKPLATE, RETROREFLECTIVE	EACH	7.0	
RELOCATE EXISTING SIGNAL HEAD	EACH	2.0	
MODIFY EXISTING CONTROLLER CABINET	EACH	1.0	
LUMINAIRE, LED, HORIZONTAL MOUNT, MEDIUM WATTAGE	EACH	4.0	

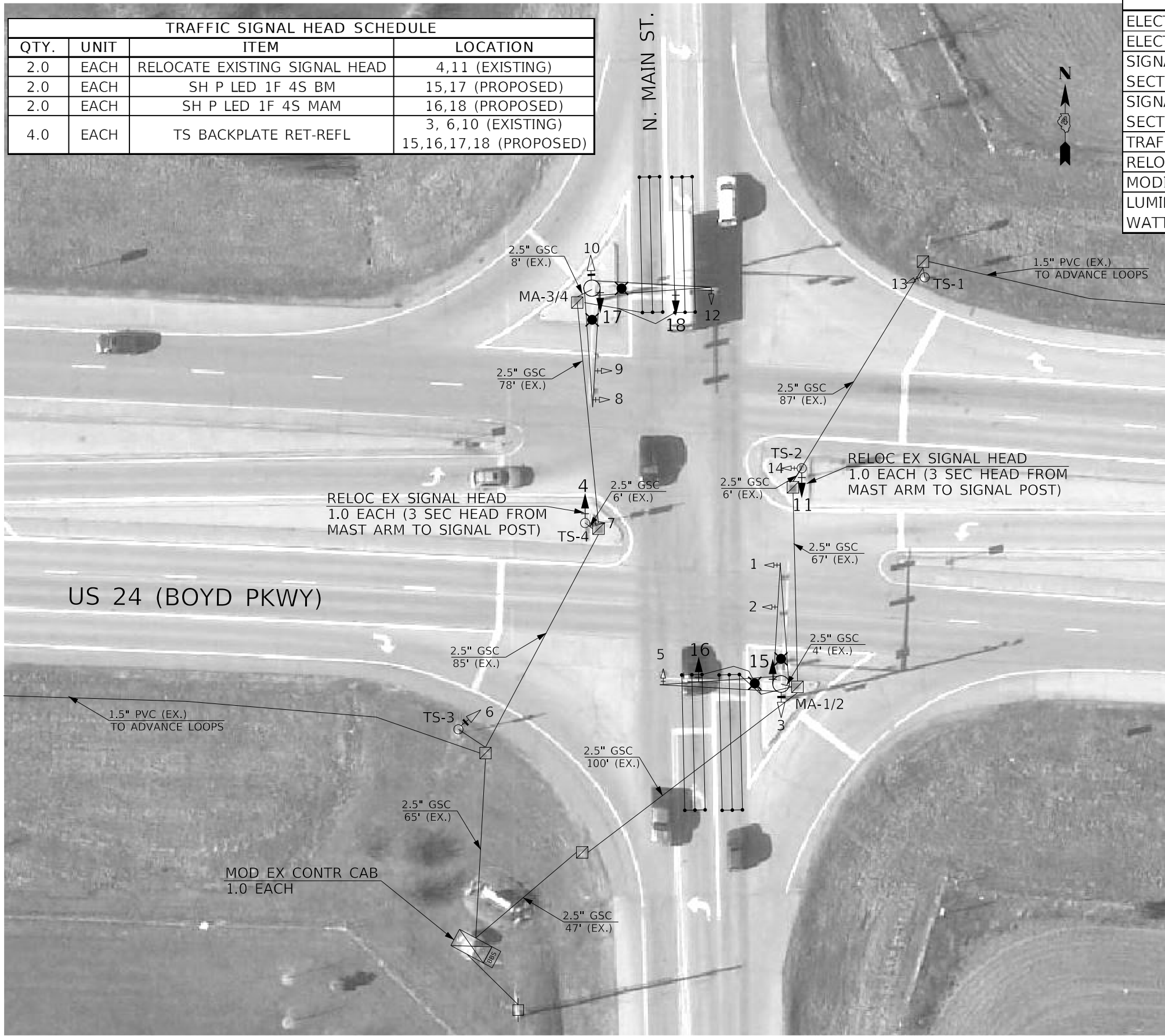

TRAFFIC SIGNAL LEGEND	
	PROP. LUMINAIRE, LED
	PROP. QUADRAPOLE LOOP
	PROP. TRAFFIC SIGNAL HEAD W/ BACKPLATE
	PROP. BACKPLATE ON EX. TRAFFIC SIGNAL HEAD
	EX. QUADRAPOLE LOOP
	EX. TRAFFIC SIGNAL HEAD W/ BACKPLATE
	EX. STL COMB MAST ARM ASSEMBLY
	EX. CONTROLLER CABINET (SIGNAL)
	EX. ELECTRICAL SERVICE
	EX. BBS AND CABINET

MODEL: \\MODELS\NAME FILES: \\NAME: STILES

USER NAME =	DESIGNED -	REVISED -
	DRAWN -	REVISED -
PLOT SCALE =	CHECKED -	REVISED -
PLOT DATE =	DATE -	REVISED -

**STATE OF ILLINOIS
DEPARTMENT OF TRANSPORTATION**

**PROPOSED TRAFFIC SIGNAL IMPROVEMENTS
US 24 (BOYD PARKWAY) & N. MAIN STREET - TAZEWELL COUNTY**

FAP ROUTE	SECTION	COUNTY	TOTAL SHEETS	SHEET NO.
VARIOUS	(17-18)TS-2; (72-7)TS-1; 8TS-1	PEORIA-TAZEWELL ILLINOIS	24	14
CONTRACT NO. 68E39				

NOT TO SCALE



RE-ASSIGN
D-4B TO
PHASE 7

RELOCATE EX.
3-SEC MAM HEAD
#4 FROM MA-1/2
TO POST TS-4

RELOCATE EX.
3-SEC MAM HEAD
#11 FROM MA-3/4
TO POST TS-2

RE-ASSIGN
D-8B TO
PHASE 3

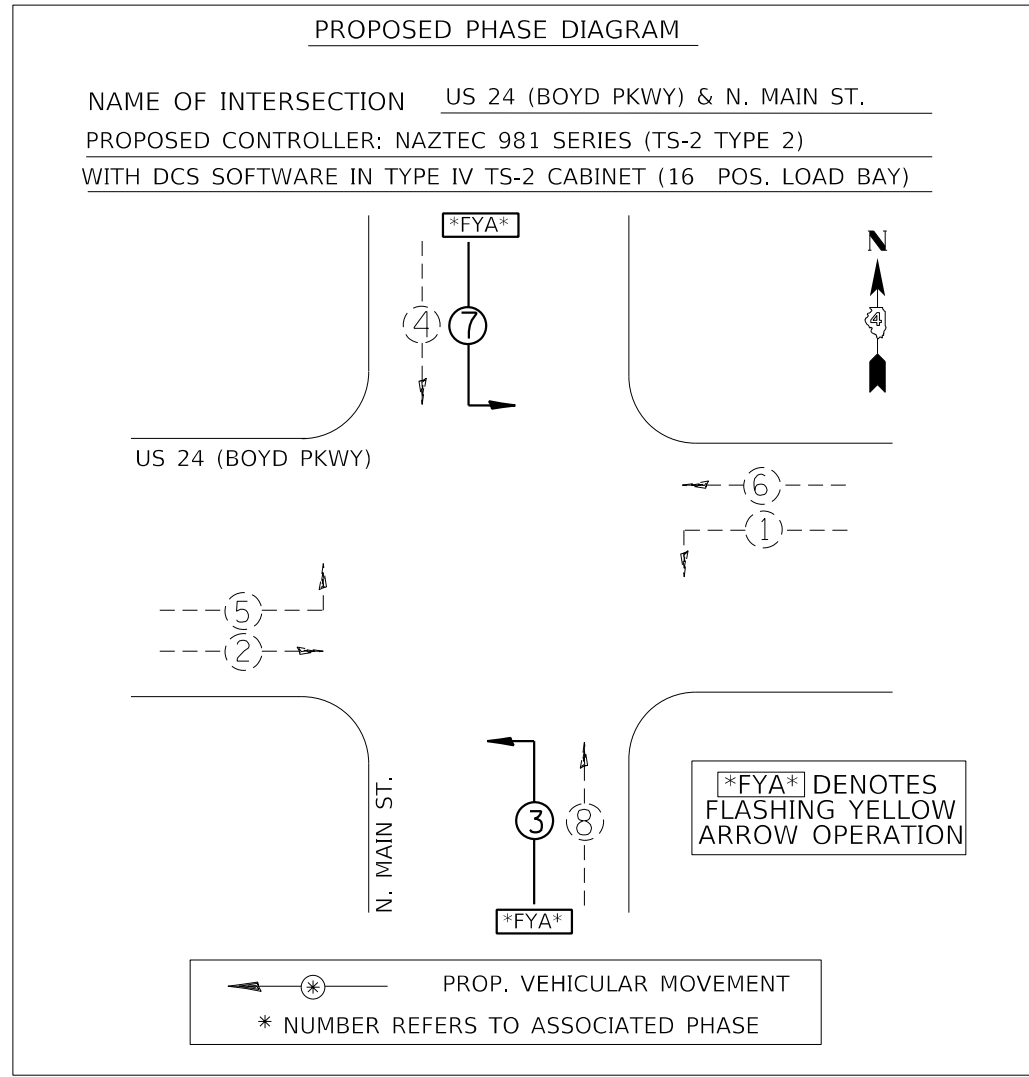
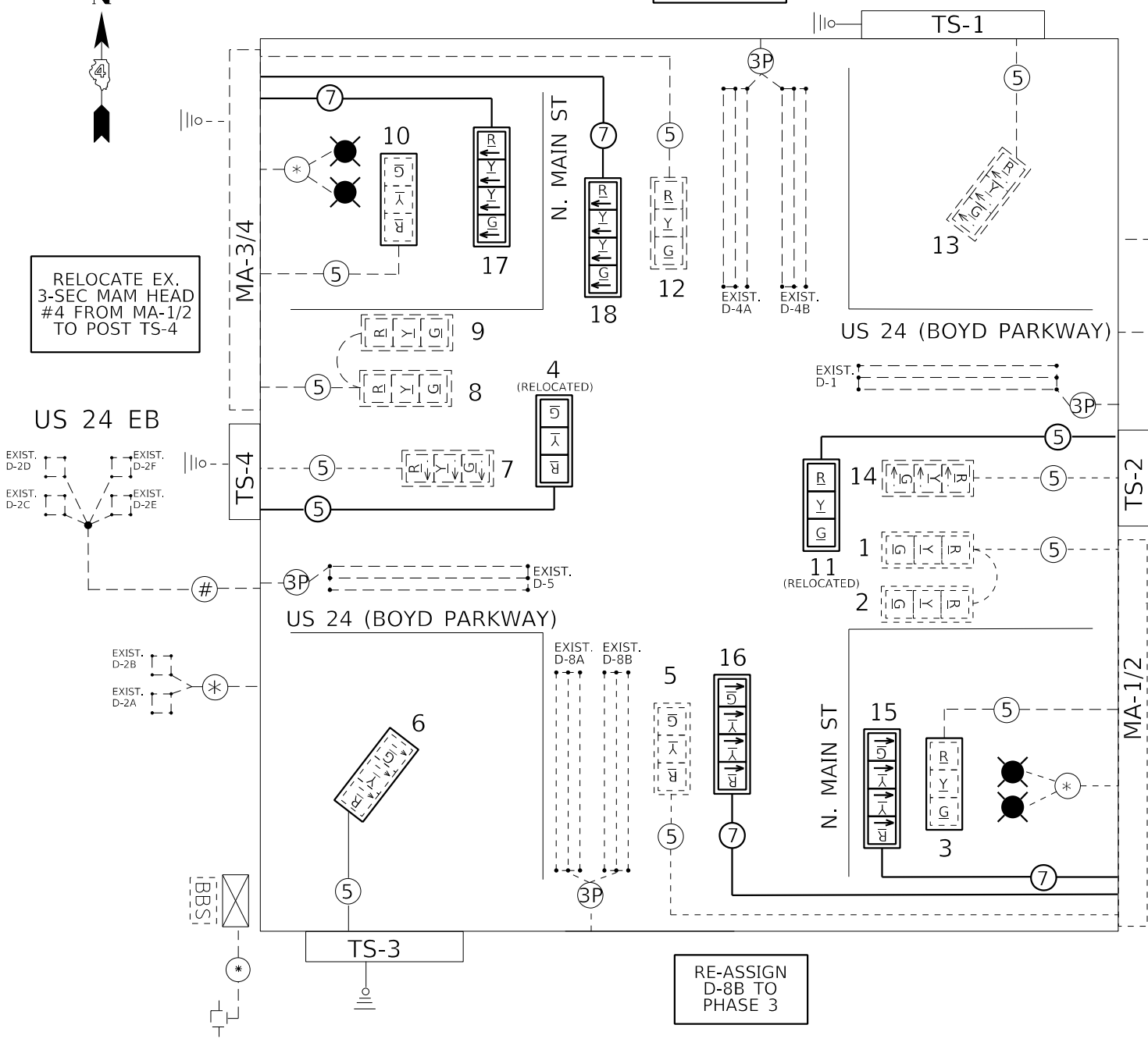

TRAFFIC SIGNALS LEGEND

- | | | |
|-------------------------|--------------------------------------|----------------------------------|
| EX. CONTROLLER (SIGNAL) | EX. 3 SEC. SIGNAL HEAD W/BACKPLATE | EX. #18 3-PR DETECTOR LOOP CABLE |
| EX. BBS CABINET | PROP. 4 SEC. SIGNAL HEAD W/BACKPLATE | PROP. 5/C NO. 14 SIGNAL CABLE |
| EX. ELECTRIC SERVICE | PROP. BACKPLATE ON EX. SIGNAL HEAD | PROP. 7/C NO. 14 SIGNAL CABLE |
| EX. DETECTOR LOOP | EX. QUADRAPOLE LOOP | EX. #12 1PR TW/SH LEAD-IN CABLE |
| PROP. LUMINIARE, LED | EX. GROUND/SAFETY BOND | EX. #6 1/C CABLE |

NOT TO SCALE

MODEL: D:\m\h\... FILE NAME: C:\P\GEN\WV\WOD\DESP\AN\Hanson\68E39.FY18.Contract.Maintenance.FY18.FINAL_03-29-18.dgn

USER NAME =	DESIGNED -	REVISED -
PLOT SCALE =	DRAWN -	REVISED -
PLOT DATE =	CHECKED -	REVISED -
	DATE -	REVISED -

**STATE OF ILLINOIS
DEPARTMENT OF TRANSPORTATION**

**PROPOSED TRAFFIC SIGNAL CABLE AND PHASE DIAGRAMS
US 24 (BOYD PARKWAY) & N. MAIN STREET - TAZEWELL COUNTY**

SCALE: _____ SHEET _____ OF _____ SHEETS STA. _____ TO STA. _____

FAP ROUTE	SECTION	COUNTY	TOTAL SHEETS	SHEET NO.
VARIOUS	(17-18)TS-2; (72-7)TS-1; 8TS-1	PEORIA-TAZEWELL ILLINOIS	24	15
CONTRACT NO. 68E39				

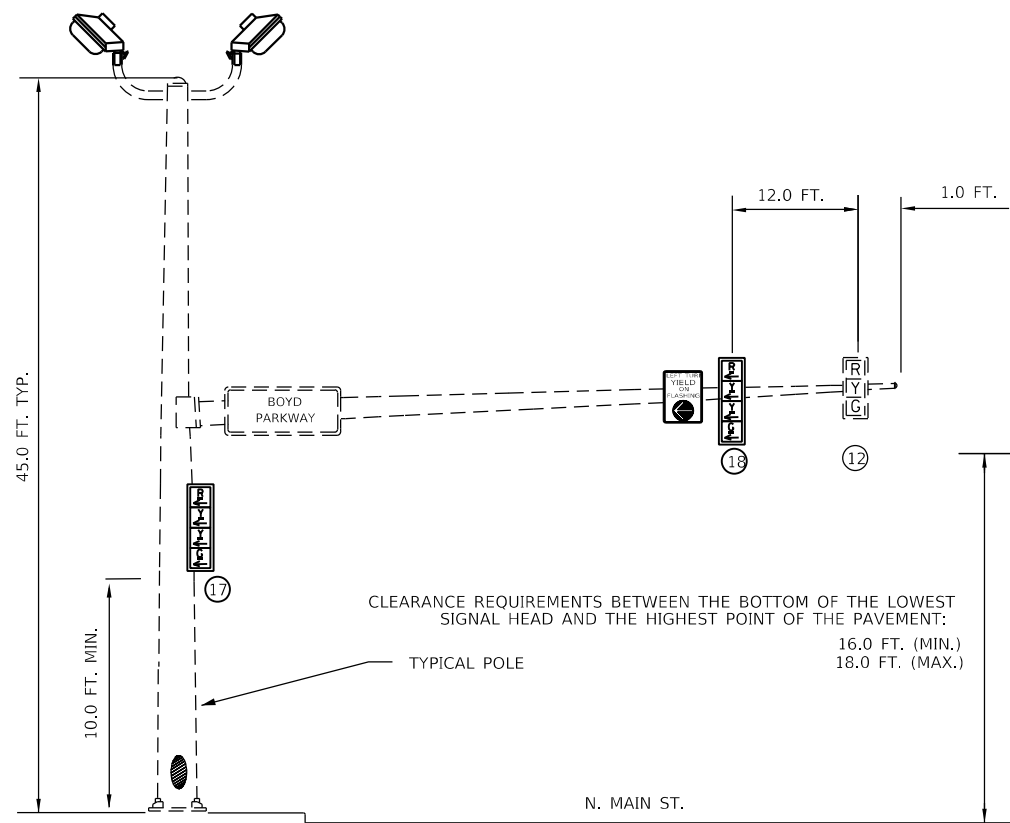

MA-3/4
NORTHBOUND TRAFFIC SIGNAL
NORTHWEST QUADRANT OF US 24 (BOYD PARKWAY) & N. MAIN ST.

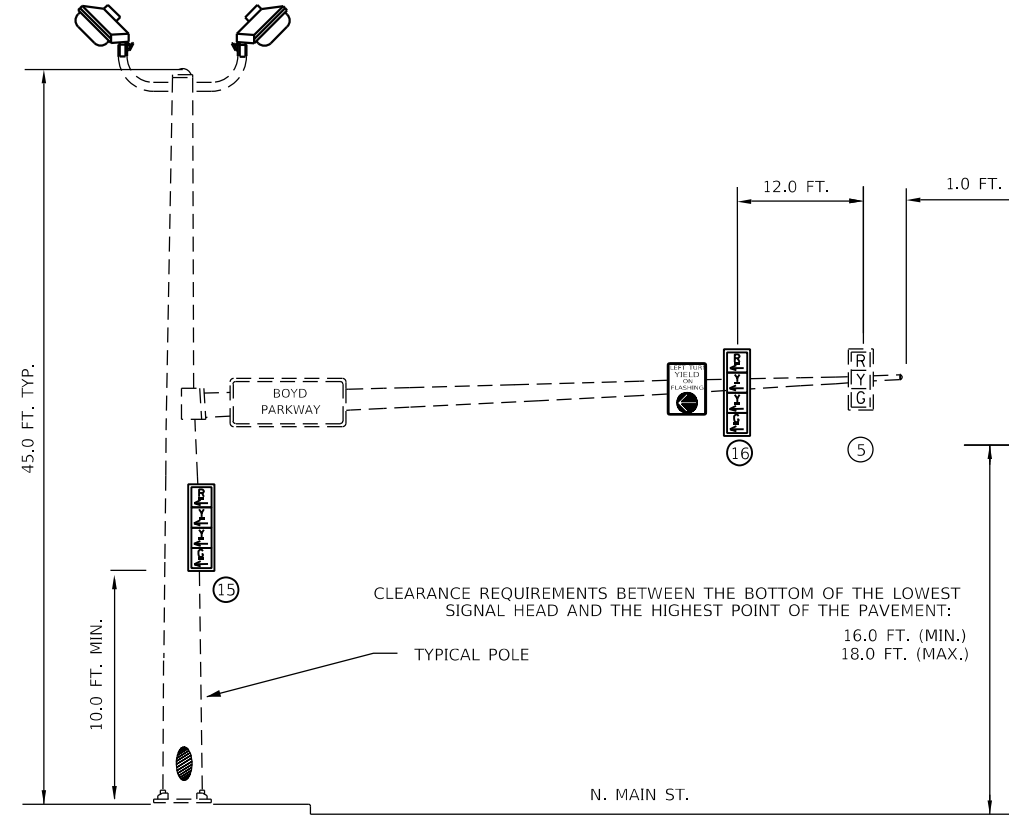

MA-1/2
SOUTHBOUND TRAFFIC SIGNAL
SOUTHEAST QUADRANT OF US 24 (BOYD PARKWAY) & N. MAIN ST.

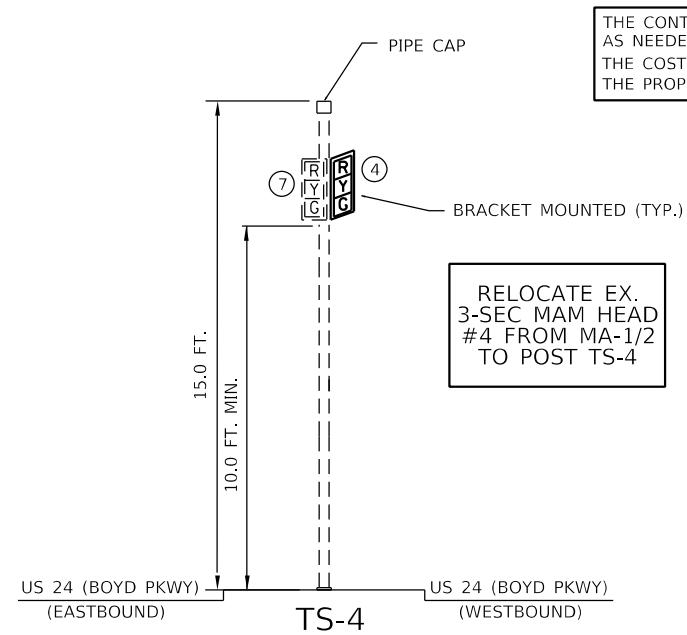

TRAFFIC SIGNAL POST
US 24 CENTER MEDIAN WEST OF INTERSECTION

THE CONTRACTOR SHALL ADJUST THE EXISTING SIGNAL HEADS AS NEEDED TO MAINTAIN VERTICAL CLEARANCE REQUIREMENTS. THE COST OF THIS WORK SHALL BE INCLUDED IN THE COST OF THE PROPOSED TRAFFIC SIGNAL HEADS.

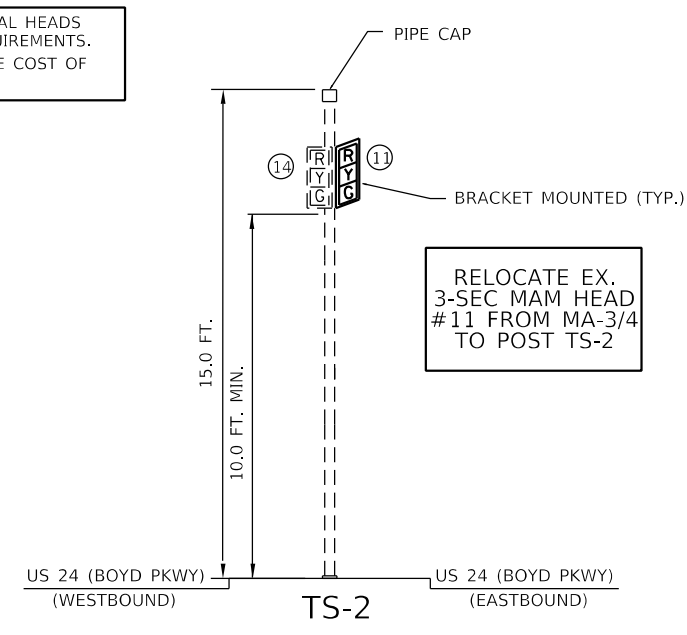

TRAFFIC SIGNAL POST
US 24 CENTER MEDIAN EAST OF INTERSECTION

MODEL: D:\m\h\... FILE NAME: C:\P\CE\ENR\W\0\DD\DESP\AN\Hanson\68E39_D4 Contract Maintenance\FY18 (FINAL_03-29-18).dgn

USER NAME =	DESIGNED - _____	REVISED - _____
	DRAWN - _____	REVISED - _____
PLOT SCALE =	CHECKED - _____	REVISED - _____
PLOT DATE =	DATE - _____	REVISED - _____

STATE OF ILLINOIS
DEPARTMENT OF TRANSPORTATION

PROPOSED MAST ARM AND TRAFFIC SIGNAL POST LOADING
US 24 (BOYD PKWY) & N. MAIN STREET - TAZEWELL COUNTY

FAP ROUTE	SECTION	COUNTY	TOTAL SHEETS	SHEET NO.
VARIOUS	(17-18)TS-2; (72-7)TS-1; 8TS-1	PEORIA-TAZEWELL ILLINOIS	24	16

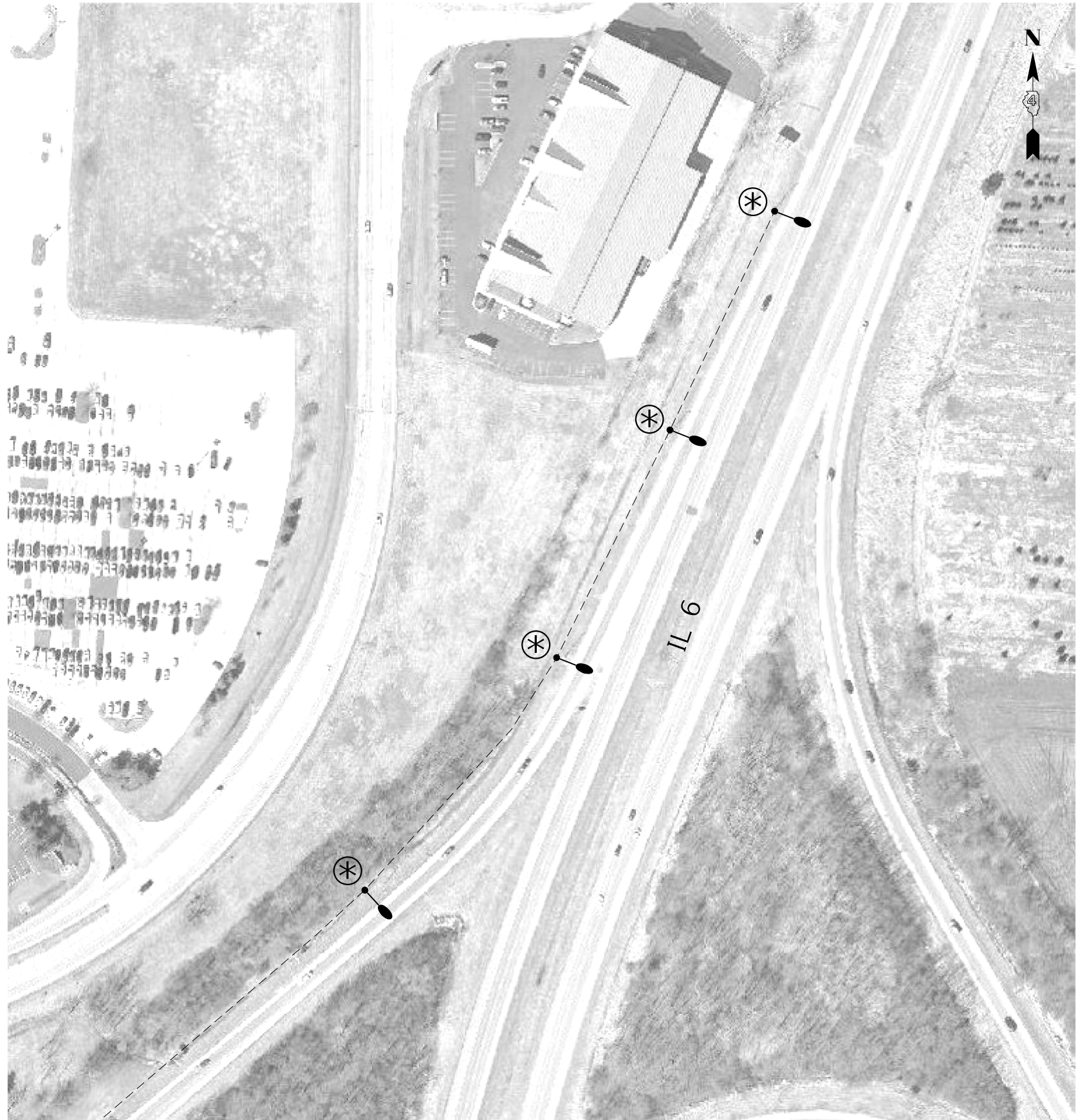

CONTRACT NO. 68E39

NOT TO SCALE

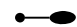
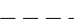

BILL OF MATERIALS		
ITEM DESCRIPTION	UNIT	QUANTITY
LUMINAIRE, LED, HORIZONTAL MOUNT, MEDIUM WATTAGE	EACH	4.0
BREAKAWAY DEVICE, TRANSFORMER BASE, 15 INCH BOLT CIRCLE	EACH	4.0
LIGHT POLE, GALVANIZED STEEL, 45 FT. M.H., TENON MOUNT	EACH	4.0

OVERHEAD LIGHTING LEGEND

-  PROP. LUMINAIRE, LED 240V
-  EX. CONDUIT
-  PROP. GALVANIZED STEEL LIGHT POLE AND TRANSFORMER BASE

NOT TO SCALE

MODEL: D:\p\h\l FILE NAME: C:\P\CEIN\W\0\DD\ESP\AN\Hanson\68E39_D4 Contract Maintenance FY18 (FINAL_03-29-18).dgn

USER NAME =	DESIGNED - _____	REVISED - _____
PLOT SCALE =	DRAWN - _____	REVISED - _____
PLOT DATE =	CHECKED - _____	REVISED - _____
	DATE - _____	REVISED - _____

STATE OF ILLINOIS
DEPARTMENT OF TRANSPORTATION

LUMINAIRE AND LIGHT POLE REPLACEMENT
IL 6 & US 150 (WAR MEMORIAL DR.) INTERCHANGE - PEORIA COUNTY

SCALE: _____ SHEET ____ OF ____ SHEETS STA. _____ TO STA. _____

FAP ROUTE	SECTION	COUNTY	TOTAL SHEETS	SHEET NO.
VARIOUS	(17-18)TS-2; (72-7)TS-1; 8TS-1	PEORIA-TAZEWELL ILLINOIS	24	18
CONTRACT NO. 68E39				



THE CONTRACTOR SHALL RELOCATE THE EXISTING PEDESTAL MOUNTED TRAFFIC SIGNAL CONTROLLER CABINET AND BBS CABINET FROM THE NORTHEAST QUADRANT TO THE SOUTHEAST QUADRANT. THIS WORK SHALL BE INCLUDED IN THE PAY ITEM "RELOCATE CONTROLLER CABINET."

THE CONTRACTOR SHALL INSTALL NEW RAILROAD INTERCONNECT CABLE IN EXISTING CONDUIT FROM HH-4 TO RAILROAD CONTROLLER CABINET. ALL WORK INVOLVING RAILROAD EQUIPMENT SHALL BE APPROVED BY THE ILLINOIS COMMERCE COMMISSION.

THE CONTRACTOR SHALL COORDINATE THE RELOCATION OF THE TRAFFIC SIGNAL CABINET AND REPLACEMENT OF THE RAILROAD INTERCONNECT CABLE WITH THE RAILROAD AND THE ILLINOIS COMMERCE COMMISSION.

BILL OF MATERIALS		
ITEM DESCRIPTION	UNIT	QUANTITY
UNDERGROUND CONDUIT, PVC, 2.5" DIA.	FOOT	69.0
ELECTRIC CABLE IN CONDUIT, SIGNAL NO. 14 5C	FOOT	535.5
ELECTRIC CABLE IN CONDUIT, SIGNAL NO. 14 7C	FOOT	704.0
ELECTRIC CABLE IN CONDUIT, EQUIPMENT	FOOT	265.0
GROUNDING CONDUCTOR, NO. 6 1C	FOOT	530.0
ELECTRIC CABLE IN CONDUIT, 600V (XLP-TYPE USE) 1/C NO. 6	FOOT	530.0
CONCRETE FOUNDATION, TYPE A	FOOT	6.0
DRILL EXISTING HANDHOLE	EACH	1.0
TRAFFIC SIGNAL BACKPLATE, RETROREFLECTIVE	EACH	5.0
ELECTRIC CABLE IN CONDUIT, RAILROAD, NO. 14 3C	FOOT	204.0
DOUBLE HANDHOLE, PORTLAND CEMENT CONCRETE	EACH	1.0
RELOCATE CONTROLLER CABINET	EACH	1.0
ISLAND PAVEMENT REMOVAL AND REPLACEMENT	SQ FT	41.0
SIGNAL HEAD, POLYCARBONATE, LED, 1-FACE, 3-SECTION, MAST ARM MOUNTED	EACH	5.0

TRAFFIC SIGNAL HEAD SCHEDULE			
QTY.	UNIT	ITEM	LOCATION
5.0	EACH	SH P LED 1F 3S MAM	1,2,3,4,5 (PROPOSED)
5.0	EACH	TS BACKPLATE RET-REFL	1,2,3,4,5 (PROPOSED)

HANDHOLE SCHEDULE		
REF	LOCATION	TYPE
DH-1	SOUTHEAST CORNER	DOUBLE

THE CONTRACTOR SHALL CUT THE EXISTING PEDESTAL BASE FOUNDATION ANCHOR BOLTS FLUSH WITH THE PAVEMENT AND CAP ALL CONDUITS AFTER RELOCATING THE SIGNAL CONTROLLER AND BBS CABINETS. THE COST OF THIS WORK SHALL BE INCLUDED IN THE PAY ITEM "RELOCATE CONTROLLER CABINET."

MODEL: S:\MODEL\NAMES FILE NAME: STILES

USER NAME =	DESIGNED -	REVISED -
PLOT SCALE =	DRAWN -	REVISED -
PLOT DATE =	CHECKED -	REVISED -
	DATE -	REVISED -

**STATE OF ILLINOIS
DEPARTMENT OF TRANSPORTATION**

**PROPOSED TRAFFIC SIGNAL IMPROVEMENTS
IL 29 (MARGARET STREET) & IL 9 (THIRD STREET) - PEKIN**

FAP ROUTE	SECTION	COUNTY	TOTAL SHEETS	SHEET NO.
VARIOUS	(17-18)TS-2; (72-7)TS-1; 8TS-1	PEORIA-TAZEWELL ILLINOIS	24	20
CONTRACT NO. 68E39				

NOT TO SCALE

INSTALL NEW #6 1/C SERVICE CABLE AND GROUND FROM EX. SERVICE DISCONNECT TO PROP. CONTROLLER CABINET LOCATION

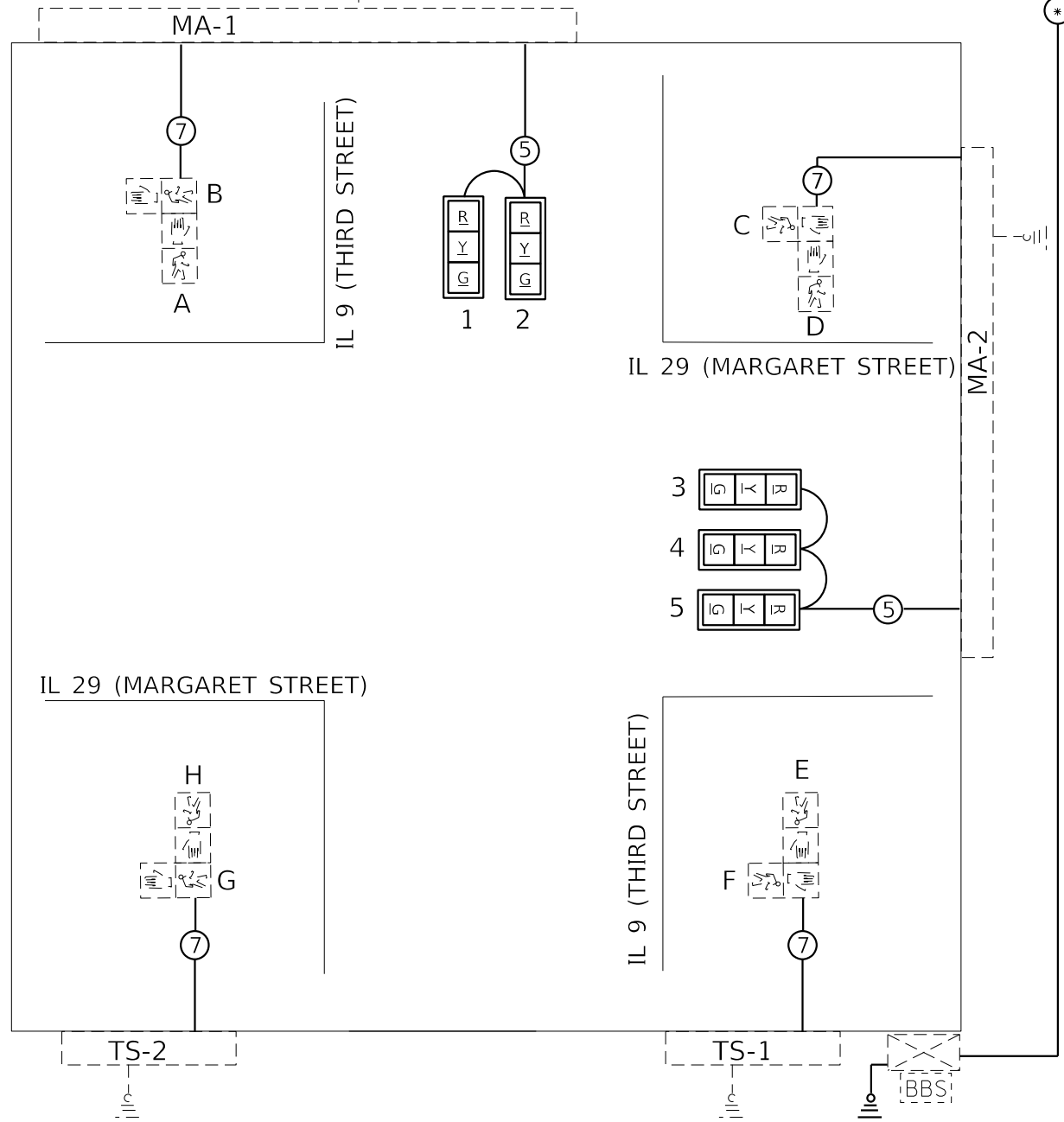
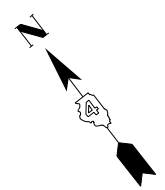

EXISTING #6 1/C GROUNDING CABLE WILL BE RE-USED IN THE PROPOSED INSTALLATION.

RELOCATE EX. TRAFFIC SIGNAL CONTROLLER CABINET AND BBS CABINET FROM NORTHEAST CORNER TO SOUTHEAST CORNER

TRAFFIC SIGNALS LEGEND

EX. CONTROLLER (SIGNAL) (RELOCATED)	PROP. 3 SEC. SIGNAL HEAD W/BACKPLATE	PROP. #6 1/C CABLE
EX. BBS CABINET	EX. PEDESTRIAN SIGNAL HEAD	PROP. 5/C NO. 14 SIGNAL CABLE
EX. ELECTRIC SERVICE	EX. GROUND/SAFETY BOND	PROP. 7/C NO. 14 SIGNAL CABLE

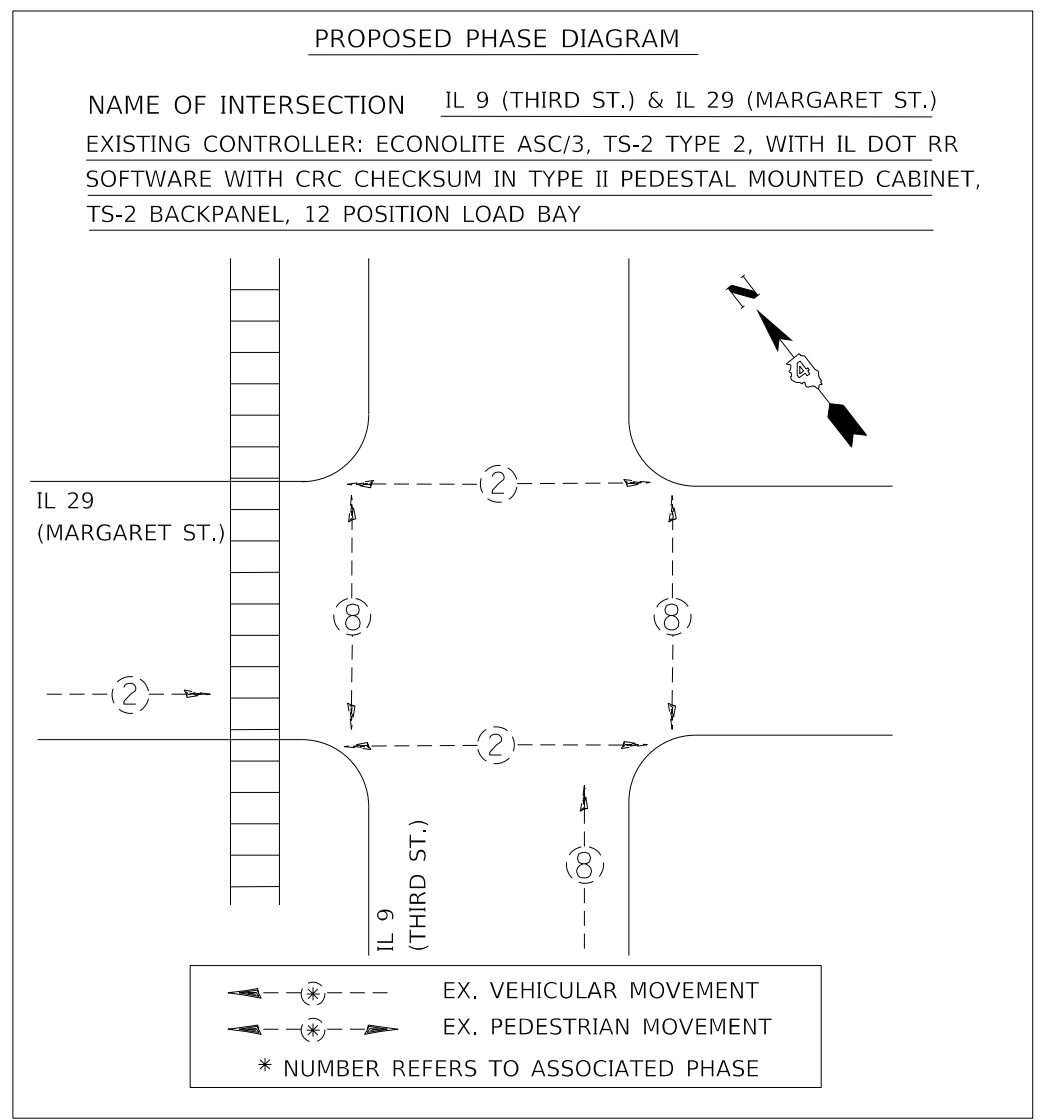

RAILROAD PREEMPTION SEQUENCE

I.	II.	III.
TRACK CLEAR	DWELL	EXIT
	ALL RED FLASH	

PHASE TIMING INFORMATION

	PHASE 2	PHASE 4
MINIMUM GREEN	20.0	15.0
YELLOW CLEARANCE	3.5	3.5
RED CLEARANCE	1.5	1.5

MODEL: D:\p\h\... FILE NAME: C:\P\CEIN\W\0\DD\ESP\AN\Hanson\68E39.DWG CONTRACT MAINTENANCE FY18 (FINAL_03-29-18).dgn

USER NAME =	DESIGNED -	REVISED -
PLOT SCALE =	CHECKED -	REVISED -
PLOT DATE =	DATE -	REVISED -

**STATE OF ILLINOIS
DEPARTMENT OF TRANSPORTATION**

**PROPOSED TRAFFIC SIGNAL CABLE AND PHASE DIAGRAMS
IL 29 (MARGARET STREET) & IL 9(THIRD STREET) – PEKIN**









SCALE: _____ SHEET _____ OF _____ SHEETS STA. _____ TO STA. _____

FAP ROUTE	SECTION	COUNTY	TOTAL SHEETS	SHEET NO.
FAP 317 (US 24) VARIOUS FAP 693 (IL 29)	(17-18)TS-2; (72-7)TS-1; 8TS-1	PEORIA-TAZEWELL ILLINOIS	24	21
CONTRACT NO. 68E39				

NOT TO SCALE

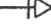
F.A. RTE.	SECTION	COUNTY	TOTAL SHEETS	SHEET NO.
693	15 TS-2	TAZEWELL	38	10
F.H.W.A. REG.	ILLINOIS	PROJECT		

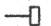
SIGNAL PLAN LEGEND

-  PROPOSED CONTROLLER CABINET
-  PROPOSED HANDHOLE
-  EXISTING SERVICE INSTALLATION
-  EXISTING MAST ARM ASSEMBLY AND POLE - LENGTH AS NOTED
-  EXISTING SIGNAL HEAD WITH BACKPLATE
-  EXISTING HANDHOLE
-  EXISTING PEDESTRIAN SIGNAL HEAD
-  EXISTING CONDUIT

FOR INFORMATION ONLY

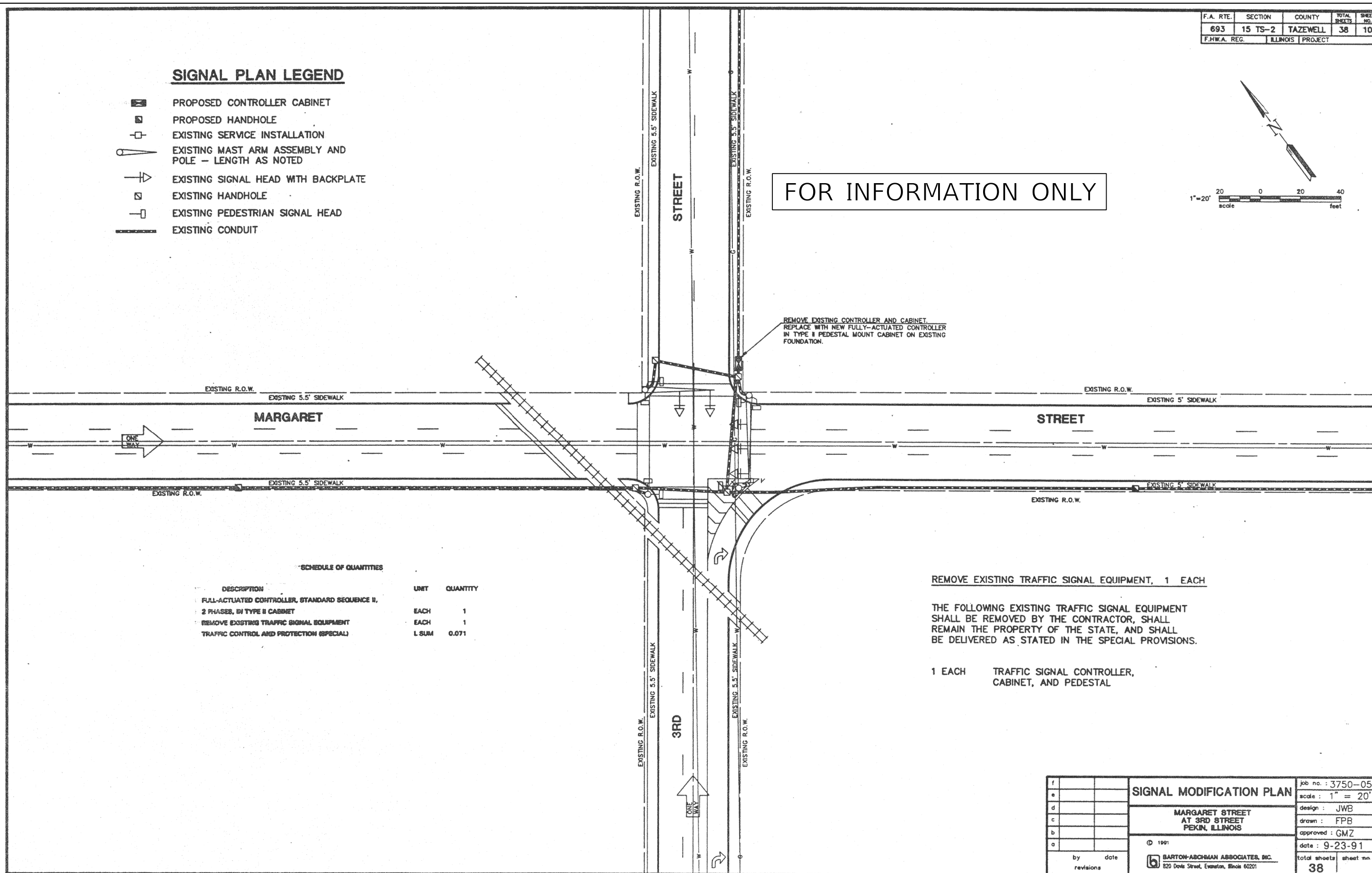
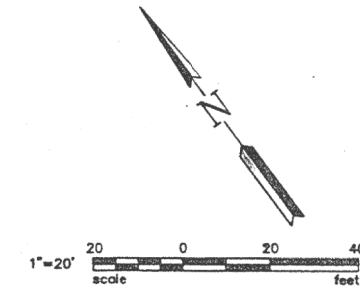

SCHEDULE OF QUANTITIES

DESCRIPTION	UNIT	QUANTITY
FULL-ACTUATED CONTROLLER, STANDARD SEQUENCE II, 2 PHASES, IN TYPE II CABINET	EACH	1
REMOVE EXISTING TRAFFIC SIGNAL EQUIPMENT	EACH	1
TRAFFIC CONTROL AND PROTECTION (SPECIAL)	L.SUM	0.071

REMOVE EXISTING TRAFFIC SIGNAL EQUIPMENT, 1 EACH

THE FOLLOWING EXISTING TRAFFIC SIGNAL EQUIPMENT SHALL BE REMOVED BY THE CONTRACTOR, SHALL REMAIN THE PROPERTY OF THE STATE, AND SHALL BE DELIVERED AS STATED IN THE SPECIAL PROVISIONS.

1 EACH TRAFFIC SIGNAL CONTROLLER, CABINET, AND PEDESTAL

f e d c b a	SIGNAL MODIFICATION PLAN		job no. : 3750-05
			scale : 1" = 20'
	MARGARET STREET AT 3RD STREET PEKIN, ILLINOIS		design : JWB
			drawn : FPB
			approved : GMZ
by _____ date _____		© 1991	date : 9-23-91
revisions		 BARTON-ABCHMAN ASSOCIATES, INC. 820 Davis Street, Evanston, Illinois 60201	total sheets 38 sheet no. 38

MODEL: D:\m\h\... FILE NAME: C:\P\CE\IN\W\ORD\DESIGN\HANSO\68E39_FY18_Contract_Maintenance\FY18_FINAL_03-29-18.dgn

USER NAME =	DESIGNED - _____	REVISED - _____
	DRAWN - _____	REVISED - _____
PLOT SCALE =	CHECKED - _____	REVISED - _____
PLOT DATE =	DATE - _____	REVISED - _____

**STATE OF ILLINOIS
DEPARTMENT OF TRANSPORTATION**

**EXISTING LIGHTING PLANS
IL 29 (MARGARET STREET) & IL 9 (THIRD STREET) - PEKIN**

SCALE: _____ SHEET _____ OF _____ SHEETS STA. _____ TO STA. _____

FAP ROUTE	SECTION	COUNTY	TOTAL SHEETS	SHEET NO.
VARIOUS	(17-18)TS-2; (72-7)TS-1; 8TS-1	PEORIA-TAZEWELL ILLINOIS	24	22
CONTRACT NO. 68E39				

F.A. RTE.	SECTION	COUNTY	TOTAL SHEETS	SHEET NO.
693	15 TS-2	TAZEWELL	38	11
F.H.W.A. REG.		ILLINOIS PROJECT		

FOR INFORMATION ONLY

INTERCONNECT TO ANN ELIZA STREET AT 3RD STREET. (SEE INTERCONNECT PLAN SHEET.)

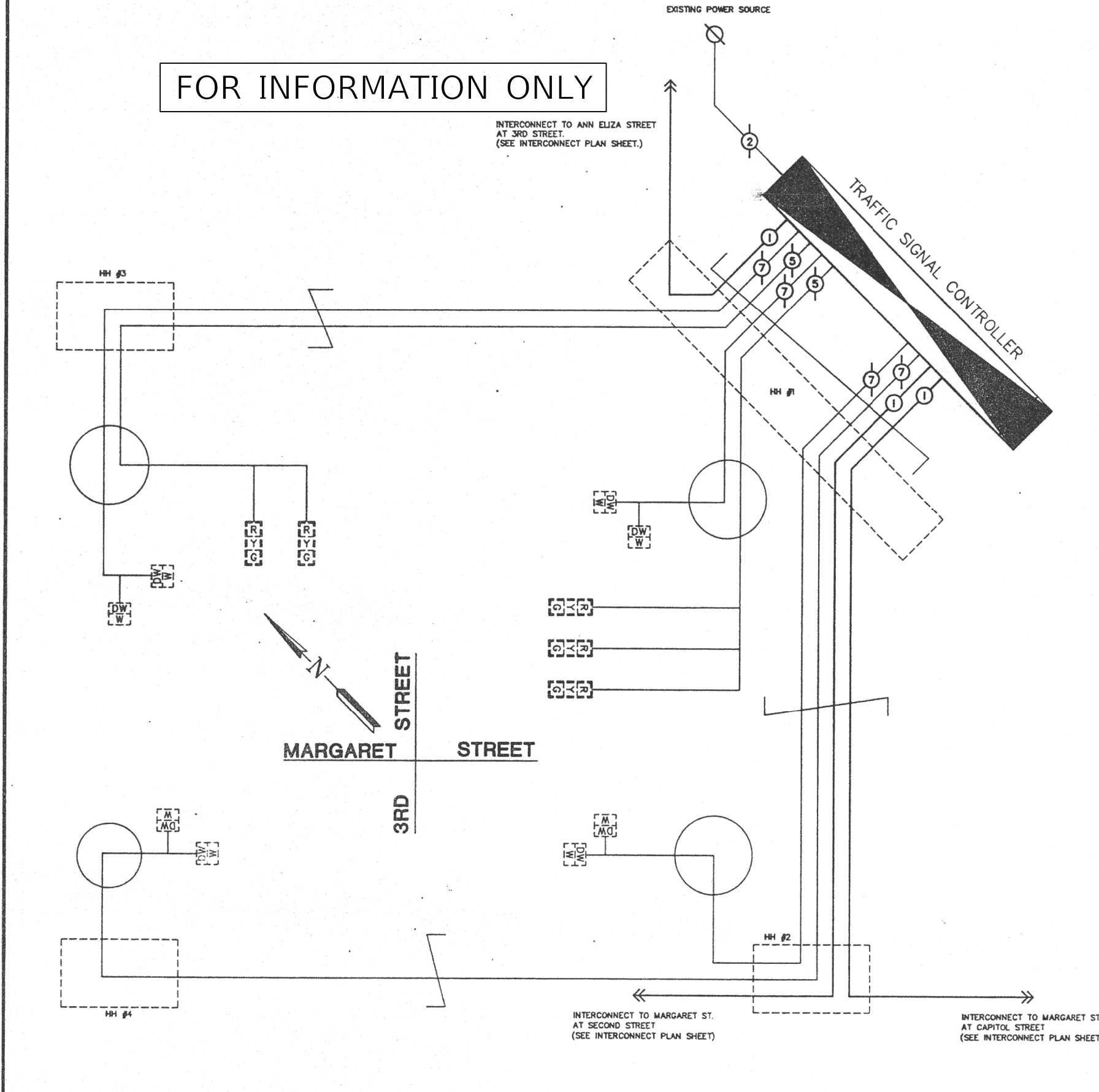

- CABLE PLAN LEGEND**
- PROPOSED CONTROLLER CABINET
 - PROPOSED DETECTOR LOOP
 - PROPOSED 6/PR #19 INTERCONNECT CABLE
 - EXISTING SIGNAL FACE W/ BACKPLATE
 - EXISTING PEDESTRIAN SIGNAL HEAD
 - EXISTING 2/C #6
 - EXISTING 5/C #14
 - EXISTING 7/C #14

NAME OF INTERSECTION MARGARET ST. & 3RD ST.
 CONTROLLER SPECIFIED FULLY ACTUATED CONTROLLER,
STANDARD SEQUENCE I, 2-PHASES,
IN TYPE II PEDESTAL MOUNT CABINET

REFERRING TO STANDARD 2393-1, THE VEHICULAR AND PEDESTRIAN PHASES USED ARE DESIGNATED BELOW.

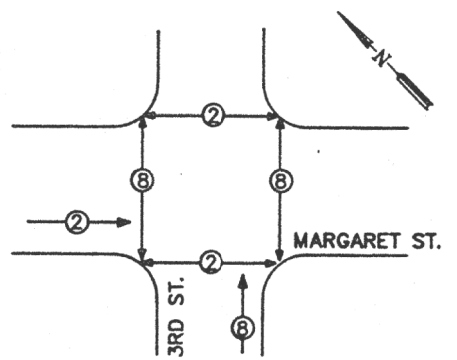

PROPOSED PHASE DESIGNATION DIAGRAM

- LEGEND**
- VEHICULAR MOVEMENT
 - PEDESTRIAN MOVEMENT
 - * NUMBERS REFER TO ASSOCIATED PHASE

f		CABLE PLAN MARGARET STREET AT 3RD STREET PEKIN, ILLINOIS © 1991 BARTON-ABCHMAN ASSOCIATES, INC. 820 Davis Street, Evanston, Illinois 60201	job no. : 3750-05
e			scale : NOT TO SCALE
d			design : GMZ
c			drawn : FPB
b			approved : GMZ
a			date : 9-23-91
by _____ date _____ revisions _____		total sheets	sheet no.
		38	11

USER NAME =	DESIGNED - _____	REVISED - _____
PLOT SCALE =	DRAWN - _____	REVISED - _____
PLOT DATE =	CHECKED - _____	REVISED - _____
	DATE - _____	REVISED - _____

**STATE OF ILLINOIS
DEPARTMENT OF TRANSPORTATION**

EXISTING LIGHTING PLANS (CONTINUED)
IL 29 (MARGARET STREET) & IL 9 (THIRD STREET) - PEKIN

FAP ROUTE	SECTION	COUNTY	TOTAL SHEETS	SHEET NO.
VARIOUS	(17-18)TS-2; (72-7)TS-1; 8TS-1	PEORIA-TAZEWELL ILLINOIS	24	23
CONTRACT NO. 68E39				

MODEL: D:\m\h\...
 FILE NAME: C:\PROJECTS\...
 MODEL: D:\m\h\...
 FILE NAME: C:\PROJECTS\...

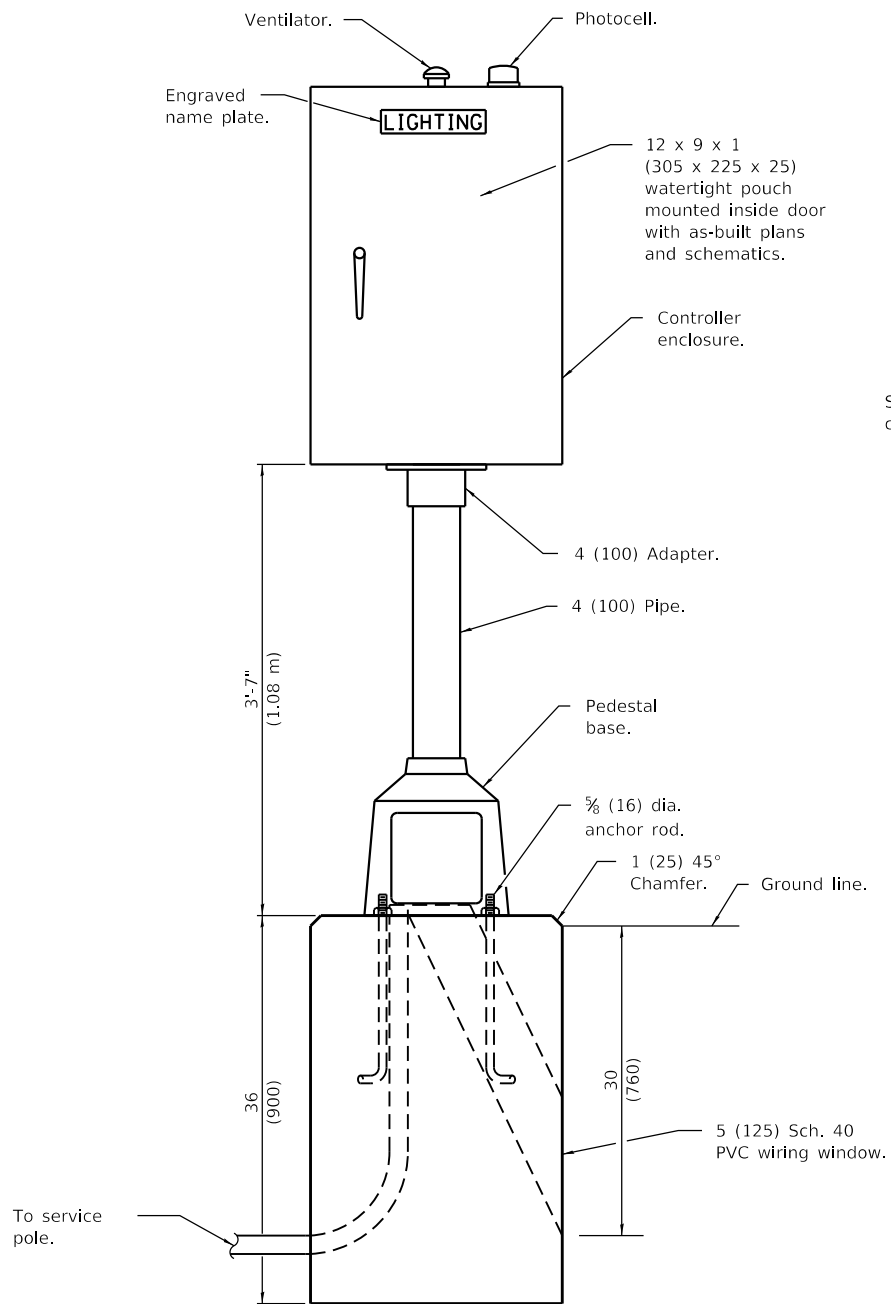

**THE PROPOSED LIGHTING CONTROLLER
WILL BE INSTALLED ON THE EXISTING
CONTROLLER FOUNDATION**

**THE EXISTING SERVICE INSTALLATION
WILL REMAIN IS USE WITH THE
PROPOSED LIGHTING CONTROLLER**

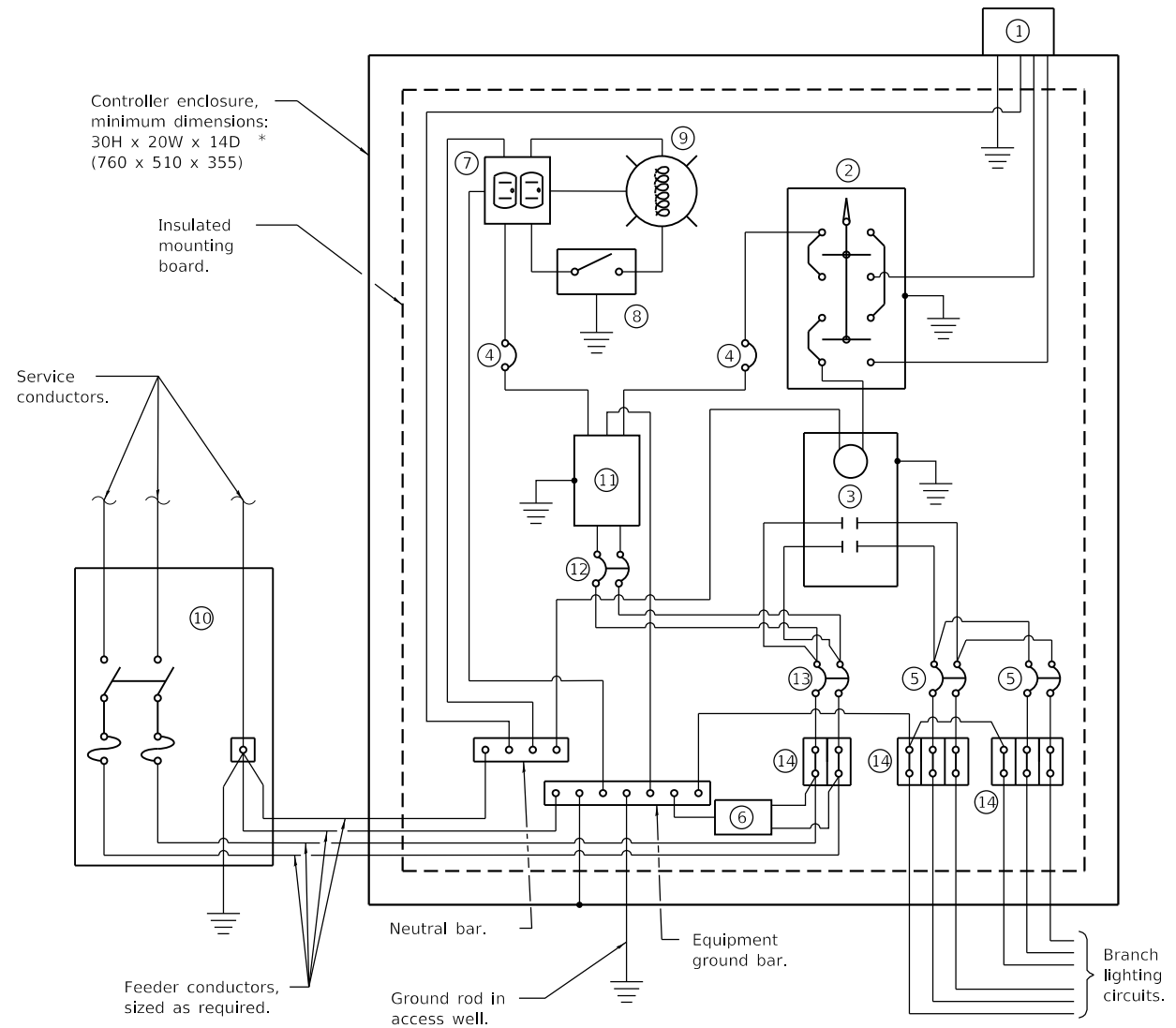

CONTROL SCHEMATIC

- ① Photocell with integral surge arrester.
- ② HAND-OFF-AUTO selector switch.
- ③ 100 amp, electrically held contactor.
- ④ 15 amp, 1-pole circuit breaker.
- ⑤ 20 amp*, 2-pole circuit breaker (two spares required but not shown).
- ⑥ Surge arrester.
- ⑦ GFCI duplex receptacle.
- ⑧ Single-pole, single-throw switch.
- ⑨ Light Fixture, enclosed and gasketted with 800 Lumen LED lightbulb.
- ⑩ Transformer - 1KVA*, 480V primary, 120/240V secondary, single-phase, 60Hz.
- ⑪ 15 amp, 2-pole circuit breaker.
- ⑫ 60 amp*, 2-pole circuit breaker.
- ⑬ Terminal block sized for conductors as shown on plans.

All dimensions are in inches (millimeters) unless otherwise shown.

MODEL: 140DELMAMES
FILE NAME: 31113

USER NAME =	DESIGNED -	REVISED -
DRAWN -	CHECKED -	REVISED -
PLOT SCALE =	DATE -	REVISED -
PLOT DATE =		

**STATE OF ILLINOIS
DEPARTMENT OF TRANSPORTATION**

LIGHTING CONTROLLER DETAIL

SCALE: SHEET OF SHEETS STA. TO STA.

FAP ROUTE	SECTION	COUNTY	TOTAL SHEETS	SHEET NO.
VARIOUS	(17-18)TS-2; (72-7)TS-1; 8TS-1	PEORIA-TAZEWELL ILLINOIS	24	24
CONTRACT NO. 68E39				