

STATE OF ILLINOIS
DEPARTMENT OF TRANSPORTATION

SECTION	COUNTY	TOTAL SHEETS	SHEET NO.
16-00037-00-RS	COOK	15	1
STA. TO STA.			
FED. ROAD DIST. NO. 1		ILLINOIS	FED. AID PROJECT

CONTRACT #61E77

PLANS FOR PROPOSED FEDERAL AID HIGHWAY

MUN 4000 (223RD STREET) AND
MUN 2026 (CORNELL AVENUE)
SAUK TRAIL TO TORRENCE AVENUE

RESURFACING
SECTION NO.: 16-00037-00-RS
PROJECT NO.: 1NYW(519)
VILLAGE of SAUK VILLAGE
COOK COUNTY
C-91-008-17

INDEX OF SHEETS
SEE SHEET NO. 2

HIGHWAY STANDARDS
SEE SHEET NO. 2

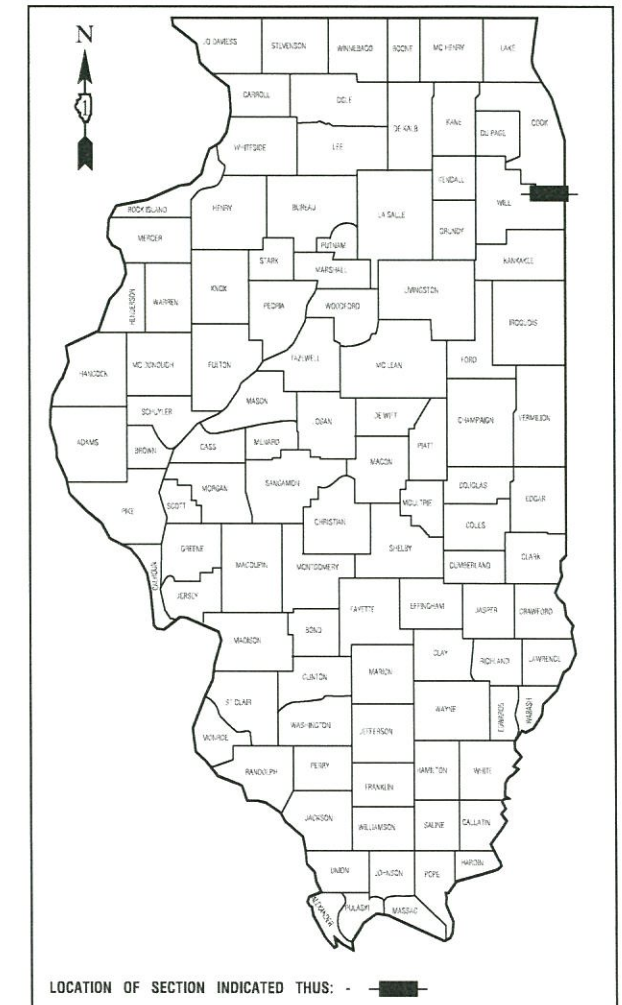

223rd STREET / CORNELL AVENUE	
2017 ADT -	1,050
2030 ADT -	1,050
POSTED SPEED LIMIT -	25 MPH/20 MPH
DESIGN PERIOD -	20 YEARS
DESIGN SPEED LIMIT -	30 mph
STREET CLASSIFICATION -	MINOR COLLECTOR

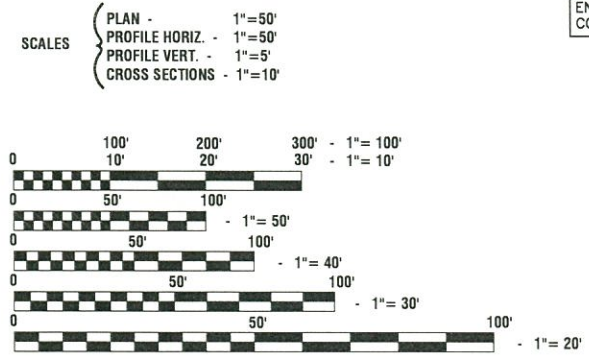

END IMPROVEMENTS
CORNELL AVE STA 110+50.29

END OF IMPROVEMENTS
223RD ST STA 53+76.30

BEGIN IMPROVEMENTS
223RD ST STA 4+63.19

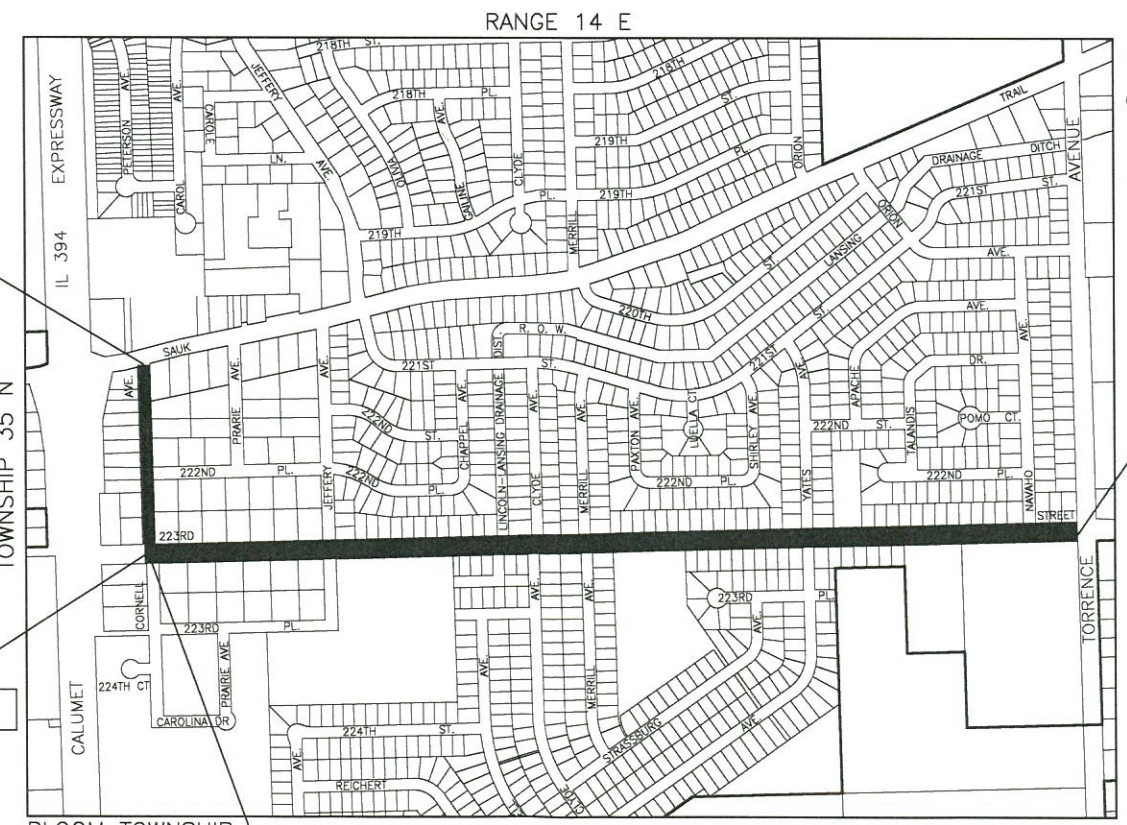

LOCATION MAP

BEGIN IMPROVEMENTS
CORNELL AVE STA 100+67.68

GROSS LENGTH=5,894.42 FEET=1.12 MILES
NET LENGTH=5,894.42 FEET=1.12 MILES

STATE OF ILLINOIS DEPARTMENT OF TRANSPORTATION

Approved: *[Signature]* 2/27/18
President, Village of Sauk Village

Passed: MARCH 6, 2018
[Signature]
District 1, Engineer of Local Roads & Streets

Released for Bid Based on Limited Review: MARCH 20, 2018
[Signature]
Regional Engineer

PREPARED BY OR UNDER THE DIRECT SUPERVISION OF:
[Signature] 2/27/18
TROY A. COLEMAN
67-6230
LICENSED PROFESSIONAL ENGINEER
STATE OF ILLINOIS
LICENSE EXPIRES: 11/30/19

PRINTED BY THE AUTHORITY OF
THE STATE OF ILLINOIS

FULL SIZE PLANS HAVE BEEN PREPARED USING STANDARD ENGINEERING SCALES, REDUCED SIZED PLANS WILL NOT CONFORM TO STANDARD SCALES, IN MAKING MEASUREMENTS ON REDUCED PLANS, THE ABOVE SCALES MAY BE USED.

J. U. L. I. E.
JOINT UTILITY LOCATION INFORMATION FOR EXCAVATION
1-800-892-0123 or 811

CONTRACT NO. 61E77

PROGRAM AND OFFICE ENGINEER: CHARLES F. RIDDLE, P.E. SCHAUMBURG, IL.
CONSULTANTS: ROBINSON ENGINEERING, LTD. 708-331-6700

INDEX OF SHEETS

- 1. COVER SHEET
- 2. INDEX OF SHEETS, HIGHWAY STANDARDS AND GENERAL NOTES
- 3. SUMMARY OF QUANTITIES
- 4. TYPICAL CROSS SECTIONS
- 5.-7. PAVEMENT PLAN
- 8.-10. PAVEMENT MARKING PLAN
- 11.-15. IDOT DISTRICT 1 STANDARD DETAILS

HIGHWAY STANDARDS

- 000001-06 STANDARD SYMBOLS, ABBREVIATIONS AND PATTERNS
- 424001-10 PERPENDICULAR CURB RAMPS
- 442201-03 CLASS C AND D PATCHES
- 602011-02 CATCH BASIN TYPE C
- 604001-04 FRAMES AND LIDS TYPE 1
- 606001-07 CONCRETE CURB TYPE B AND COMBINATION CONCRETE CURB AND GUTTER
- 701006-05 OFF-RD OPERATIONS, 2L, 2W, 15' TO 24" FROM PAVEMENT EDGE
- 701301-04 LANE CLOSURE, 2L, 2W, SHORT TIME OPERATIONS
- 701311-03 LANE CLOSURE, 2L, 2W, MOVING OPERATIONS-DAY ONLY
- 701501-06 URBAN LANE CLOSURE, 2L, 2W, UNDIVIDED
- 701801-06 SIDEWALK, CORNER OR CROSSWALK CLOSURE
- 701901-07 TRAFFIC CONTROL DEVICES
- 720001-01 SIGN PANEL MOUNTING DETAILS
- 720006-04 SIGN PANEL ERECTION DETAILS
- 728001-01 TELESCOPING STEEL SIGN SUPPORT
- 731001-01 BASE FOR TELESCOPING STEEL SIGN SUPPORT
- 780001-05 TYPICAL PAVEMENT MARKINGS

GENERAL NOTES

- 1. THE ROBINSON ENGINEERING, LTD. FIELD OFFICE (708-331-6700), AND THE PUBLIC WORKS DIRECTOR, AT THE VILLAGE OF SAUK VILLAGE SHALL BE NOTIFIED TWO (2) WORKING DAYS BEFORE CONSTRUCTION BEGINS.
- 2. BEFORE STARTING ANY EXCAVATION THE CONTRACTOR SHALL CALL "J.U.L.I.E." AT (800) 892-0123 OR 811 AND (312) 744-7000 FOR FIELD LOCATIONS OF BURIED ELECTRIC, TELEPHONE AND GAS UTILITIES. (48 HOUR NOTIFICATION REQUIRED)
- 3. UTILITIES INDICATED ON THE PLANS ARE PROVIDED FOR THE CONTRACTOR'S USE AND ARE BASED UPON INFORMATION AVAILABLE AT THE TIME OF THE ADVERTISEMENT FOR BIDS. THE OWNER AND ENGINEER DO NOT GUARANTEE THE ACCURACY OF UTILITY INFORMATION.
- 4. IT SHALL BE THE CONTRACTOR'S RESPONSIBILITY TO VERIFY ALL DIMENSIONS AND CONDITIONS EXISTING IN THE FIELD PRIOR TO CONSTRUCTION AND ORDERING OF MATERIALS.
- 5. THE THICKNESS OF HMA MIXTURE STATED IN THE SPECIFICATIONS IS THE NOMINAL THICKNESS. DEVIATIONS FROM THE NOMINAL THICKNESS WILL BE PERMITTED WHEN SUCH DEVIATIONS OCCUR DUE TO IRREGULARITIES IN THE EXISTING SURFACE OR BASE ON WHICH THE HMA SURFACE IS PLACED.
- 6. ANY LOOSE MATERIAL DEPOSITED IN THE FLOW LINE OF DITCHES, GUTTERS OR OTHER DRAINAGE STRUCTURES SHALL BE REMOVED BY THE END OF EACH DAY BY THE CONTRACTOR.
- 7. CLASS D PATCHING QUANTITIES FOR THIS CONTRACT SHALL BE PERFORMED AT THE DIRECTION OF THE ENGINEER AFTER PAVEMENT MILLING.
- 8. EXISTING TREES ARE NOT AFFECTED BY THE LIMITS OF CONSTRUCTION. CONTRACTOR SHALL BE CAUTIOUS ON TREE PROTECTION DURING THE CONSTRUCTION. IF ANY DAMAGE OCCURS, CONTRACTOR SHALL REPLACE ANY TREES.
- 9. NO PAVEMENT PATCHING SHALL BE PERMITTED AFTER FRIDAY AT 3:00PM OF EACH AND EVERY WEEK AND NO HOLES WILL BE ALLOWED TO REMAIN OPEN OVERNIGHT OR OVER THE WEEKEND.
- 10. ALL EQUIPMENT SHALL BE REMOVED OFF THE VILLAGE STREETS DURING ALL HOLIDAY WEEKENDS AS COORDINATED WITH THE VILLAGE.
- 11. HMA PAVING SHALL BE PERFORMED WITH HOT JOINTS. PAVEMENT TESTING CORING HOLES SHALL BE PROPERLY FILLED AND SHOULD AVOID THE TRAFFIC WHEEL PATHS.
- 12. 10 FEET TRANSITIONS SHALL BE USED TO MATCH VARIOUS TYPES OF CURB AND GUTTER ITEMS OF WORK AS INDICATED ON THE PLANS. THE TRANSITIONS AND DEPRESSED CURB LOCATIONS SHALL BE PAID FOR AT THE CONTRACT UNIT PRICE FOR THE PROPOSED ITEMS OF WORK SPECIFIED.

FILE NAME = 16R0439_02-INDEX-01 - IDOT P01	USER NAME =	DESIGNED -- TAG	REVISED --	STATE OF ILLINOIS DEPARTMENT OF TRANSPORTATION	223RD STREET AND CORNELL AVENUE RESURFACING INDEX OF SHEETS & STATE STANDARDS	MUN. RTE.	SECTION	COUNTY	TOTAL SHEETS	SHEET NO.	
	CHECKED -- ----	REVISOR --				4000/2026	16-00037-00-RS	COOK	15	2	
	PLOT SCALE =	DRAWN -- ACAD	REVISED --			CONTRACT NO. 61E77					
	PLOT DATE = 12-07-17	CHECKED -- ACAD	REVISED --			SCALE: NONE	SHEET NO. 2 OF 15 SHEETS	STA. TO STA.	FED. ROAD DIST. NO. 1	ILLINOIS	FED. AID PROJECT ----

SUMMARY OF QUANTITIES					ROADWAY	SAFETY
S.I.	CODE NO.	PAY ITEM	UNIT	QUANTITY	CONSTRUCTION TYPE CODE	
					0005	0021
	20101200	TREE ROOT PRUNING	EACH	3		3
	20200100	EARTH EXCAVATION	CU YD	19		19
	30300001	AGGREGATE SUBGRADE IMPROVEMENT	CU YD	10		10
	35101600	AGGREGATE BASE COURSE, TYPE B 4"	SQ YD	955		955
	35800100	PREPARATION OF BASE	SQ YD	2395	2395	
	35800200	AGGREGATE BASE REPAIR	TON	400	400	
	40201000	AGGREGATE FOR TEMPORARY ACCESS	TON	200	200	
	40600275	BITUMINOUS MATERIALS (PRIME COAT)	POUND	5390	5390	
	40600290	BITUMINOUS MATERIALS (TACK COAT)	POUND	14600	14600	
	40600827	POLYMERIZED LEVELING BINDER (MACHINE METHOD), IL-4.75, N50	TON	855	855	
	40600982	HOT-MIX ASPHALT SURFACE REMOVAL - BUTT JOINT	SQ YD	180	180	
	40603080	HOT-MIX ASPHALT BINDER COURSE, IL-19.0, N50	TON	310	310	
	40603335	HOT-MIX ASPHALT SURFACE COURSE, MIX "D", N50	TON	1940	1940	
	42400200	PORTLAND CEMENT CONCRETE SIDEWALK 5 INCH	SQ FT	3975		3975
	42400400	PORTLAND CEMENT CONCRETE SIDEWALK 7 INCH	SQ FT	450		450
	42400800	DETECTABLE WARNINGS	SQ FT	336		336
	44000157	HOT-MIX ASPHALT SURFACE REMOVAL, 2"	SQ YD	20035	20035	
	44000163	HOT-MIX ASPHALT SURFACE REMOVAL, 3 1/2"	SQ YD	2395	2395	
	44000200	DRIVEWAY PAVEMENT REMOVAL	SQ YD	565	565	
	44000500	COMBINATION CURB AND GUTTER REMOVAL	FOOT	2695	2695	
	44000600	SIDEWALK REMOVAL	SQ FT	4410		4410
	44201713	CLASS D PATCHES, TYPE I, 6 INCH	SQ YD	30	30	
	44201717	CLASS D PATCHES, TYPE II, 6 INCH	SQ YD	80	80	
	44201721	CLASS D PATCHES, TYPE III, 6 INCH	SQ YD	100	100	

* - INDICATES SPECIALTY ITEMS

SUMMARY OF QUANTITIES					ROADWAY	SAFETY
S.I.	CODE NO.	PAY ITEM	UNIT	QUANTITY	CONSTRUCTION TYPE CODE	
					0005	0021
	44201723	CLASS D PATCHES, TYPE IV, 6 INCH	SQ YD	160	160	
	59300100	CONTROLLED LOW-STRENGTH MATERIAL	CU YD	10	10	
	60206905	CATCH BASINS, TYPE C, TYPE 1 FRAME, OPEN LID	EACH	1	1	
	60266600	VALVE BOXES TO BE ADJUSTED	EACH	4	4	
	60500050	REMOVING CATCH BASINS	EACH	1	1	
	60603800	COMBINATION CONCRETE CURB AND GUTTER, TYPE B-6.12	FOOT	475	475	
	60610400	COMBINATION CONCRETE CURB AND GUTTER, TYPE M-6.24	FOOT	210	210	
	67100100	MOBILIZATION	LSUM	1	1	
	70102620	TRAFFIC CONTROL AND PROTECTION, STANDARD 701501	LSUM	1	1	
	70102640	TRAFFIC CONTROL AND PROTECTION, STANDARD 701801	LSUM	1	1	
	* 72000100	SIGN PANEL - TYPE 1	SQ FT	145		145
	* 72400500	RELOCATE SIGN PANEL ASSEMBLY - TYPE A	EACH	1		1
	* 72400710	RELOCATE SIGN PANEL - TYPE 1	SQ FT	9		9
	* 72800100	TELESCOPING STEEL SIGN SUPPORT	FOOT	235		235
	* 78000600	THERMOPLASTIC PAVEMENT MARKING - LINE 12"	FOOT	1630		1630
	* 78000650	THERMOPLASTIC PAVEMENT MARKING - LINE 24"	FOOT	320		320
	Z0004522	HOT-MIX ASPHALT DRIVEWAY PAVEMENT, 6"	SQ YD	155	155	
	Z0004530	HOT-MIX ASPHALT DRIVEWAY PAVEMENT, 8"	SQ YD	350	350	
	Z0017400	DRAINAGE & UTILITY STRUCTURES TO BE ADJUSTED	EACH	51	51	
	Z0017700	DRAINAGE & UTILITY STRUCTURES TO BE RECONSTRUCTED	EACH	1	1	
	X2110104	TOPSOIL FURNISH AND PLACE, 4" (SPECIAL)	SQ YD	1200	1200	
	X2520700	SODDING, SPECIAL	SQ YD	1200	1200	
	X4230720	PORTLAND CEMENT CONCRETE DRIVEWAY PAVEMENT, 7 INCH, SPECIAL	SQ YD	90	90	
	X6030310	FRAMES AND LIDS TO BE ADJUSTED (SPECIAL)	EACH	6	6	
	X6061815	COMBINATION CONCRETE CURB AND GUTTER, TYPE M (SPECIAL)	FOOT	2010	2010	

FILE NAME = 16R0439_02-S00-01 - IDOT-001

USER NAME =	DESIGNED -- TAG	REVISED --
PLOT SCALE =	CHECKED --	REVISED --
PLOT DATE = 12-07-17	DRAWN -- MED	REVISED --
	CHECKED -- APG	REVISED --

STATE OF ILLINOIS
DEPARTMENT OF TRANSPORTATION

223RD STREET AND CORNELL AVENUE
RESURFACING
SUMMARY OF QUANTITIES

SCALE: NONE SHEET NO. 3 OF 15 SHEETS STA. TO STA.

MUN. RTE. 4000/2026	SECTION 16-00037-00-RS	COUNTY COOK	TOTAL SHEETS 15	SHEET NO. 3
FED. ROAD DIST. NO. 1 ILLINOIS FED. AID PROJECT ---- CONTRACT NO. 61E77				

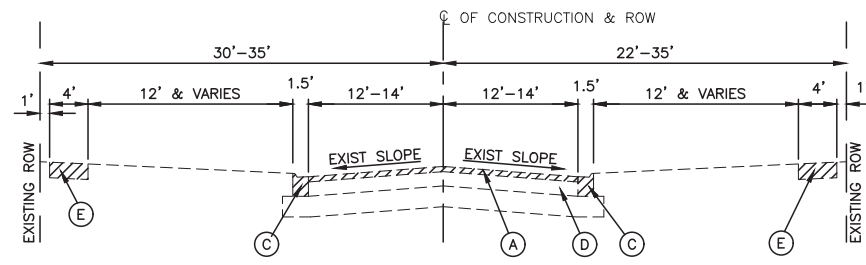

EXISTING TYPICAL SECTION

CORNELL AVENUE FROM SAUK TRAIL TO 223RD STREET
 STA. 100+67.68 TO STA. 110+00
 223RD STREET FROM JEFFREY AVENUE TO CHAPPEL AVENUE
 STA. 13+69.24 TO STA. 21+90.22

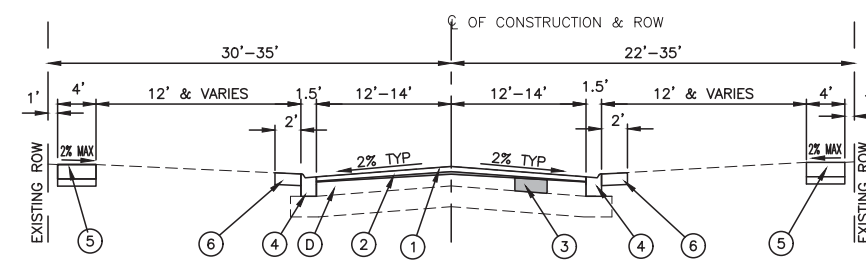

PROPOSED TYPICAL SECTION

CORNELL AVENUE FROM SAUK TRAIL TO 223RD STREET
 STA. 100+67.68 TO STA. 110+00
 223RD STREET FROM JEFFREY AVENUE TO CHAPPEL AVENUE
 STA. 13+69.24 TO STA. 21+90.22

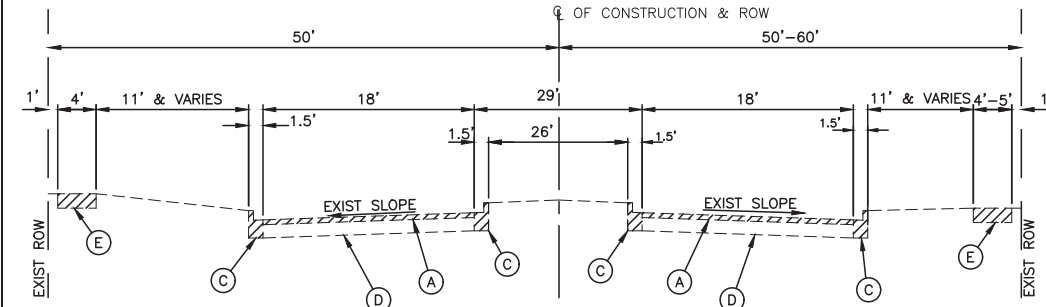

EXISTING TYPICAL SECTION

223RD STREET FROM CHAPPEL AVENUE TO TORRENCE AVENUE
 STA. 21+90.22 TO STA. 53+76.30

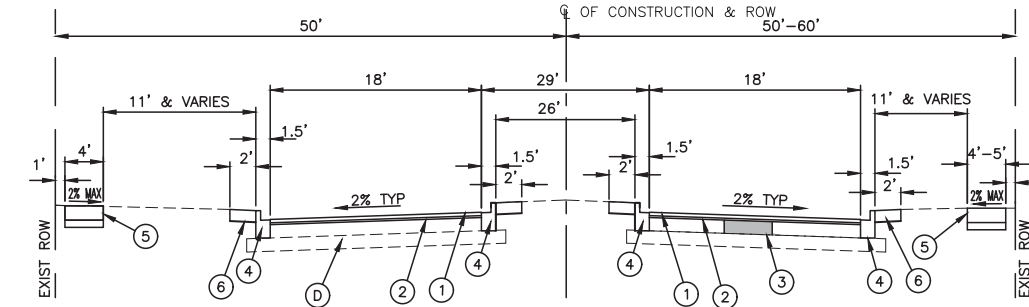

PROPOSED TYPICAL SECTION

223RD STREET FROM CHAPPEL AVENUE TO TORRENCE AVENUE
 STA. 21+90.22 TO STA. 53+76.30

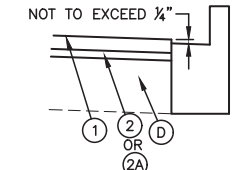

HMA WITH RESPECT TO GUTTER

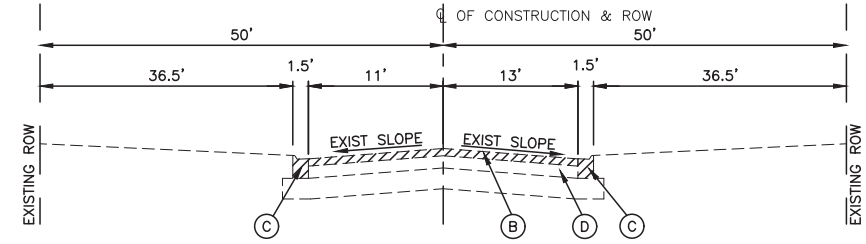

EXISTING TYPICAL SECTION

223RD STREET FROM CORNELL AVENUE TO CHAPPEL AVENUE
 STA. 5+19.444 TO STA. 13+96.24

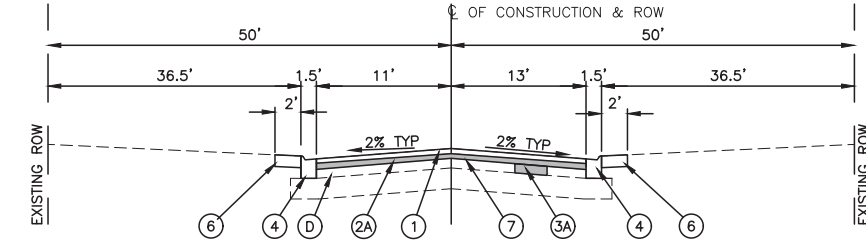

PROPOSED TYPICAL SECTION

223RD STREET FROM CORNELL AVENUE TO CHAPPEL AVENUE
 STA. 5+19.444 TO STA. 13+96.24

NOTES:

- HMA PATCHING (CLASS D) WILL BE PERFORMED AFTER MILLING THE PAVEMENT AT THE DIRECTION OF THE ENGINEER.

EXISTING LEGEND

- (A) HOT MIX ASPHALT SURFACE REMOVAL, 2"
- (B) HOT MIX ASPHALT SURFACE REMOVAL, 3 1/2"
- (C) EXISTING CURB & GUTTER, REMOVAL AT LOCATIONS SHOWN ON PLANS OR DIRECTED BY ENGINEER
- (D) EXISTING PAVEMENT
- (E) EXISTING PCC SIDEWALK TO BE REMOVED AT LOCATIONS SHOWN ON PLANS OR DIRECTED BY ENGINEER (SIDEWALK LOCATION VARIES)

PROPOSED LEGEND

- (1) HOT-MIX ASPHALT SURFACE COURSE, MIX "D", N50, 1 1/2"
- (2) POLYMERIZED LEVELING BINDER (MACHINE METHOD), IL-4.75, N50, 3/4"
- (2A) HOT-MIX ASPHALT BINDER COURSE, IL-19.0 N50, 2 1/4"
- (3) CLASS D PATCH, 6", AT LOCATIONS SHOWN ON PLANS OR DIRECTED BY ENGINEER
- (3A) AGGREGATE BASE REPAIR, AT LOCATIONS AS DIRECTED BY ENGINEER.
- (4) PROPOSED CURB AND GUTTER, TO BE INSTALLED AT LOCATIONS SHOWN ON PLAN OR DIRECTED BY ENGINEER (IN KIND EXCEPT WHERE NOTED)
- (5) PROPOSED PORTLAND CEMENT CONCRETE SIDEWALK 5" (7" ACROSS DRIVEWAYS) & AGGREGATE BASE COURSE, TYPE B, 4" (REPLACEMENT AT LOCATIONS DIRECTED BY THE ENGINEER)
- (6) TOPSOIL FURNISH AND PLACE, 4" SODDING AS DIRECTED BY THE ENGINEER
- (7) PREPARATION OF BASE

HOT-MIX ASPHALT MIXTURE REQUIREMENTS

MIXTURE TYPE	AIR VOIDS
ROADWAY RESURFACING	
HOT MIX ASPHALT SURFACE COURSE, N50, (IL-9.5mm); 1 1/2"	4% @ 50 Gyr.
POLYMERIZED LEVELING BINDER (MACHINE METHOD), IL-4.75, N50, 3/4"	3.5% @ 50 Gyr.
HOT MIX ASPHALT BINDER COURSE, IL-19.0, N50, 2 1/4"	4% @ 50 Gyr.
HOT MIX ASPHALT DRIVEWAY PAVEMENT, 6" OR 8"	
HOT MIX ASPHALT SURFACE COURSE, MIX "D", N50, (IL-9.5mm); 2"	4% @ 50 Gyr.
HOT MIX ASPHALT BINDER COURSE, IL-19.0, N50, PE-4", CE-6"	4% @ 50 Gyr.
PATCHING	
CLASS D PATCHES, (HMA BINDER, IL-19.00mm) 6" (IN 2 LIFTS)	4% @ 70 Gyr.

NOTE:
 THE UNIT WEIGHT USED TO CALCULATE ALL HOT-MIX ASPHALT SURFACE MIXTURE QUANTITIES IS 112 LBS/SY/IN.

THE "AC-TYPE" FOR POLYMERIZED HMA MIXES SHALL BE "SBR/SBR PG 76-22" AND FOR NON-POLYMERIZED HMA THE "AC-TYPE" SHALL BE "PG-64-22" UNLESS MODIFIED BY DISTRICT ONE SPECIAL PROVISIONS. FOR USE OF RECYCLED MATERIALS SEE SPECIAL PROVISIONS.

FILE NAME = 16R0439_02-TYPX-01 - IDOT P01

USER NAME =	DESIGNED -- TAG	REVISED --
	CHECKED --	REVISED --
PLOT SCALE =	DRAWN -- MED	REVISED --
PLOT DATE = 12-07-17	CHECKED -- APG	REVISED --

STATE OF ILLINOIS
 DEPARTMENT OF TRANSPORTATION

223RD STREET AND CORNELL AVENUE
 RESURFACING
 TYPICAL CROSS SECTIONS

SCALE: NONE SHEET NO. 4 OF 15 SHEETS STA. TO STA.

MUN. RTE. 4000/2026	SECTION 16-00037-00-RS	COUNTY COOK	TOTAL SHEETS 15	SHEET NO. 4
CONTRACT NO. 61E77				
FED. ROAD DIST. NO. 1 ILLINOIS FED. AID PROJECT ----				

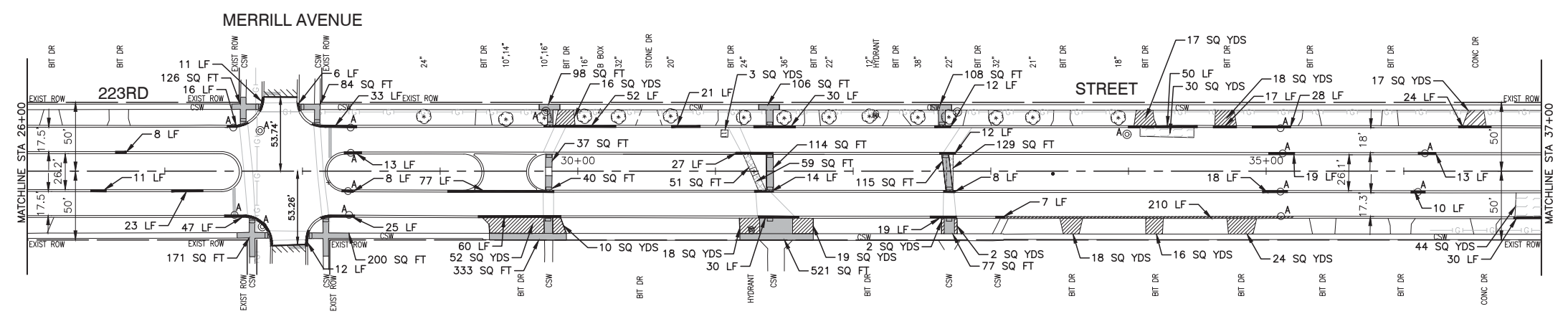
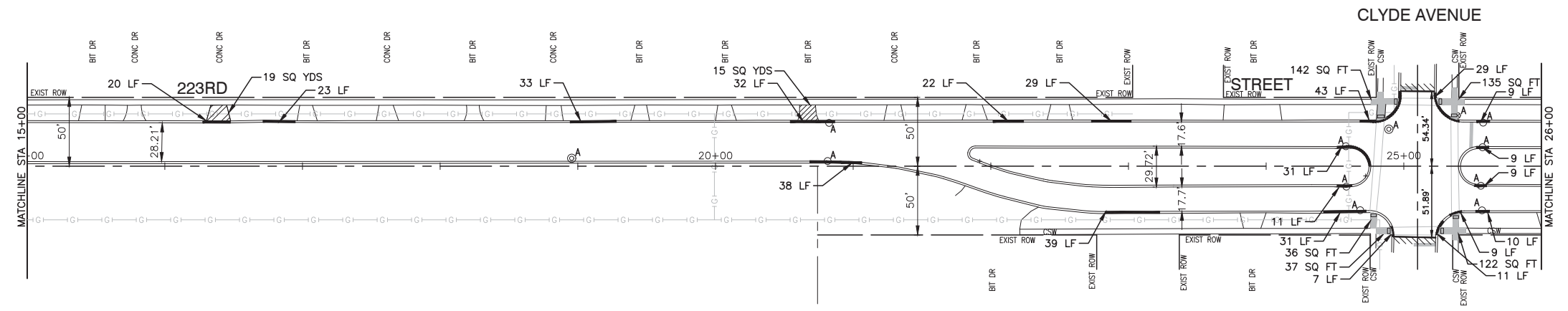
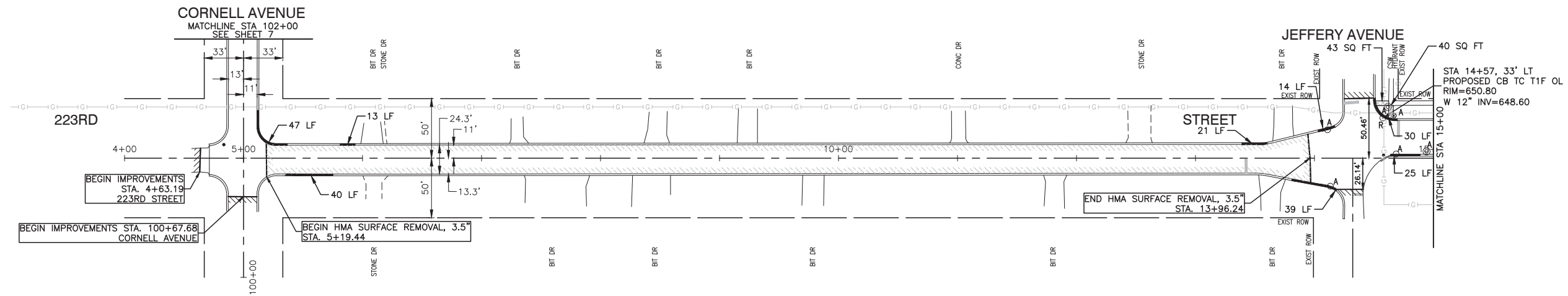

- LEGEND**
- CLASS "D" PATCHES, 6"
 - HMA SURFACE REMOVAL, 3.5" (2" REMOVAL EVERYWHERE ELSE)
 - SIDEWALK REMOVAL
 - CONCRETE DRIVEWAY PAVEMENT REMOVAL AND REPLACEMENT
 - HMA DRIVEWAY PAVEMENT REMOVAL AND REPLACEMENT
 - PROPOSED PCC SIDEWALK OR SIDEWALK REMOVAL AND REPLACEMENT
 - DETECTABLE WARNING
 - BUTT JOINTS
 - COMBINATION CURB AND GUTTER REMOVAL AND REPLACEMENT (IN KIND)
 - COMBINATION CURB AND GUTTER REMOVAL AND REPLACEMENT (M-6.24)
 - "A" STRUCTURE TO BE ADJUSTED
 - "R" STRUCTURE TO BE REMOVED AND REPLACED

FILE NAME = 16R0439_02-PLAN-01 - IDOT P01

USER NAME =	DESIGNED -- TAG	REVISED --
CHECKED --	CHECKED --	REVISED --
PLOT SCALE =	DRAWN -- MED	REVISED --
PLOT DATE = 12-07-17	CHECKED -- APG	REVISED --

STATE OF ILLINOIS
DEPARTMENT OF TRANSPORTATION

223RD STREET AND CORNELL AVENUE RESURFACING PAVEMENT PLAN			
SCALE: 1"=50'	SHEET NO. 5	OF 15 SHEETS	STA. 4+00 TO STA. 37+00

MUN. RTE. 4000/2026	SECTION 16-00037-00-RS	COUNTY COOK	TOTAL SHEETS 15	SHEET NO. 5
CONTRACT NO. 61E77				
FED. ROAD DIST. NO. 1	ILLINOIS	FED. AID PROJECT	----	

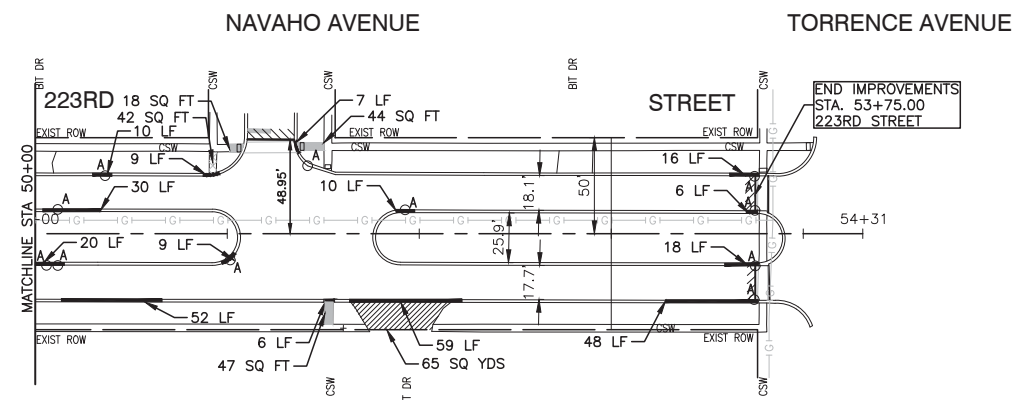
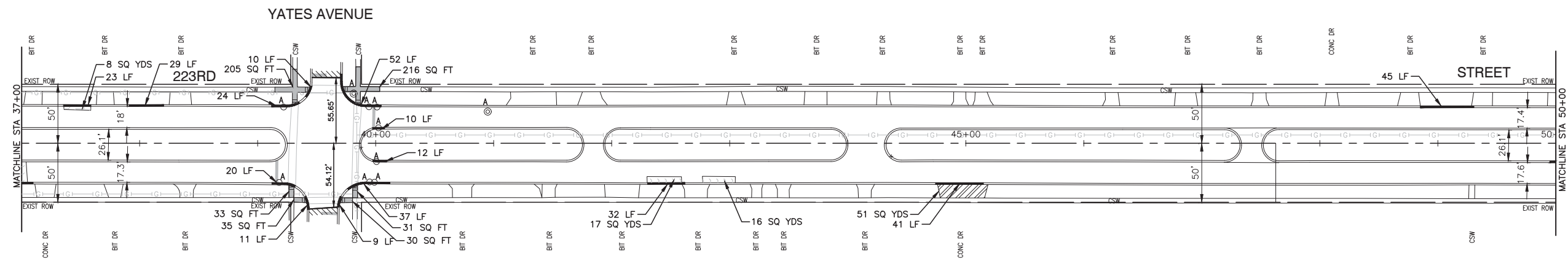

LEGEND

- CLASS "D" PATCHES, 6"
- HMA SURFACE REMOVAL, 3.5" (2" REMOVAL EVERYWHERE ELSE)
- SIDEWALK REMOVAL
- CONCRETE DRIVEWAY PAVEMENT REMOVAL AND REPLACEMENT
- HMA DRIVEWAY PAVEMENT REMOVAL AND REPLACEMENT
- PROPOSED PCC SIDEWALK OR SIDEWALK REMOVAL AND REPLACEMENT
- DETECTABLE WARNING
- BUTT JOINTS
- COMBINATION CURB AND GUTTER REMOVAL AND REPLACEMENT (IN KIND)
- COMBINATION CURB AND GUTTER REMOVAL AND REPLACEMENT (M-6.24)
- "A" STRUCTURE TO BE ADJUSTED
- "R" STRUCTURE TO BE REMOVED AND REPLACED

FILE NAME = 16R0439_02-PLAN-01 - IDOT P01 (2)

USER NAME =	DESIGNED -- TAG	REVISED --
PLOT SCALE =	CHECKED --	REVISED --
PLOT DATE = 12-07-17	DRAWN -- ACAD	REVISED --
	CHECKED -- ACAD	REVISED --

STATE OF ILLINOIS
DEPARTMENT OF TRANSPORTATION

223RD STREET AND CORNELL AVENUE
RESURFACING
PAVEMENT PLAN

SCALE: 1"=50' SHEET NO. 6 OF 15 SHEETS STA. 37+00 TO STA. 54+31

MUN. RTE. 4000/2026	SECTION 16-00037-00-RS	COUNTY COOK	TOTAL SHEETS 15	SHEET NO. 6
CONTRACT NO. 61E77				
FED. ROAD DIST. NO. 1	ILLINOIS	FED. AID PROJECT	----	

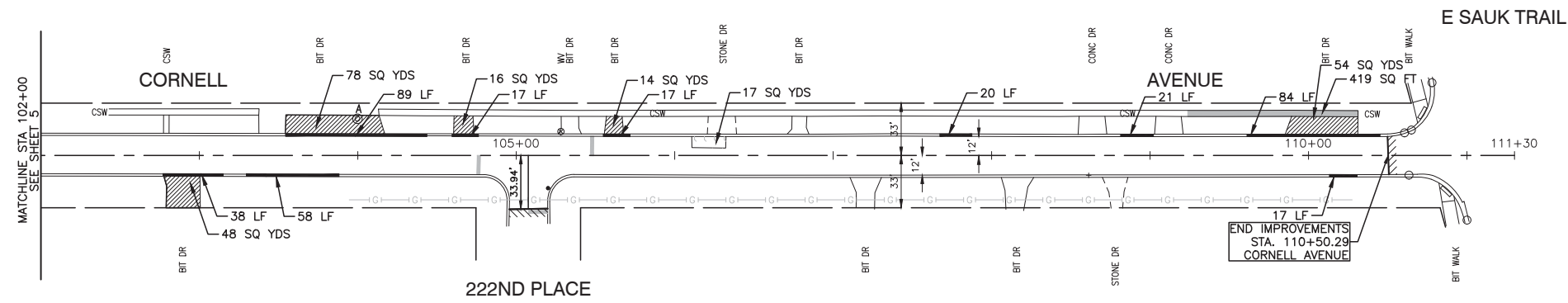
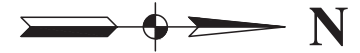

LEGEND

- CLASS "D" PATCHES, 6"
- HMA SURFACE REMOVAL, 3.5"
(2" REMOVAL EVERYWHERE ELSE)
- SIDEWALK REMOVAL
- CONCRETE DRIVEWAY PAVEMENT REMOVAL AND REPLACEMENT
- HMA DRIVEWAY PAVEMENT REMOVAL AND REPLACEMENT
- PROPOSED PCC SIDEWALK OR SIDEWALK REMOVAL AND REPLACEMENT
- DETECTABLE WARNING
- BUTT JOINTS
- COMBINATION CURB AND GUTTER REMOVAL AND REPLACEMENT (IN KIND)
- COMBINATION CURB AND GUTTER REMOVAL AND REPLACEMENT (M-6.24)
- "A" STRUCTURE TO BE ADJUSTED
- "R" STRUCTURE TO BE REMOVED AND REPLACED

FILE NAME = 16R0439_02-PLAN-01 - IDOT P01 (3)	USER NAME =	DESIGNED -- TAG	REVISED --
		CHECKED --	REVISED --
	PLOT SCALE =	DRAWN -- ACAD	REVISED --
	PLOT DATE = 12-07-17	CHECKED -- ACAD	REVISED --

**STATE OF ILLINOIS
DEPARTMENT OF TRANSPORTATION**

**223RD STREET AND CORNELL AVENUE
RESURFACING
PAVEMENT PLAN**

SCALE: 1"=50' SHEET NO. 7 OF 15 SHEETS STA. 102+00 TO STA. 111+30

MUN. RTE. 4000/2026	SECTION 16-00037-00-RS	COUNTY COOK	TOTAL SHEETS 15	SHEET NO. 7
CONTRACT NO. 61E77				
FED. ROAD DIST. NO. 1 ILLINOIS FED. AID PROJECT ----				

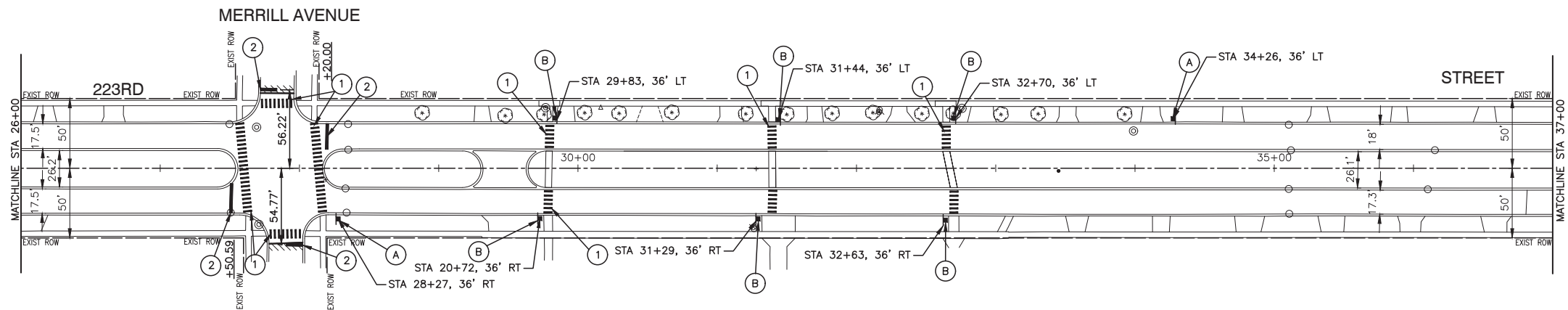
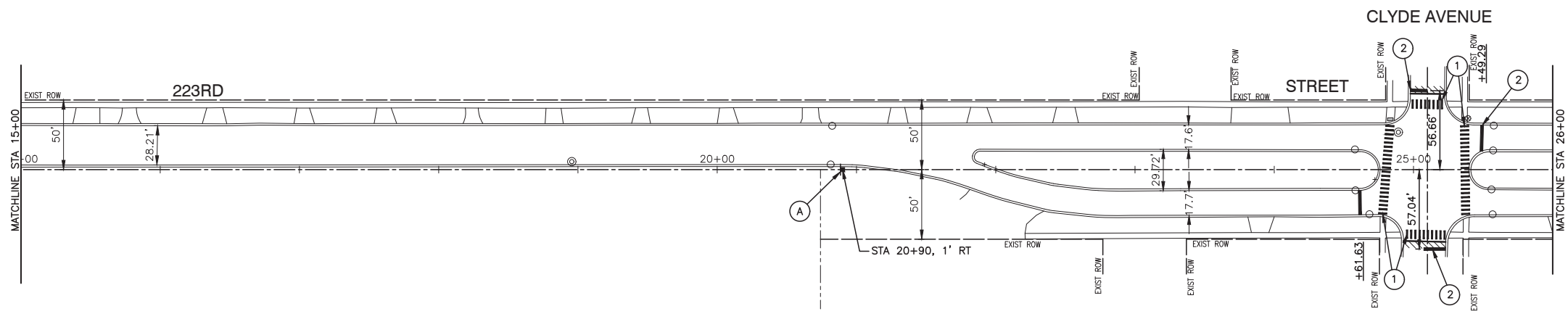
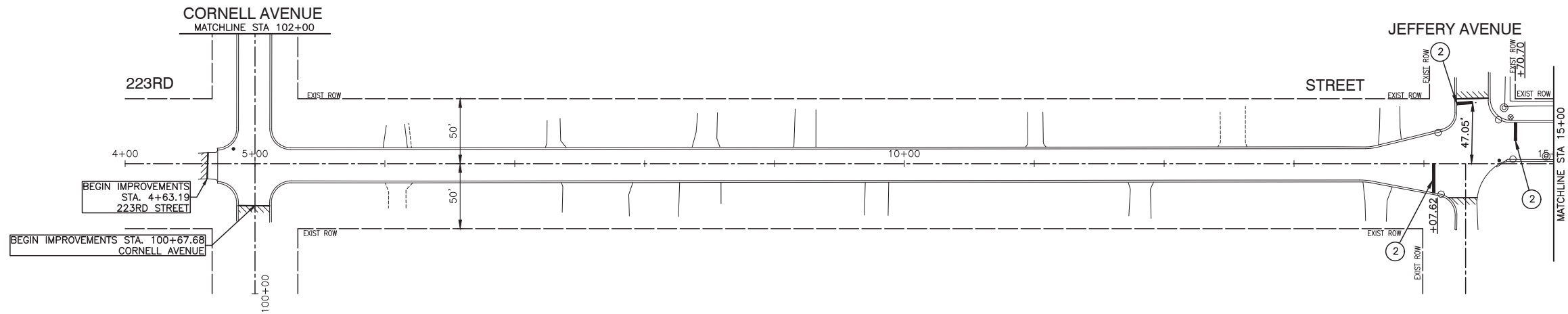

S1-1
36"x36"



W16-9P
24"x12"
SIGN PANEL - TYPE 1
A



S1-1
36"x36"



W16-7PL
24"x12"
SIGN PANEL - TYPE 1
B

LEGEND

- ① THERMOPLASTIC PAVEMENT MARKING - WHITE LINE 12" (3' C-C)
- ② THERMOPLASTIC PAVEMENT MARKING - WHITE LINE 24"

FILE NAME = 16R0439_02-PLAN-02 - IDOT P01

USER NAME =	DESIGNED -- TAG	REVISED --
	CHECKED --	REVISED --
PLOT SCALE =	DRAWN -- MED	REVISED --
PLOT DATE = 12-07-17	CHECKED -- APG	REVISED --

STATE OF ILLINOIS
DEPARTMENT OF TRANSPORTATION

223RD STREET AND CORNELL AVENUE
RESURFACING
PAVEMENT MARKING & SIGNING

SCALE: 1"=50'

SHEET NO. 8 OF 15 SHEETS

STA. 4+00 TO STA. 37+00

MUN. RTE.	SECTION	COUNTY	TOTAL SHEETS	SHEET NO.
4000/2026	16-00037-00-RS	COOK	15	8
CONTRACT NO. 61E77				
FED. ROAD DIST. NO. 1	ILLINOIS	FED. AID PROJECT	----	

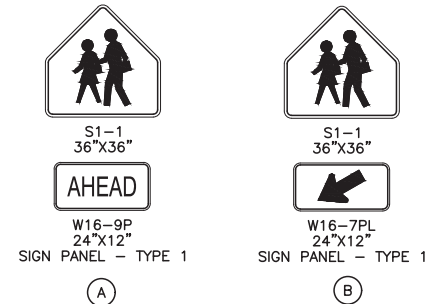
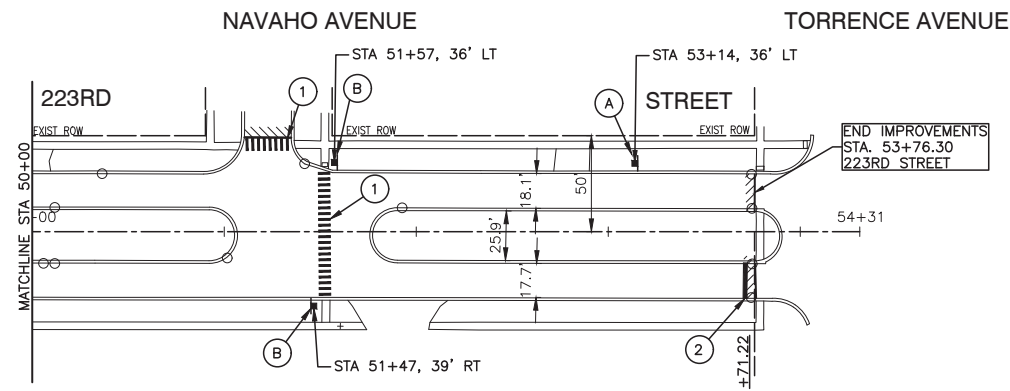
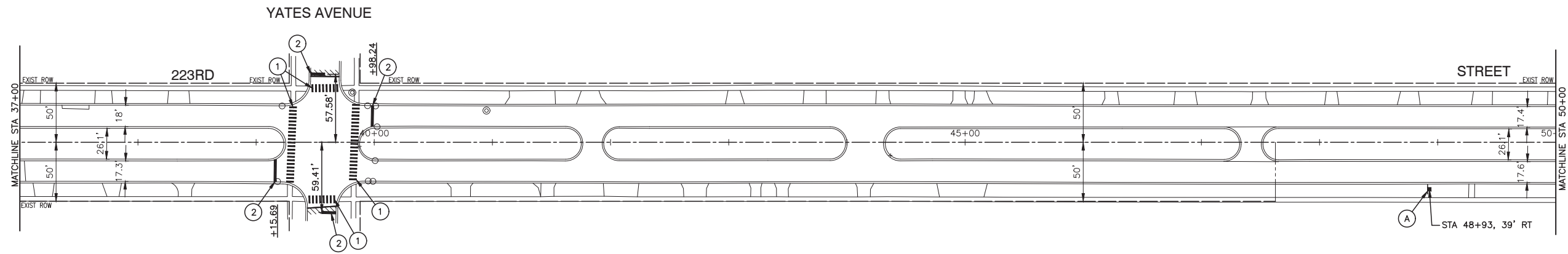

- LEGEND**
- ① THERMOPLASTIC PAVEMENT MARKING - WHITE LINE 12" (3' C-C)
 - ② THERMOPLASTIC PAVEMENT MARKING - WHITE LINE 24"

FILE NAME = 16R0439_02-PLAN-02 - IDOT P01 (2)	USER NAME =	DESIGNED -- TAG	REVISED --
		CHECKED --	REVISED --
	PLOT SCALE =	DRAWN -- MED	REVISED --
	PLOT DATE = 12-07-17	CHECKED -- APG	REVISED --

STATE OF ILLINOIS
DEPARTMENT OF TRANSPORTATION

223RD STREET AND CORNELL AVENUE
RESURFACING
PAVEMENT MARKING & SIGNING

SCALE: 1"=50' SHEET NO. 9 OF 15 SHEETS STA. 37+00 TO STA. 54+31

MUN. RTE.	SECTION	COUNTY	TOTAL SHEETS	SHEET NO.
4000/2026	16-00037-00-RS	COOK	15	9
CONTRACT NO. 61E77				
FED. ROAD DIST. NO. 1	ILLINOIS	FED. AID PROJECT	----	

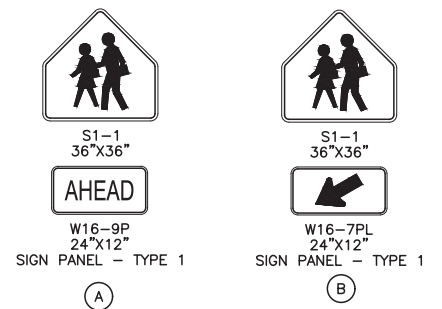
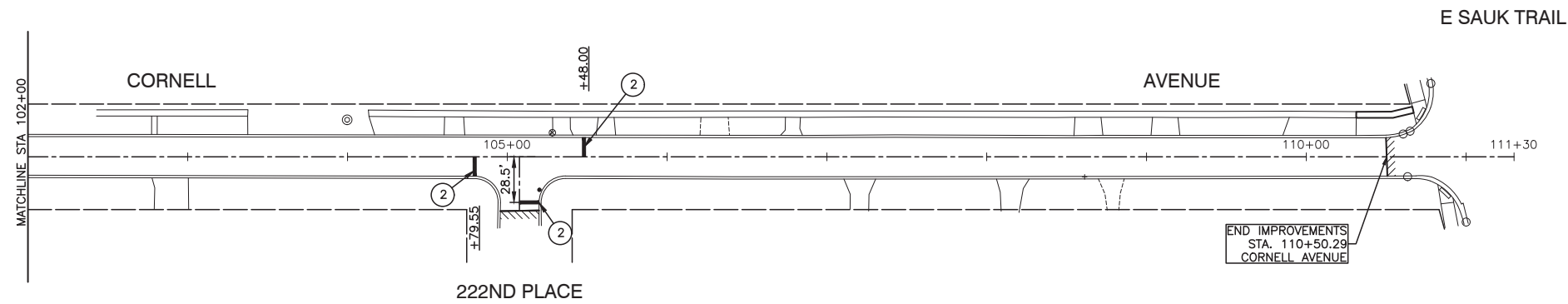
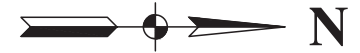

- LEGEND**
- ① THERMOPLASTIC PAVEMENT MARKING - WHITE LINE 12" (3' C-C)
 - ② THERMOPLASTIC PAVEMENT MARKING - WHITE LINE 24"

FILE NAME = 16R0439_02-PLAN-02 - IDOT P01 (3)	USER NAME =	DESIGNED -- TAG	REVISED --
		CHECKED --	REVISED --
	PLOT SCALE =	DRAWN -- MED	REVISED --
	PLOT DATE = 12-07-17	CHECKED -- APG	REVISED --

STATE OF ILLINOIS
DEPARTMENT OF TRANSPORTATION

223RD STREET AND CORNELL AVENUE RESURFACING PAVEMENT MARKING & SIGNING		MUN. RTE. 4000/2026	SECTION 16-00037-00-RS	COUNTY COOK	TOTAL SHEETS 15	SHEET NO. 10
SCALE: 1"=50'	SHEET NO. 10 OF 15 SHEETS	STA. 102+00	TO STA. 111+30	FED. ROAD DIST. NO. 1	ILLINOIS	FED. AID PROJECT ----

MUN. RTE. 4000/2026	SECTION 16-00037-00-RS	COUNTY COOK	TOTAL SHEETS 15	SHEET NO. 10	
CONTRACT NO. 61E77					
FED. ROAD DIST. NO. 1	ILLINOIS	FED. AID PROJECT ----			

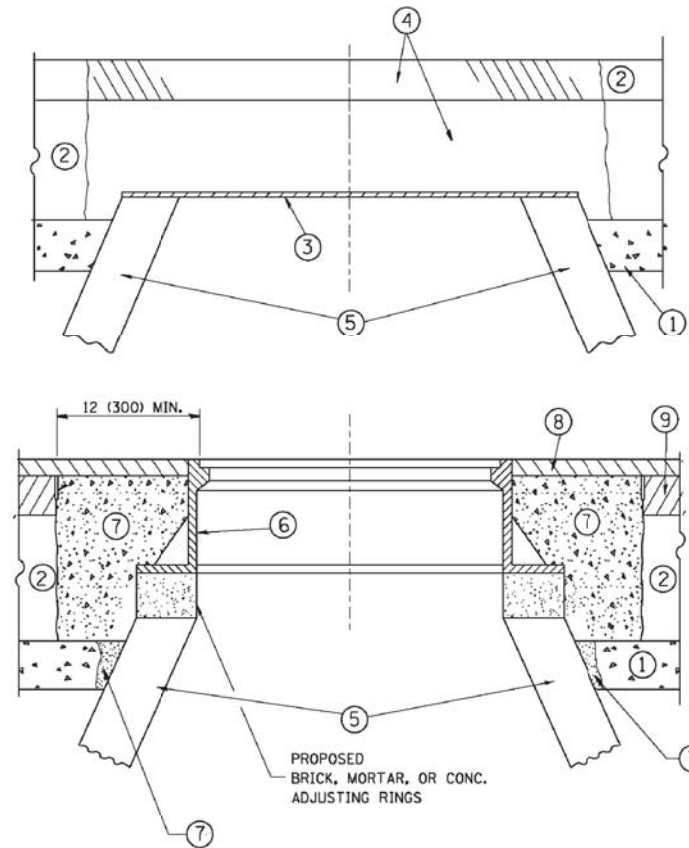

CONSTRUCTION PROCEDURES

STAGE 1 (BEFORE PAVEMENT MILLING)

- A) REMOVE A MINIMUM OF 12 (300) OF THE PAVEMENT FROM AROUND THE STRUCTURE.
- B) REMOVE THE EXISTING FRAME AND LID FROM THE STRUCTURE.
- C) COVER THE STRUCTURE OPENING WITH A 36 (900) DIAMETER METAL PLATE.
- D) BACKFILL WITH CRUSHED STONE AND A MINIMUM 1/2 (40) THICK HMA SURFACE MIX APPROVED BY THE ENGINEER.

STAGE 2 (AFTER PAVEMENT MILLING)

- A) REMOVE THE HMA SURFACE MIX AND CRUSHED STONE.
- B) INSTALL THE FRAME AND LID; ADJUST THE FRAME TO ITS FINAL SURFACE ELEVATION.
- C) THE SURROUNDING SPACE SHALL BE FILLED WITH CLASS PP-1* CONCRETE TO THE ELEVATION OF THE SURFACE OF THE EXISTING BASE COURSE OR THE BINDER COURSE.

*UNLESS OTHERWISE SPECIFIED IN THE PLANS.

THE PROCEDURE EXPLAINED ABOVE SHALL CONFORM TO THE APPLICABLE PORTIONS OF SECTIONS 353, 406, 602, AND 603 OF THE STANDARD SPECIFICATIONS EXCEPT THAT "THE CONTRACTOR SHALL ADJUST THE STRUCTURES TO THE FINISHED PAVEMENT ELEVATION NO MORE THAN 5 CALENDAR DAYS PRIOR TO PLACEMENT OF THE FINAL LIFT OF SURFACE UNLESS APPROVED BY THE ENGINEER."

LEGEND

- ① SUB-BASE GRANULAR MATERIAL
- ② EXISTING PAVEMENT
- ③ 36 (900) DIAMETER METAL PLATE
- ④ PROPOSED CRUSHED STONE AND HMA SURFACE MIX
- ⑤ EXISTING STRUCTURE
- ⑥ FRAME AND LID (SEE NOTES)
- ⑦ CLASS PP-1* CONCRETE
- ⑧ PROPOSED HMA SURFACE COURSE
- ⑨ PROPOSED HMA BINDER COURSE

LOCATION OF STRUCTURES:

THE CONTRACTOR WILL BE REQUIRED TO KEEP A RECORD OF THE LOCATIONS OF THE BURIED STRUCTURES ACCORDING TO THE STATION AND DISTANCE LEFT OR RIGHT OF THE CENTERLINE OF PAVEMENT. UPON COMPLETION OF THE WORK, THE CONTRACTOR WILL DELIVER THE RECORD TO THE ENGINEER.

BASIS OF PAYMENT:

REMOVING FRAMES AND LIDS ON DRAINAGE AND UTILITY STRUCTURES IN THE PAVEMENT PRIOR TO MILLING, AND ADJUSTING TO FINAL GRADE PRIOR TO PLACING THE SURFACE COURSE, WILL BE PAID FOR AT THE CONTRACT UNIT PRICE EACH FOR "FRAMES AND LIDS TO BE ADJUSTED (SPECIAL)."

THIS WORK WILL NOT BE PAID FOR WHEN DRAINAGE AND UTILITY STRUCTURES ARE SPECIFIED FOR PAYMENT AS STRUCTURE RECONSTRUCTION.

NEW FRAMES AND LIDS, WHEN SPECIFIED, WILL BE PAID FOR SEPARATELY.

NOTES:

EXISTING BROKEN FRAMES AND LIDS SHALL BE REMOVED AND DISPOSED OF BY THE CONTRACTOR AND SHALL BE REPLACED AS DIRECTED BY THE ENGINEER. REPLACEMENT FRAMES AND LIDS WILL BE PAID FOR IN ACCORDANCE WITH ARTICLE 109.04 OF THE STANDARD SPECIFICATIONS UNLESS A SEPARATE PAY ITEM HAS BEEN PROVIDED.

IF THE EXISTING LIDS ARE OPEN, THE FRAME WILL BE ADJUSTED TO THE ELEVATION OF THE MILLED PAVEMENT SURFACE PRIOR TO THE MILLING OPERATION. THE FRAME WILL NOT BE REMOVED AND COVERED BY THE METAL PLATE.

CITY OF CHICAGO CASTINGS ARE THE PROPERTY OF THE CITY AND THE CONTRACTOR SHALL NOTIFY THE CITY FOR REMOVAL AND DISPOSITION OF THE CASTINGS.

THE METAL PLATE USED TO COVER THE STRUCTURE SHALL REMAIN THE PROPERTY OF THE CONTRACTOR.

WHEN STRUCTURES ARE TO BE ADJUSTED OR RECONSTRUCTED, THE LOWERING AND RAISING OF THE FRAMES AND LIDS WILL NOT BE PAID FOR SEPARATELY BUT WILL BE INCLUDED IN THE COST OF THE CORRESPONDING PAY ITEM.

DETAILS FOR FRAMES AND LIDS ADJUSTMENT WITH MILLING

ALL DIMENSIONS ARE IN INCHES (MILLIMETERS) UNLESS OTHERWISE SHOWN

FILE NAME = 16R0439_02-DTLS-01 - IDOT P01	USER NAME =	DESIGNED -- R. SHAH	REVISED --R. WIEDEMAN 05-14-04
	CHECKED --		REVISED --R. BORO 01-01-07
	PLOT SCALE =	DRAWN --	REVISED --R. BORO 03-09-11
	PLOT DATE = 12-07-17	CHECKED -- 10-25-94	REVISED --R. BORO 12-06-11

STATE OF ILLINOIS
DEPARTMENT OF TRANSPORTATION

SCALE:		SHEET NO. 11 OF 15 SHEETS		STA. TO STA.	
MUN. RTE. 4000/2026		SECTION 16-00037-00-RS		COUNTY COOK	
FED. ROAD DIST. NO. 1		ILLINOIS		FED. AID PROJECT ----	
BD600-03 (BD-8)		CONTRACT NO. 61E77		TOTAL SHEETS 15	SHEET NO. 11

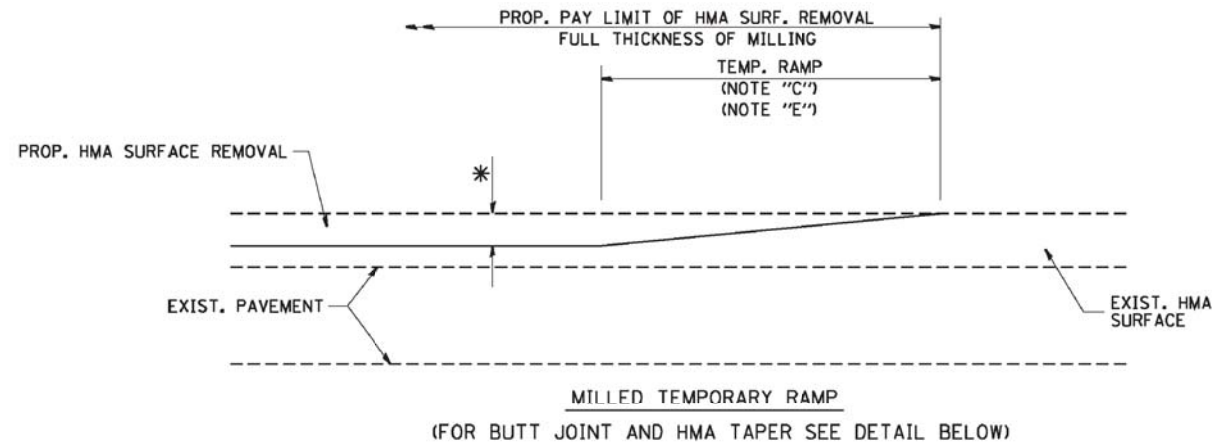

OPTION 1

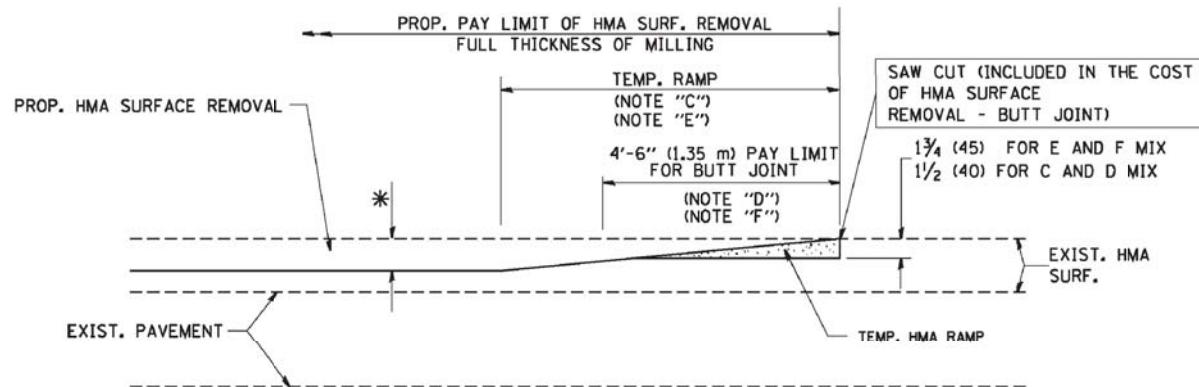

OPTION 2
(FOR BUTT JOINT AND HMA TAPER SEE DETAIL BELOW)

TYPICAL TEMPORARY RAMP

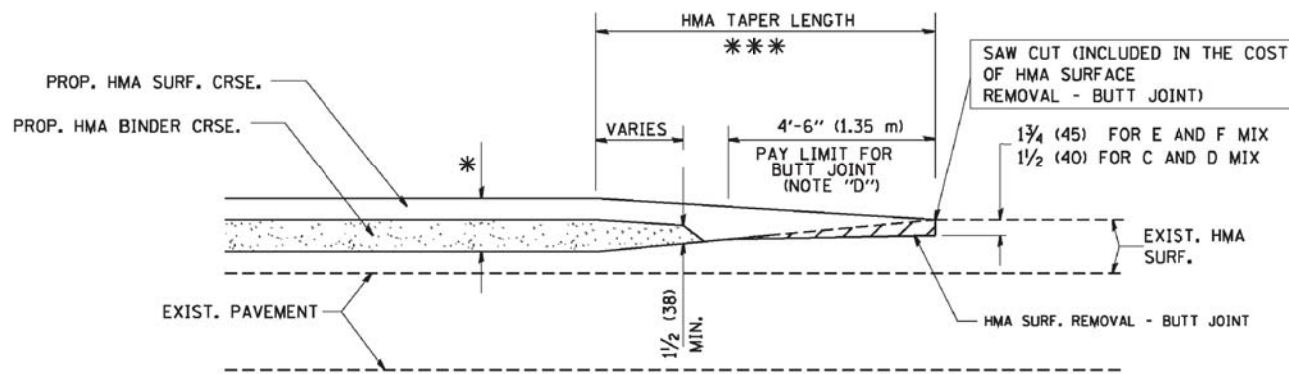

TYPICAL BUTT JOINT AND HMA TAPER FOR MILLING AND RESURFACING

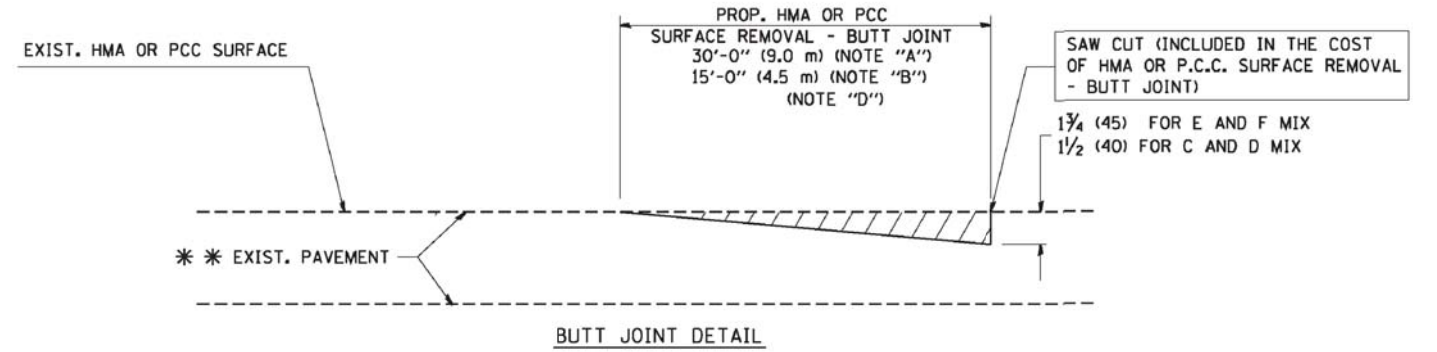

BUTT JOINT DETAIL

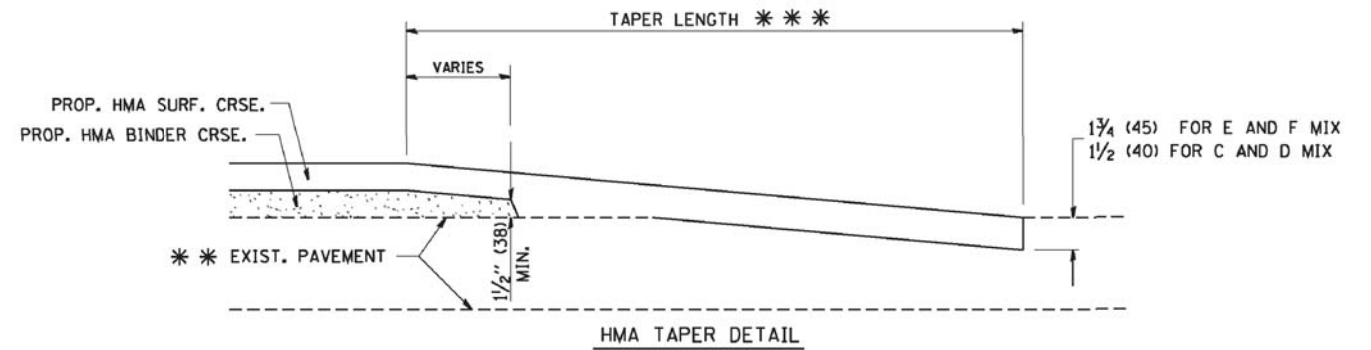

HMA TAPER DETAIL

TYPICAL BUTT JOINT AND HMA TAPER FOR RESURFACING ONLY

*** PC CONCRETE, HMA OR HMA RESURFACED PAVEMENT.

NOTES

- A: MAINLINE ROADWAYS AND MAJOR SIDE ROADS.
 - B: MINOR SIDE ROADS.
 - C: THE TEMP. RAMP SHALL BE CONSTRUCTED IMMEDIATELY UPON REMOVAL OF THE EXISTING HMA SURFACE.
 - D: THE BUTT JOINT SHALL BE CONSTRUCTED IMMEDIATELY PRIOR TO PLACING THE PROPOSED HMA COURSES.
 - E: TAPER THE TEMP. RAMP AT A RATE OF 3'-0" (900 mm) PER 1 INCH (25 mm) OF MILLING THICKNESS.
 - F: INSTALLATION AND REMOVAL OF THE 4'-6" (1.35 m) TEMP. RAMP IS INCLUDED IN COST OF HMA SURFACE REMOVAL - BUTT JOINT
 - G: SEE ARTICLE 406.08 AND 406.14 OF THE STANDARD SPECIFICATIONS FOR "HMA AND/OR PCC SURFACE REMOVAL, BUTT JOINT".
- * SEE TYPICAL SECTIONS FOR MILLING THICKNESS.
- *** 20'-0" (6.1 m) PER 1 (25) RESURFACING (NOTE "A")
10'-0" (3.0 m) PER 1 (25) RESURFACING (NOTE "B")

BASIS OF PAYMENT:

THE BUTT JOINT WILL BE PAID FOR AT THE CONTRACT UNIT PRICE PER SQUARE YARD (SQUARE METER) FOR "HOT-MIX ASPHALT SURFACE REMOVAL - BUTT JOINT" OR FOR "PORTLAND CEMENT CONCRETE SURFACE REMOVAL - BUTT JOINT".

ALL DIMENSIONS ARE IN INCHES (MILLIMETERS) UNLESS OTHERWISE SHOWN.

FILE NAME = 16R0439_02-DTLS-01 - IDOT P01 (2)	USER NAME =	DESIGNED -- M. DE YONG	REVISED -- R. SHAH 10-25-94
	CHECKED --	CHECKED -- A. ABBAS 03-21-97	REVISED -- M. GOMEZ 04-06-01
	PLOT SCALE =	DRAWN --	REVISED -- R. BORO 01-01-07
	PLOT DATE = 12-07-17	CHECKED -- 06-13-90	

STATE OF ILLINOIS
DEPARTMENT OF TRANSPORTATION

**BUTT JOINT AND
HMA TAPER DETAILS**

SCALE: SHEET NO. 12 OF 15 SHEETS STA. TO STA.

MUN. RTE.	SECTION	COUNTY	TOTAL SHEETS	SHEET NO.
4000/2026	16-00037-00-RS	COOK	15	12
BD400-05 BD32		CONTRACT NO. 61E77		
FED. ROAD DIST. NO. 1	ILLINOIS	FED. AID PROJECT	---	

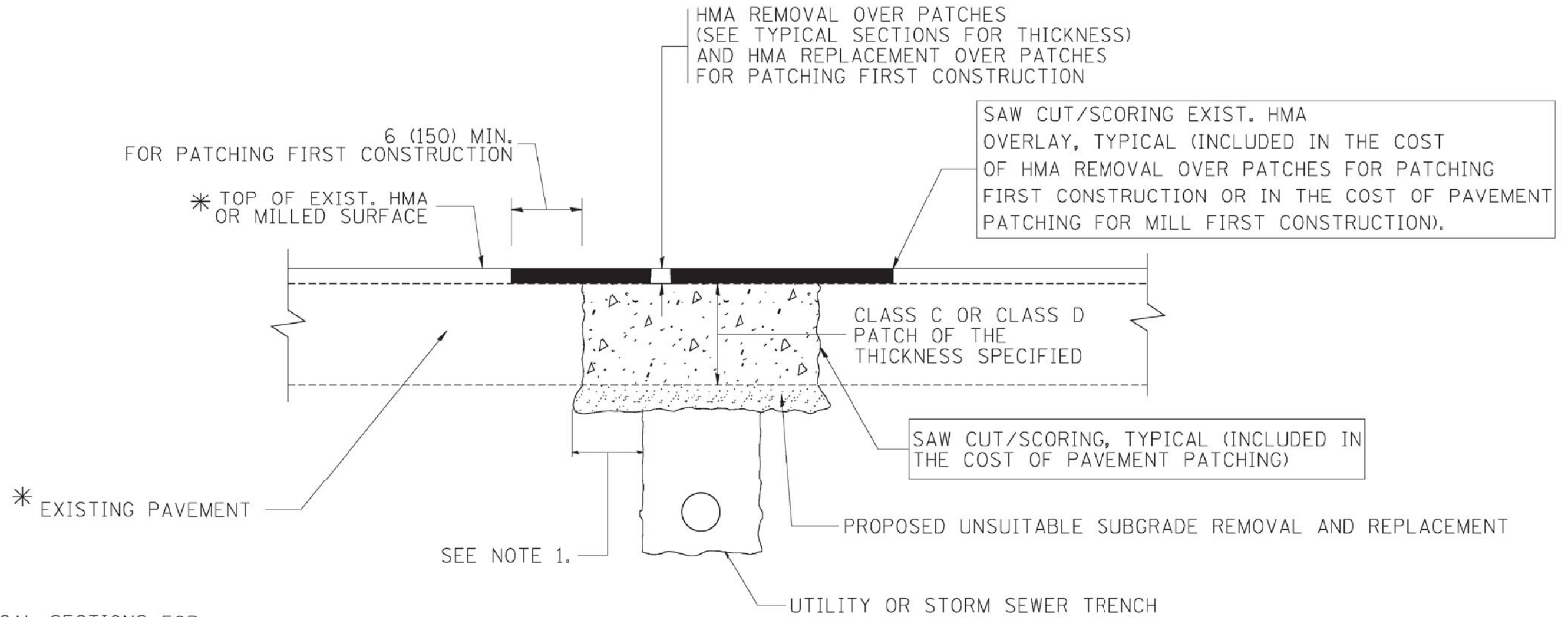

* SEE TYPICAL SECTIONS FOR THICKNESS AND MATERIALS

NOTES:

1. THE WIDTH OF THE FULL DEPTH PATCH OVER A TRENCH SHALL BE 12 (300) WIDER ON EACH SIDE OF THE TRENCH.
2. FOR METHOD OF MEASUREMENT AND BASIS OF PAYMENT, SEE RECURRING SPECIAL PROVISION "PATCHING WITH HOT-MIX ASPHALT OVERLAY REMOVAL".

SEQUENCE OF CONSTRUCTION (PATCHING FIRST)

1. REMOVE THE EXISTING HMA MATERIAL OVER THE AREA TO BE PATCHED.
2. REMOVE AND REPLACE WITH CLASS C OR D PATCH.
3. REPLACE HMA MATERIAL OVER THE AREA TO BE PATCHED.

SEQUENCE OF CONSTRUCTION (MILLING FIRST)

1. MILL HMA FIRST IF THERE IS AT LEAST 4 1/2 INCHES OR MORE OF HMA MATERIAL ON TOP OF THE EXISTING PAVEMENT OR IF THE PAVEMENT IS FULL DEPTH HMA. A MINIMUM OF 2 INCHES OF HMA MATERIAL SHALL BE IN PLACE AFTER MILLING.
2. REMOVE AND REPLACE WITH FULL DEPTH CLASS D PATCHES TO TOP OF MILLED SURFACE.

ALL DIMENSIONS ARE IN INCHES (MILLIMETERS) UNLESS OTHERWISE SHOWN.

FILE NAME = 16R0439_02-DTLS-01 - IDOT P01 (3)	USER NAME =	DESIGNED -- R. SHAH	REVISED -- A. ABBAS 04-27-98
		CHECKED --	REVISED -- R. BORO 01-01-07
	PLOT SCALE =	DRAWN --	REVISED -- R. BORO 09-04-07
	PLOT DATE = 12-07-17	CHECKED -- 10-25-94	REVISED -- K. ENG 10-27-08

STATE OF ILLINOIS
DEPARTMENT OF TRANSPORTATION

PAVEMENT PATCHING FOR
HMA SURFACED PAVEMENT

SCALE: SHEET NO. 13 OF 15 SHEETS STA. TO STA.

MUN. RTE.	SECTION	COUNTY	TOTAL SHEETS	SHEET NO.
4000/2026	16-00037-00-RS	COOK	15	13
BD400-04 (BD-22)		CONTRACT NO. 61E77		
FED. ROAD DIST. NO. 1	ILLINOIS	FED. AID PROJECT	---	

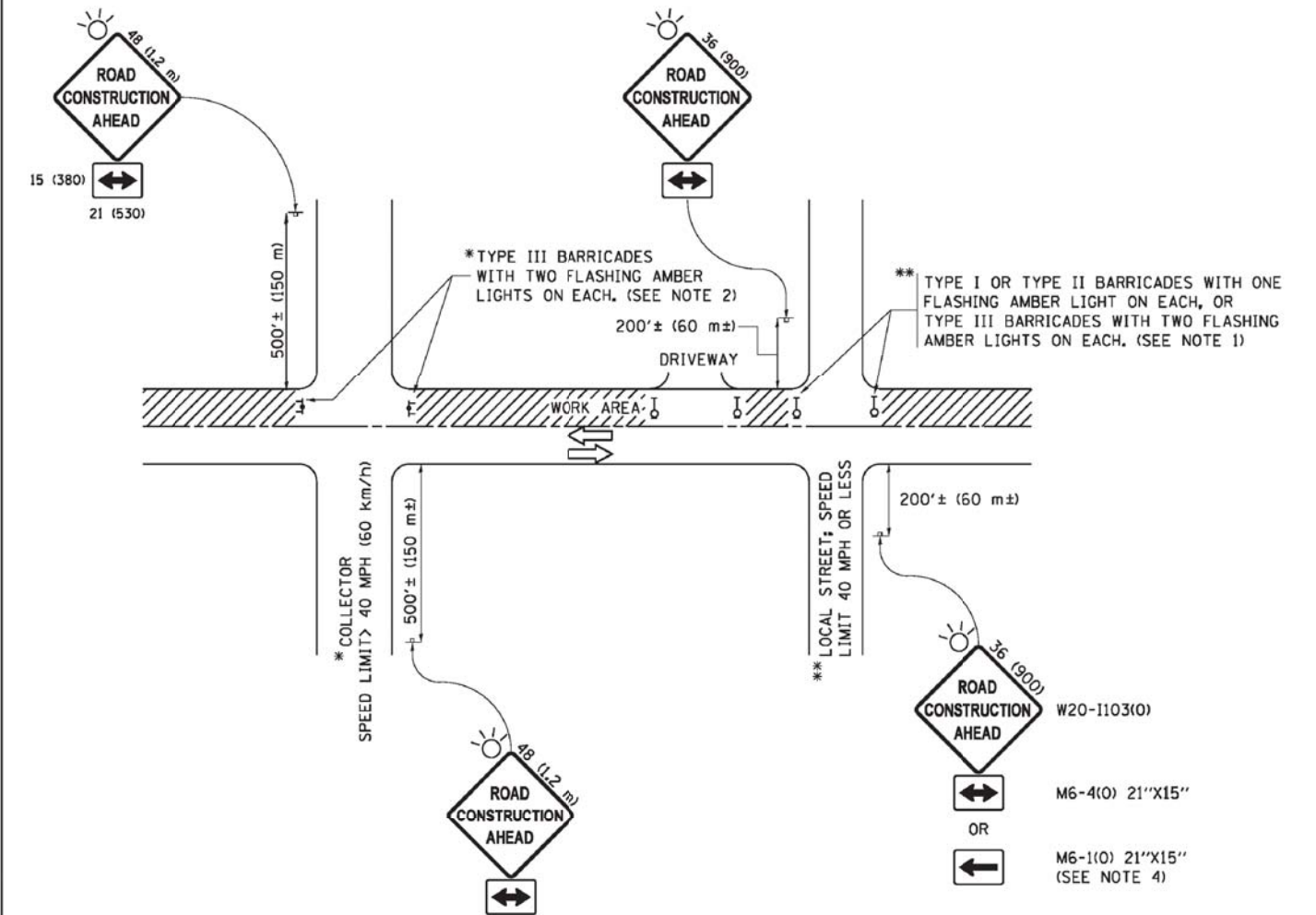

NOTES:

1. SIDE ROAD WITH A SPEED LIMIT OF 40 MPH (60 km/h) OR LESS AS SHOWN ON THE DRAWING AND AS DIRECTED BY THE ENGINEER:
 - a) ONE "ROAD CONSTRUCTION AHEAD" SIGN 36 x 36 (900x900) WITH A FLASHER MOUNTED ON IT APPROXIMATELY 200' (60 m) IN ADVANCE OF THE MAIN ROUTE.
 - b) THE CLOSED PORTION OF THE MAIN ROUTE SHALL BE PROTECTED BY BLOCKING WITH TYPE I, TYPE II OR TYPE III BARRICADES, 1/3 OF THE CROSS SECTION OF THE CLOSED PORTION.
2. SIDE ROAD WITH A SPEED LIMIT GREATER THAN 40 MPH (60 km/h) AS SHOWN ON THE DRAWING AND AS DIRECTED BY THE ENGINEER:
 - a) ONE "ROAD CONSTRUCTION AHEAD" SIGN 48 x 48 (1.2 m x 1.2 m) WITH A FLASHER MOUNTED ON IT APPROXIMATELY 500' (150 m) IN ADVANCE OF THE MAIN ROUTE.
 - b) THE CLOSED PORTION OF THE MAIN ROUTE SHALL BE PROTECTED BY BLOCKING WITH TYPE III BARRICADES, 1/2 OF THE CROSS SECTION OF THE CLOSED PORTION.
3. CONES MAY BE SUBSTITUTED FOR BARRICADES OR DRUMS AT HALF THE SPACING DURING DAY OPERATIONS. CONES SHALL BE A MINIMUM OF 28 (710) IN HEIGHT.
4. WHEN THE SIDE ROAD LIES BETWEEN THE BEGINNING OF THE MAINLINE SIGNING AND THE WORK ZONE, A SINGLE HEADED ARROW (M6-1) SHALL BE USED IN LIEU OF THE DOUBLE HEADED ARROW (M6-4).
5. WHEN WORK IS BEING PERFORMED ON A SIDE ROAD OR DRIVEWAY, FOLLOW THE APPLICABLE STANDARD(S). THE DIRECTIONAL ARROW (M6-1 OR M6-4) SHALL BE COVERED OR REMOVED WHEN NO LONGER CONSISTENT WITH THE TRAFFIC CONTROL SET-UP.
6. ADVANCE WARNING SIGNS ARE TO BE OMITTED ON DRIVEWAYS UNLESS OTHERWISE SPECIFIED IN THE PLANS OR BY THE ENGINEER.
7. THE TRAFFIC CONTROL AND PROTECTION FOR SIDE ROADS, INTERSECTIONS, AND DRIVEWAYS SHALL BE INCLUDED IN THE COST OF SPECIFIED TRAFFIC CONTROL STANDARDS OR ITEMS.

All dimensions are in inches (millimeters) unless otherwise shown.

FILE NAME = 16R0439_02-DTLS-01 - IDOT P01 (4)	USER NAME =	DESIGNED -- L.H.A.	REVISED -- A. HOUSEH 10-15-96
	CHECKED -- CAD\ahets\to18.dgn	REVISIONS -- RAMMACHER 01-06-00	
	PLOT SCALE =	DRAWN --	REVISED -- A. SCHUETZE 07-01-13
	PLOT DATE = 12-07-17	CHECKED -- 06-89	REVISED -- A. SCHUETZE 09-15-16

STATE OF ILLINOIS
DEPARTMENT OF TRANSPORTATION

**TRAFFIC CONTROL AND PROTECTION FOR
SIDE ROADS, INTERSECTIONS, AND DRIVEWAYS**

SCALE: SHEET NO. 14 OF 15 SHEETS STA. TO STA.

MUN. RTE. 4000/2026	SECTION 16-00037-00-RS	COUNTY COOK	TOTAL SHEETS 15	SHEET NO. 14
TC-10		CONTRACT NO. 61E77		
FED. ROAD DIST. NO. 1 ILLINOIS FED. AID PROJECT ----				

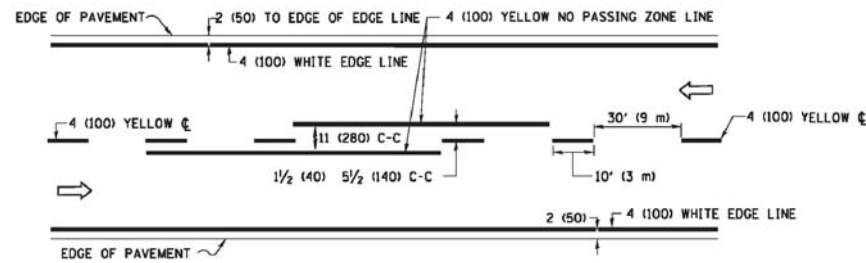

2-LANE ROADWAY

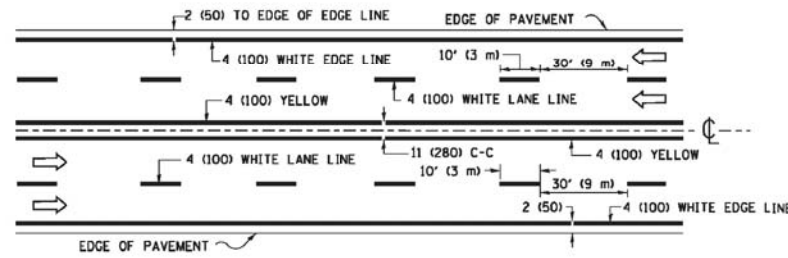

MULTI-LANE UNDIVIDED

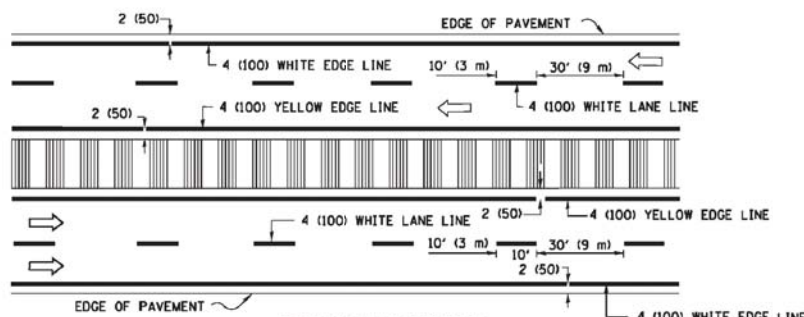

MULTI-LANE DIVIDED WITH MEDIAN

TYPICAL LANE AND EDGE LINE MARKING

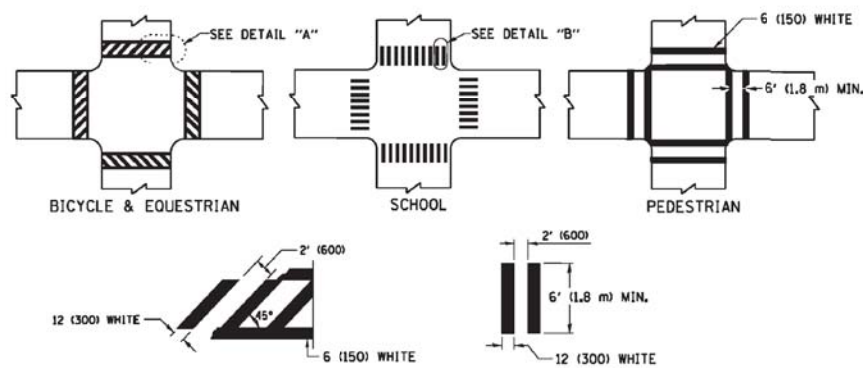

DETAIL "A"

DETAIL "B"

TYPICAL CROSSWALK MARKING

* MARKINGS SHALL BE INSTALLED PARALLEL TO THE CENTERLINE OF THE ROAD WHICH IT CROSSES

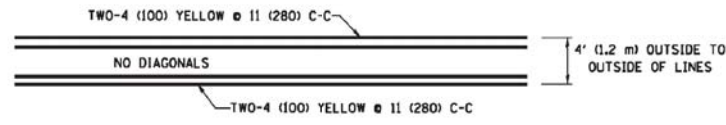

4' (1.2 m) WIDE MEDIANS ONLY

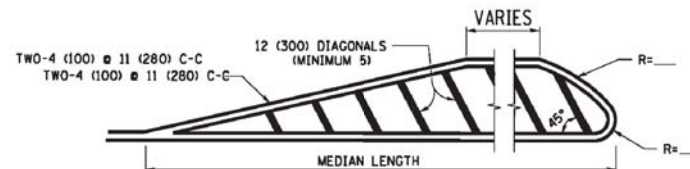

FOR MEDIAN LENGTHS WHERE DIAGONAL SPACING CANNOT BE ATTAINED, USE 5 (FIVE) EQUALLY SPACED DIAGONAL LINES.

DIAGONAL LINE SPACING: 50' (15 m) C-C (LESS THAN 30MPH (50 km/h))
75' (25 m) C-C (30MPH (50 km/h) TO 45MPH (70 km/h))
150' (45 m) C-C (MORE THAN 45MPH (70 km/h))

MEDIANS OVER 4' (1.2 m) WIDE

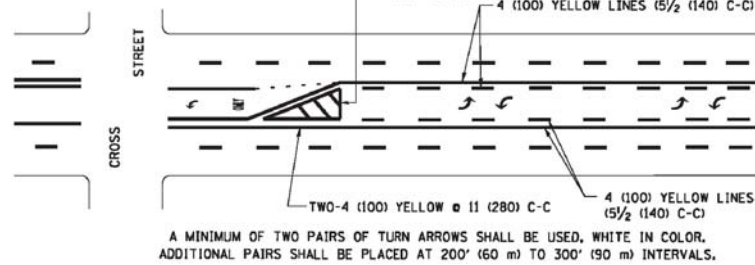

MEDIAN WITH TWO-WAY LEFT TURN LANE

TYPICAL PAINTED MEDIAN MARKING

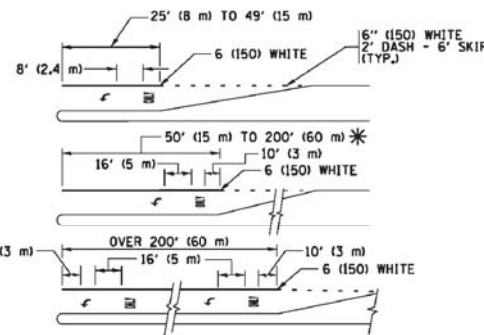

FULL SIZE LETTERS 8' (2.4 m) AND ARROWS SHALL BE USED. AREA = 15.6 SQ. FT. (1.5 m²) ONLY AREA = 20.8 SQ. FT. (1.9 m²)

* TURN LANES IN EXCESS OF 400' (120 m) IN LENGTH MAY HAVE AN ADDITIONAL SET OF ARROW - "ONLY" INSTALLED MIDWAY BETWEEN THE OTHER TWO SETS OF ARROW - "ONLY".

TYPICAL LEFT (OR RIGHT) TURN LANE

TYPICAL TURN LANE MARKING

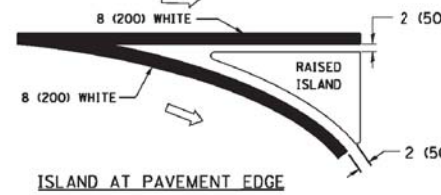
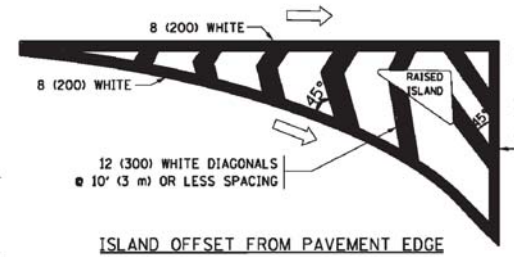

TYPICAL ISLAND MARKING

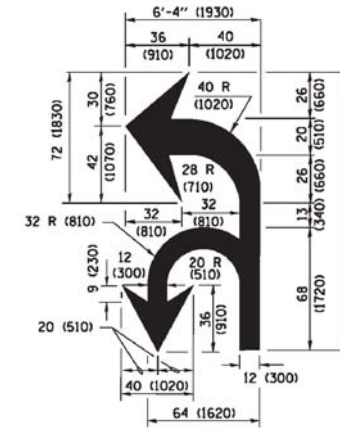

COMBINATION LEFT AND U-TURN

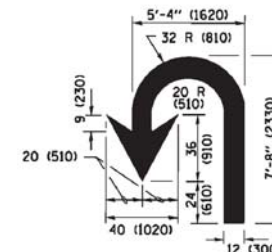

U-TURN

LANE REDUCTION TRANSITION

* LANE REDUCTION ARROWS REQUIRED AT SPEEDS OF 45 MPH OR GREATER OR WHEN SPECIFIED IN PLANS.

D(FT)	SPEED LIMIT
345	30
425	35
500	40
580	45
665	50
750	55

TYPE OF MARKING	WIDTH OF LINE	PATTERN	COLOR	SPACING /REMARKS
CENTERLINE ON 2 LANE PAVEMENT	4 (100)	SKIP-DASH	YELLOW	10' (3 m) LINE WITH 30' (9 m) SPACE
CENTERLINE ON MULTI-LANE UNDIVIDED PAVEMENT	2 @ 4 (100)	SOLID	YELLOW	11 (280) C-C
NO PASSING ZONE LINES FOR ONE DIRECTION FOR BOTH DIRECTIONS	4 (100) 2 @ 4 (100)	SOLID SOLID	YELLOW YELLOW	5/2 (140) C-C FROM SKIP-DASH CENTERLINE 11 (280) C-C OMIT SKIP-DASH CENTERLINE BETWEEN
LANE LINES	4 (100) 5 (125) ON FREEWAYS	SKIP-DASH SKIP-DASH	WHITE WHITE	10' (3 m) LINE WITH 30' (9 m) SPACE
DOTTED LINES (EXTENSIONS OF CENTER, LANE OR TURN LANE MARKINGS)	SAME AS LINE BEING EXTENDED	SKIP-DASH	SAME AS LINE BEING EXTENDED	2' (600) LINE WITH 6' (1.8 m) SPACE
EDGE LINES	4 (100)	SOLID	YELLOW-LEFT WHITE-RIGHT	OUTLINE MEDIANS IN YELLOW
TURN LANE MARKINGS	6 (150) LINE; FULL SIZE LETTERS & SYMBOLS (8' (2.4m))	SOLID	WHITE	SEE TYPICAL TURN LANE MARKING DETAIL
TWO WAY LEFT TURN MARKING	2 @ 4 (100) EACH DIRECTION 8' (2.4m) LEFT ARROW	SKIP-DASH AND SOLID IN PAIRS	YELLOW WHITE	10' (3 m) LINE WITH 30' (9 m) SPACE FOR SKIP-DASH; 5/2 (140) C-C BETWEEN SOLID LINE AND SKIP-DASH LINE SEE TYPICAL TWO-WAY LEFT TURN MARKING DETAIL
CROSSWALK LINES (PEDESTRIAN) A. DIAGONALS (BIKE & EQUESTRIAN) B. LONGITUDINAL BARS (SCHOOL)	2 @ 6 (150) 12 (300) @ 45° 12 (300) @ 90°	SOLID SOLID SOLID	WHITE WHITE WHITE	NOT LESS THAN 6' (1.8 m) APART 2' (600) APART SEE TYPICAL CROSSWALK MARKING DETAILS.
STOP LINES	24 (600)	SOLID	WHITE	PLACE 4' (1.2 m) IN ADVANCE OF AND PARALLEL TO CROSSWALK, IF PRESENT, OTHERWISE, PLACE AT DESIRED STOPPING POINT, PARALLEL TO CROSSROAD CENTERLINE, WHERE POSSIBLE
PAINTED MEDIANS	2 @ 4 (100) WITH 12 (300) DIAGONALS @ 45° NO DIAGONALS USED FOR 4' (1.2 m) WIDE MEDIANS	SOLID	YELLOW; TWO WAY TRAFFIC WHITE; ONE WAY TRAFFIC	11 (280) C-C FOR THE DOUBLE LINE SEE TYPICAL PAINTED MEDIAN MARKING.
GORE MARKING AND CHANNELIZING LINES	8 (200) WITH 12 (300) DIAGONALS @ 45°	SOLID	WHITE	DIAGONALS: 15' (4.5 m) C-C (LESS THAN 30MPH (50 km/h)) 20' (6 m) C-C (30MPH (50 km/h) TO 45MPH (70 km/h)) 30' (9 m) C-C (OVER 45MPH (70 km/h))
RAILROAD CROSSING	24 (600) TRANSVERSE LINES; "RR" 15 6' (1.8 m) LETTERS; 16 (400) LINE FOR "X"	SOLID	WHITE	SEE STATE STANDARD 780001 AREA OF: "R"=3.6 SQ. FT. (0.33 m ²) EACH "X"=54.0 SQ. FT. (5.0 m ²)
SHOULDER DIAGONALS (REQUIRED FOR SHOULDERS ≥ 8')	12 (300) @ 45°	SOLID	WHITE - RIGHT YELLOW - LEFT	50' (15 m) C-C (LESS THAN 30MPH (50 km/h)) 75' (25 m) C-C (30 MPH (50 km/h) TO 45MPH (70 km/h)) 150' (45 m) C-C (OVER 45MPH (70 km/h))
U TURN ARROW	SEE DETAIL	SOLID	WHITE	16.3 SF
2 ARROW COMBINATION LEFT AND U TURN	SEE DETAIL	SOLID	WHITE	30.4 SF

FOR FURTHER DETAILS ON PAVEMENT MARKING REFER TO STANDARD SPECIFICATIONS FOR ROAD AND BRIDGE CONSTRUCTION AND STATE STANDARD 780001.

All dimensions are in inches (millimeters) unless otherwise shown.

FILE NAME = 16R0439_02-DTLS-01 - IDOT P01 (5)	USER NAME =	DESIGNED = EVERS	REVISED = C. JUCIUS 09-09-09
		CHECKED =	REVISED = C. JUCIUS 07-01-13
	PLOT SCALE =	DRAWN =	REVISED = C. JUCIUS 12-21-15
	PLOT DATE = 12-07-17	CHECKED = 03-19-90	REVISED = C. JUCIUS 04-12-16

STATE OF ILLINOIS DEPARTMENT OF TRANSPORTATION

DISTRICT ONE TYPICAL PAVEMENT MARKINGS

SCALE: SHEET NO. 15 OF 15 SHEETS STA. TO STA.

MUN. RTE. 4000/208	SECTION 16-00037-00-RS	COUNTY COOK	TOTAL SHEETS 15	SHEET NO. 15
TC-13		CONTRACT NO. 61E77		
FED. ROAD DIST. NO. 1		ILLINOIS FED. AID PROJECT ----		