

ROAD CLASSIFICATION: MAJOR COLLECTOR  
DESIGN SPEED: 50 M.P.H.

ADT:  
(2017) = 750  
(2037) = 1010  
PC = 889  
SU = 71  
MU = 50  
DHV<sub>20</sub> = 101

ROUTE	SECTION	COUNTY	SHEET NO.
FAS 874	11-00183-00-RS	FRANKLIN	1 OF 9
CONTRACT 99597			

STATE OF ILLINOIS  
DEPARTMENT OF TRANSPORTATION  
DIVISION OF HIGHWAYS

PLANS FOR PROPOSED ROADWAY IMPROVEMENTS

FAS 874 LOGAN ROAD  
Franklin County, Illinois  
Section 11-00183-00-RS  
Project PKP6 (323)  
Job C-99-534-12



SHEET NO.	TITLE
1	COVER SHEET AND SUMMARY OF QUANTITIES
2	MISCELLANEOUS DETAILS AND TYPICAL SECTIONS
3	MISCELLANEOUS DETAILS
4-9	PLAN

STANDARDS

701006-05  
701301-04  
701306-04  
701311-03  
701901-07  
780001-05  
BLR 24-2

SUMMARY OF QUANTITIES			
CODE NO.	PAY ITEM	UNIT	TOTAL
40200800	AGGREGATE SURFACE COURSE, TYPE B	TON	144
40600275	BITUMINOUS MATERIALS (PRIME COAT)	FOUND	14,934
40600982	HOT-MIX ASPHALT SURFACE REMOVAL	SQ YD	565
	-BUTT JOINT		
40603085	HOT-MIX ASPHALT BINDER COURSE, IL 19.0, N70	TON	6,810
40603315	HOT-MIX ASPHALT SURFACE COURSE, MIX "C", N70	TON	5,428
48100100	AGGREGATE SHOULDERS, TYPE A	TON	5,139
56109210	WATER VALVES TO BE ADJUSTED	EACH	1
60255500	MANHOLES TO BE ADJUSTED	EACH	2
67100100	MOBILIZATION	L SUM	1
70300100	SHORT-TERM PAVEMENT MARKING	FOOT	5
Δ78001110	PAINT PAVEMENT MARKING - LINE 4"	FOOT	59,572
X44.01198	HOT-MIX ASPHALT SURFACE REMOVAL -VARIABLE DEPTH	SQ YD	1,099
Δ	SPECIALTY ITEMS		

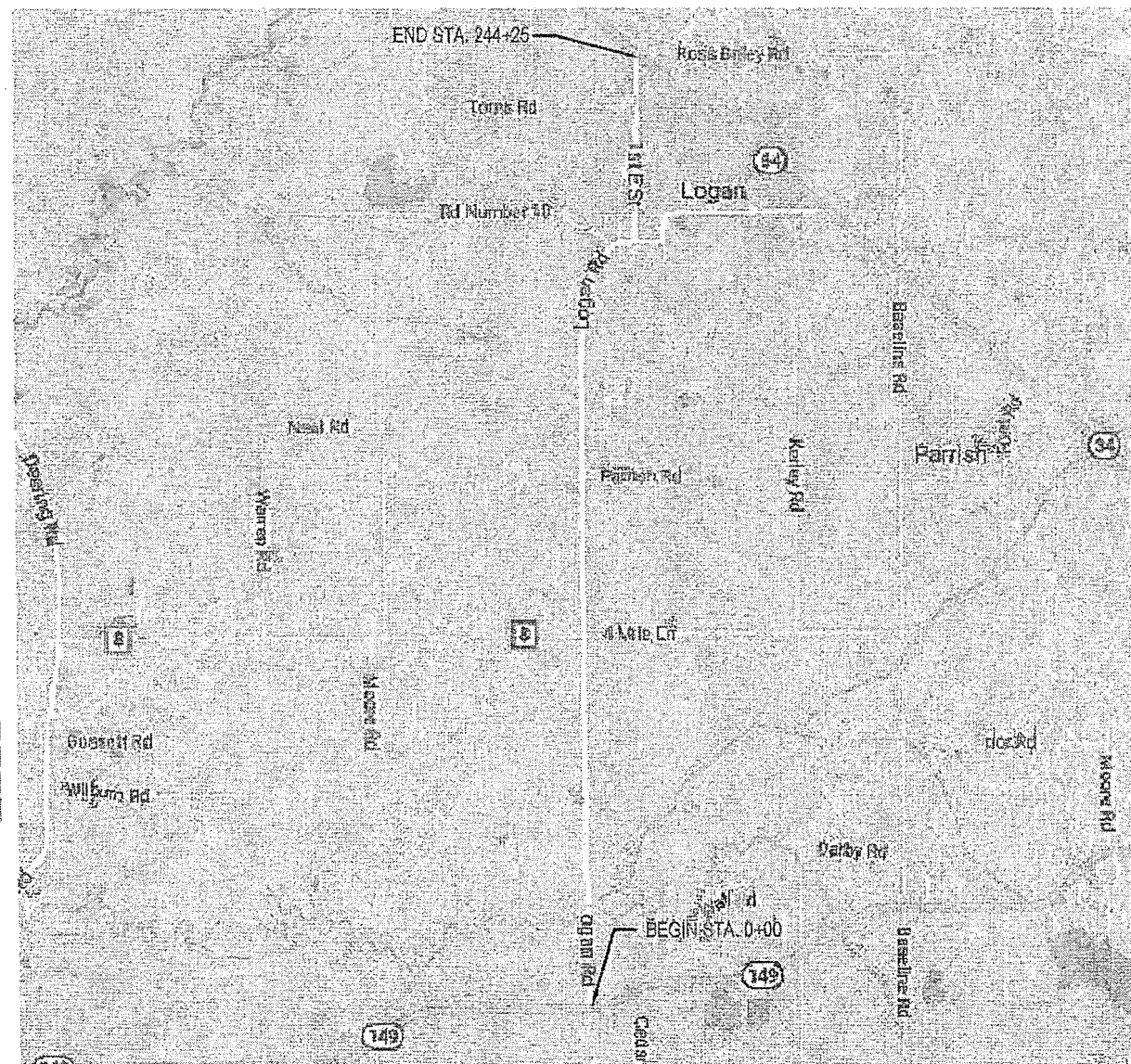

LOCATION MAP

NET LENGTH = 4.63 MILES (24,425 FEET)



STATE OF ILLINOIS DEPARTMENT OF TRANSPORTATION	
APPROVED	<u>3/28/2018</u> <i>[Signature]</i>
FRANKLIN COUNTY HIGHWAY ENGINEER	
PASSED	<u>APRIL 06, 2018</u> <i>[Signature]</i>
DISTRICT 9 ENGINEER OF LOCAL ROADS & STREETS	
RELEASING FOR BID	
BASED ON LIMITED REVIEW	<u>APRIL 06, 2018</u> <i>[Signature]</i>
REGION 5 ENGINEER	

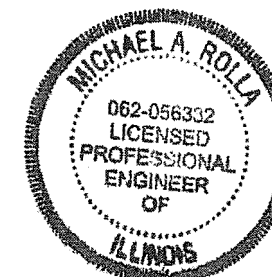

*[Signature]*  
MICHAEL A. ROLLA  
ILLINOIS REGISTERED PROFESSIONAL ENGINEER  
#062-056332  
LIC. EXPIRES 11/30/2019

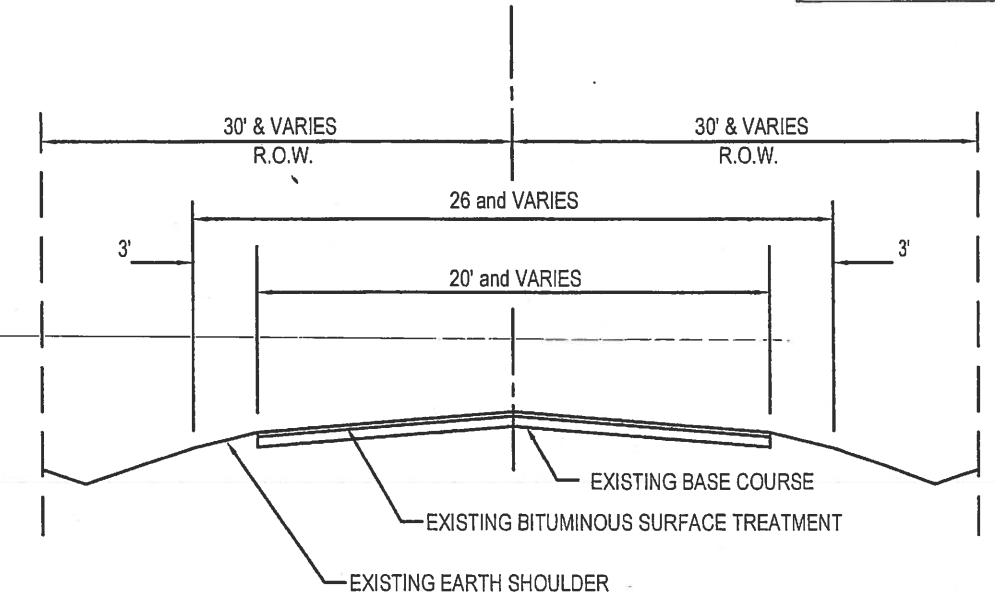
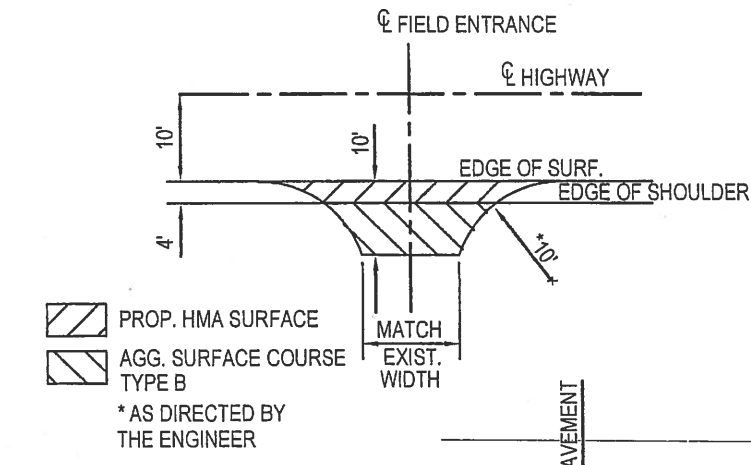
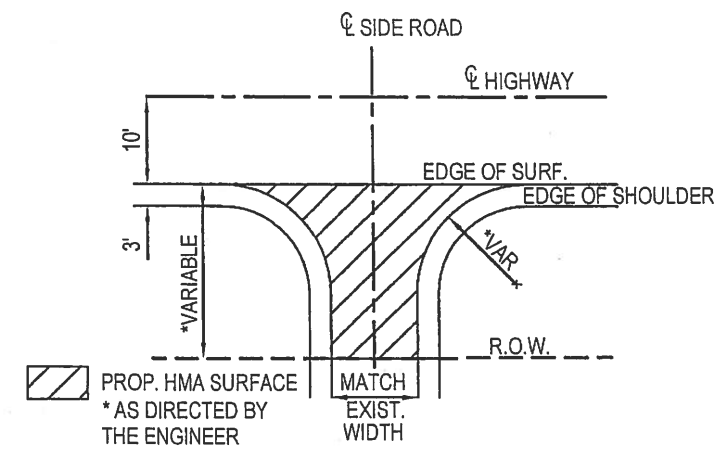

TYPICAL EXISTING SECTION

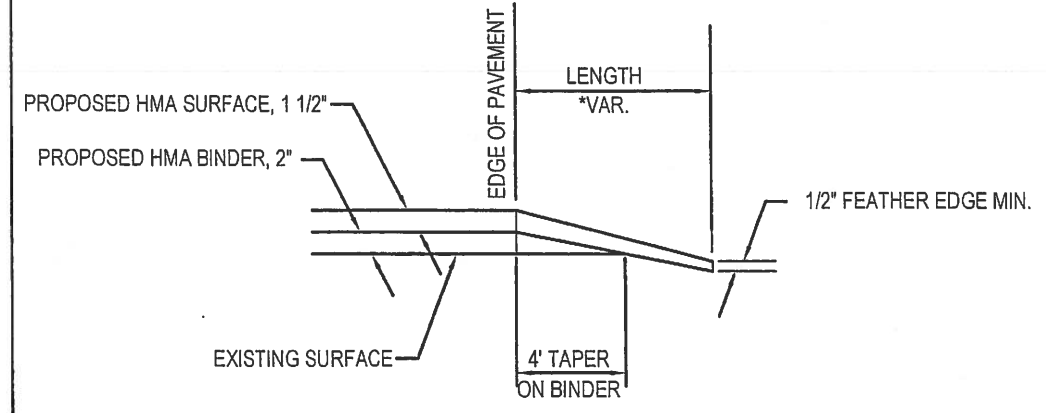

SIDEROAD DETAILS

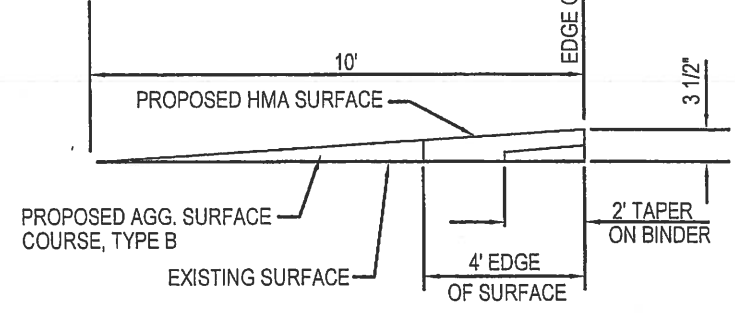

FIELD ENTRANCE DETAILS

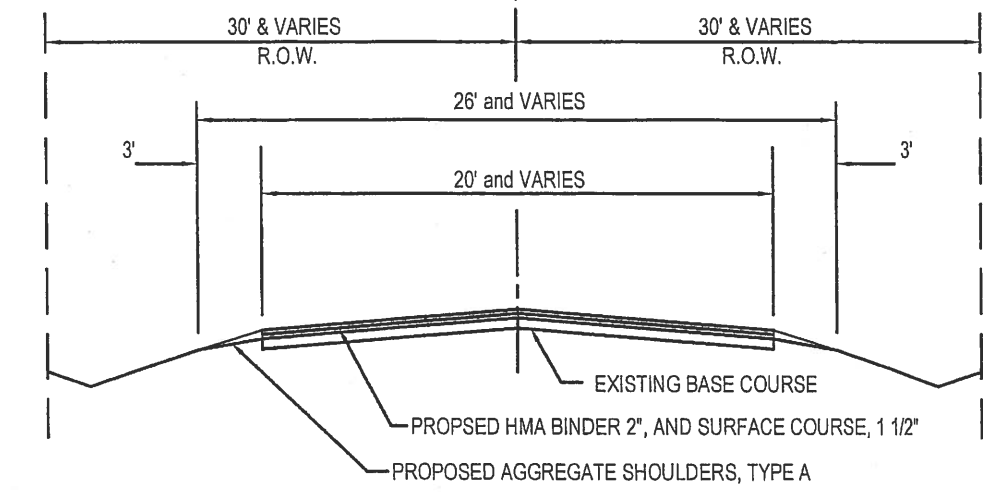

TYPICAL PROPOSED SECTION

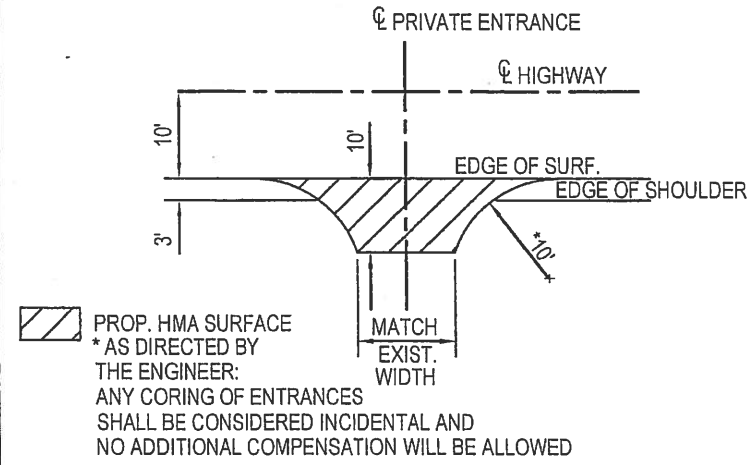

PRIVATE AND COMMERCIAL ENTRANCE DETAILS

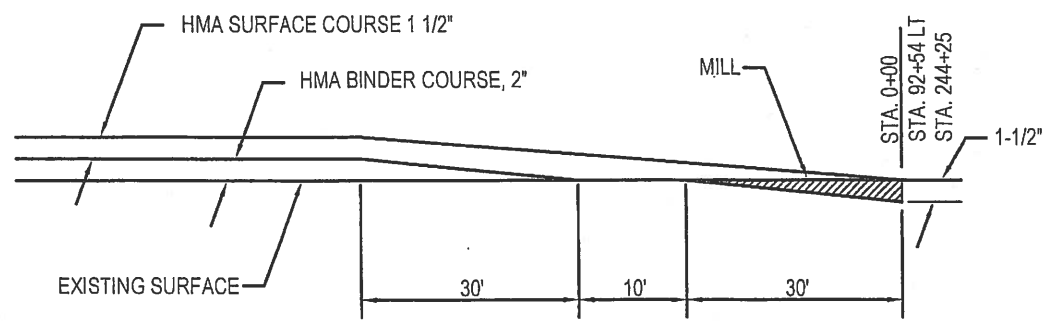

BUTT JOINT

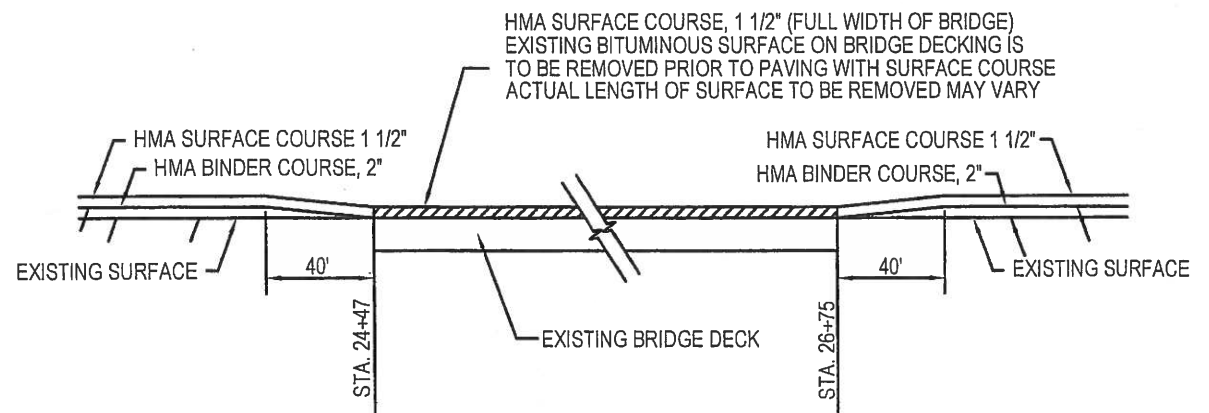
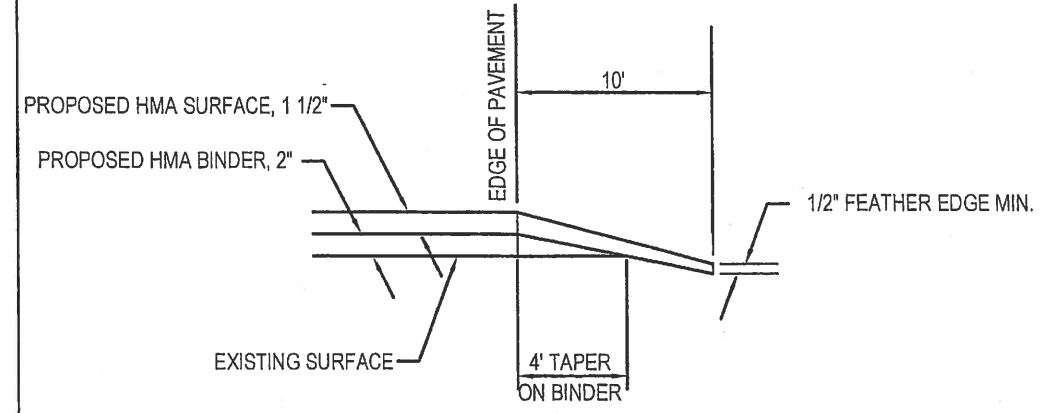

SURFACING AT BRIDGE

FIELD ENTRANCE QUANTITIES		
ENTRANCES	AGGREGATE SURFACE COURSE TYPE B, TON	HOT MIX ASPHALT SURFACE COURSE, MIX "C", N70, TON
ONE (1) ENTRANCE	4	1
TOTAL = 36 ENTRANCES	144	36
MAILBOX TURNOUT QUANTITIES		
TURNOUT	BITUMINOUS MATERIALS (PRIME COAT) POUND	HOT MIX ASPHALT SURFACE COURSE, MIX "C", N70, TON
ONE (1) TURNOUT	3	1
TOTAL = 12 TURNOUTS	36	12
PRIVATE ENTRANCE QUANTITIES		
ENTRANCES	BITUMINOUS MATERIALS (PRIME COAT) POUND	HOT MIX ASPHALT SURFACE COURSE, MIX "C", N70, TON
ONE (1) ENTRANCE	9	2.4
TOTAL = 43 ENTRANCES	387	103
COMMERCIAL ENTRANCE QUANTITIES		
ENTRANCES	BITUMINOUS MATERIALS (PRIME COAT) POUND	HOT MIX ASPHALT SURFACE COURSE, MIX "C", N70, TON
ONE (1) ENTRANCE	17	4
TOTAL = 3 ENTRANCES	51	12

SIDEROAD ENTRANCE QUANTITIES	
LOCATION	HOT MIX ASPHALT SURFACE COURSE, MIX "C", N70, TON
STA 92+54 LT	15.4
STA 92+60 RT	6.4
STA 131+87 RT	17.1
STA 151+71 RT	6.0
STA 151+73 LT	2.9
STA 177+31 LT	8.9
STA 177+91 RT	3.5
STA 183+35 RT	8.4
STA 185+39 LT	9.5
STA 185+43 RT	15.5
STA 189+96 LT	10.1
STA 189+96 RT	6.3
STA 192+33 LT	16.0
STA 193+92 LT	8.6
STA 193+92 RT	14.0
STA 197+56 RT	4.2
STA 197+56 RT	5.2
STA 201+03 LT	4.3
STA 201+03 RT	4.1
STA 204+31 LT	5.3
STA 204+36 RT	9.8
STA 207+48 LT	3.6
STA 210+64 LT	4.8
STA 213+87 LT	5.1
STA 216+97 LT	5.5
STA 231+16 LT	11.4
TOTAL = 26 SIDEROADS	211.9

MILLING SCHEDULE		
LOCATION	TYPE	COLD MILLING
STA. 0+00 TO 0+30	BUTT JOINT	188 SQ YD
STA. 23+67 TO 27+55	VARIABLE DEPTH	1099 SQ YD
STA. 92+54 LT	BUTT JOINT	180 SQ YD
STA. 243+95 TO 244+25	BUTT JOINT	197 SQ YD
TOTAL		1664 SQ YD

SCHEDULE OF PAVEMENT MARKING LINE, 4"							
NORTHBOUND LANE			SOUTHBOUND LANE			STATION	EDGE LINE (WHITE SOLID)
STATION	NO PASSING (YELLOW SOLID)	PASSING (YELLOW DASHED)	STATION	NO PASSING (YELLOW SOLID)	PASSING (YELLOW DASHED)		
0+00 TO 115+00		2875	115+00 TO 123+00		200	0+00 TO 244+25	47363
115+00 TO 123+00	800		123+00 TO 133+50	1050			
123+00 TO 135+50		313	135+50 TO 142+50		175		
135+50 TO 138+00	250		142+50 TO 148+50	600			
142+50 TO 146+50		100	148+50 TO 154+00		138		
146+50 TO 155+00	850		154+00 TO 164+00	1000			
155+00 TO 166+00		275	166+00 TO 172+10		153		
166+00 TO 218+30	5230		172+10 TO 225+75	5365			
218+30 TO 222+00		93	225+75 TO 230+25		113		
222+00 TO 229+00	700		230+25 TO 235+25	500			
230+25 TO 231+75		38	235+25 TO 238+75		88		
231+75 TO 236+75	500		238+75 TO 244+25	550			
238+75 TO 244+25		138					
TOTALS	8330	3832		9065	867		47363

MISCELLANEOUS DETAILS

SCALE 1" = 200'

ROUTE	SECTION	COUNTY	SHEET NO.
FAS 874	11-00183-00-RS	FRANKLIN	4 OF 9
CONTRACT 99597			

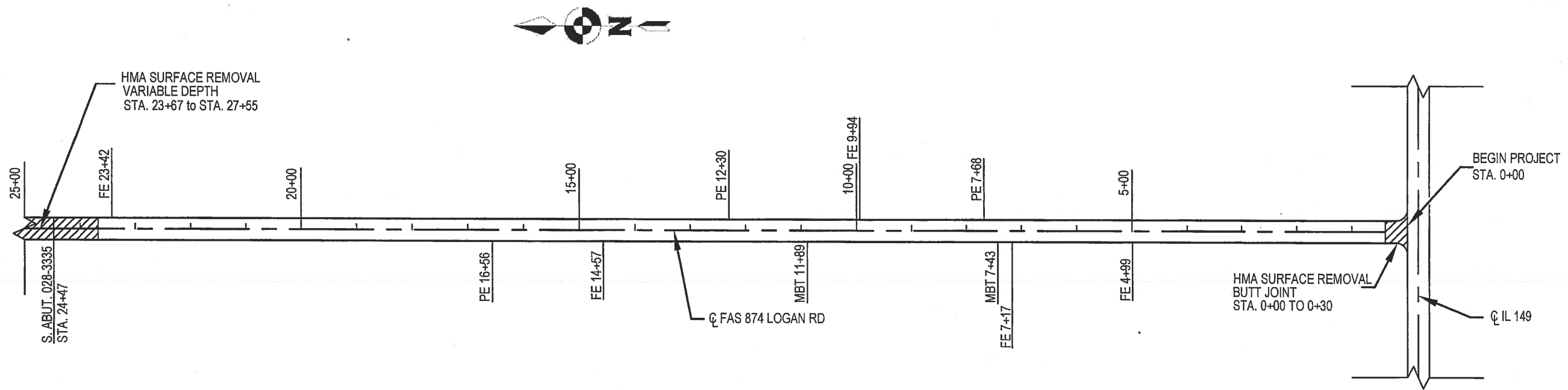

SCALE 1" = 200'

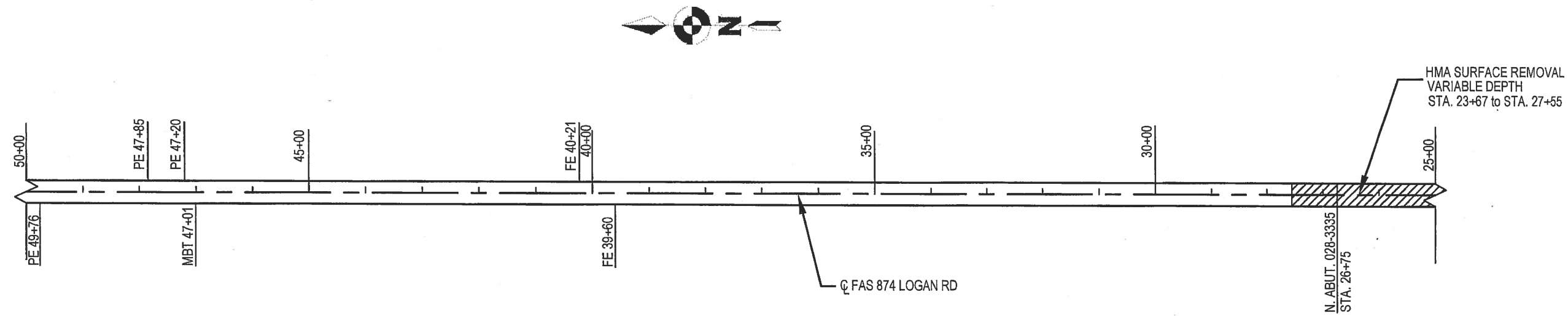

PLAN  
STATION 0+00 TO 50+00

SCALE 1" = 200'

ROUTE	SECTION	COUNTY	SHEET NO.
FAS 874	11-00183-00-RS	FRANKLIN	5 OF 9
CONTRACT 99597			

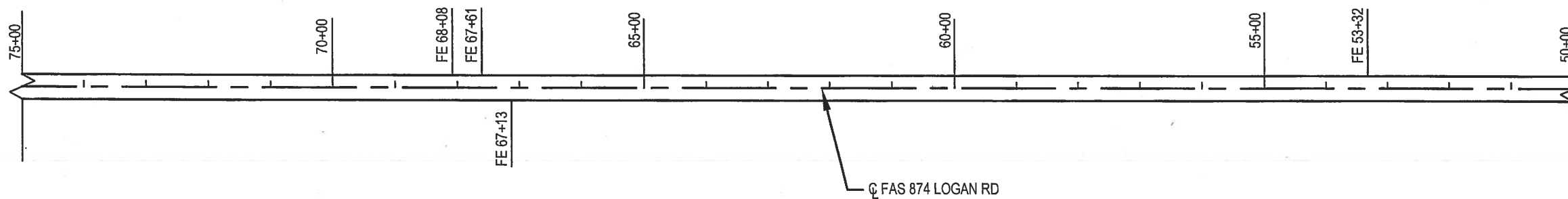

SCALE 1" = 200'

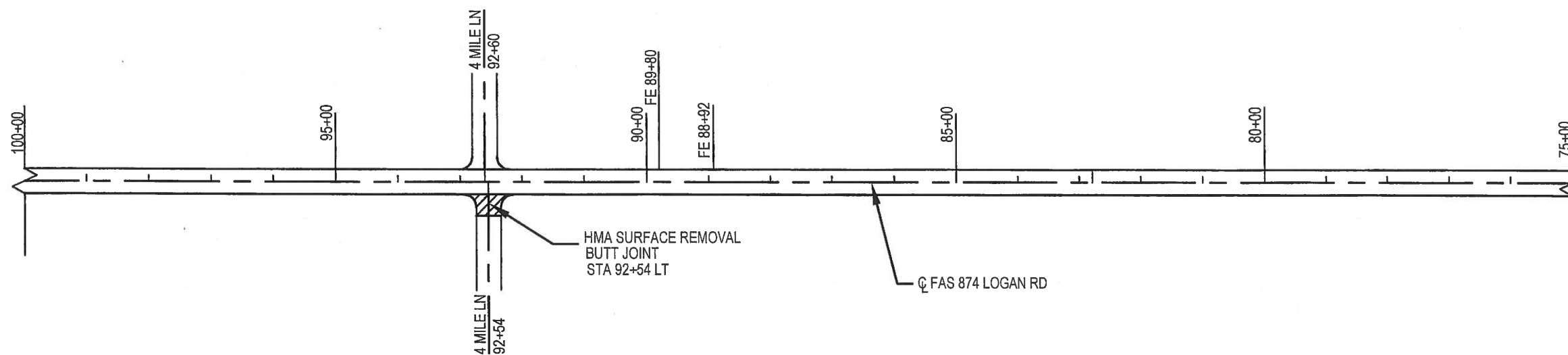

PLAN  
STATION 50+00 TO 100+00

SCALE 1" = 200'

ROUTE	SECTION	COUNTY	SHEET NO.
FAS 874	11-00183-00-RS	FRANKLIN	6 OF 9
CONTRACT 99597			

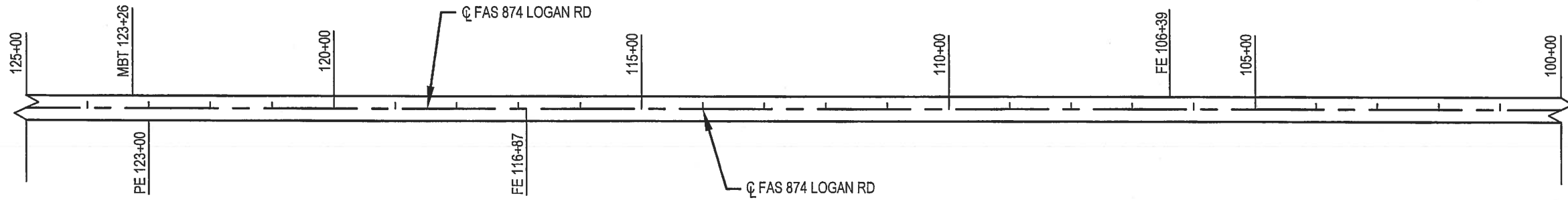

SCALE 1" = 200'

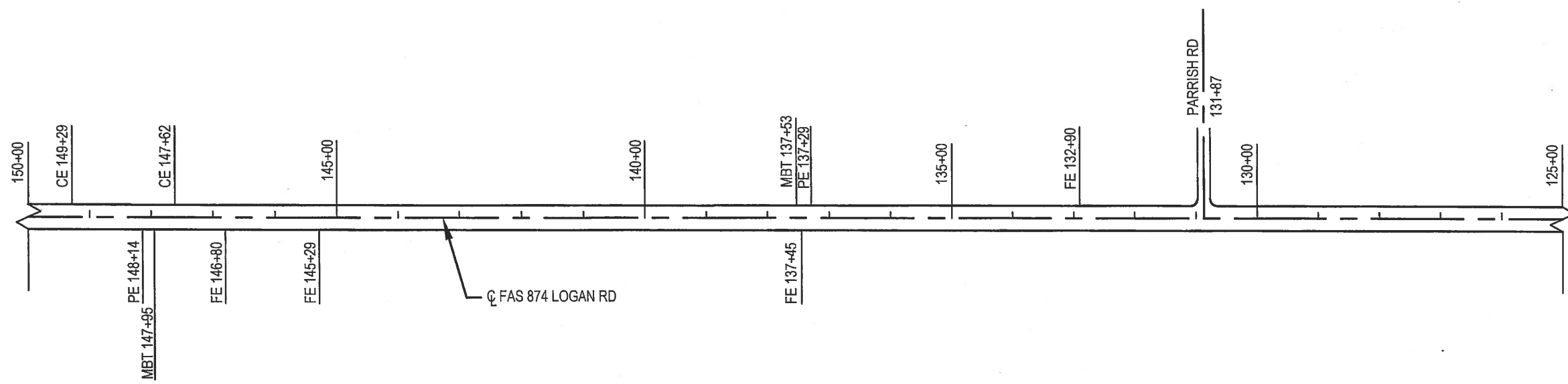

PLAN  
STATION 100+00 TO 150+00

SCALE 1" = 200'

ROUTE	SECTION	COUNTY	SHEET NO.
FAS 874	11-00183-00-RS	FRANKLIN	7 OF 9
CONTRACT 99597			

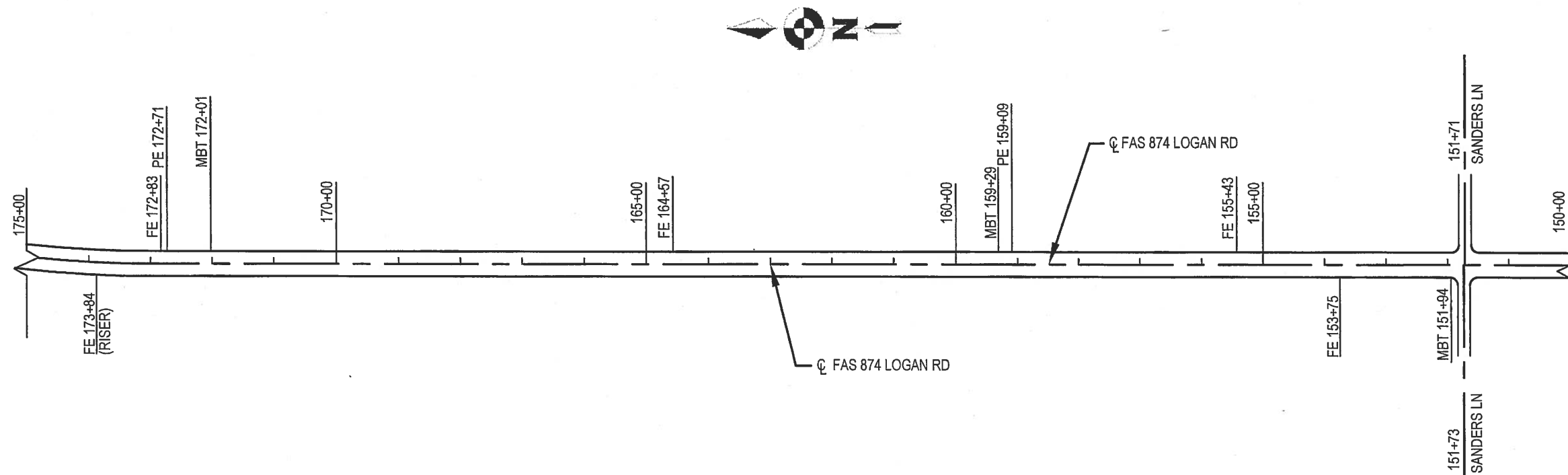

PLAN  
STATION 150+00 TO 175+00

ROUTE	SECTION	COUNTY	SHEET NO.
FAS 874	11-00183-00-RS	FRANKLIN	8 OF 9
			CONTRACT 99597

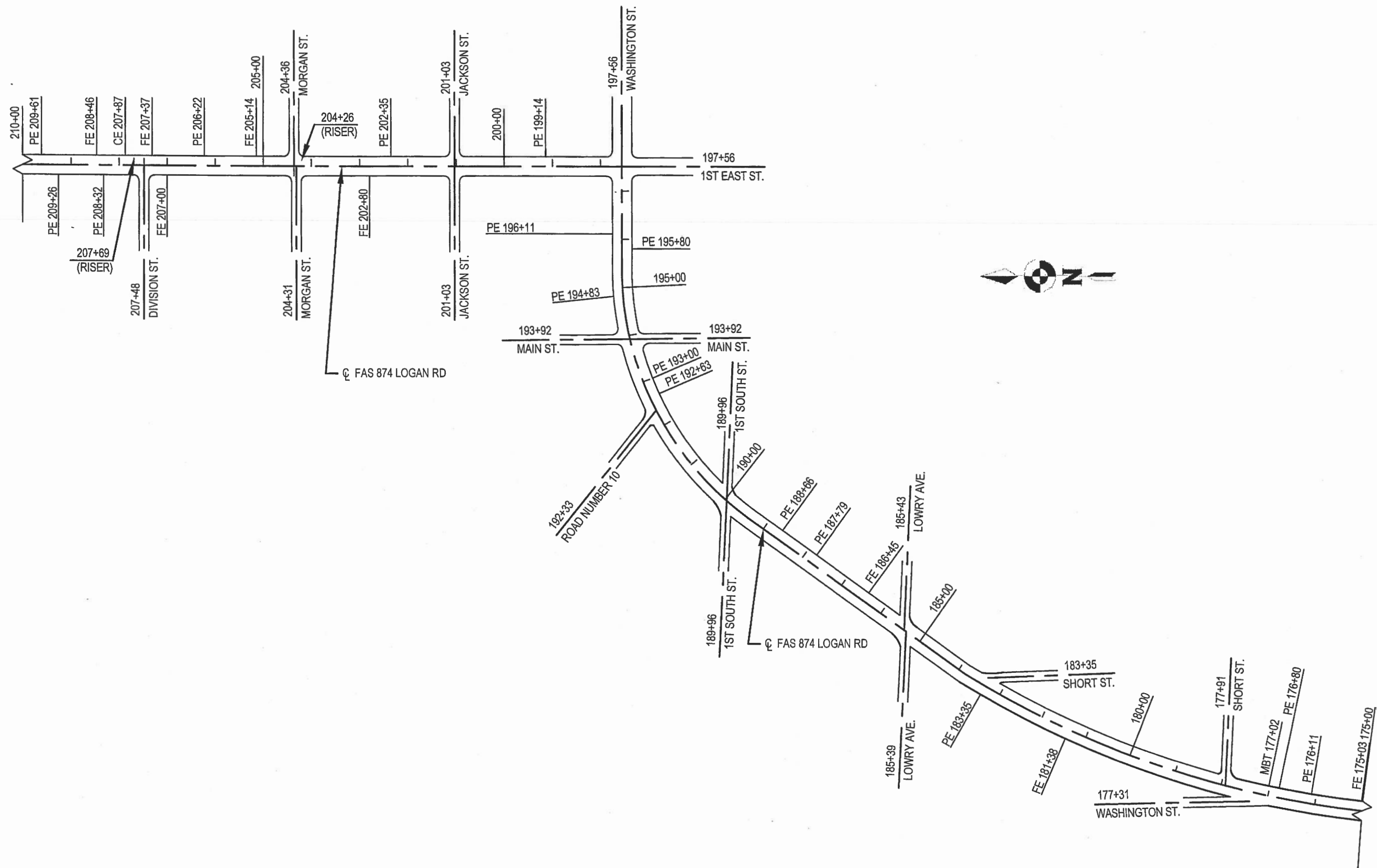



SCALE 1" = 200'

ROUTE	SECTION	COUNTY	SHEET NO.
FAS 874	11-00183-00-RS	FRANKLIN	9 OF 9
CONTRACT 99597			

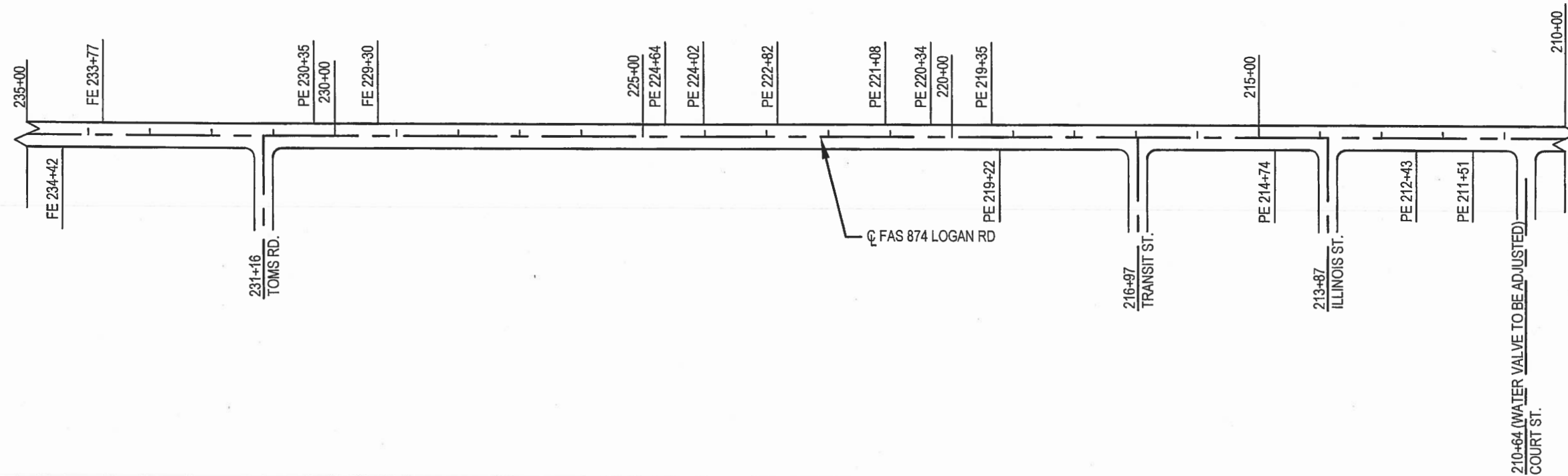

SCALE 1" = 200'

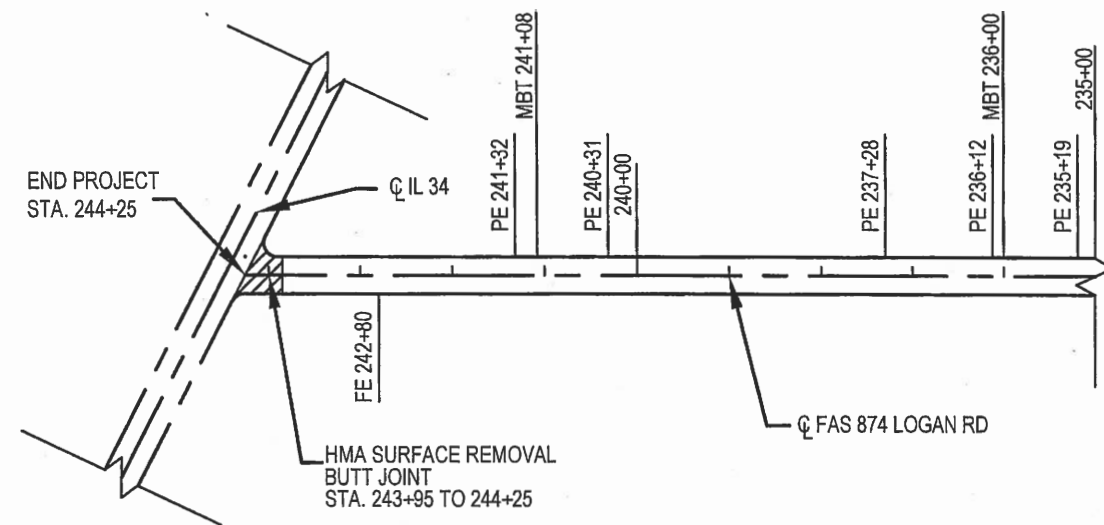

PLAN  
STATION 210+00 TO 244+25