

F.A. RTE.	SECTION	COUNTY	TOTAL SHEETS	SHEET NO.
		COOK	17	11
STA.		TO STA.		
FED. ROAD DIST. NO.		ILLINOIS FED. AID PROJECT		
CONTRACT NO. 44917				

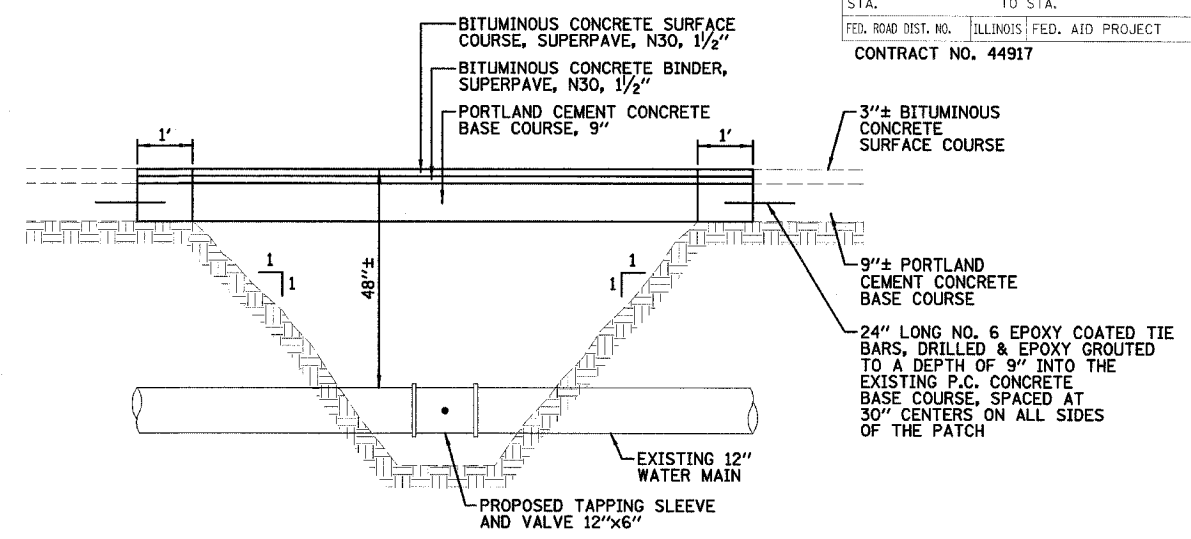

NOTE: PAVEMENT PATCH SHALL BE CONSTRUCTED ONTO A MINIMUM OF ONE FOOT OF UNDISTURBED SOIL. THIS WILL REQUIRE SAW CUTTING THE AREA TWICE. ALL PAVEMENT REMOVAL AND REPLACEMENT SHALL BE PAID AS PAVEMENT PATCH TYPE IV.

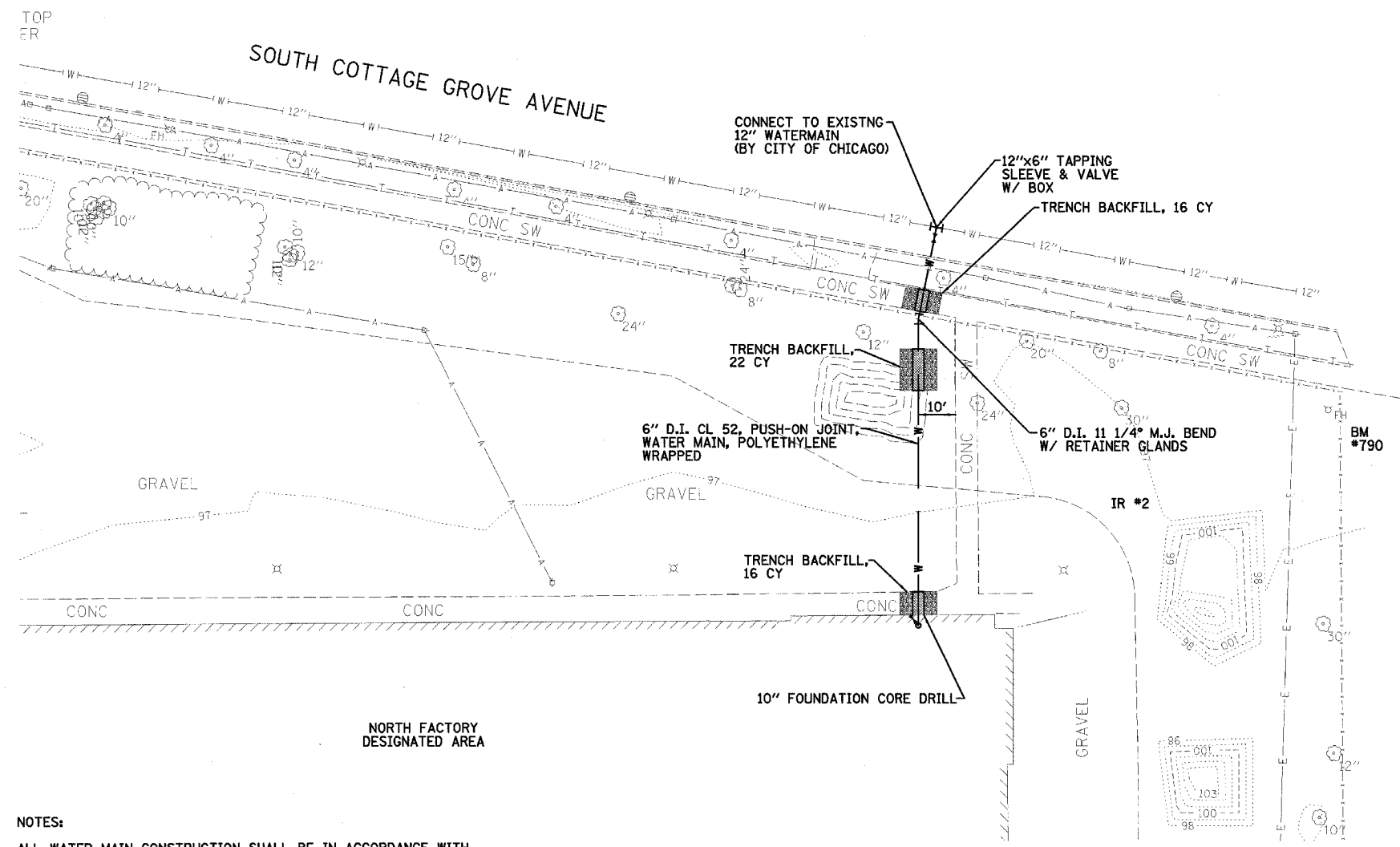
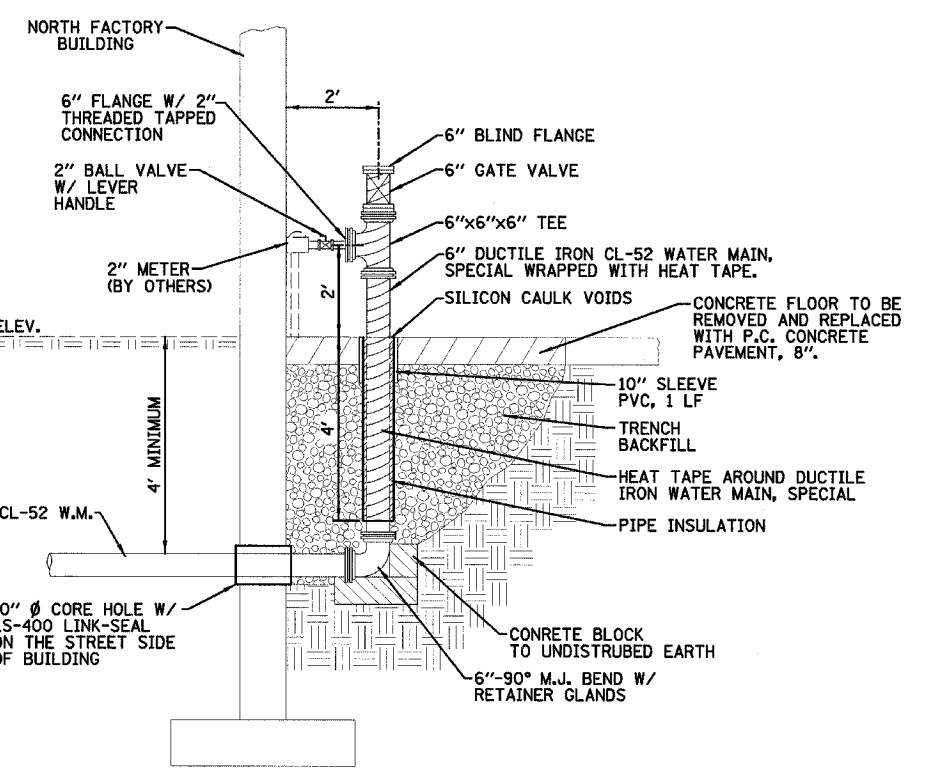

NOTE: ALL JOINTS SHALL BE RESTRAINED JOINTS INSIDE THE BUILDING WALL, TO A POINT FIFTY FEET OUTSIDE THE BUILDING AND AT ALL FITTINGS.

- NOTES:**
- ALL WATER MAIN CONSTRUCTION SHALL BE IN ACCORDANCE WITH THE "STANDARD SPECIFICATIONS FOR WATER & SEWER MAIN CONSTRUCTION IN ILLINOIS".
 - ALL INTERIOR PLUMBING SHALL BE IN ACCORDANCE WITH THE CITY OF CHICAGO BUILDING CODE, PLUMBING CODE CHAPTERS.
 - THE CITY OF CHICAGO WATER DEPARTMENT SHALL PERFORM TAPPING OF EXISTING WATER MAIN. THE CONTRACTOR SHALL PROVIDE ALL MATERIALS AND PREPARATION FOR THE TAP.
 - THE CONTRACTOR SHALL OBTAIN CONSTRUCTION PERMIT FROM THE CITY OF CHICAGO, DEPARTMENT OF WATER. THE REQUEST SHALL BE MADE FOR CITY TAPPING.
 - STREET PAVEMENT SHALL BE THREE INCHES OF BITUMINOUS CONCRETE ON A NINE INCH P.C. CONCRETE BASE.
 - SELECT GRANULAR BACKFILL SHALL BE CA-6, CA-7, CA-9, CA-11 OR FA-5, FA-6, FA-10.
 - ALL ROADWAY CONSTRUCTION SHALL BE IN ACCORDANCE WITH IDOT "STANDARD SPECIFICATIONS FOR ROAD & BRIDGE CONSTRUCTION".
 - CORE DRILLING THE FOUNDATION WALL SHALL INCLUDE MATERIAL, EQUIPMENT & LABOR NEEDED TO CUT A CIRCULAR HOLE THROUGH THE EXISTING FOUNDATION. SIZE AS NECESSARY FOR PROPOSED WATER MAIN. GROUT REMAINING VOIDS.
 - THE FLOOR SLEEVE SHALL BE A PVC PIPE SET IN POURED SLAB WITH SILICON CAULKING IN REMAINING VOIDS.
 - HEAT TAPE SHALL BE A SINGLE COMPONENT CONTAINING 2-WIRE CONDUCTIVE CORE CABLE WITH INTERGRATED THERMOSTAT AND PLUG-IN. HEAT TAPE SHALL EMIT 6W/ FT OF OUTPUT AT 120V.
 - THE POWER SOURCE FOR THE HEAT TAPE PLUG-IN SHALL BE BY OTHERS. HEAT TAPE PLUG-IN MUST CONNECT TO A GFI RECEPTACLE AND NOT BE CONNECTED WITH AN EXTENSION CORD.
 - PIPE INSULATION SHALL BE CLOSED CELL POLYETHYLENE FOAM WITH A MINIMUM THICKNESS OF 1/2".
 - THE CONCRETE FLOOR SLAB REPLACED SHALL MATCH EXISTING PROFILES AND THICKNESS AND SHALL BE SMOOTH. THE NEW FLOOR SLAB WILL BE PAID AS P.C. CONCRETE PAVEMENT, 8". THE EXISTING CONCRETE SHALL BE SAW CUT STRAIGHT & NEAT FOR REMOVAL. REMOVAL OF THE EXISTING FLOOR SHALL BE PAID AS CONCRETE REMOVAL.

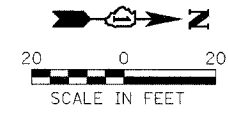

REVISIONS	
NAME	DATE

ILLINOIS DEPARTMENT OF TRANSPORTATION
WATER MAIN PLAN
 IDOT / IHPA
 PULLMAN STATE HISTORIC SITE
 SCALE: VERT. _____
 HORIZ. _____
 DATE: 11/08/05
 DRAWN BY: DJM
 CHECKED BY: PJM