

F.A.U. RTE.	SECTION	COUNTY	TOTAL SHEETS	SHEET NO.
* 2000-037RS	COOK		58	6
STA. 16+48		TO STA. 116+13		
FED. ROAD DIST. NO. 1 ILLINOIS FED. AID PROJECT				

\* 2786, 1334, 1332

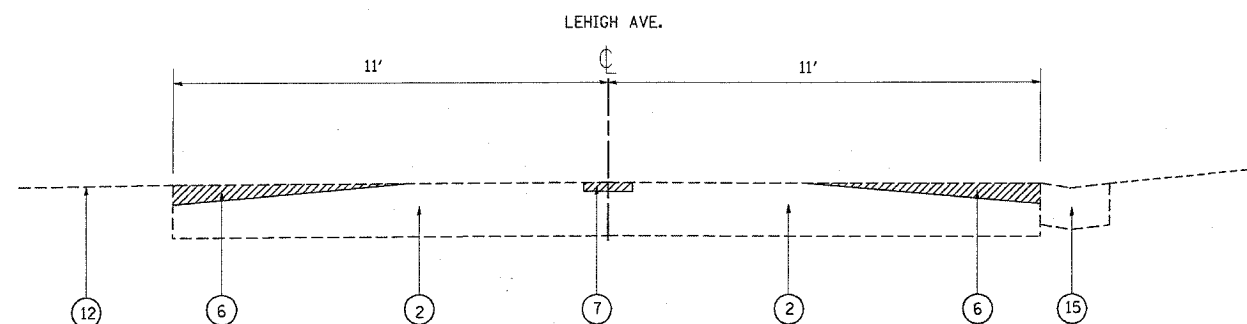

EXISTING TYPICAL SECTION  
 STA 16+48 TO 60+48  
 STA 77+41 TO 85+16  
 STA 103+59 TO 116+13

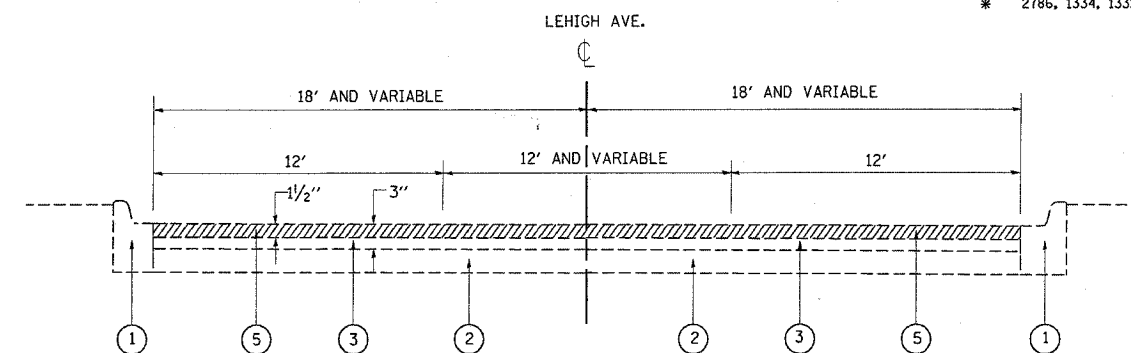

EXISTING TYPICAL SECTION  
 STA 60+48 TO 65+63  
 STA 66+32 TO 72+54

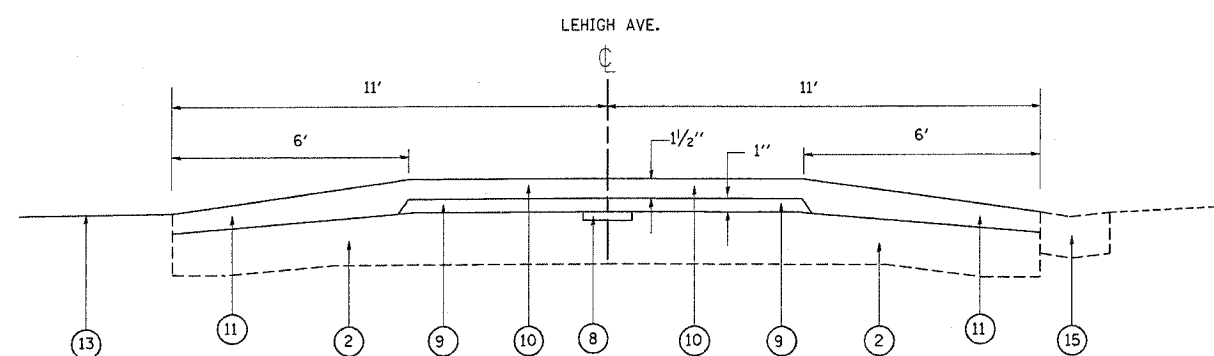

PROPOSED TYPICAL SECTION  
 STA 16+48 TO 60+48  
 STA 77+41 TO 85+16  
 STA 103+59 TO 116+13

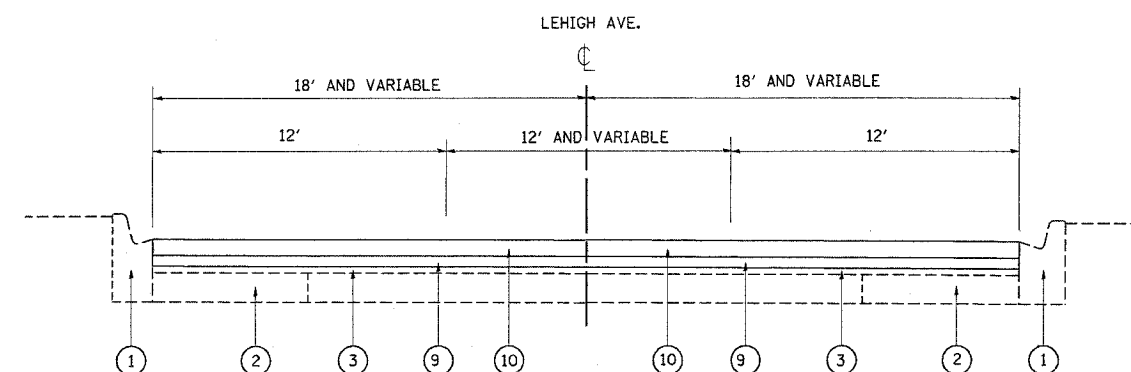

PROPOSED TYPICAL SECTION  
 STA 60+48 TO 65+53  
 STA 66+32 TO 72+54

**LEGEND**

- ① EXISTING COMB. CURB AND GUTTER TYPE B-6.12
- ② EXISTING PCC PAVEMENT (10" AND VARIES)
- ③ EXISTING BIT. AFTER MILLING SURFACE, 1 1/2"
- ④ EXISTING CONCRETE MEDIAN
- ⑤ PROP. BIT. SURFACE REMOVAL, 1 1/2"
- ⑥ PROP. PCC SURFACE REMOVAL (VAR. DEPTH), SEE DISTRICT DETAIL BD-33
- ⑦ PROP. PARTIAL DEPTH REMOVAL, 2"
- ⑧ PROP. POLYMERIZED LEVELING BINDER (MM), SUPERPAVE, IL-4.75, N50, 2"
- ⑨ PROP. POLYMERIZED LEVELING BINDER (MM), SUPERPAVE, IL-4.75, N50, 1"
- ⑩ PROP. BIT. CONC. SURFACE COURSE, SUPERPAVE, MIX "D", N70, 1 1/2"
- ⑪ PROP. BIT. TAPER AT EDGE OF P.C.C. PAVEMENT (SEE DISTRICT DETAIL BD-33)
- ⑫ EXISTING AGGREGATE SHOULDER
- ⑬ PROP. AGGREGATE SHOULDER, TYPE B
- ⑭ PROP. MEDIAN REMOVAL (PARTIAL DEPTH)
- ⑮ EXISTING GUTTER, TYPE B
- ⑯ PROP. BIT SHOULDERS, SUPERPAVE, 8"

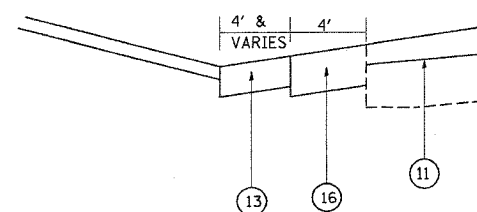

PROPOSED TYPICAL SECTION  
 STA 81+25 TO 87+72  
 STA 111+16 TO 116+13

REVISIONS	
NAME	DATE

ILLINOIS DEPARTMENT OF TRANSPORTATION  
**LEHIGH AVE.  
 (CENTRAL AVE. TO OAKTON AVE.)  
 EXISTING AND PROPOSED  
 TYPICAL SECTION**  
 SCALE: VERT. NONE  
 HORIZ. DATE 10/27/2005  
 DRAWN BY: RK  
 CHECKED BY: