

*REF-topo10

CONTRACT NO. 60A11			
F.A. RTE.	SECTION	COUNTY	TOTAL SHEETS
55	2005-040 GRR	WILL	18
STA. 75+00		TO STA. 83+00	
FED. ROAD DIST. NO.	ILLINOIS	FED. AID PROJECT	

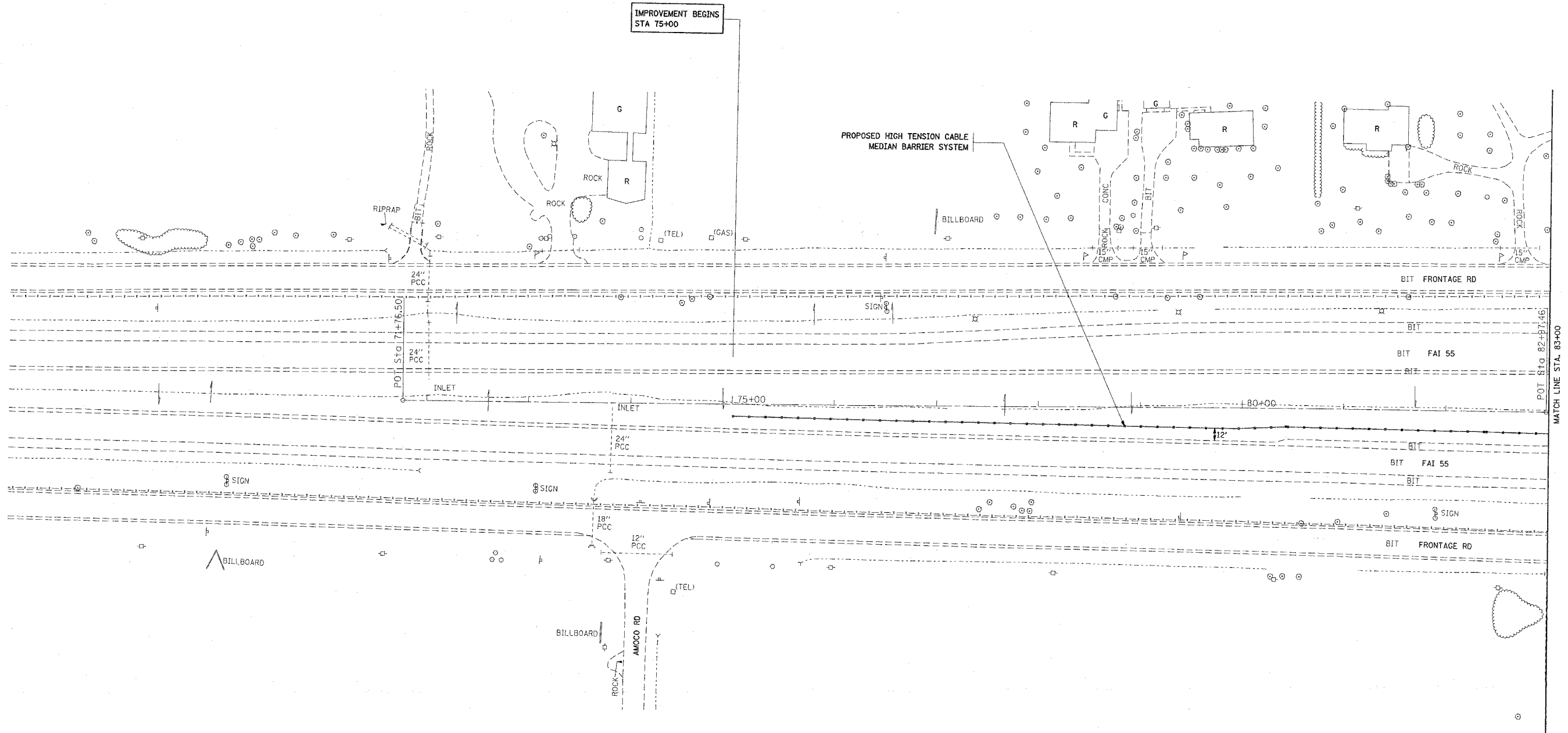

PLOT DATE = 3/22/2006
 FILE NAME = \\s127205\ah\155\p2\2063
 PLOT SCALE = 50,000 / IN.
 USER NAME = oasanth

REVISIONS	
NAME	DATE

ILLINOIS DEPARTMENT OF TRANSPORTATION

FAI 55/ I-55
US 6 TO SOUTH OF I-80
EXISTING / PROPOSED ROADWAY PLAN

SCALE: VERT. 1"=50'
HORIZ. 1"=50'
DATE 3/22/2006

DRAWN BY: HMO
CHECKED BY: