

F.A. RTE.	SECTION	COUNTY	TOTAL SHEETS	SHEET NO.
55	2005-040 GRR	WILL	18	9
STA. 113+00		TO STA. 128+00		
FED. ROAD DIST. NO.		FED. AID PROJECT		

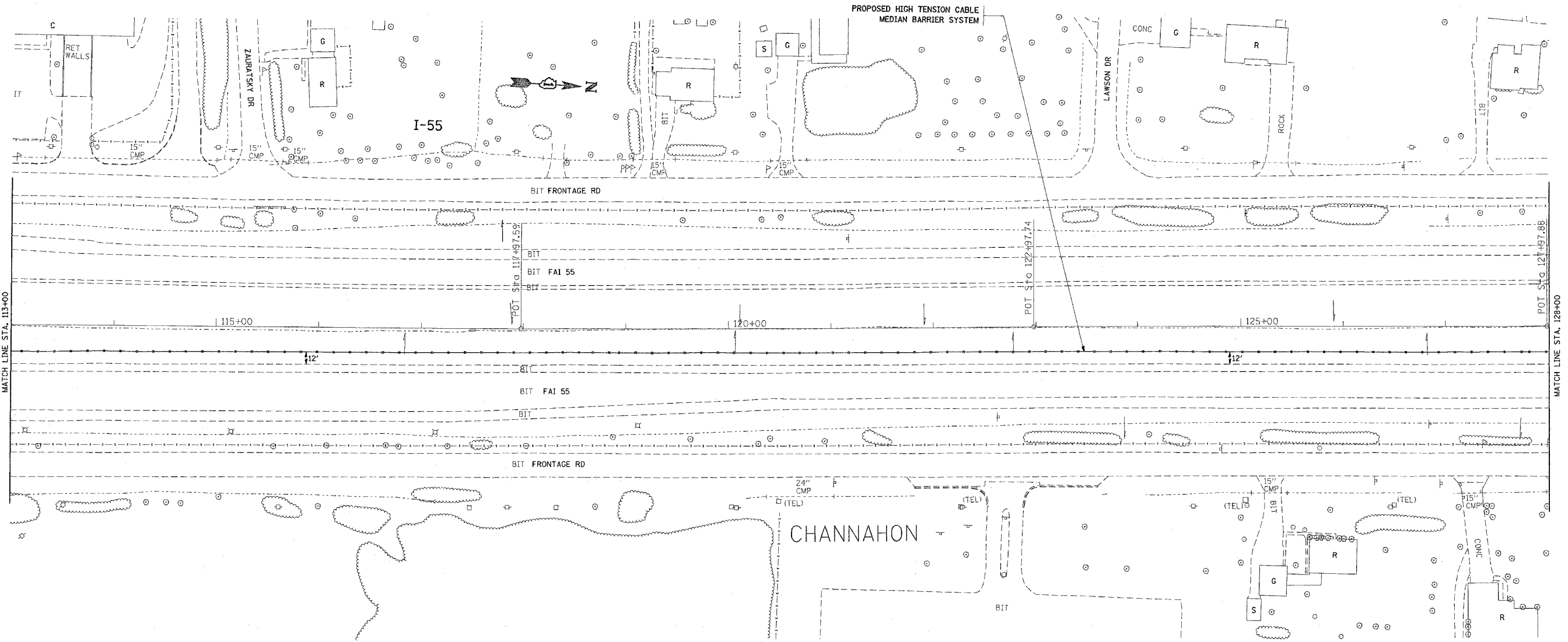

PLOT DATE = 3/22/2005  
 PLOT SCALE = 1/8" = 1'-0"  
 USER NAME = csmahm

REVISIONS	
NAME	DATE

ILLINOIS DEPARTMENT OF TRANSPORTATION  
 FAI 55/ I-55  
 US 6 TO SOUTH OF I-80  
 EXISTING / PROPOSED ROADWAY PLAN

SCALE: VERT. HORIZ.  
 DATE  
 DRAWN BY: HMO  
 CHECKED BY: