

*REF-topo04

CONTRACT NO. 60A11

F.A.I. RTE.	SECTION	COUNTY	TOTAL SHEETS	SHEET NO.
55	2005-040 GRR	WILL	18	10
STA. 128+00		TO STA. 143+00		
FED. ROAD DIST. NO.		ILLINOIS FED. AID PROJECT		

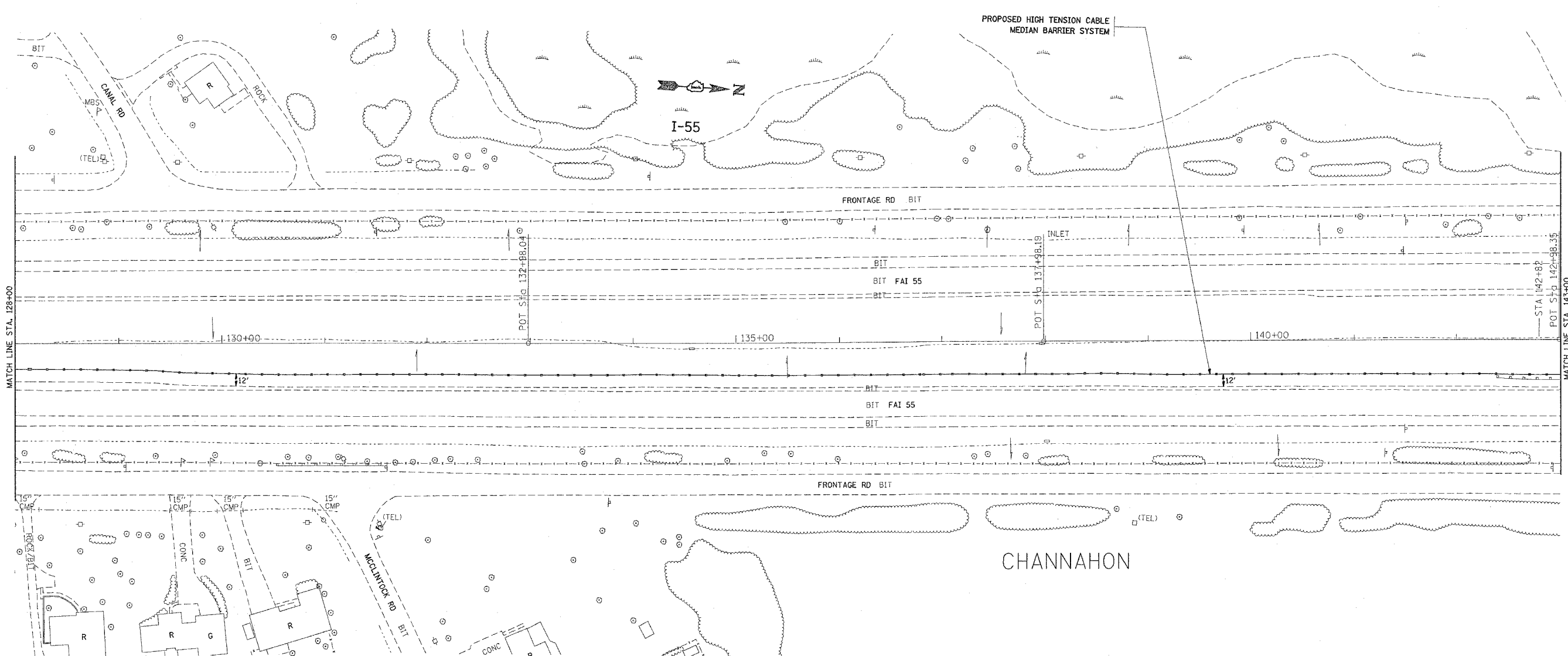

PLOT DATE = 3/22/2006
 FILE NAME = s:\projects\60a11\127205\127205.dwg
 PLOT SCALE = 50.000 / IN.
 USER NAME = ommahm

REVISIONS	
NAME	DATE

ILLINOIS DEPARTMENT OF TRANSPORTATION

FAI 55/ I-55
US 6 TO SOUTH OF I-80
EXISTING / PROPOSED ROADWAY PLAN

SCALE: VERT. 1"=50'
 HORIZ. 1"=50'
 DATE 3/22/2006

DRAWN BY: HMO
 CHECKED BY: