

ROUTE	SECTION	COUNTY	TOTAL SHEETS	SHEET NUMBER
VARIOUS	2005-0771	COOK	14	1

CONTRACT NO.: 60A83

D-91-115-06

FOR INDEX OF SHEETS SEE SHEET 2

STATE OF ILLINOIS
DEPARTMENT OF TRANSPORTATION
DIVISION OF HIGHWAYS
DISTRICT ONE

PROPOSED HIGHWAY PLANS

VARIOUS ROUTES
VARIOUS LOCATIONS (NEAR MIDWAY)
SECTION 2005-0771
CURB AND GUTTER REPAIR
COOK COUNTY
C-91-115-06

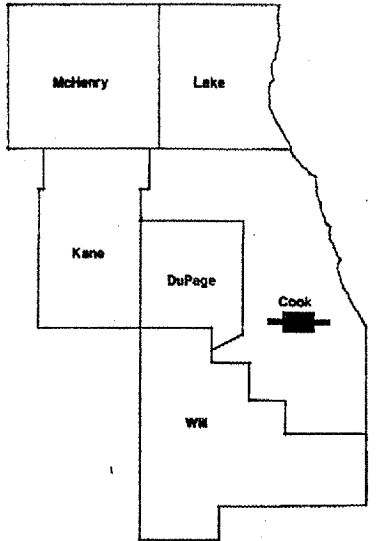

IMPROVEMENT IS LOCATED
IN THE CITY OF CHICAGO

LOCATION OF IMPROVEMENT INDICATED THUS:

R 13E

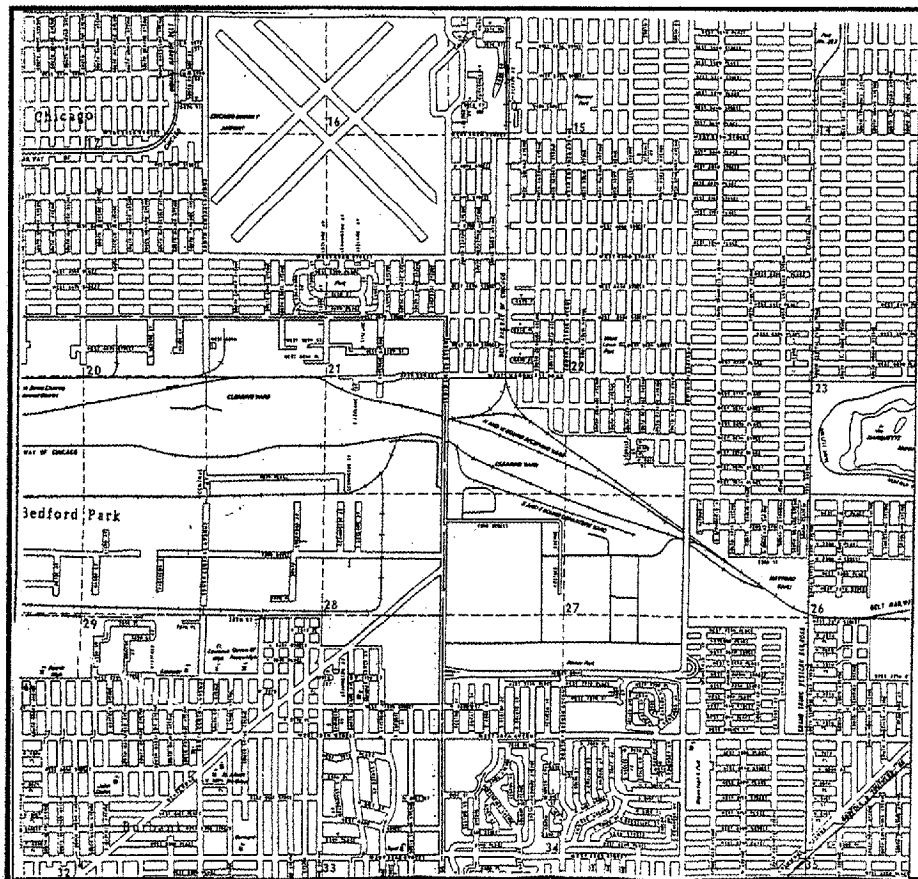

T 38 N

LAKE TOWNSHIP

IMPROVEMENT
LOCATION

STATE OF ILLINOIS
DEPARTMENT OF TRANSPORTATION
DIVISION OF HIGHWAYS

SUBMITTED: March 28 2006
Diane M. O'Keefe
DEPUTY DIRECTOR OF HIGHWAYS, REGION ENGINEER

May 12, 2006
Mike Hine
ENGINEER OF DESIGN AND ENVIRONMENT

May 12, 2006
Milton R. Sees, P.E.
DIRECTOR OF HIGHWAYS, CHIEF ENGINEER

**PRINTED BY THE AUTHORITY
OF THE STATE OF ILLINOIS**

C.U.A.N.: CHICAGO UTILITY ALERT
NETWORK
(312) 744-7000

DISTRICT ONE - PLAN PREPARATION ENGINEER:
KEN ENG/ R. BORO (847) 705-4178

CONTRACT NO. 60A83

ROUTE	SECTION	COUNTY	TOTAL SHEETS	SHEET NUMBER
VARIOUS	2005-0771	COOK	14	2

CONTRACT NO.: 60A83

INDEX OF SHEETS

1. TITLE SHEET
2. INDEX OF SHEETS, STATE STANDARDS, GENERAL NOTES AND MIXTURE REQUIREMENTS
3. SUMMARY OF QUANTITIES
- 4.-10. SCHEDULE OF QUANTITIES
11. DETAIL: CONCRETE DRIVEWAY
12. CURB AND GUTTER REMOVAL AND REPLACEMENT
13. CITY OF CHICAGO DETAILS FOR P.C. CONCRETE DRIVEWAY, ALLEY RETURN AND SIDEWALK
14. TRAFFIC CONTROL AND PROTECTION FOR SIDEROADS, INTERSECTIONS AND DRIVEWAYS

STATE STANDARDS

- 424001-04 SIDEWALK RAMPS ACCESSIBLE TO THE DISABLED
- 606001-02 CONCRETE CURB AND COMBINATION CONCRETE CURB AND GUTTER
- 701301-02 LANE CLOSURE, 2L, 2W, SHORT TIME OPERATIONS
- 701501-03 URBAN LANE CLOSURE, 2L, 2W UNDIVIDED
- 701801-03 LANE CLOSURE, MULTILANE, 1W OR 2W CROSSWALK OR SIDEWALK CLOSURE
- 702001-06 TRAFFIC CONTROL DEVICES

MIXTURE REQUIREMENTS

MIXTURE TYPE	AC TYPE	RAP % MAX	AIR VOIDS
BITUMINOUS CONCRETE SURFACE COURSE, SUPERPAVE, MIX D, N50	PG 64-22	15	4%@ 50 GYRATIONS

NOTE: THE UNIT WEIGHT USED TO CALCULATE BITUMINOUS SURFACE MIXTURES IS 112 LBS/SQ YD/IN.

GENERAL NOTES

BEFORE STARTING ANY EXCAVATION, THE CONTRACTOR SHALL CALL "C.U.A.N." (CHICAGO UTILITY ALERT NETWORK) AT (312)744-7000 FOR FIELD LOCATIONS OF BURIED ELECTRIC, TELEPHONE AND GAS UTILITIES. (48 HOUR NOTIFICATION IS REQUIRED).

THE CONTRACTOR WILL NOT BE ALLOWED TO SET UP A YARD OR FIELD OFFICE ON STATE PROPERTY WITHOUT WRITTEN PERMISSION FROM THE DEPARTMENT.

WHEN CONSTRUCTING SIDEWALK RAMPS FOR THE HANDICAPPED (STATE STANDARD 424001), USE TYPE B RAMPS UNLESS OTHERWISE SPECIFIED.

THESE PLANS HAVE BEEN PREPARED FROM NOTES RECEIVED FROM FIELD MAINTENANCE ENGINEERS.

THE COST OF BITUMINOUS SURFACE REMOVAL IN THE EXISTING GUTTER FLAG WILL BE INCLUDED IN THE UNIT PRICE BID FOR COMBINATION CURB AND GUTTER REMOVAL AND REPLACEMENT.

ALL DAMAGE TO EXISTING PAVEMENT MARKINGS SHALL BE REPLACED AT THE CONTRACTOR'S EXPENSE.

THE ENGINEER SHALL OBTAIN APPROVAL FROM THE DISTRICT ONE BUREAU CHIEF OF MAINTENANCE FOR ANY PROPOSED REVISIONS IN THE SCHEDULED CURB AND GUTTER REPAIR LOCATIONS.

DO NOT SCALE PLANS FOR CONSTRUCTION DIMENSIONS.

ALL CURBS AND GUTTERS ARE TYPE B6-12

PAINT CURB YELLOW AT FIRE HYDRANTS ACCORDING TO THE APPLICABLE REQUIREMENTS OF SECTION 780 OF THE STANDARD SPECIFICATIONS FOR PAINTED PAVEMENT MARKINGS, EXCEPT THE COST SHALL NOT BE PAID FOR SEPERATELY BUT SHALL BE INCLUDED IN "COMB. CONC. C&G, REMOVAL AND REPLACEMENT."

ADJACENT PARALLEL SIDEWALK, REMOVE AND REPLACE ENTIRE WIDTH OF SIDEWALK JOINT TO JOINT

ILLINOIS DEPARTMENT OF TRANSPORTATION

**INDEX OF SHEETS
STATE STANDARDS
GENERAL NOTES**

100%
STATE
URBAN

ROUTE
VARIOUS

SECTION
2005-0771

COUNTY
COOK

TOTAL
SHEETS
14

SHEET
NUMBER
3

CONTRACT NO.: 60A83

CONSTRUCTION CODE TYPE: SFTY - 1B

COOK CO.

CODE NO.	ITEMS	UNITS	TOTAL QUANTITIES
42001300	PROTECTIVE COAT	SQ YD	931
42300400	PORTLAND CEMENT CONCRETE DRIVEWAY PAVEMENT, 8 INCH	SQ YD	34
42400200	PORTLAND CEMENT CONCRETE SIDEWALK 5 INCH	SQ FT	3282
44000200	DRIVEWAY PAVEMENT REMOVAL	SQ YD	34
44000600	SIDEWALK REMOVAL	SQ FT	3282
44001115	BITUMINOUS CONCRETE SURFACE REMOVAL (FULL DEPTH)	SQ YD	400
44001700	COMBINATION CONCRETE CURB AND GUTTER REMOVAL AND REPLACEMENT	FOOT	2399
67000400	ENGINEER'S FIELD OFFICE, TYPE A	CAL MO	4
67100100	MOBILIZATION	L SUM	1
70102620	TRAFFIC CONTROL AND PROTECTION, STANDARD 701501	L SUM	1
70102640	TRAFFIC CONTROL AND PROTECTION, STANDARD 701801	L SUM	1
X0322467	TEMPORARY INFORMATION SIGNING FOR LANE CLOSURE	SQ FT	432
X4066424	BITUMINOUS CONCRETE SURFACE COURSE, SUPERPAVE, MIX "D", N50	TON	67.2

ILLINOIS DEPARTMENT OF TRANSPORTATION

SUMMARY OF QUANTITIES

ROUTE	SECTION	COUNTY	TOTAL SHEETS	SHEET NUMBER
VARIOUS	2005-0771	COOK	14	4

CONTRACT: 60A83

LOCATION	COMB. CONC. C & G R&R (LF)	BIT. CONC.SURF R&R FULL DEPTH (SQ YD)	SIDEWALK 5" R&R (SQ FT) 18" CARRIAGE	SIDEWALK 5" R&R (SQ FT) 5' PARALLEL	DRIVEWAY 8" R&R (SQ FT)	SALT TOLERANT SODDING (SQ YD)	REMARKS
6158 S. MENARD	31.0	5.2	4.5	0.0	0.0	4.7	62ND ST SIDE
6105 S. MAJOR	19.0	3.2	0.0	0.0	0.0	3.2	
5731 W. 64TH PL.	5.0	0.8	3.0	0.0	0.0	0.5	
5451 W. 64TH PL.	15.0	2.5	0.0	0.0	0.0	2.5	PARKING LOT
5721 W. 64TH ST.	5.0	0.8	0.0	0.0	0.0	0.8	PARKING/PLAY LOT
5700 W. 63RD PL.	13.0	2.2	0.0	65.0	0.0	0.0	5' OF 13' IS HANDICAP WALK 8' SEC. CONTAINS TY23 STRUC.
5900 W. 63RD PL.	5.0	0.8	0.0	0.0	0.0	0.8	AROUND MEDIAN RADIUS
5901 W. 63RD ST.	8.0	1.3	0.0	0.0	0.0	1.3	AROUND ALLY RADIUS ON MAYFIELD AVE.
6426 S. LAPORTE	15.0	2.5	4.5	0.0	0.0	2.0	WRONG ADDRESS: SHOULD BE 6428 (NEW HOME)
6301 S. LACROSSE	5.0	0.8	0.0	0.0	0.0	0.0	ADJACENT TO BRICK PAVERS
6025 S. KILPATRICK	5.0	0.8	0.0	0.0	0.0	0.8	TY1 STRUC. IN FRONT OF CURB
6051 S. KEATING	5.0	0.8	3.8	0.0	0.0	0.4	
6225 S. KEATING	5.0	0.8	3.8	0.0	0.0	0.4	2 MINOR CRACKS
6149 S. KILBOURN	5.0	0.8	4.5	0.0	0.0	0.3	TY1 STRUC. IN FRONT OF CURB
6158 S. KILBOURN	10.0	1.7	4.5	0.0	0.0	1.2	
5638 S. KILBOURN	18.0	3.0	0.0	0.0	0.0	3.0	
5620 S. KILBOURN	5.0	0.8	0.0	0.0	0.0	0.8	
5515 S. KENNETH	10.0	1.7	0.0	0.0	0.0	1.7	TYPE 1 STRUCTURE
5744 S. KENNETH	5.0	0.8	7.5	0.0	0.0	0.0	
5743 S. KENNETH	10.0	1.7	15.0	0.0	0.0	0.0	
6453 S. KENNETH	6.0	1.0	9.0	0.0	0.0	0.0	TYPE 1 STRUCTURE
6342 S. KILDARE	5.0	0.8	3.8	0.0	0.0	0.4	IN FRONT OF PCC PATCH
6404 S. KILDARE	16.0	2.7	3.0	0.0	0.0	2.3	TYPE 1 STRUCTURE
6726 S. KILDARE	5.0	0.8	7.5	0.0	0.0	0.0	
6813 S. KILDARE	17.0	2.8	0.0	0.0	0.0	2.8	
6750 S. KOLIN	17.0	2.8	25.5	0.0	0.0	0.0	TYPE 1 STRUCTURE/SUNKEN CARRIAGE WALK
6715 S. KOLIN	19.0	3.2	24.8	0.0	0.0	0.4	TYPE 1 STRUCT./SUNKEN CARRIAGE WALK/ALLY RADIUS
6634 S. KOLIN	5.0	0.8	7.5	0.0	0.0	0.0	
6558 S. KOLIN	18.0	3.0	0.0	0.0	0.0	3.0	TYPE 1 STRUCTURE
6819 S. KOSTNER	34.0	5.7	51.0	0.0	0.0	0.0	ALREADY SAW CUT
6812 S. TRIPP	5.0	0.8	7.5	0.0	0.0	0.0	TYPE 1 STRUCTURE
6748 S. TRIPP	5.0	0.8	0.0	0.0	0.0	0.8	TYPE 1 STRUCTURE
SUB-TOTAL	351.0	58.5	190.5	65.0	0.0	34.3	

ILLINOIS DEPARTMENT OF TRANSPORTATION

SCHEDULE OF QUANTITIES

ROUTE	SECTION	COUNTY	TOTAL SHEETS	SHEET NUMBER
VARIOUS	2005-0771	COOK	14	5

CONTRACT: 60A83

LOCATION	COMB. CONC. C & G R&R (LF)	BIT. CONC.SURF R&R FULL DEPTH (SQ YD)	SIDEWALK 5" R&R (SQ FT) 18" CARRIAGE	SIDEWALK 5" R&R (SQ FT) 5' PARALLEL	DRIVEWAY 8" R&R (SQ FT)	SALT TOLERANT SODDING (SQ YD)	REMARKS
6819 S. KOSTNER	34.0	5.7	51.0	0.0	0.0	0.0	PREVIOUSLY SAW CUT
6812 S. TRIPP	5.0	0.8	7.5	0.0	0.0	0.0	TY1 STRUC. ADJACENT TO CURB
6748 S. TRIPP	5.0	0.8	0.0	0.0	0.0	0.8	TY1 STRUC. ADJACENT TO CURB
6431 S. TRIPP	7.0	1.2	1.5	0.0	0.0	1.0	TY1 STRUC. ADJACENT TO CURB
6405 S. TRIPP	13.0	2.2	10.5	0.0	0.0	1.0	TY1 STRUC. ADJACENT TO CURB
6358 S. KILBOURN	15.0	2.5	0.0	0.0	0.0	2.5	
6339 S. KILBOURN	7.0	1.2	9.0	0.0	0.0	0.2	
6334 S. KILBOURN	5.0	0.8	0.0	0.0	0.0	0.8	ADJACENT TO FIELD
6816 S. KILBOURN	5.0	0.8	0.0	0.0	0.0	0.8	
6831 S. KEELER	10.0	1.7	7.5	0.0	0.0	0.8	5' ADJACENT TO TY1 STRUC.
6720 S. KEDVALE	5.0	0.8	0.0	0.0	0.0	0.8	
6447 S. KEDVALE	10.0	1.7	15.0	0.0	0.0	0.0	TY1 STRUC. ADJACENT TO CURB
6147 S. KEDVALE	12.0	2.0	0.0	0.0	0.0	2.0	TY1 STRUC. ADJACENT TO CURB
6110 S. KEDVALE	6.0	1.0	7.5	0.0	0.0	0.2	TY1 STRUC. ADJACENT TO CURB
5930 S. KEDVALE	16.0	2.7	3.8	0.0	0.0	2.3	TY1 STRUC. ADJACENT TO CURB/YELLOW PAINT
5949 S. KARLOV	7.0	1.2	0.0	0.0	0.0	1.2	TY1 STRUC. ADJACENT TO CURB
5955 S. KARLOV	10.0	1.7	7.5	0.0	0.0	0.8	
6023 S. KARLOV	5.0	0.8	7.5	0.0	0.0	0.0	
6050 S. KARLOV	23.0	3.8	0.0	0.0	0.0	3.8	TY1 STRUC. ADJACENT TO BASEBALL FIELD
6348 S. KARLOV	5.0	0.8	4.5	0.0	0.0	0.3	TY1 STRUC. ADJACENT TO CURB
6558 S. KARLOV	7.0	1.2	3.0	0.0	0.0	0.8	TY1 STRUC. ADJACENT TO CURB/PAINTED YELLOW
6630 S. KARLOV	8.0	1.3	0.0	0.0	0.0	1.3	TY1 STRUC. ADJACENT TO CURB
6657 S. KARLOV	9.0	1.5	0.0	0.0	0.0	1.5	
6536 S. KARLOV	5.0	0.8	7.5	0.0	0.0	0.0	
6644 S. KOMENSKY	5.0	0.8	7.5	0.0	0.0	0.0	
6630 S. KOMENSKY	5.0	0.8	0.0	0.0	0.0	0.8	TY1 STRUC. ADJACENT TO CURB
6624 S. KOMENSKY	5.0	0.8	7.5	0.0	0.0	0.0	PAINTED YELLOW
6501 S. KOMENSKY	100.0	16.7	0.0	0.0	52.5	10.8	5' ADJACENT TO TY1 STRUC.
6411 S. KOMENSKY	11.0	1.8	0.0	0.0	0.0	1.8	11' ADJACENT TY1 STRUC./PARTIAL AROUND RADIUS 64TH ST.
6314 S. KOMENSKY	17.0	2.8	0.0	0.0	0.0	2.8	10' ALLY RADIUS
6110 S. KOMENSKY	8.0	1.3	3.0	0.0	0.0	1.0	
6007 S. KOMENSKY	5.0	0.8	0.0	0.0	0.0	0.8	
5948 S. KOMENSKY	5.0	0.8	0.0	0.0	0.0	0.8	TY1 STRUC. ADJACENT TO CURB
SUB-TOTAL	395.0	65.8	161.3	0.0	52.5	42.1	

ILLINOIS DEPARTMENT OF TRANSPORTATION

SCHEDULE OF QUANTITIES

ROUTE	SECTION	COUNTY	TOTAL SHEETS	SHEET NUMBER
VARIOUS	2005-0771	COOK	14	6

CONTRACT: 60A83

LOCATION	COMB. CONC. C & G R&R (LF)	BIT. CONC.SURF R&R FULL DEPTH (SQ YD)	SIDEWALK 5" R&R (SQ FT) 18" CARRIAGE	SIDEWALK 5" R&R (SQ FT) 5' PARALLEL	DRIVEWAY 8" R&R (SQ FT)	SALT TOLERANT SODDING (SQ YD)	REMARKS
6049 S. KARLOV	7.0	1.2	0.0	0.0	0.0	1.2	
6545 S. KARLOV	17.0	2.8	3.8	0.0	0.0	2.4	5' ADJACENT TO TY1 STRUC.
6327 S. KILPATRICK	5.0	0.8	7.5	0.0	0.0	0.0	TY1 STRUC. ADJACENT TO CURB
5628 S. TRIPP	5.0	0.8	7.5	0.0	0.0	0.0	TY1 STRUC. ADJACENT TO CURB/PAINTED YELLOW
5659 S. KILDARE	5.0	0.8	0.0	0.0	0.0	0.8	
5707 S. KILDARE	5.0	0.8	7.5	0.0	0.0	0.0	TY1 STRUC. ADJACENT TO CURB
5658 S. KILDARE	25.0	4.2	0.0	0.0	0.0	4.2	INC. ADD./CORR. ADD. 5656/CURB LOC. ON 57TH ST.
5829 S. KILDARE	5.0	0.8	0.0	0.0	0.0	0.8	TY1 STRUC. ADJACENT TO CURB
5930 S. KILDARE	5.0	0.8	0.0	0.0	0.0	0.8	TY23 STRUC. ADJ. TO CURB/PAINTED YELLOW
5937 S. KILDARE	5.0	0.8	0.0	0.0	0.0	0.8	
5928 S. KILDARE	5.0	0.8	0.0	0.0	0.0	0.8	PAINTED YELLOW
5938 S. KEELER	14.0	2.3	21.0	0.0	0.0	0.0	NEW CARRIAGE BACKING CURB
6326 S. KEELER	11.0	1.8	0.0	0.0	0.0	1.8	TY1 STRUC. ADJACENT TO CURB
6359 S. KEELER	28.0	4.7	0.0	0.0	0.0	4.7	ADDRESS PART OF 6355 S. KEELER
6412 S. KEELER	5.0	0.8	0.0	0.0	0.0	0.8	
6440 S. KEELER	5.0	0.8	0.0	0.0	0.0	0.8	
6449 S. KEELER	10.0	1.7	15.0	0.0	0.0	0.0	TY1 STRUC. ADJACENT TO CURB
6507 S. KEELER	28.0	4.7	22.5	0.0	19.5	0.0	CARRIAGE WALK SETTLED
6518 S. KEELER	8.0	1.3	12.0	0.0	0.0	0.0	
6530 S. KEELER	36.0	6.0	54.0	0.0	0.0	0.0	CARRIAGE WALK SETTLED
6901 S. KOMENSKY	5.0	0.8	3.8	0.0	0.0	0.4	
4024 W. 57TH PL.	10.0	1.7	0.0	0.0	0.0	1.7	2.5' CURB PAINTED YELLOW
4050 W. 57TH PL.	15.0	2.5	10.5	0.0	0.0	1.3	TY1 STRUC. ADJACENT TO CURB/GRASS AREA
4054 W. 57TH PL.	5.0	0.8	6.0	0.0	0.0	0.2	
4107 W. 57TH PL.	12.0	2.0	18.0	0.0	0.0	0.0	
4111 W. 57TH PL.	7.0	1.2	0.0	0.0	0.0	1.2	TY1 STRUC. ADJACENT TO CURB
4130 W. 57TH ST.	32.0	5.3	3.8	0.0	21.0	2.6	
4122 W. 57TH ST.	5.0	0.8	0.0	25.0	0.0	0.0	NEED STAMP PATTERN OF BRICK (RED)
4115 W. 57TH ST.	5.0	0.8	7.5	0.0	0.0	0.0	
4114 W. 57TH ST.	5.0	0.8	0.0	0.0	0.0	0.8	
4106 W. 57TH ST.	10.0	1.7	0.0	0.0	0.0	1.7	
SUB-TOTAL	345.0	57.5	200.3	25.0	40.5	29.9	

ILLINOIS DEPARTMENT OF TRANSPORTATION

SCHEDULE OF QUANTITIES

ROUTE	SECTION	COUNTY	TOTAL SHEETS	SHEET NUMBER
VARIOUS	2005-0771	COOK	14	7

CONTRACT: 60A83

LOCATION	COMB. CONC. C & G R&R (LF)	BIT. CONC.SURF R&R FULL DEPTH (SQ YD)	SIDEWALK 5" R&R (SQ FT) 18" CARRIAGE	SIDEWALK 5" R&R (SQ FT) 5' PARALLEL	DRIVEWAY 8" R&R (SQ FT)	SALT TOLERANT SODDING (SQ YD)	REMARKS
4100 W. 57TH ST.	50.0	8.3	0.0	0.0	0.0	8.3	
4059 W. 57TH ST.	10.0	1.7	0.0	0.0	15.0	0.0	ADJACENT TO ALLY OFF OF KARLOV ST.
4042 W. 57TH ST.	5.0	0.8	7.5	0.0	0.0	0.0	
4033 W. 57TH ST.	12.0	2.0	18.0	0.0	0.0	0.0	
4043 W. 56TH ST.	30.0	5.0	45.0	0.0	0.0	0.0	CARRIAGE WALK SETTLED
5552 S. KOLIN	5.0	0.8	0.0	0.0	0.0	0.8	
5526 S. KOLIN	5.0	0.8	0.0	0.0	0.0	0.8	PAINTED YELLOW/FIRE HYDRANT ADJACENT TO CURB
6145 S. KOLMAR	9.0	1.5	11.3	0.0	0.0	0.3	TY1 STRUC. ADJACENT TO CARRIAGE
6105 S. MAJOR	19.0	3.2	0.0	0.0	0.0	3.2	
6054 S. MEADE	5.0	0.8	0.0	0.0	0.0	0.8	
5542 S. KEDVALE	5.0	0.8	0.0	0.0	0.0	0.8	
4048 W. 58TH ST.	10.0	1.7	7.5	0.0	0.0	0.8	
4014 W. 58TH ST.	5.0	0.8	6.0	0.0	0.0	0.2	
3741 W. 61ST PL.	21.0	3.5	31.5	0.0	0.0	0.0	5' TY1 STRUC. IN CARRIAGE/TY23 STRUC. IN CURB
5939 S. SPRINGFIELD	7.0	1.2	0.0	0.0	0.0	1.2	
7119 S. SPRINGFIELD	5.0	0.8	0.0	0.0	0.0	0.8	
7123 S. SPRINGFIELD	5.0	0.8	4.5	0.0	0.0	0.3	
7125 S. SPRINGFIELD	5.0	0.8	4.5	0.0	0.0	0.3	
7128 S. SPRINGFIELD	6.0	1.0	9.0	0.0	0.0	0.0	
7129 S. SPRINGFIELD	20.0	3.3	10.5	0.0	0.0	2.2	
7215 S. SPRINGFIELD	12.0	2.0	18.0	0.0	0.0	0.0	
3900 W. 71ST ST.	38.0	6.3	0.0	0.0	0.0	6.3	ON SIDE OF BUILDING (SPRINGFIELD AVE.)
3905 W. 69TH PL.	5.0	0.8	7.5	0.0	0.0	0.0	
3901 W. 69TH PL.	30.0	5.0	17.3	0.0	0.0	3.1	16' NEAR DRIVEWAY
3859 W. 70TH PL.	10.0	1.7	3.8	0.0	0.0	1.3	5' CURB PAINTED YELLOW
3859 W. 68TH ST.	20.0	3.3	3.0	0.0	22.5	0.5	ON SPRINGFIELD AVE. SIDE
7228 S. RIDGEWAY	12.0	2.0	3.0	0.0	0.0	1.7	TY1 STRUC. ADJACENT TO CURB/PAINTED YELLOW
7250 S. RIDGEWAY	5.0	0.8	6.0	0.0	0.0	0.2	TY1 STRUC. ADJACENT TO CURB
SUB-TOTAL	371.0	61.8	213.8	0.0	37.5	33.9	

ILLINOIS DEPARTMENT OF TRANSPORTATION

SCHEDULE OF QUANTITIES

ROUTE	SECTION	COUNTY	TOTAL SHEETS	SHEET NUMBER
VARIOUS	2005-0771	COOK	14	8

CONTRACT: 60A83

LOCATION	COMB. CONC. C & G R&R (LF)	BIT. CONC.SURF R&R FULL DEPTH (SQ YD)	SIDEWALK 5" R&R (SQ FT) 18" CARRIAGE	SIDEWALK 5" R&R (SQ FT) 5' PARALLEL	DRIVEWAY 8" R&R (SQ FT)	SALT TOLERANT SODDING (SQ YD)	REMARKS
7258 S. RIDGEWAY	5.0	0.8	7.5	0.0	0.0	0.0	2.5' CURB PAINTED YELLOW
7225 S. AVERS	6.0	1.0	9.0	0.0	0.0	0.0	
6950 S. LAWNDALE	10.0	1.7	0.0	0.0	0.0	1.7	CURB NEAR CORNER
4151 W. 78TH PL.	10.0	1.7	0.0	50.0	0.0	0.0	
4141 W. 78TH PL.	42.0	7.0	0.0	150.0	18.0	0.0	
4348 W. 78TH ST.	9.0	1.5	0.0	0.0	0.0	1.5	9' FROM DRIVEWAY TO TY1 STRUC.
4210 W. 77TH PL.	10.0	1.7	0.0	0.0	0.0	1.7	
4224 W. 77TH PL.	12.0	2.0	0.0	0.0	10.5	0.8	
4338 W. 77TH PL.	5.0	0.8	0.0	0.0	0.0	0.8	
4349 W. 77TH PL.	5.0	0.8	0.0	0.0	0.0	0.8	CURB ADJACENT TO TY1 STRUC.
4434 W. 77TH PL.	10.0	1.7	0.0	0.0	1.5	1.5	CURB ADJACENT TO TY1 STRUC.
4544 W. 77TH PL.	16.0	2.7	0.0	0.0	16.5	0.8	
7700 S. KENTON	5.0	0.8	0.0	0.0	0.0	0.8	
7747 S. KENTON	11.0	1.8	0.0	0.0	4.5	1.3	TY1 STRUC. IN FRONT OF 8' SECT.
7805 S. KENTON	15.0	2.5	0.0	0.0	19.5	0.3	
7806 S. KENTON	10.0	1.7	0.0	0.0	15.0	0.0	CURB ADJACENT TO TY1 STRUC.
7817 S. KENTON	13.0	2.2	0.0	0.0	0.0	2.2	
7843 S. KENTON	5.0	0.8	0.0	0.0	0.0	0.8	
7748 S. KNOX	10.0	1.7	0.0	0.0	0.0	1.7	
7708 S. KNOX	14.0	2.3	0.0	0.0	0.0	2.3	CURB ADJACENT TO TY1 STRUC.
7724 S. KOLMAR	10.0	1.7	0.0	0.0	0.0	1.7	
7817 S. KOLMAR	5.0	0.8	0.0	0.0	0.0	0.8	CURB ADJACENT TO TY1 STRUC.
7717 S. KILBOURN	5.0	0.8	0.0	0.0	0.0	0.8	ON 77TH PL. SIDE OF HOUSE
7720 S. KILBOURN	5.0	0.8	0.0	0.0	0.0	0.8	
7804 S. KEELER	5.0	0.8	0.0	25.0	0.0	0.0	
7800 S. KEELER	10.0	1.7	0.0	50.0	0.0	0.0	
7814 S. KEELER	25.0	4.2	0.0	125.0	0.0	0.0	
7815 S. KEELER	5.0	0.8	0.0	25.0	0.0	0.0	
7826 S. KEELER	10.0	1.7	0.0	25.0	7.5	0.0	
7830 S. KEELER	13.0	2.2	0.0	65.0	0.0	0.0	
7838 S. KEELER	20.0	3.3	0.0	100.0	0.0	0.0	
7855 S. KEELER	15.0	2.5	0.0	75.0	0.0	0.0	
SUB-TOTAL	351.0	58.5	16.5	690.0	93.0	23.3	

ILLINOIS DEPARTMENT OF TRANSPORTATION

SCHEDULE OF QUANTITIES

ROUTE	SECTION	COUNTY	TOTAL SHEETS	SHEET NUMBER
VARIOUS	2005-0771	COOK	14	9

CONTRACT: 60A83

LOCATION	COMB. CONC. C & G R&R (LF)	BIT. CONC.SURF R&R FULL DEPTH (SQ YD)	SIDEWALK 5" R&R (SQ FT) 18" CARRIAGE	SIDEWALK 5" R&R (SQ FT) 5' PARALLEL	DRIVEWAY 8" R&R (SQ FT)	SALT TOLERANT SODDING (SQ YD)	REMARKS
7856 S. KEELER	10.0	1.7	0.0	50.0	0.0	0.0	
7835 S. KARLOV	32.0	5.3	0.0	100.0	18.0	0.0	
7919 S. KARLOV	5.0	0.8	0.0	0.0	0.0	0.8	
7923 S. KARLOV	10.0	1.7	0.0	0.0	0.0	1.7	5' ADJ. TO TY1 STRUC./5' ADJ. TO DRIVEWAY
7930 S. KOMENSKY	10.0	1.7	7.5	0.0	0.0	0.8	
7951 S. KOMENSKY	5.0	0.8	0.0	0.0	0.0	0.8	
8031 S. KEDVALE	14.0	2.3	0.0	0.0	0.0	2.3	
8009 S. KEDVALE	10.0	1.7	0.0	0.0	0.0	1.7	
7955 S. KEDVALE	15.0	2.5	0.0	0.0	19.5	0.3	13' ADJACENT TO TY1 STRUC.
7951 S. KEDVALE	5.0	0.8	0.0	0.0	0.0	0.8	
7938 S. KEDVALE	8.0	1.3	0.0	0.0	0.0	1.3	
7864 S. KEDVALE	30.0	5.0	0.0	150.0	0.0	0.0	
7840 S. KEDVALE	10.0	1.7	0.0	50.0	0.0	0.0	
7837 S. KEDVALE	10.0	1.7	0.0	50.0	0.0	0.0	
7947 S. KEELER	5.0	0.8	0.0	0.0	0.0	0.8	CURB ADJACENT TO TY1 STRUC.
7952 S. KEELER	5.0	0.8	0.0	0.0	0.0	0.8	
8020 S. KEELER	7.0	1.2	0.0	0.0	0.0	1.2	CURB PAINTED YELLOW IN FRONT OF HYDRANT
4104 W. 82ND PL.	20.0	3.3	0.0	100.0	0.0	0.0	
4136 W. 83RD ST.	10.0	1.7	0.0	25.0	7.5	0.0	
4162 W. 82ND ST.	10.0	1.7	0.0	50.0	0.0	0.0	
4008 W. 81ST ST.	15.0	2.5	0.0	75.0	0.0	0.0	DRIVEWAY WEST 15'
4153 W. 80TH PL.	5.0	0.8	0.0	0.0	0.0	0.8	CURB PAINTED YELLOW/ADJ. TO TY1 STRUC.
7839 S. KEATING	5.0	0.8	0.0	0.0	0.0	0.8	CURB ADJ. TO CHASE BANK P. LOT
7820 S. KEATING	7.0	1.2	0.0	0.0	0.0	1.2	
8029 S. KENTON	10.0	1.7	0.0	50.0	0.0	0.0	
7764 S. KOMENSKY	10.0	1.7	0.0	50.0	0.0	0.0	
7726 S. KOMENSKY	10.0	1.7	0.0	50.0	0.0	0.0	CURB ADJACENT TO TY1 STRUC.
8229 S. KOMENSKY	10.0	1.7	0.0	50.0	0.0	0.0	TY1 STRUC. IN 10' SECT.
4154 W. 77TH PL.	15.0	2.5	0.0	75.0	0.0	0.0	
4044 W. 77TH PL.	10.0	1.7	0.0	50.0	0.0	0.0	
SUB-TOTAL	328.0	54.6	7.5	975.0	45.0	16.3	

ILLINOIS DEPARTMENT OF TRANSPORTATION
SCHEDULE OF QUANTITIES

ROUTE	SECTION	COUNTY	TOTAL SHEETS	SHEET NUMBER
VARIOUS	2005-0771	COOK	14	10

CONTRACT: 60A83

LOCATION	COMB. CONC. C & G R&R (LF)	BIT. CONC.SURF R&R FULL DEPTH (SQ YD)	SIDEWALK 5" R&R (SQ FT) 18" CARRIAGE	SIDEWALK 5" R&R (SQ FT) 5' PARALLEL	DRIVEWAY 8" R&R (SQ FT)	SALT TOLERANT SODDING (SQ YD)	REMARKS
5919 S. KEELER	5.0	0.8	0.0	0.0	0.0	0.8	
7835 S. KEELER	26	4.3	0	75	16.5	0	
7835 S. KARLOV	132	22	0	600	18	0	
4030 W. 57TH ST.	8	1.3	0	0	0	1.3	
5912 W. 60TH ST.	10.0	1.7	15.0	0.0	0.0	0.0	
4500 W. 64TH PL.	9	1.5	0	0	0	1.5	PAINTED YELLOW
4500 W. 64TH ST.	6	1	0	0	0	1	TYPE 1 STRUCTURE ADJACENT TO BASEBALL FIELD
3858 W. 67TH PL.	25	4.2	0	25	0	3.3	PAINTED YELLOW
3916 W. 67TH PL.	15	2.5	22.5	0	0	0	SUNKEN CATWALK
3859 W. 70TH PL	14	2.3	0	0	0	2.3	LOCATED ON SIDE OF HOUSE ON SPRINGFIELD
6800 S. KEDVALE	8	1.3	0	0	0	1.3	RADIUS CORNER TYPE 1 STRUCTURE
SUB-TOTAL	258.0	42.9	37.5	700.0	34.5	11.5	

TOTAL FOR PROJECT:	2399.0	399.7	827.3	2455.0	303.0	191.5
---------------------------	---------------	--------------	--------------	---------------	--------------	--------------

ILLINOIS DEPARTMENT OF TRANSPORTATION

SCHEDULE OF QUANTITIES

ROUTE	SECTION	COUNTY	TOTAL SHEETS	SHEET NUMBER
VARIOUS	2005-0771	COOK	14	11

CONTRACT NO.: 60A83

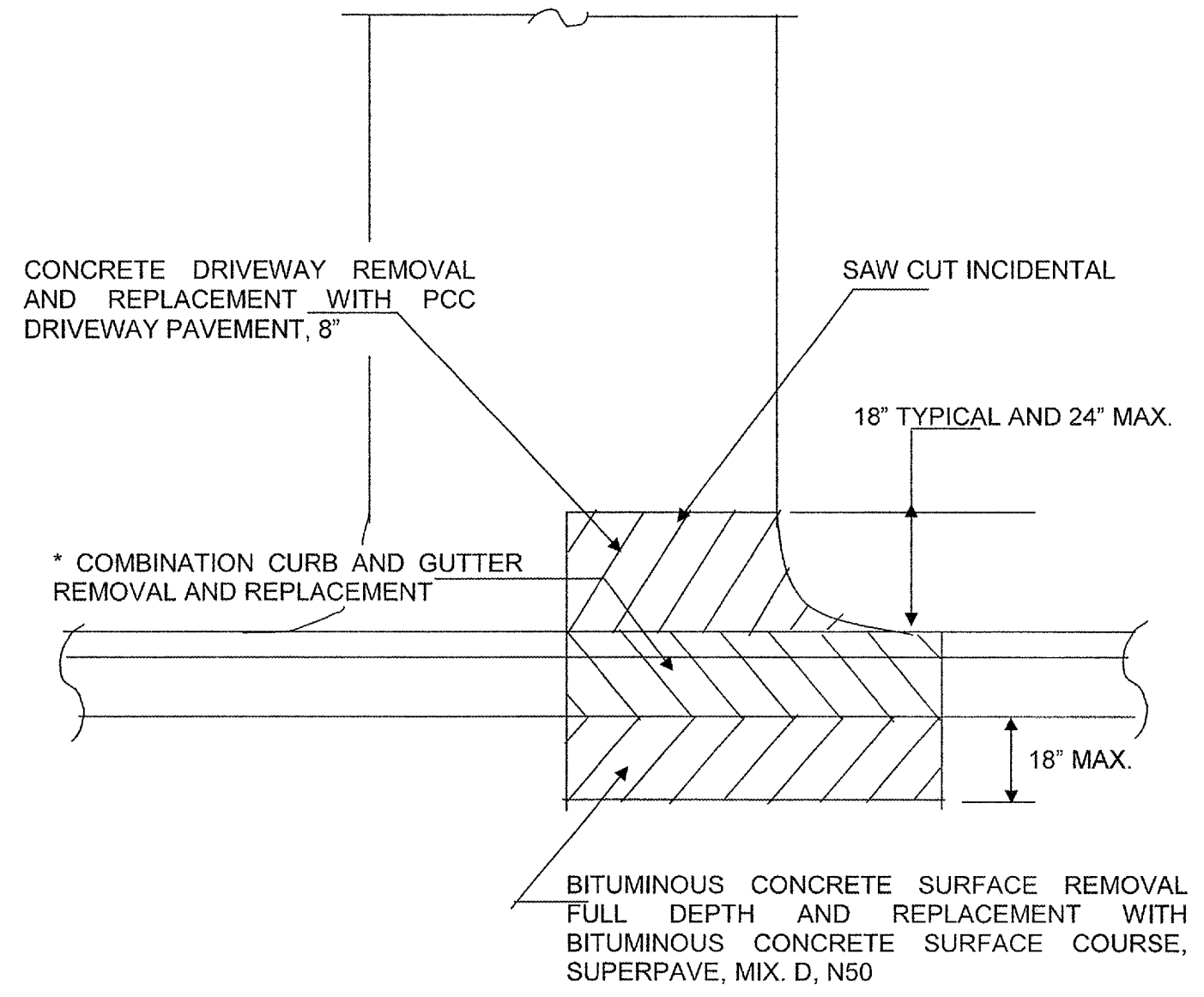

* PROPOSED DEPRESSED CURB AND EXACT LENGTH SHALL BE DETERMINED IN THE FIELD BY THE ENGINEER (TYPICAL)

ILLINOIS DEPARTMENT OF TRANSPORTATION

DETAIL: CONCRETE DRIVEWAY

F. A. DIST.	SECTION	COUNTY	TOTAL SHEETS	SHEET NO.
			14	12
STA.		TO STA.		
FED. ROAD DIST. NO.	ILLINOIS	FED. AID PROJECT		

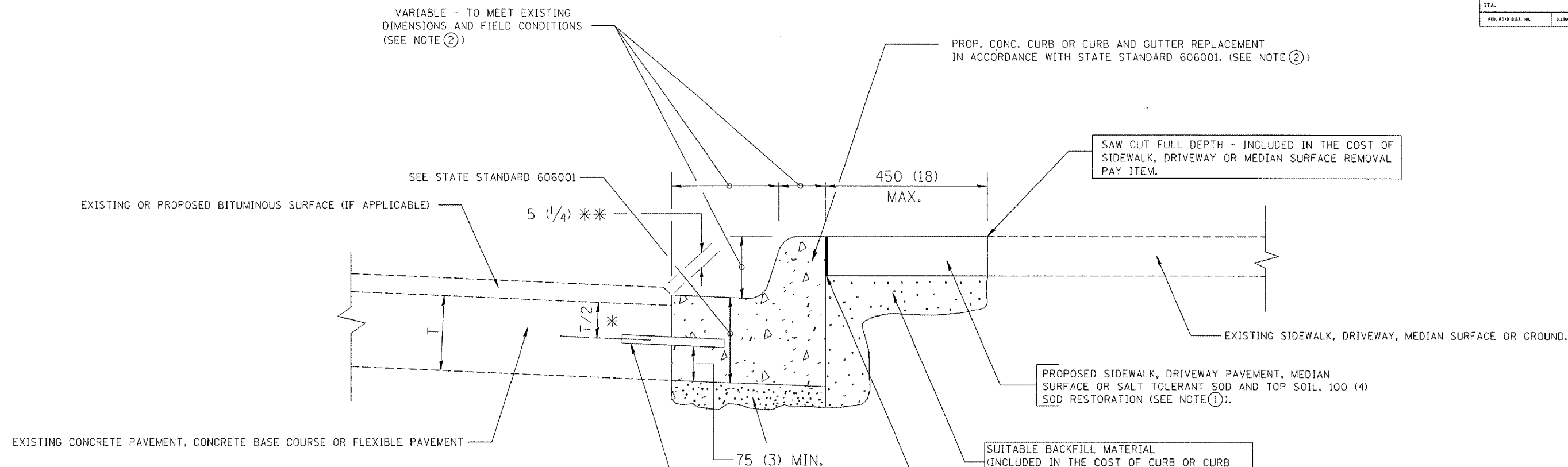

* 75 (3) MINIMUM FROM TOP AND BOTTOM OF THE CONCRETE PAVEMENT OR BASE COURSE.
 ** IF THE FINAL SURFACE OF THE PAVEMENT IS CONCRETE, THE GUTTER IS TO BE FLUSH WITH THE PAVEMENT.

NOTE: ① SIDEWALK, DRIVEWAY PAVEMENT OR MEDIAN SURFACE SHALL BE SIMILAR TO THE MATERIAL BEING REMOVED AND WILL BE PAID FOR SEPARATELY.

SALT TOLERANT SOD AND TOP SOIL, 100 (4) RESTORATION WILL NOT BE PAID FOR SEPARATELY, BUT SHALL BE INCLUDED IN THE COST OF CURB OR CURB AND GUTTER REMOVAL AND REPLACEMENT.

- ② CURB OR CURB AND GUTTER REPLACEMENT SHALL MATCH THE SHAPE OF THE EXISTING CURB OR CURB AND GUTTER UNLESS OTHERWISE SPECIFIED.
- ③ FOR CURB OR CURB AND GUTTER REMOVAL AND REPLACEMENT ADJACENT TO FLEXIBLE PAVEMENT DELETE EPOXY COATED TIE BARS.
- ④ LONGITUDINAL BARS, IF ENCOUNTERED IN THE EXISTING CURB OR CURB AND GUTTER, ARE NOT TO BE REPLACED. CUTTING AND REMOVING LONGITUDINAL BARS SHALL BE INCLUDED IN THE COST OF CURB OR CURB AND GUTTER REMOVAL AND REPLACEMENT.
- ⑤ THE COST OF BITUMINOUS SURFACE REMOVAL IN THE EXISTING GUTTER FLAG SHALL BE INCLUDED IN THE COST OF THE CURB AND GUTTER REMOVAL AND REPLACEMENT.
- ⑥ THE REMOVAL AND REPLACEMENT OF THE EXISTING CURB OR CURB AND GUTTER SHALL BE DONE IN ACCORDANCE WITH THE APPLICABLE PORTIONS OF SECTION 440 AND 606 OF THE STANDARD SPECIFICATIONS.
- ⑦ THE LOCATIONS OF REMOVAL AND REPLACEMENT OF EXISTING CURB OR CURB AND GUTTER SHALL BE DETERMINED BY THE RESIDENT ENGINEER AT THE TIME OF CONSTRUCTION.

UNSUITABLE SUB-BASE MATERIAL TO BE REMOVED, IF DIRECTED BY THE ENGINEER, SHALL BE REPLACED WITH EITHER SUB-BASE GRANULAR MATERIAL, TYPE B OR ADDITIONAL THICKNESS OF CONCRETE.

REMOVAL AND REPLACEMENT 100 (4) OR LESS IS INCLUDED IN THE COST OF CURB OR CURB AND GUTTER REMOVAL AND REPLACEMENT.

REMOVAL AND REPLACEMENT IN EXCESS OF 100 (4) WILL BE PAID FOR IN ACCORDANCE WITH ARTICLE 109.04 OF THE STANDARD SPECIFICATIONS.

PROPOSED NO. 20 (NO. 6) EPOXY COATED TIE BARS 600 (24) LONG AT 600 (24) CENTERS WILL NOT BE PAID FOR SEPARATELY. DELETE EPOXY COATED TIE BARS IF EXISTING TIE BARS ARE USUABLE AS DETERMINED BY THE ENGINEER. (SEE NOTE ③).

BASIS OF PAYMENT:
 THIS WORK WILL BE PAID FOR AT THE CONTRACT UNIT PRICE PER METER (FOOT) FOR "CURB REMOVAL AND REPLACEMENT" OR "COMBINATION CONCRETE CURB AND GUTTER REMOVAL AND REPLACEMENT".

CURB OR CURB AND GUTTER REMOVAL AND REPLACEMENT

ALL DIMENSIONS ARE IN MILLIMETERS (INCHES) UNLESS OTHERWISE SHOWN.

REVISIONS	
NAME	DATE
M. DE YONG	05/28/91
A. HOUSEH	03/11/94
R. SHAH	02/24/95
R. SHAH	03/02/95
R. SHAH	08/19/96
R. SHAH	09/12/96
R. SHAH	09/19/96
R. SHAH	10/03/96
A. ABBAS	03/21/97
M. GOMEZ	01/22/01

ILLINOIS DEPARTMENT OF TRANSPORTATION
**CURB OR
 CURB AND GUTTER
 REMOVAL AND REPLACEMENT**

SCALE: NONE
 DATE 10/18/2002
 DRAWN BY
 CHECKED BY

P.A. NO.	SECTION	COUNTY	TOTAL SHEETS	SHEET NO.
	2005-0711	COOK	14	13
STA.	TO STA.			
FED. ROAD DIST. NO. 1	ALDERS	FED. AID PROJECT		

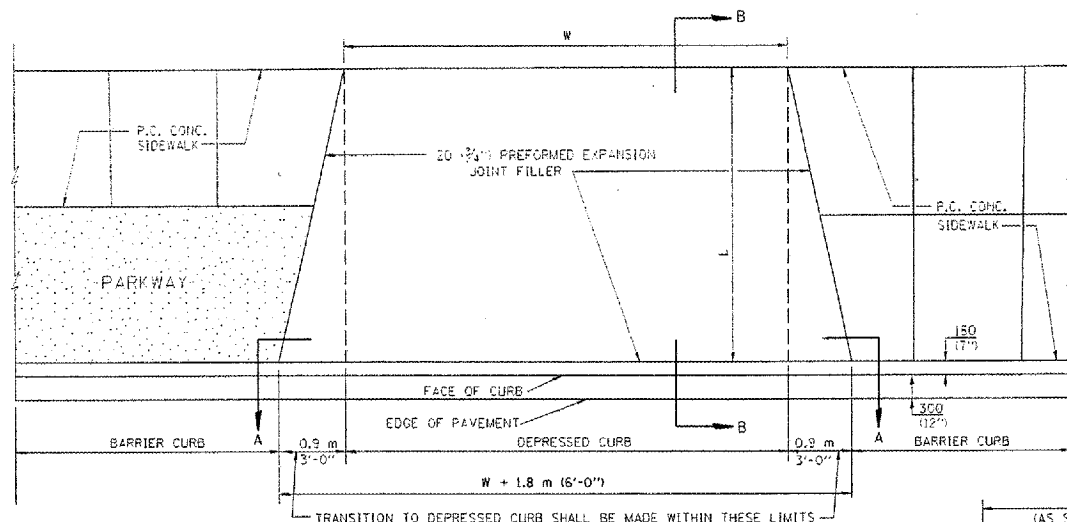

- NOTES:
1. EXPANSION JOINTS SHALL BE CONSTRUCTED AS SHOWN ON THE DETAILS FOR P.C.C. SIDEWALK.
 2. THE CURB BETWEEN ADJACENT DRIVEWAYS SHALL BE FULL HEIGHT FOR A DISTANCE OF AT LEAST FOUR 1.2 METERS (4 FEET).
 3. P.C. CONCRETE DRIVEWAYS SHALL BE CONSTRUCTED AT LOCATIONS SHOWN ON THE PLANS OR AS DIRECTED BY THE ENGINEER.
 4. 20 (3/4)\"/>

PLAN VIEW

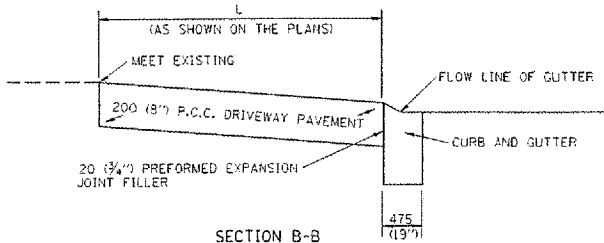

SECTION B-B

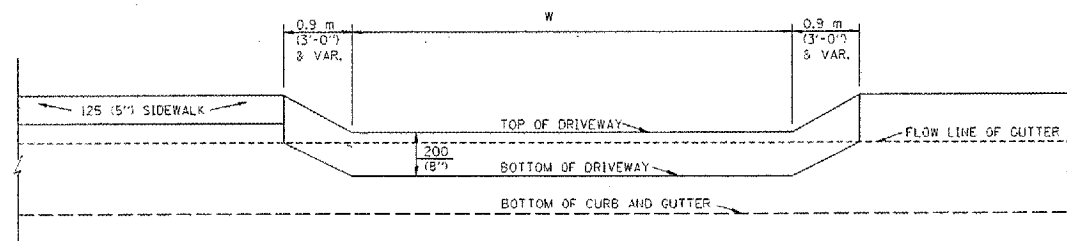

SECTION A-A

P.C.C. DRIVEWAY PAVEMENT DETAIL

FOR INFORMATION ONLY

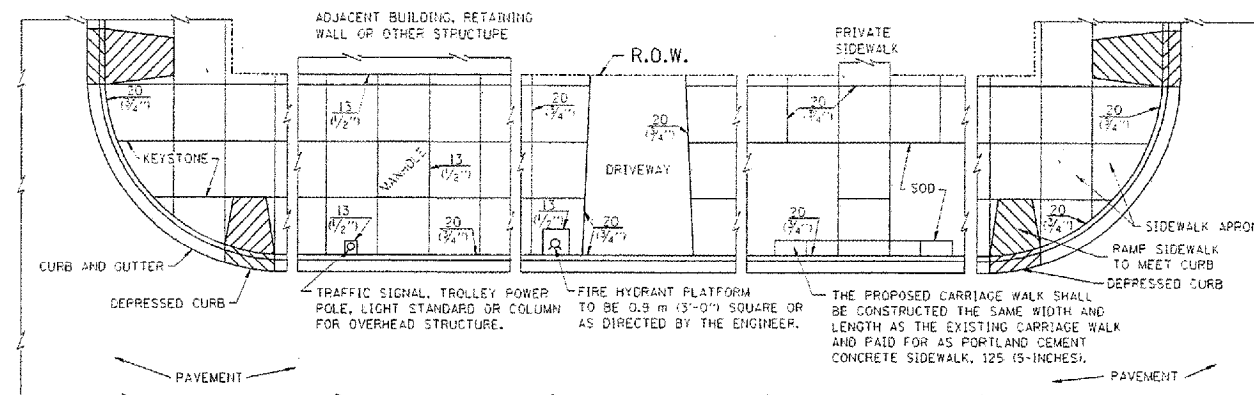

NOTES:

1. ONE-HALF INCH THICK EXPANSION JOINTS SHALL BE PLACED BETWEEN THE SIDEWALK AND ALL STRUCTURES SUCH AS LIGHT STANDARDS, TRAFFIC LIGHT STANDARDS, MANHOLES, WHICH EXTEND THROUGH THE SIDEWALK.
2. 20 (3/4)\"/>

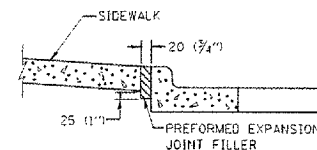

SLOPE FOR SIDEWALK
25 (1)\"/>

PORTLAND CEMENT CONCRETE SIDEWALK DETAILS

NOTES: NO EXTRA COMPENSATION SHALL BE ALLOWED FOR THE GUTTER FLARE

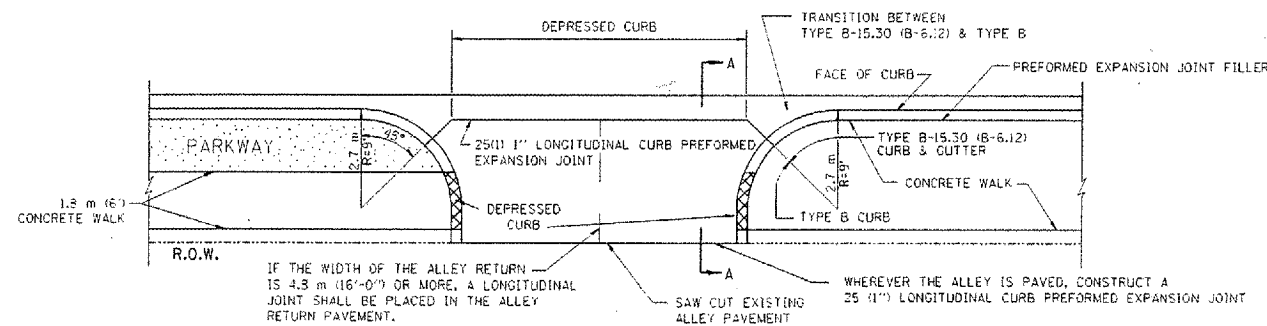

IF THE WIDTH OF THE ALLEY RETURN IS 4.3 m (16'-0)\"/>

WHEREVER THE ALLEY IS PAVED, CONSTRUCT A 25 (1)\"/>

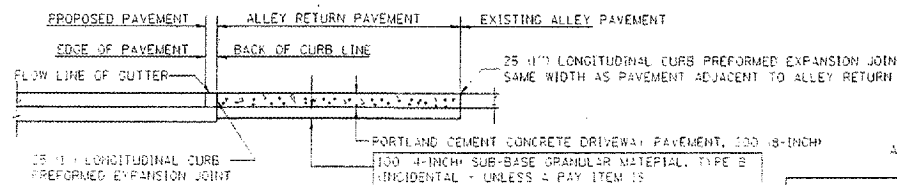

SECTION A-A

ALLEY RETURN DETAIL

REVISIONS	
NAME	DATE
M. DE YONG	06/13/90

ILLINOIS DEPARTMENT OF TRANSPORTATION
CITY OF CHICAGO
DETAILS FOR P.C. CONCRETE DRIVEWAY, ALLEY RETURN AND SIDEWALK

SCALE: NONE
DATE: 10/18/2002

DRAWN BY R/JH
CHECKED BY

BD400-03 (BD-17)

REVISION DATE: 06/13/90

F.A. RTE.	SECTION	COUNTY	TOTAL SHEETS	SHEET NO.
			14	14
STA.		TO STA.		
FED. ROAD DIST. NO. 1		ILLINOIS	FED. AID PROJECT	

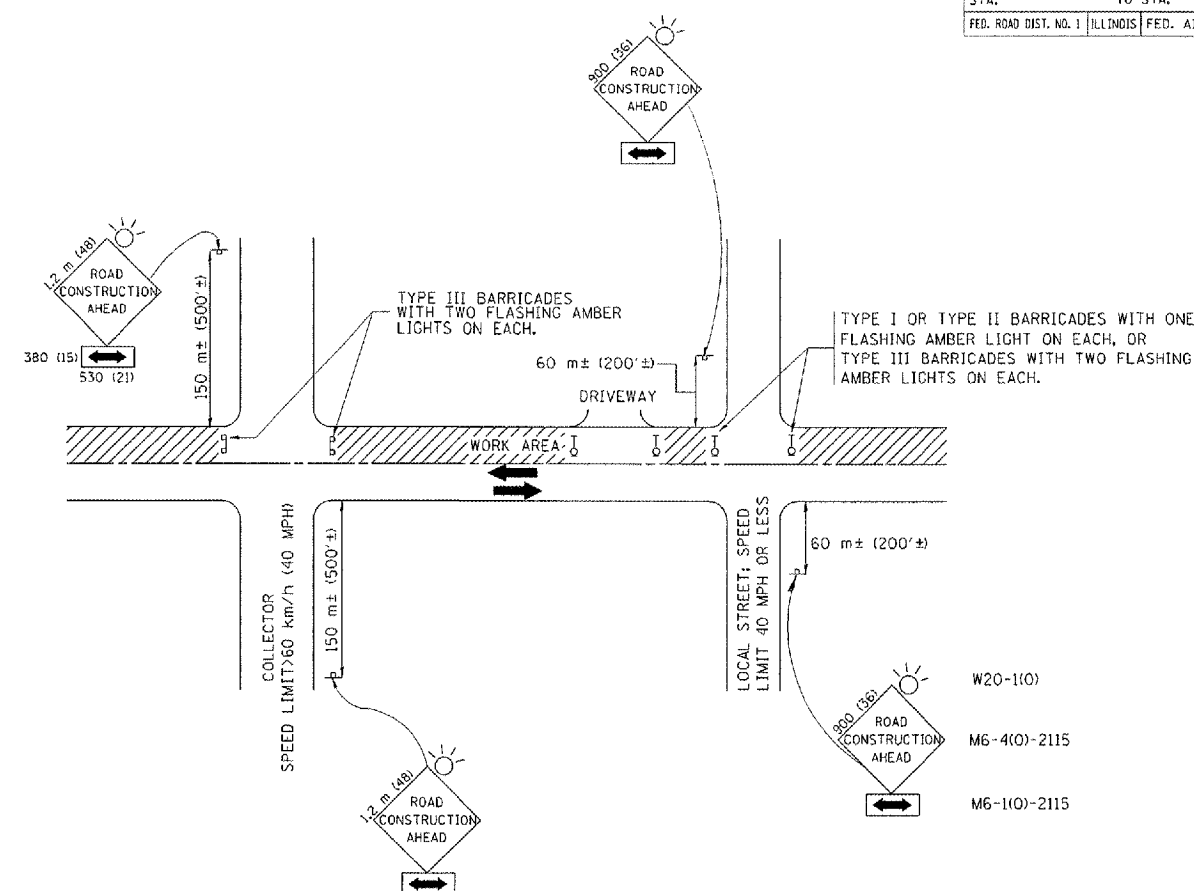

TRAFFIC CONTROL AND PROTECTION FOR SIDE ROADS, INTERSECTIONS, AND DRIVEWAYS

NOTES:

- A. FOR NO LANE RESTRICTION ON THE SIDE ROAD OR DRIVEWAYS
- SIDE ROAD WITH A SPEED LIMIT OF 60 km/h (40 MPH) OR LESS AS SHOWN ON THE DRAWING AND AS DIRECTED BY THE ENGINEER:
 - ONE **ROAD CONSTRUCTION AHEAD** SIGN 900x900 (36x36) WITH A FLASHER AND FLAG MOUNTED ON IT APPROXIMATELY 60 m (200') IN ADVANCE OF THE MAIN ROUTE.
 - THE CLOSED PORTION OF THE MAIN ROUTE SHALL BE PROTECTED BY BLOCKING WITH TYPE I, TYPE II OR TYPE III BARRICADES, 1/3 OF THE CROSS SECTION OF THE CLOSED PORTION.
 - SIDE ROAD WITH A SPEED LIMIT GREATER THAN 60 km/h (40 MPH) AS SHOWN ON THE DRAWING AND AS DIRECTED BY THE ENGINEER:
 - ONE **ROAD CONSTRUCTION AHEAD** SIGN 1.2 m x 1.2 m (48x48) WITH A FLASHER MOUNTED ON IT APPROXIMATELY 150 m (500') IN ADVANCE OF THE MAIN ROUTE.
 - THE CLOSED PORTION OF THE MAIN ROUTE SHALL BE PROTECTED BY BLOCKING WITH TYPE III BARRICADES, 1/2 OF THE CROSS SECTION OF THE CLOSED PORTION.
 - WHEN THE SIDE ROAD LIES BETWEEN THE BEGINNING OF THE MAINLINE SIGNING AND THE WORK ZONE, A SINGLE HEADED ARROW (M6-1) SHALL BE USED IN LIEU OF THE DOUBLE HEADED ARROW (M6-4).
- B. FOR A LANE CLOSURE ON A SIDE ROAD OR DRIVEWAY:
- USE APPLICABLE PORTIONS OF THE TYPICAL APPLICATION OF TRAFFIC CONTROL DEVICES (STD. 701501, STD. 701606 OR THE APPROPRIATE STANDARD). THE SPACING OF SIGNS AND BARRICADES SHALL BE ADJUSTED FOR FIELD CONDITIONS AS DIRECTED BY THE ENGINEER. THE DIRECTIONAL ARROW SHALL BE COVERED OR REMOVED WHEN NO LONGER CONSISTENT WITH THE SIDE ROAD LANE CLOSURE.
- C. ADVANCE WARNING SIGNS ARE TO BE OMITTED ON DRIVEWAY UNLESS OTHERWISE NOTED.
- D. THE TRAFFIC CONTROL AND PROTECTION FOR SIDE ROADS, INTERSECTIONS, AND DRIVEWAYS SHALL BE INCIDENTAL TO THE COST OF SPECIFIED TRAFFIC CONTROL STANDARDS OR ITEMS.

REVISIONS	
NAME	DATE
LHA	6/89
T. RAMMACHER	09/08/94
J. OBERLE	10/18/95
A. HOUSEH	03/08/96
A. HOUSEH	10/15/96
T. RAMMACHER	01/06/00

ILLINOIS DEPARTMENT OF TRANSPORTATION
TRAFFIC CONTROL AND PROTECTION FOR SIDE ROADS, INTERSECTIONS, AND DRIVEWAYS

SCALE: VERT.
 HORIZ.
 DATE 10/18/2002

DRAWN BY
 CHECKED BY
 TC-10