

F.A.P. RTE.	SECTION	COUNTY	TOTAL SHEETS	SHEET NO.
029	2001-050-TS	COOK	21	21
STA.		TO STA.		
FED. ROAD DIST. NO. 1 ILLINOIS FED. AID PROJECT				
CONTRACT# 62201				

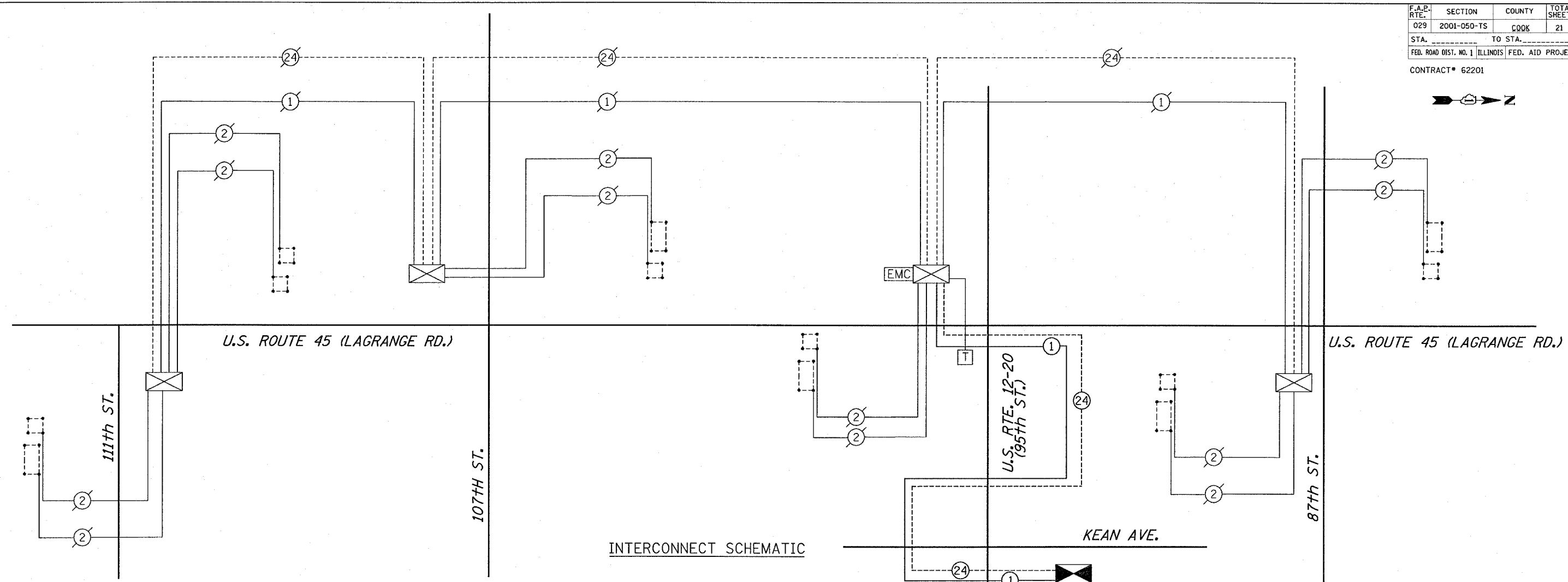
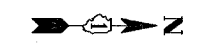

INTERCONNECT SCHEMATIC

INTERCONNECT SCHEMATIC LEGEND

EXISTING INTERSECTION CONTROLLER		EXISTING SAMPLING (SYSTEM) PREFORMED DETECTORS	
PROPOSED INTERSECTION CONTROLLER		PROPOSED SAMPLING (SYSTEM) PREFORMED DETECTORS	
EXISTING MASTER CONTROLLER		EXISTING FIBER OPTIC CABLE IN CONDUIT, NO. 62.5/125, MM12F SM12F	
PROPOSED MASTER CONTROLLER		PROPOSED FIBER OPTIC CABLE IN CONDUIT, NO. 62.5/125, MM12F SM12F	
MASTER MASTER CONTROLLER		EXISTING INTERCONNECT CABLE - NO. 62.5/125 12F FIBER OPTIC CABLE	
EXISTING INTERSECTION & SAMPLING (SYSTEM) DETECTORS		PROPOSED INTERCONNECT CABLE - NO. 62.5/125 12F FIBER OPTIC CABLE	
PROPOSED INTERSECTION & SAMPLING (SYSTEM) DETECTORS		EXISTING INTERCONNECT CABLE - NO. 18 3 PAIR TWISTED, SHIELDED	
EXISTING INTERSECTION LOOP DETECTORS		PROPOSED INTERCONNECT CABLE - NO. 18 3 PAIR TWISTED, SHIELDED	
PROPOSED SAMPLING (SYSTEM) DETECTORS		EXISTING LOOP DETECTOR CABLE 2/C TWISTED, SHIELDED	
EXISTING SAMPLING (SYSTEM) DETECTORS		PROPOSED LOOP DETECTOR CABLE 2/C TWISTED, SHIELDED	
EXISTING INTERSECTION AND SAMPLING (SYSTEM) DETECTORS.		EXISTING ELECTRIC CABLE, 1/C (AS SPECIFIED)	
EXISTING SAMPLING (SYSTEM) DETECTORS, PROPOSED SAMPLING (SYSTEM) DETECTORS.		PROPOSED ELECTRIC CABLE, 1/C (AS SPECIFIED)	
EXISTING PREFORMED INTERSECTION & SAMPLING (SYSTEM) DETECTORS		EXISTING TELEPHONE CONNECTION	
PROPOSED PREFORMED INTERSECTION & SAMPLING (SYSTEM) DETECTORS		PROPOSED TELEPHONE CONNECTION	

SCHEDULE OF QUANTITIES

ITEM	UNIT	QUANTITY
CONDUIT IN TRENCH, 2" DIA., GALVANIZED STEEL	FOOT	2365
CONDUIT PUSHED, 2" DIA. GALVANIZED STEEL	FOOT	795
HANDHOLE	EACH	6
ELECTRIC CABLE IN CONDUIT, TRACER NO. 14 1C	FOOT	4024
FIBER OPTIC CABLE IN CONDUIT, NO. 62.5/125 MM12F & SM12F	FOOT	4076
TRENCH AND BACKFILL FOR ELECTRICAL WORK	FOOT	2365
DRILL EXISTING HANDHOLE	EACH	4

REVISIONS	
NAME	DATE

Illinois Department of Transportation
DISTRICT 1
INTERCONNECT SCHEMATIC
U.S. RTE. 12-20-45 (LAGRANGE ROAD)
(111th STREET TO 87th STREET)
95TH ST, U.S. 45 TO 88TH AVE.
SCALE: NONE
DATE: 12/6/05
DRAWN BY: PRT
DESIGNED BY: RC
CHECKED BY: JVV

10:45:44 03/10/2006