

F.A.P. RTE.	SECTION	COUNTY	TOTAL SHEETS	SHEET NO.
351	3277R	COOK	66	11
STA. 2+750		TO STA. 2+900		
FED. ROAD DIST. NO.	ILLINOIS	FED. AID PROJECT		

CONTRACT NO. 62206

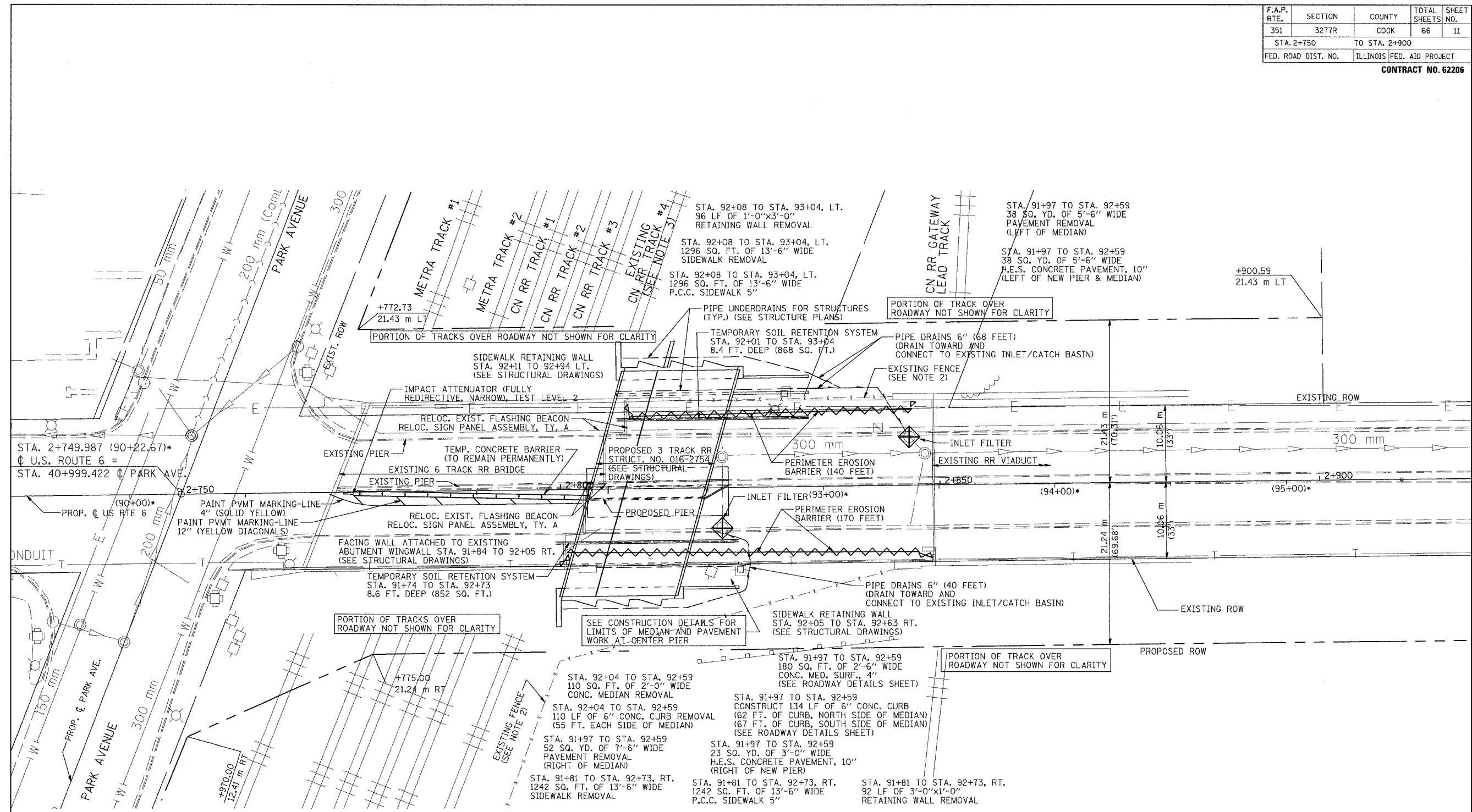

- NOTES: 1. * ENGLISH STATIONING ON ϕ U.S. 6 SHOWN IN PARENTHESES.
2. SEE RAILROAD TRACK PLAN FOR FENCE REMOVAL, PROPOSED FENCING, AND EROSION CONTROL FENCE.
3. SEE TRACK CONSTRUCTION PLANS FOR PROPOSED RE-ALIGNMENT OF CN RR TRACK 4.

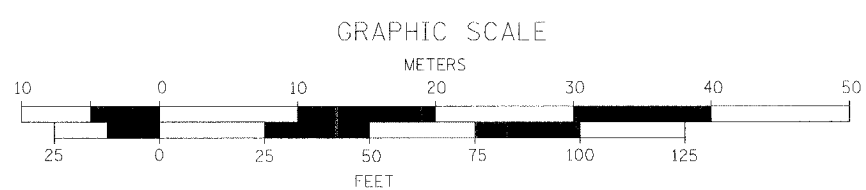

REVISIONS	
NAME	DATE

ILLINOIS DEPARTMENT OF TRANSPORTATION
US RTE 6 FROM I-294 TO IL RTE 1
PLAN AND DRAINAGE
STA. 2+750 TO STA. 2+900

DRAWN BY MAD
CHECKED BY JRP

DATE 03/27/06