

F.A.P. RTE.	SECTION	COUNTY	TOTAL SHEETS	SHEET NO.
351	3277R	COOK	66	15
STA.	TO STA.			
	ILLINOIS		FED. AID PROJECT	
CONTRACT NO. 62206				

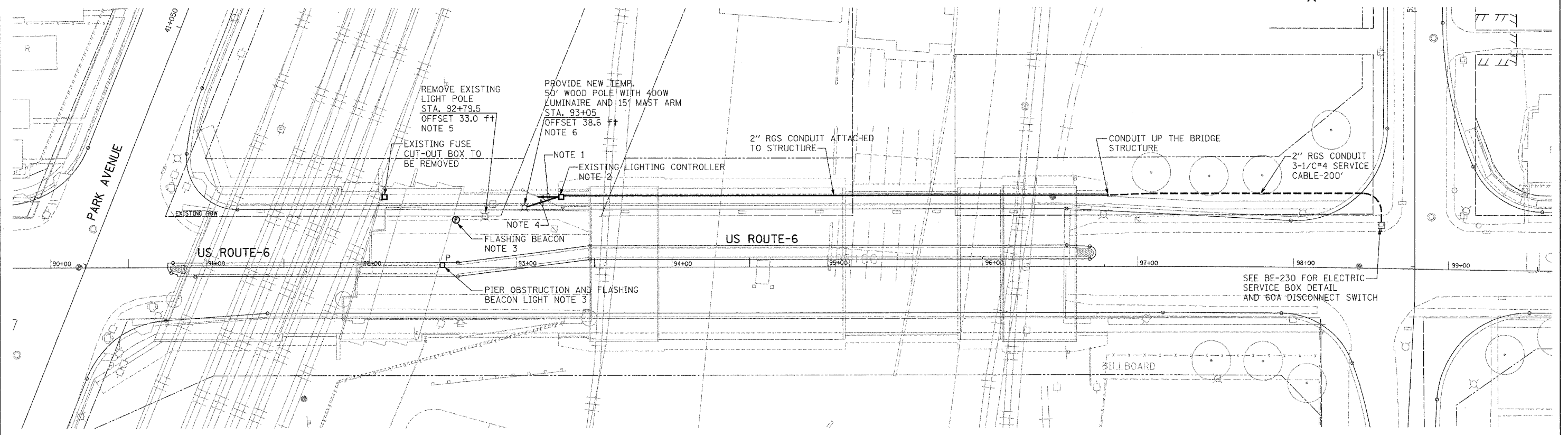

TEMPORARY LIGHTING AND NEW ComEd SERVICE PLAN

SCALE: 1"=30'-0"

NOTES:

1. REMOVE 114 L.F. OF EXISTING OVERHEAD AERIAL CABLE BETWEEN THE BRIDGES APPROX. 10 L.F. OF CONDUIT ATTACHED TO THE STRUCTURE TO THE CONTROLLER ON THE WEST BRIDGE AND THE CABLE IN CONDUIT. THESE WILL BE PAID FOR UNDER "PROTECTION AND MAINTENANCE OF EXISTING UNDERPASS LUMINAIRES".
2. EXISTING LIGHTING CONTROLLER IN SERVICE WITH THE NEW ComEd SERVICE AS SHOWN.
3. REMOVE PIER OBSTRUCTION LIGHT AND POWER SOURCE FOR THIS DEVICE. THIS WILL BE PAID FOR UNDER "PROTECTION AND MAINTENANCE OF EXISTING UNDERPASS LUMINAIRES".
4. INSTALL NEW TEMPORARY AERIAL CABLE (3-1/C#4 WITH MESSENGER WIRE) TO FEED THE TEMPORARY LIGHT POLE.
5. CONTRACTOR TO REMOVE EXISTING LIGHT POLE AND ENSURE THE EXISTING CIRCUIT CONTINUITY IS MAINTAINED AFTER THE POLE REMOVAL. ALSO SEE NOTE 3 ON DRAWING E-1. THIS WILL BE PAID FOR UNDER "REMOVAL OF EXISTING LIGHTING UNIT, SALVAGE".
6. TEMPORARY WOOD LIGHT POLE BEHIND THE EXISTING FENCE. CONTRACTOR TO INSTALL ON THE POLE A 400W HIGH PRESSURE SODIUM LUMINAIRE ON A 15'-0" MAST ARM.
7. RELOCATE THE FLASHING BEACON AND REMOVE AND REINSTALL POWER SOURCE. THIS WORK SHALL BE PAID FOR UNDER "RELOCATE EXISTING FLASHING BEACON."

DRAWING No. E-2

REVISIONS	
NAME	DATE

ILLINOIS DEPARTMENT OF TRANSPORTATION
US RTE 6 FROM I-294 TO IL RTE 1
**TEMPORARY LIGHTING AND
NEW ComEd SERVICE PLAN**

DELTA ENGINEERING, INC.
CONSULTING ENGINEERS, CHICAGO, ILLINOIS.

SCALE: 1" = 30'-0"
DATE: 03/27/06

DRAWN BY: KK/IHS
CHECKED BY: CK