

**CONT. TRAFFIC CONTROL
GENERAL NOTES**

- 10. THE CONTRACTOR MUST HAVE EQUIPMENT AVAILABLE TO RELOCATE THE TEMPORARY BARRIER WALL TO PROVIDE EMERGENCY ACCESS AS NEEDED. THIS WORK WILL NOT BE MEASURED FOR PAYMENT BUT IS INCLUDED IN THE CONTRACT UNIT PRICE FOR 'TRAFFIC CONTROL AND PROTECTION (EXPRESSWAY).'
- 11. AT LOCATIONS WHERE WORKZONE IS 3 FEET OR LESS FROM THE FACE OF THE TEMPORARY CONCRETE BARRIER OR THE TRAFFIC LANE IS A FOOT (1') OR LESS, THE BARRIER MUST BE ANCHORED TO THE PAVEMENT. ANCHORING OF THE TEMPORARY CONCRETE BARRIER WILL NOT BE MEASURED FOR PAYMENT BUT IS INCLUDED IN THE CONTRACT UNIT PRICE FOR TEMPORARY CONCRETE BARRIER AND RELOCATE TEMPORARY CONCRETE BARRIER.

CONT. TRAFFIC CONTROL-GENERAL NOTES

- 12. ADVANCE SIGNING PER IDOT DISTRICT 1 DETAIL TC-22 AND/OR CHANGABLE MESSAGE SIGNS MUST BE USED IN ADVANCE OF ROAD WORK IN BOTH DIRECTIONS EASTBOUND AND WESTBOUND DIRECTIONS. THE SIGNS SHOULD BE IN LOCATIONS AS SHOWN IN MAINTENANCE OF TRAFFIC PLANS AND SCHEDULE, OR AS DIRECTED BY THE ENGINEER. THESE SIGNS WILL BE PAID FOR AT THE CONTRACT UNIT PRICE FOR CHANGABLE MESSAGE SIGN. THE CONTRACTOR IS RESPONSIBLE FOR COORDINATING THE PLACEMENT AND MESSAGES FOR ALL PORTABLE CHANGABLE MESSAGE SIGNS WITH CONTRACTS 62301 AND 62303.
- 13. MAINTENANCE OF TRAFFIC NEEDED FOR CITY STREETS UNDER THE BRIDGES WHERE WORK IS BEING DONE SHOULD BE COORDINATED WITH IDOT, CITY OF CHICAGO AND RESIDENT ENGINEER. ALL MAINTENANCE OF TRAFFIC NEEDED MUST BE IN ACCORDANCE WITH APPLICABLE IDOT HIGHWAY STANDARDS. IT WILL BE PAID AS 'TRAFFIC CONTROL AND PROTECTION FOR SURFACE STREET', FOR MORE INFORMATION SEE SPECIAL PROVISIONS.
- 14. ALL EXISTING DRAINAGE STRUCTURE LIDS AND GRATES SHALL BE SECURED TO THE SATISFACTION OF THE ENGINEER AT LOCATIONS WHERE TRAFFIC IS LOCATED ON THE SHOULDERS. SECURING OF THE LIDS AND GRATES WILL NOT BE PAID FOR SEPARATELY AND IS INCLUDED IN THE CONTRACT UNIT PRICE FOR 'TRAFFIC CONTROL AND PROTECTION (EXPRESSWAYS)' TO THE SATISFACTION OF THE ENGINEER.

BOWMAN, BARRETT & ASSOCIATES INC.
CONSULTING ENGINEERS
Chicago, Illinois
312.228.0100
www.bbainc.com

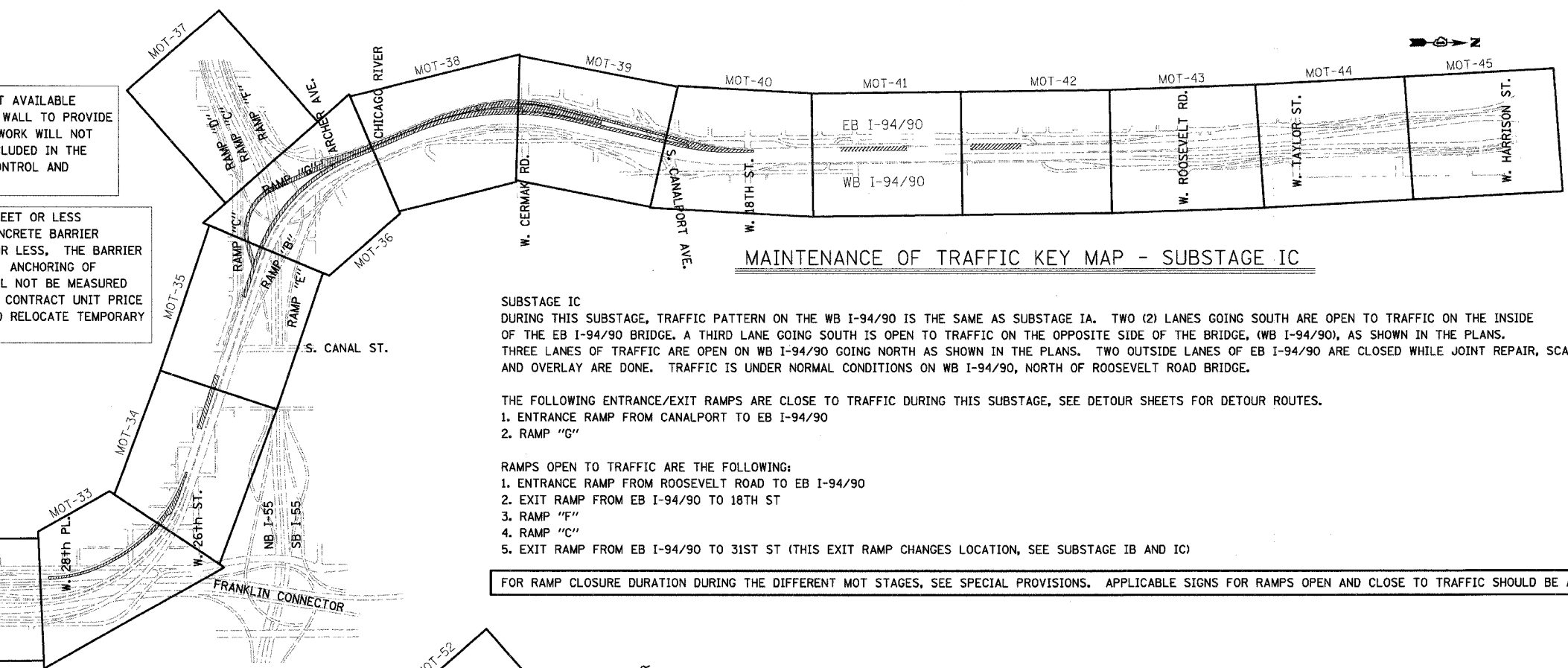

MAINTENANCE OF TRAFFIC KEY MAP - SUBSTAGE IC

SUBSTAGE IC
DURING THIS SUBSTAGE, TRAFFIC PATTERN ON THE WB I-94/90 IS THE SAME AS SUBSTAGE IA. TWO (2) LANES GOING SOUTH ARE OPEN TO TRAFFIC ON THE INSIDE OF THE EB I-94/90 BRIDGE. A THIRD LANE GOING SOUTH IS OPEN TO TRAFFIC ON THE OPPOSITE SIDE OF THE BRIDGE, (WB I-94/90), AS SHOWN IN THE PLANS. THREE LANES OF TRAFFIC ARE OPEN ON WB I-94/90 GOING NORTH AS SHOWN IN THE PLANS. TWO OUTSIDE LANES OF EB I-94/90 ARE CLOSED WHILE JOINT REPAIR, SCARIFICATION AND OVERLAY ARE DONE. TRAFFIC IS UNDER NORMAL CONDITIONS ON WB I-94/90, NORTH OF ROOSEVELT ROAD BRIDGE.

THE FOLLOWING ENTRANCE/EXIT RAMP ARE CLOSE TO TRAFFIC DURING THIS SUBSTAGE, SEE DETOUR SHEETS FOR DETOUR ROUTES.

1. ENTRANCE RAMP FROM CANALPORT TO EB I-94/90
2. RAMP "C"

RAMPS OPEN TO TRAFFIC ARE THE FOLLOWING:

1. ENTRANCE RAMP FROM ROOSEVELT ROAD TO EB I-94/90
2. EXIT RAMP FROM EB I-94/90 TO 18TH ST
3. RAMP "F"
4. RAMP "C"
5. EXIT RAMP FROM EB I-94/90 TO 31ST ST (THIS EXIT RAMP CHANGES LOCATION, SEE SUBSTAGE IB AND IC)

FOR RAMP CLOSURE DURATION DURING THE DIFFERENT MOT STAGES, SEE SPECIAL PROVISIONS. APPLICABLE SIGNS FOR RAMPS OPEN AND CLOSE TO TRAFFIC SHOULD BE ADJUSTED AS NEEDED.

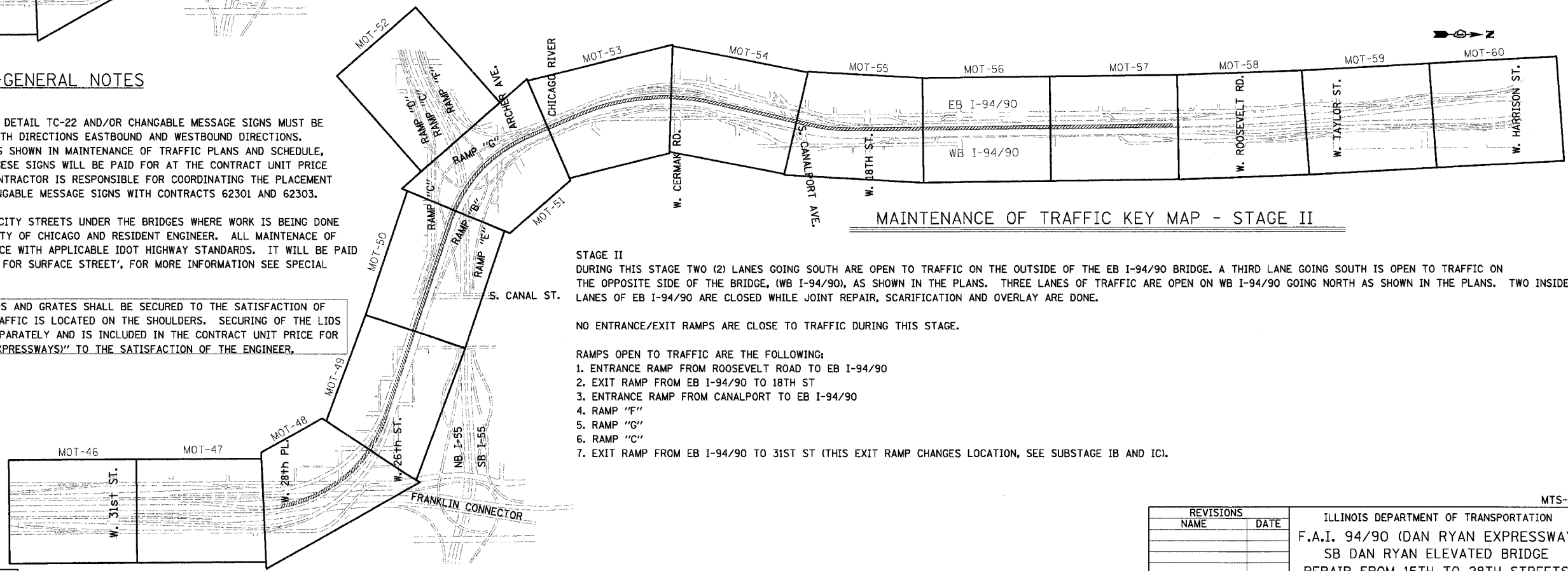

MAINTENANCE OF TRAFFIC KEY MAP - STAGE II

STAGE II
DURING THIS STAGE TWO (2) LANES GOING SOUTH ARE OPEN TO TRAFFIC ON THE OUTSIDE OF THE EB I-94/90 BRIDGE. A THIRD LANE GOING SOUTH IS OPEN TO TRAFFIC ON THE OPPOSITE SIDE OF THE BRIDGE, (WB I-94/90), AS SHOWN IN THE PLANS. THREE LANES OF TRAFFIC ARE OPEN ON WB I-94/90 GOING NORTH AS SHOWN IN THE PLANS. TWO INSIDE LANES OF EB I-94/90 ARE CLOSED WHILE JOINT REPAIR, SCARIFICATION AND OVERLAY ARE DONE.

NO ENTRANCE/EXIT RAMP ARE CLOSE TO TRAFFIC DURING THIS STAGE.

RAMPS OPEN TO TRAFFIC ARE THE FOLLOWING:

1. ENTRANCE RAMP FROM ROOSEVELT ROAD TO EB I-94/90
2. EXIT RAMP FROM EB I-94/90 TO 18TH ST
3. ENTRANCE RAMP FROM CANALPORT TO EB I-94/90
4. RAMP "F"
5. RAMP "G"
6. RAMP "C"
7. EXIT RAMP FROM EB I-94/90 TO 31ST ST (THIS EXIT RAMP CHANGES LOCATION, SEE SUBSTAGE IB AND IC).

REVISIONS	
NAME	DATE

ILLINOIS DEPARTMENT OF TRANSPORTATION
F.A.I. 94/90 (DAN RYAN EXPRESSWAY)
SB DAN RYAN ELEVATED BRIDGE
REPAIR FROM 15TH TO 28TH STREETS
MAINTENANCE OF TRAFFIC PLAN
GENERAL NOTES AND TYPICAL SECTIONS
SCALE: NTS
DATE: 4/14/2006
DRAWN BY: RA
CHECKED BY: RS

F.A.I.	SECTION	COUNTY	TOTAL SHEETS	SHEET NO.
94/90	2003-029B-2	COOK	344	27
STA.	TO STA.			
FED. ROAD DIST. NO.	ILLINOIS	FED. AID PROJECT	62581	

MTS-02
4/14/2006 9:20:43 AM