

F.A.I.	SECTION	COUNTY	TOTAL SHEETS	SHEET NO.
94/90	2003-029	COOK	344	35
STA.	TO STA.			
FED. ROAD DIST. NO.	ILLINOIS	FED. AID PROJECT		
62581				

NOTE:  
 EB I-94/90 TEMPORARY INFORMATION SIGNING, PANEL COVERING AND PANEL REPLACING TO BE REMOVED AT END OF SUBSTAGE IC, UNLESS OTHERWISE SPECIFIED  
 EB I-94/90 TEMPORARY PAVEMENT MARKINGS INSTALLED IN SUBSTAGE IA TO REMAIN TO THE END OF SUBSTAGE IC, UNLESS OTHERWISE SPECIFIED  
 5A. THIS CONTRACT IS RESPONSIBLE FOR THE REMOVAL OF EXISTING PANELS FOR SIGN ES05-02. CONTRACT 62303 IS RESPONSIBLE FOR THE PERMANENT SIGNING. BOTH CONTRACTS NEED TO COORDINATE  
 5B. IMPORTANT TO COORDINATE NEXT EXIT STREET NAME WITH CONTRACT 62303 THIS CONTRACT 62581 IS RESPONSIBLE FOR THE TEMPORARY SIGNING  
 5C. FOR SIGNS TS05-01 AND TS05-02, ALIGN ABOVE OPEN LANES

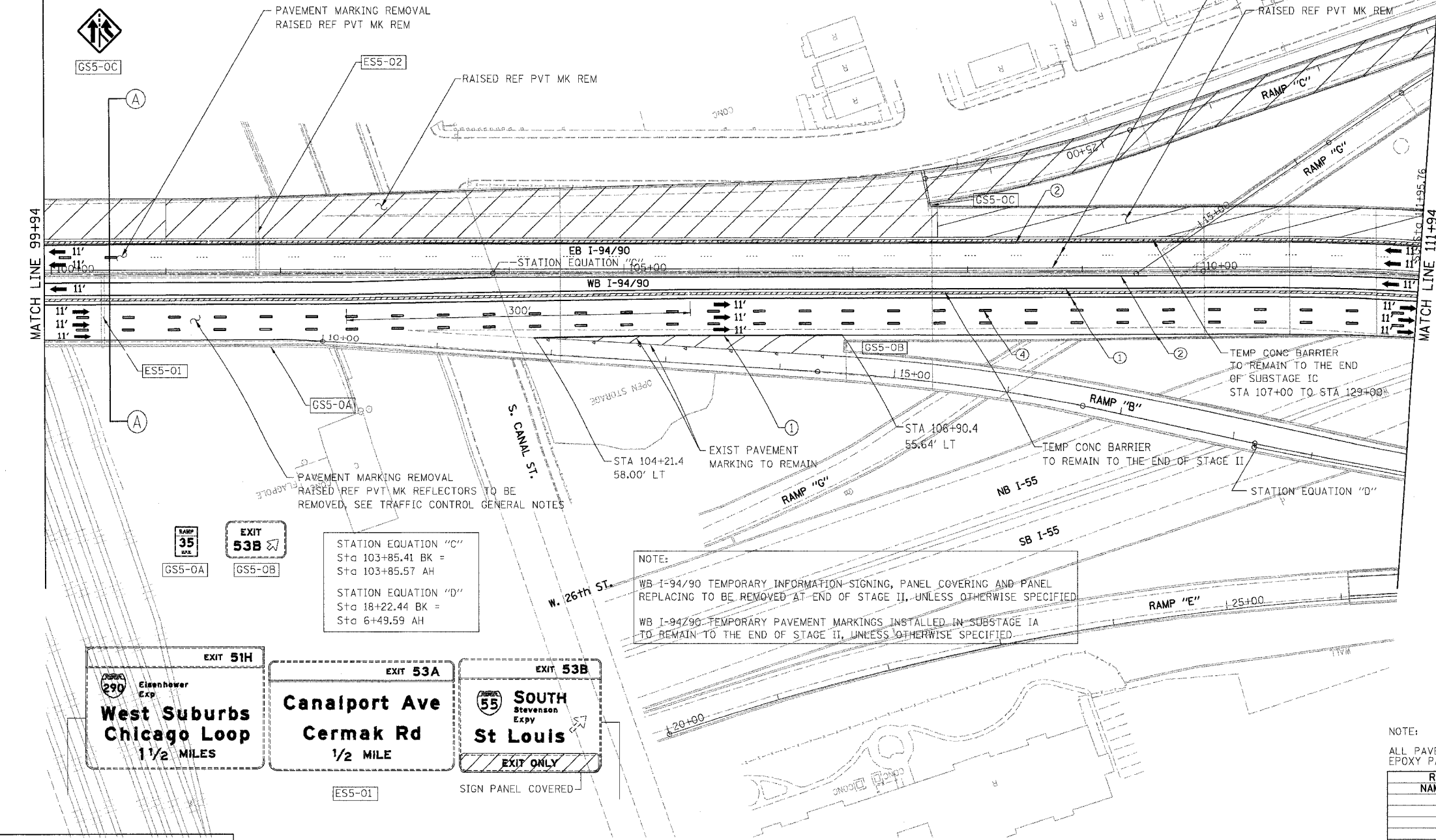
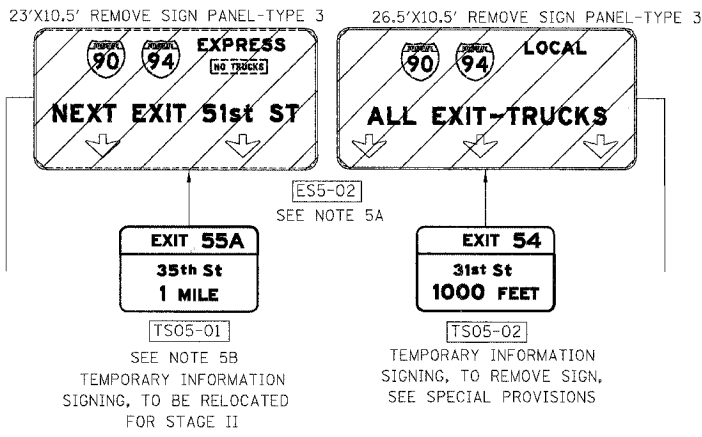

- LEGEND**
- WORK ZONE
  - DIRECTION OF TRAFFIC
  - DRUM OR BARRICADE TYPE II WITH STEADY BURN LIGHT
  - IMPACT ATTENUATORS, TEMPORARY (NON-REDIRECTIVE), TEST LEVEL 3
  - BARRICADE TYPE III
  - TEMPORARY CONCRETE BARRIER
  - ① LINE 4" (YELLOW EDGE LINE)
  - ② LINE 4" (WHITE EDGE LINE)
  - ③ LINE 4" (SKIP DASH, 6' SKIP - 2' DASH, WHITE)
  - ④ LINE 5" (SKIP DASH, 30' SKIP - 10' DASH, WHITE)
  - ⑤ LINE 8" (WHITE LINE)
  - ⑥ LINE 8" (SKIP DASH, 12' SKIP - 3' DASH, WHITE)
  - ⑦ LINE 12" (DIAGONAL, 30' C-C)
  - ⑧ LINE 12" (DIAGONAL, 500' C-C)
  - ⑨ LETTERS AND SYMBOLS
  - ESx-xx EXISTING OVERHEAD OR CANTILEVER SIGNS
  - GSx-xx EXISTING POST MOUNTED SIGNS
  - TSx-xx TEMPORARY SIGNS

NOTE:  
 WB I-94/90 TEMPORARY INFORMATION SIGNING, PANEL COVERING AND PANEL REPLACING TO BE REMOVED AT END OF STAGE II, UNLESS OTHERWISE SPECIFIED  
 WB I-94/90 TEMPORARY PAVEMENT MARKINGS INSTALLED IN SUBSTAGE IA TO REMAIN TO THE END OF STAGE II, UNLESS OTHERWISE SPECIFIED

STATION EQUATION "C"  
 Sta 103+85.41 BK =  
 Sta 103+85.57 AH  
 STATION EQUATION "D"  
 Sta 18+22.44 BK =  
 Sta 6+49.59 AH

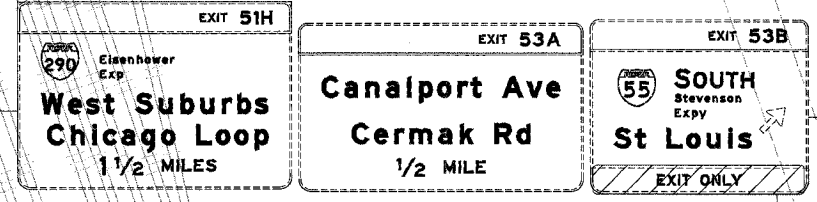

NOTE:  
 ALL PAVEMENT MARKINGS ON THIS SHEET WILL BE EPOXY PAVEMENT MARKING, UNLESS OTHERWISE NOTED.

REVISIONS	NAME	DATE

ILLINOIS DEPARTMENT OF TRANSPORTATION  
 F.A.I. 94/90 (DAN RYAN EXPRESSWAY)  
 SB DAN RYAN ELEVATED BRIDGE  
 REPAIR FROM 15TH TO 28TH STREETS  
 MAINTENANCE OF TRAFFIC PLAN - SUBSTAGE IA  
 STA. 99+94 TO STA. 111+94

SCALE: 1"=50'  
 DATE: 4/14/2006

MOT-05  
 DRAWN BY: RA  
 CHECKED BY: RS

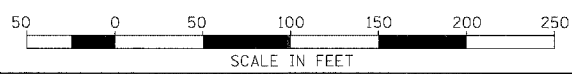

BOWMAN, BARRETT & ASSOCIATES INC  
 CONSULTING ENGINEERS  
 Chicago, Illinois  
 312.228.0100  
 www.bbainc.com