

F.A.I.	SECTION	COUNTY	TOTAL SHEETS	SHEET NO.
94/90	2003-0291	COOK	344	48
STA.	TO STA.			
62581				
FED. ROAD DIST. NO.	ILLINOIS	FED. AID PROJECT		

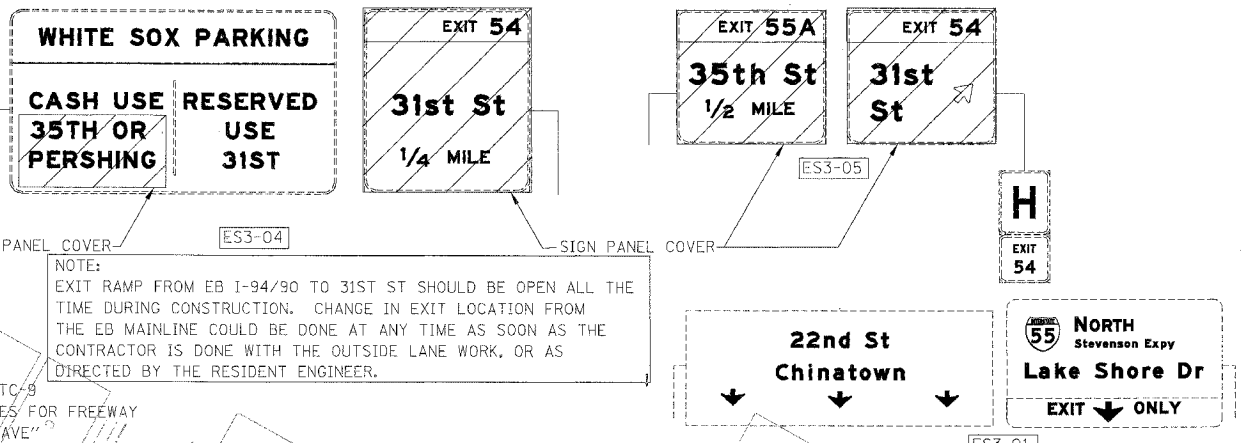

NOTE:
EXIT RAMP FROM EB I-94/90 TO 31ST ST SHOULD BE OPEN ALL THE TIME DURING CONSTRUCTION. CHANGE IN EXIT LOCATION FROM THE EB MAINLINE COULD BE DONE AT ANY TIME AS SOON AS THE CONTRACTOR IS DONE WITH THE OUTSIDE LANE WORK, OR AS DIRECTED BY THE RESIDENT ENGINEER.

USE IDOT DISTRICT STD TC-9 "TRAFFIC CONTROL DEVICES FOR FREEWAY SINGLE & MULTI-LANE WEAVE" FROM SUBSTAGE 1A

- LEGEND**
- WORK ZONE
 - DIRECTION OF TRAFFIC
 - DRUM OR BARRICADE TYPE II WITH STEADY BURN LIGHT
 - IMPACT ATTENUATORS, TEMPORARY (NON-REDIRECTIVE), TEST LEVEL 3
 - BARRICADE TYPE III
 - TEMPORARY CONCRETE BARRIER
 - ① LINE 4" (YELLOW EDGE LINE)
 - ② LINE 4" (WHITE EDGE LINE)
 - ③ LINE 4" (SKIP DASH, 6' SKIP - 2' DASH, WHITE)
 - ④ LINE 5" (SKIP DASH, 30' SKIP - 10' DASH, WHITE)
 - ⑤ LINE 8" (WHITE LINE)
 - ⑥ LINE 8" (SKIP DASH, 12' SKIP - 3' DASH, WHITE)
 - ⑦ LINE 12" (DIAGONAL, 30' C-C)
 - ⑧ LINE 12" (DIAGONAL, 500' C-C)
 - ⑨ LETTERS AND SYMBOLS
 - ESx-xx EXISTING OVERHEAD OR CANTILEVER SIGNS
 - GSx-xx EXISTING POST MOUNTED SIGNS
 - TSx-xx TEMPORARY SIGNS

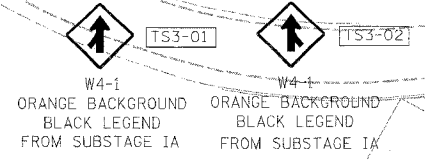
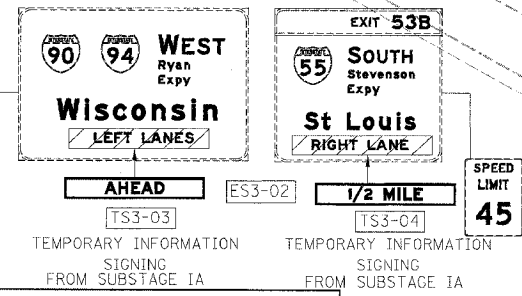
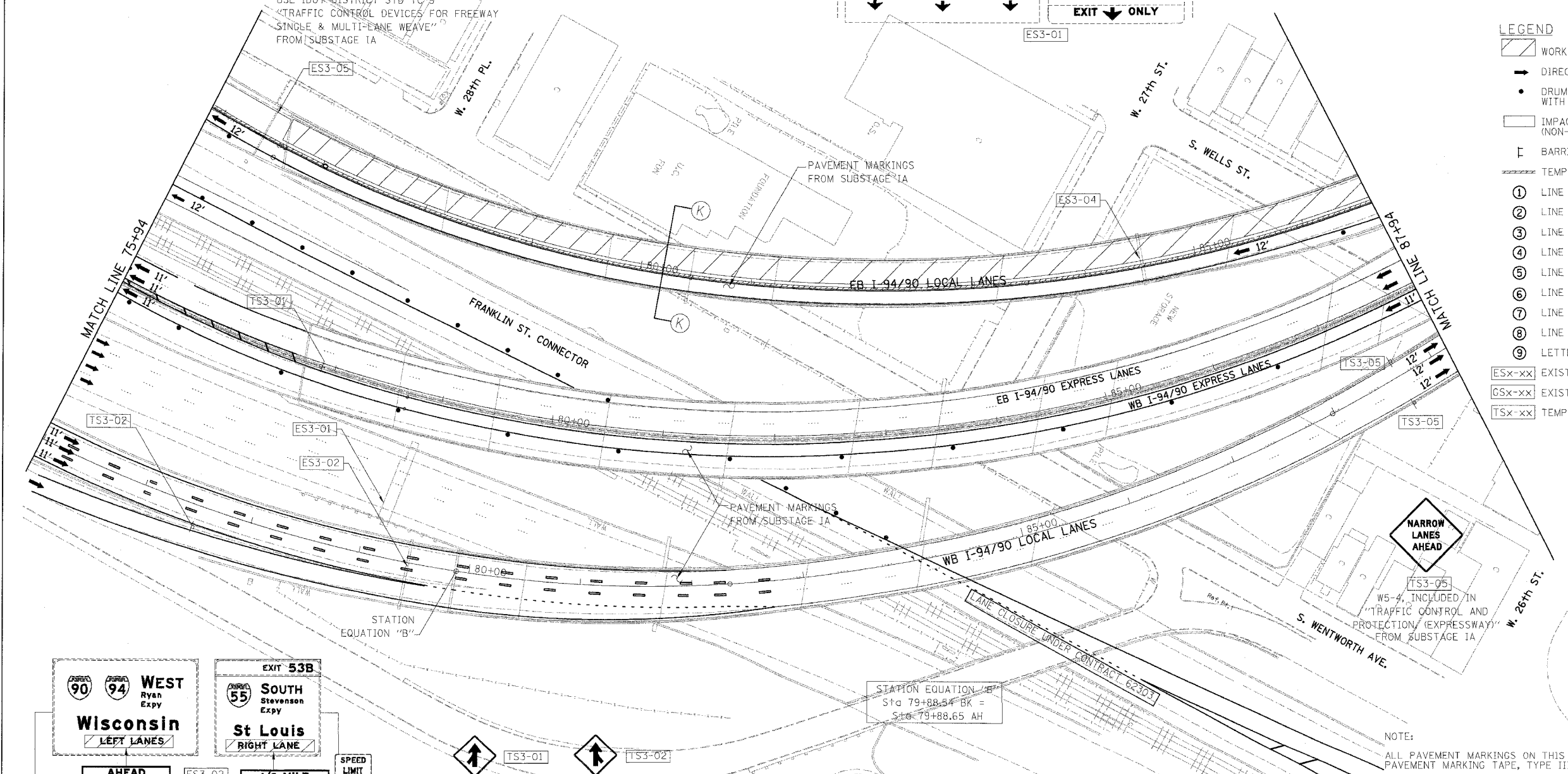

STATION EQUATION:
Sta 79+88.54 BK =
Sta 79+88.65 AH

NOTE:
ALL PAVEMENT MARKINGS ON THIS SHEET WILL BE PAVEMENT MARKING TAPE, TYPE III, UNLESS OTHERWISE NOTED. MOT-18

REVISIONS	
NAME	DATE

ILLINOIS DEPARTMENT OF TRANSPORTATION
F.A.I. 94/90 (DAN RYAN EXPRESSWAY)
SB DAN RYAN ELEVATED BRIDGE
REPAIR FROM 15TH TO 28TH STREETS
MAINTENANCE OF TRAFFIC PLAN - SUBSTAGE 1B
STA. 75+94 TO STA. 87+94

SCALE: 1"=50'
DATE: 5/12/2006
DRAWN BY: RA
CHECKED BY: RS

BOWMAN, BARRETT & ASSOCIATES INC
CONSULTING ENGINEERS
Chicago, Illinois
312.228.0100
www.bbainc.com

