

ROUTE NO. FAU 3578	SECTION 1327 B	COUNTY COOK	SHEET 108	SHEET NO. 51	SHEET NO. 23 35 SHEETS
FED. ROAD DIST. NO. 7		S.D.N.G.S.		FED. AID PROJECT	

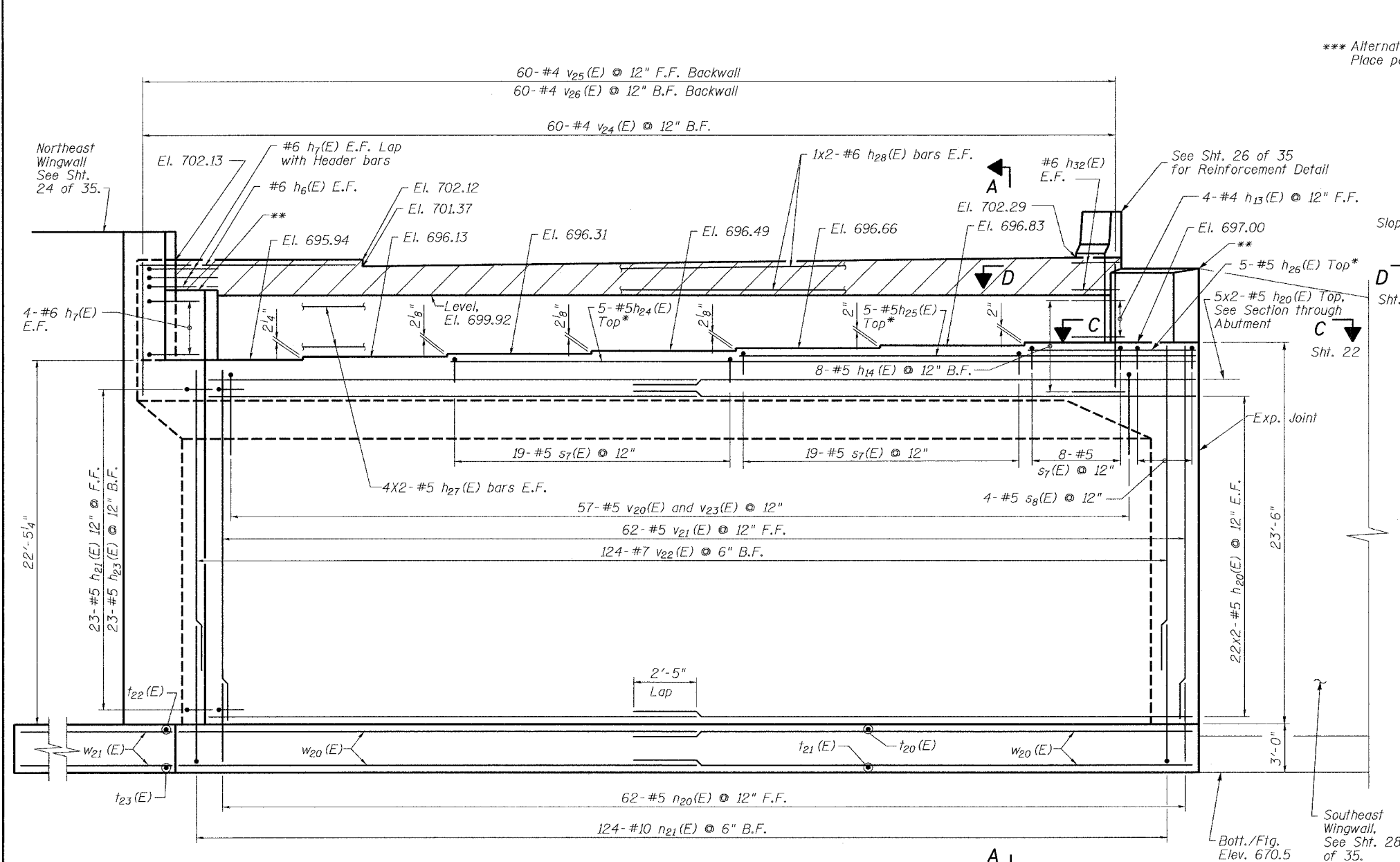

**ELEVATION**

\* Cut to fit skew as required.  
 \*\* Cheekwall poured after bridge deck pour.  
 T/wall 1" below bott. of bridge deck.  
 Slope top of wall to match bott. of bridge deck.

**Legend**  
 B.F. = Back Face  
 F.F. = Front Face  
 E.F. = Each Face

DESIGNED	SRT
CHECKED	JJI
DRAWN	MD
CHECKED	JJI

**B** Bollinger, Lach & Associates, Inc.

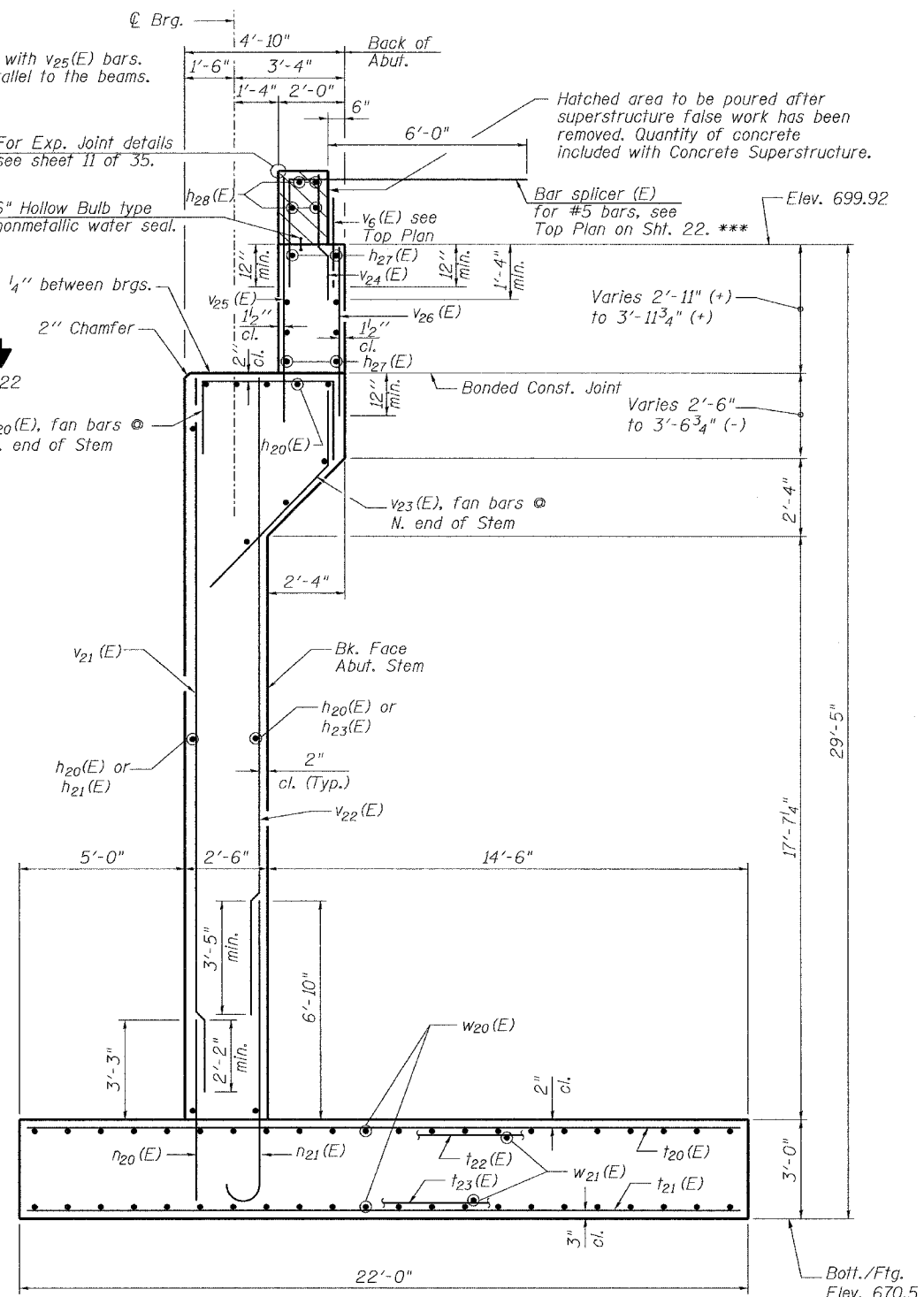

**SECTION A-A**

**Notes:**  
 Reinforcement bars designated (E) shall be epoxy coated.  
 All edges shall have standard 3/4" chamfer except as noted.  
 Space reinforcement in cap to miss anchor bolts.  
 Pour steps monolithically with cap.  
 Maximum Applied Soil Bearing Pressure = 5,540 psf.  
 See Sheet 26 of 35 for Pipe Underdrain Drain Detail and limits of PGE (Special).

**EAST ABUTMENT  
 ELEVATION & SECTION**  
 IL 7 (SOUTHWEST HIGHWAY) OVER  
 US 45 (LA GRANGE ROAD)  
 F.A.U. ROUTE 3578 SECTION 1327B  
 COOK COUNTY  
 STA. 1516+85.79  
 STRUCTURE NUMBER 016-2847