

STATE OF ILLINOIS
DEPARTMENT OF TRANSPORTATION

ROUTE NO.	SECTION	COUNTY	TOTAL SHEETS	THIS SHEET NO.	SHEET NO.
FAU 3578	1327B	COOK	108	64	22 SHEETS
FED. ROAD DIST. NO. 7		ILLINOIS	FED. AID PROJECT		

Bench Mark: Top of Brass Disk in West Curb of US Rte. 45 (La Grange Rd.) Approximately 675' North of the Centerline of IL Rte. 7 (Southwest Highway). Elev. 689.07.

Existing Structure: None

Staging: Construct stone columns that will be within the limits of excavation for the West Abutment prior to starting abutment construction. Coordinate MSE wall construction with roadway embankment construction.

Sta. 1515+78.21 Elev. 691.75
See Slip Joint Detail, Sheet 9

Proposed Northwest Wingwall, See Bridge Plans

Proposed U.S. Route 45 (La Grange Rd.)

Proposed Bridge S.N. 016-2847

30'-0" Bridge Appr. Pavement (Special)

Proposed Northwest Wingwall (Prop. S.N. 016-2847)

Begin Wall Sta. 1515+78.21 Lt. 22'-0"

Begin Wall Sta. 1515+78.21 Elev. 700.51

Turning Point

Sta. 1515+34.14 Elev. 700.06

Sta. 1515+00.00 Elev. 699.61

Sta. 1511+00.00 Elev. 691.82

Sta. 1513+00.00 Elev. 695.29

Sta. 1513+00.00 Elev. 687.00

Sta. 1515+00.00 Elev. 691.30

Sta. 1515+34.14 Elev. 693.14

B. of Ftg. El. 670.0

Existing @ U.S. Route 45 (La Grange Rd.)

Proposed Southwest Wingwall (Prop. S.N. 016-2847)

B-6.24 Curb & Gutter (Typ.)

Proposed Metra Parking Lot

Underground Electric

Existing 2'x3' Elliptical Pipe to be Removed & Replaced with 54" RCP

Sta. 1509+95.68 Begin Taper

New Storm Sewer (Typ.)

New Inlet (Typ.)

Approximate Limits of Reinforced Soil Mass

Existing & Proposed @ IL. Route 7

BR-1

BR-1A 44'-2 5/8"

Sta. 1515+34.14 Lt. 25'-7"

EXIST. ROW McGinnis Slough (No-Intrusion Area)

10'-0" Inside face of parapet to back of curb

Existing & Proposed @ IL. Route 7

Front Face MSE Wall Panels

994'-1 5/8"

Wetland Limits (Typ.)

6'-0" Sidewalk (Moment Slab)

Storm Sewer (By others)

End Wall Sta. 1505+40.00 Lt. 25'-7"

Underground Telephone Line to be relocated

ELEVATION (Front Face)

Drainage structure to be installed after stone column installation is complete. Provide additional Pipe Bedding under drainage structure. See Drainage Plans. (Typical for all drainage structures)

APPROVED FOR STRUCTURAL ADEQUACY ONLY

DATE SIGNED: 3-09-06
EXP. DATE: 11-30-06

Paul E. Anderson
ENGINEER OF BRIDGES AND STRUCTURES



- LEGEND:**
- - Indicates Soil Boring
 - ▨ - Reinforced soil mass
 - ▤ - MSE Wall Panels

DESIGNED	SRT
CHECKED	JJI
DRAWN	GM
CHECKED	JJI

Bollinger, Lach & Associates, Inc.

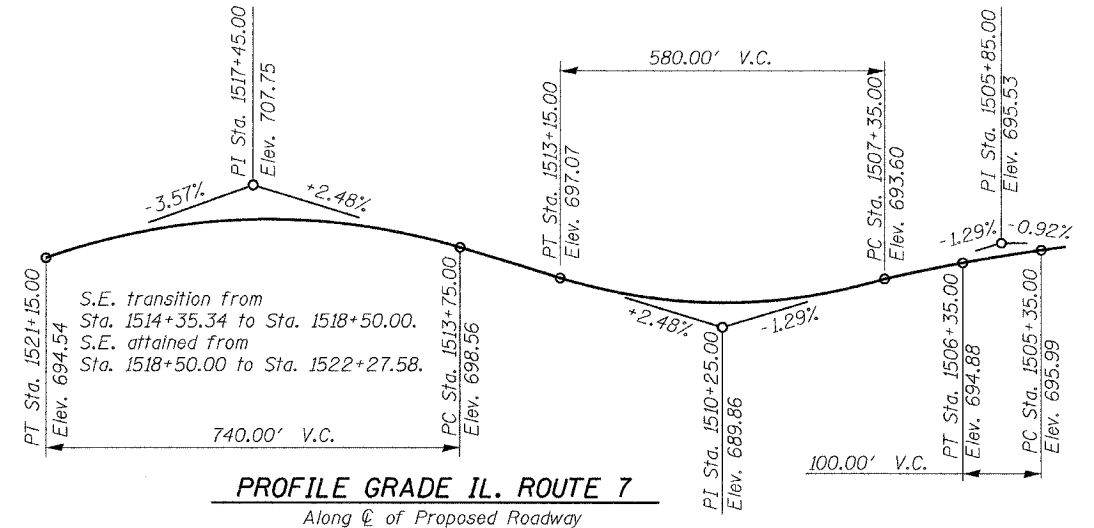

PLAN

DESIGN SPECIFICATIONS
AASHTO (2002)

DESIGN STRESSES

FIELD UNITS

f_c = 3,500 psi
f_y = 60,000 psi (Reinforcement)

PRECAST UNITS

f_c = 4,500 psi (Precast Face Panels)
Allowable Soil Bearing Pressure = 3.0 ksf.

MSE WALL LOADING

Equivalent Lateral Soil Pressure = 42 pcf (min.)
Live Load Surcharge = 2' height of soil

Note: Stations and O/S are given to the inside face of the parapet. Lengths are measured along the inside face of the parapet.

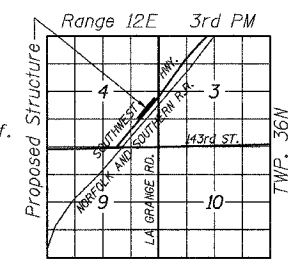

GENERAL PLAN & ELEVATION
NORTHWEST RETAINING WALL
IL. 7 (Southwest Highway)
F.A.U. ROUTE 3578 SECTION 1327B
COOK COUNTY
STA. 1505+40.00 to STA. 1515+78.21
STRUCTURE NUMBER 016-W970