

STATE OF ILLINOIS  
DEPARTMENT OF TRANSPORTATION

ROUTE NO.	SECTION	COUNTY	TOTAL SHEETS	SHEET NO.
FAU 3578	1327B	COOK	108	65
FED. ROAD DIST. NO. 7	ILLINOIS	FED. AID PROJECT		

SHEET NO. 2  
22 SHEETS

**GENERAL NOTES**

See Special Provisions for Mechanically Stabilized Earth Retaining Wall and Stone Columns for design and construction requirements.

Reinforcement bars shall conform to the requirements of AASTHO M31 or M322 Grade 60.

All construction joints shall be bonded.

Concrete surfaces exposed to view in the completed wall shall be given a normal finish according to Article 503.16.

Cost of Slip Joint included in the pay item "Mechanically Stabilized Earth Retaining Wall".

Spacing of stone columns located within the limits of the reinforced soil mass shall be adjusted to account for the width of the reinforced soil mass as designed by the Supplier and approved by the Engineer.

Drainage layer/working platform shall be installed after the installation of the stone columns is complete. Contractor shall keep the drainage layer/working platform free from contamination to maintain drainage.

Work on MSE Retaining Wall shall be done in conjunction with Northeast MSE wingwall. See Bridge Plans.

**TOTAL BILL OF MATERIAL**

ITEM	UNIT	TOTAL
Mechanically Stabilized Earth Retaining Wall	Sq. Ft.	12,750
Structure Excavation	Cu. Yd.	2787
Concrete Structures	Cu. Yd.	409.8
Reinforcement Bars, Epoxy Coated	Pound	50,350
Aluminum Railing, Type L	Foot	1037
Stone Columns 2'-6" Dia.	Foot	3861
Stone Columns 3'-0" Dia.	Foot	5033
Pipe Underdrains for Structures 4"	Foot	1035

**INDEX OF SHEETS**

SHEET NO.	DESCRIPTION
1	General Plan & Elevation
2	Index of Sheets, Typical Section, Total Bill of Material
3	MSE Wall Plan & Elevation Sta. 1515+78.21 to Sta. 1513+00.00
4	MSE Wall Plan & Elevation Sta. 1513+00.00 to Sta. 1510+00.00
5	MSE Wall Plan & Elevation Sta. 1510+00.00 to Sta. 1507+00.00
6	MSE Wall Plan & Elevation Sta. 1507+00.00 to Sta. 1505+40.00
7	Parapet & Sidewalk Plan & Elevation Sta. 1515+78.21 to Sta. 1510+00.00
8	Parapet & Sidewalk Plan & Elevation Sta. 1510+00.00 to Sta. 1505+40.00
9	Details
10	Type L Aluminum Railing
11	Soil Boring Logs R-1 & R-2
12	Soil Boring Logs R-2 & R-3
13	Soil Boring Logs R-4 & R-5
14	Soil Boring Logs R-5 & R-6
15	Soil Boring Logs R-7 & R-8
16	Soil Boring Logs R-8 & R-9
17	Soil Boring Logs R-10 & R-11
18	Soil Boring Logs R-11 & R-12
19	Soil Boring Logs R-13, R-14 & R-15
20	Soil Boring Logs R-16, R-17 & R-18
21	Soil Boring Logs R-19 & BR-1
22	Soil Boring Log ST-2

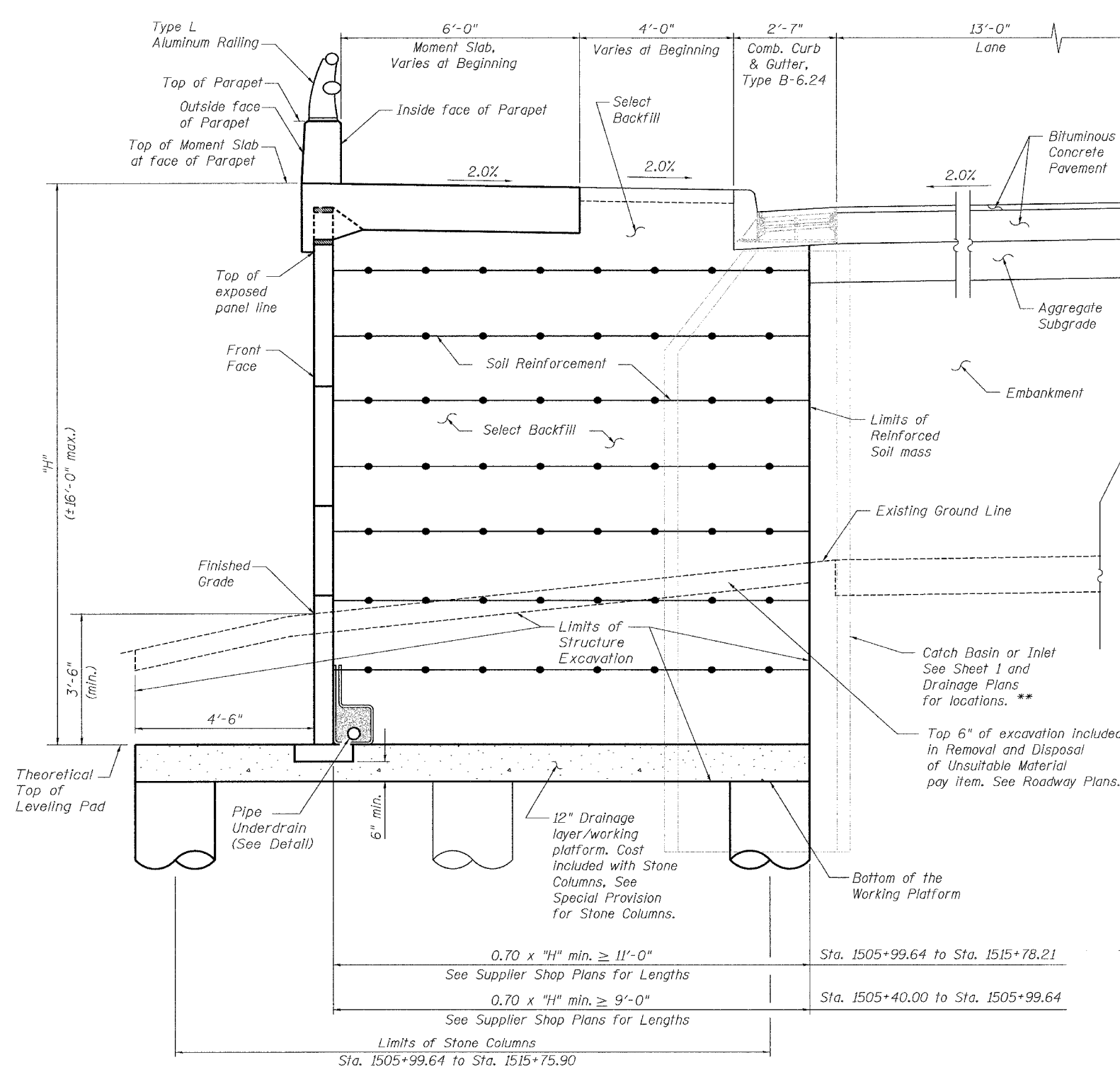

\*\* Where soil reinforcement layers must be partially or fully severed in the location of obstructions, the wall supplier shall design the surrounding reinforcement layers to carry the additional load which would have been carried by the severed reinforcements.

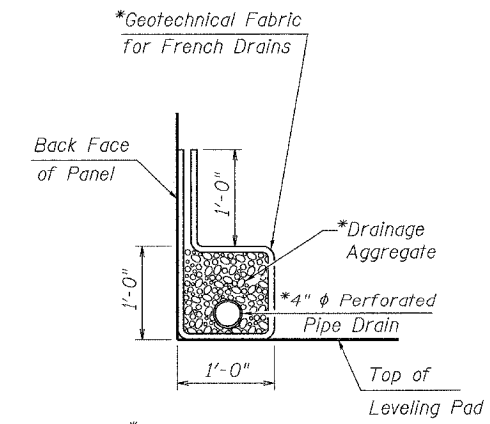

\*Included in the cost of "Pipe Underdrains for Structures, 4 in."

**PIPE UNDERDRAIN DETAIL**

**TYPICAL SECTION**  
(Looking Upstation)

DESIGNED	SRT
CHECKED	JJI
DRAWN	GM
CHECKED	JJI

**Bollinger, Lach & Associates, Inc.**

**INDEX OF SHEETS, TYPICAL SECTION & TOTAL BILL OF MATERIAL**  
**NORTHWEST RETAINING WALL**  
**IL. 7 (Southwest Highway)**  
**F.A.U. ROUTE 3578 SECTION 1327B**  
**COOK COUNTY**  
**STA. 1505+40.00 to STA. 1515+78.21**  
**STRUCTURE NUMBER 016-W970**