

F.A.P. RTE.	SECTION	COUNTY	TOTAL SHEETS	SHEET NO.
880	12 RS-9	LAKE	14	5
STA.		TO STA.		
FED. ROAD DIST. NO. 1		ILLINOIS	FED. AID PROJECT	
CONTRACT NO. 62922				

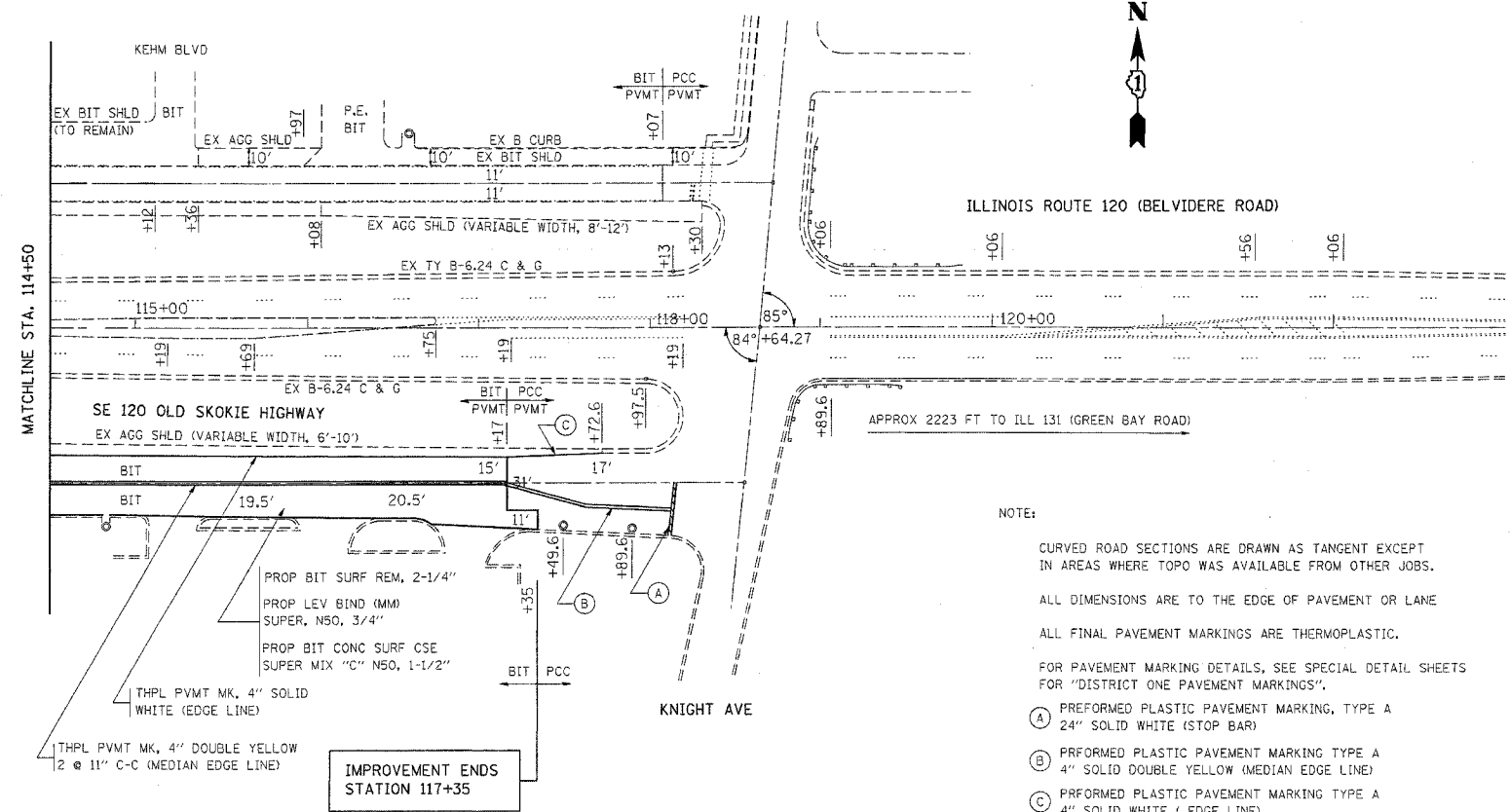

- NOTE:
- CURVED ROAD SECTIONS ARE DRAWN AS TANGENT EXCEPT IN AREAS WHERE TOPO WAS AVAILABLE FROM OTHER JOBS.
  - ALL DIMENSIONS ARE TO THE EDGE OF PAVEMENT OR LANE
  - ALL FINAL PAVEMENT MARKINGS ARE THERMOPLASTIC.
  - FOR PAVEMENT MARKING DETAILS, SEE SPECIAL DETAIL SHEETS FOR "DISTRICT ONE PAVEMENT MARKINGS".
  - (A) PREFORMED PLASTIC PAVEMENT MARKING, TYPE A 24" SOLID WHITE (STOP BAR)
  - (B) PREFORMED PLASTIC PAVEMENT MARKING TYPE A 4" SOLID DOUBLE YELLOW (MEDIAN EDGE LINE)
  - (C) PREFORMED PLASTIC PAVEMENT MARKING TYPE A 4" SOLID WHITE (EDGE LINE)

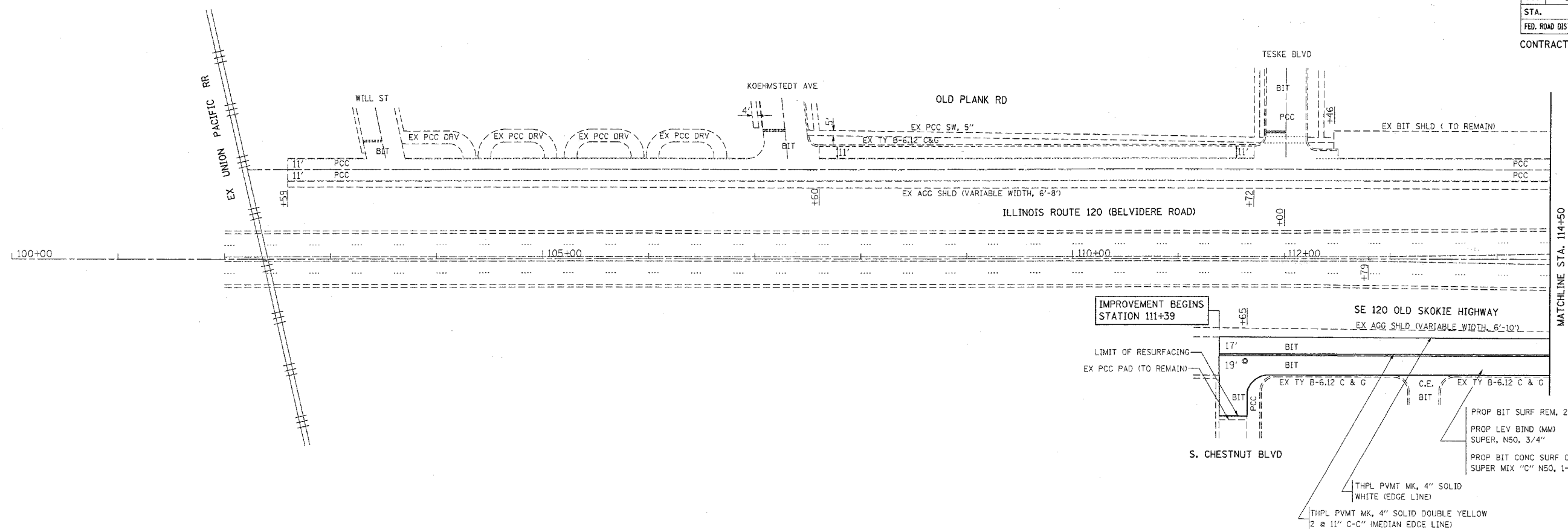
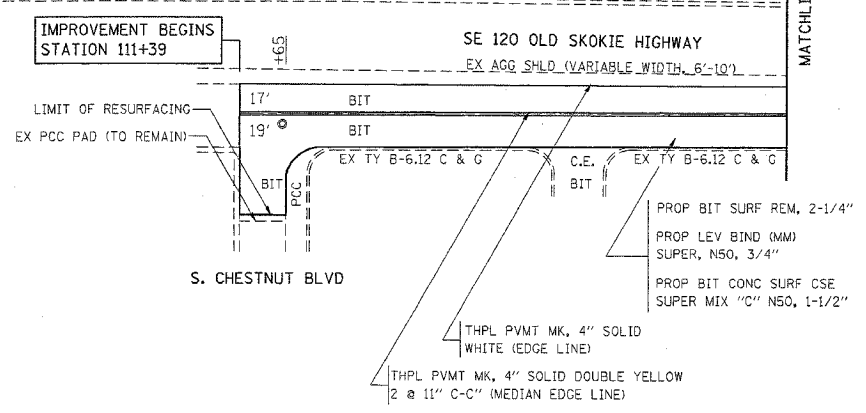

PLOT DATE = 4/2/2006  
 PLOT NAME = J:\02388A\02388A.dwg  
 PLOT SCALE = 5/8"=1'-0"  
 USER NAME = galbarb

REVISIONS	
NAME	DATE

ILLINOIS DEPARTMENT OF TRANSPORTATION  
**S.E. IL 120 OLD SKOKIE HIGHWAY  
 SOUTH CHESTNUT BLVD TO KNIGHT AVE**  
 EXISTING AND PROPOSED  
 ROADWAY AND PAVEMENT MARKING PLAN

SCALE: VERT. 1"=50'  
 HORIZ. DATE  
 DRAWN BY  
 CHECKED BY