

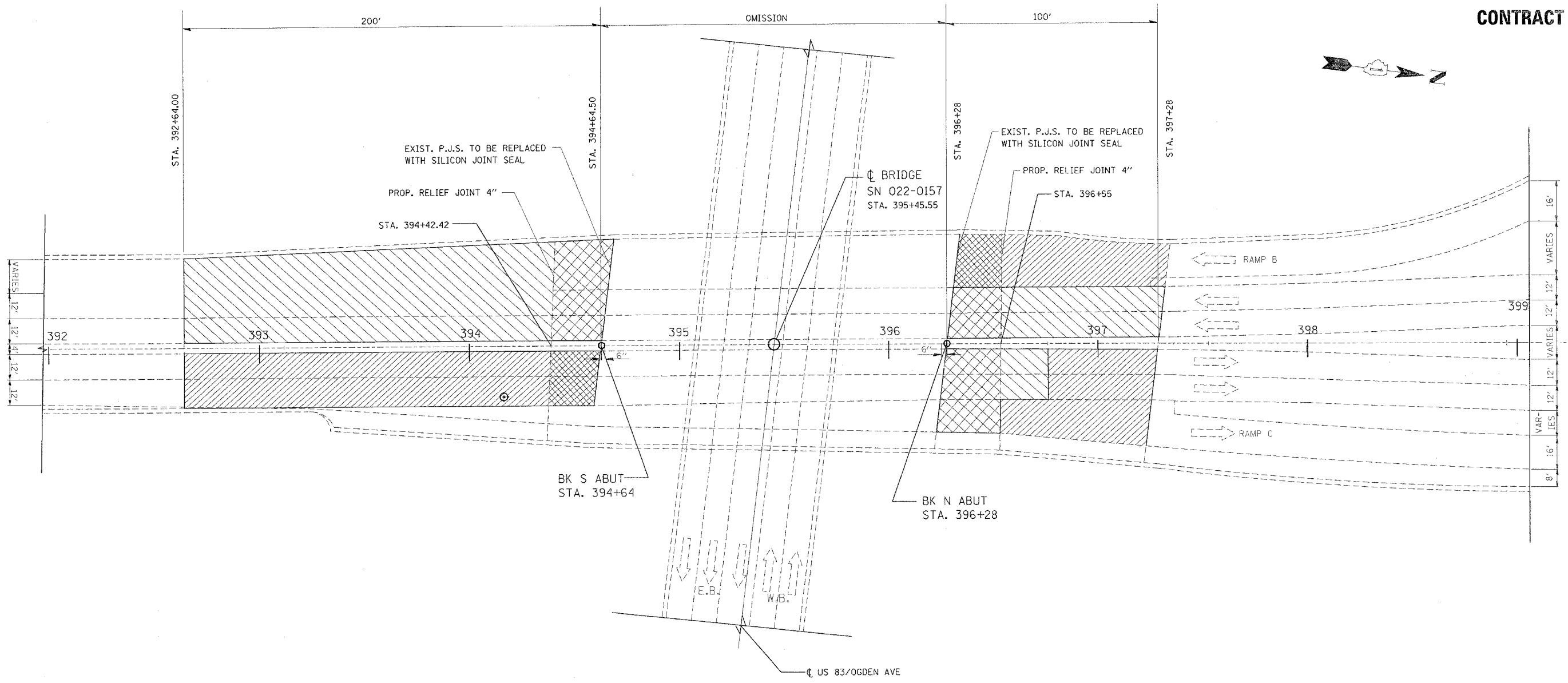

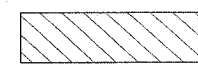

**CONTRACT NO. 62940**

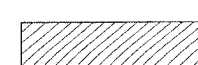

**LEGEND**

-  BITUMINOUS SURFACE REMOVAL 2-1/2"
-  BITUMINOUS SURFACE REMOVAL 1-3/4"
-  P.C.C. SURFACE REMOVAL 2-1/2"
-  P.C.C. SURFACE REMOVAL 1-3/4"

**PLAN**

NOTE: LOCATION OF PROP. THERMOPLASTIC PAVEMENT MARKING SHALL BE MATCH EXIST. LOCATIONS

REVISIONS	
NAME	DATE

ILLINOIS DEPARTMENT OF TRANSPORTATION  
**ROADWAY PLAN**  
**LOC 1: IL 83 AT US 34**  
**(OGDEN AVE.)**

SCALE: VERT. \_\_\_\_\_  
 HORIZ. \_\_\_\_\_  
 DATE: 4/26/2006

DRAWN BY \_\_\_\_\_  
 CHECKED BY \_\_\_\_\_