

CONTRACT NO. 62940

BENCH MARK
Bolt on Base of Electric Box North Side of Ogden Ave and West Side of Illinois Route 83 Elevation 705.79

EXISTING STRUCTURE DATA
STRUCTURE NO. 022-0049
Seven Span Simple Concrete Girders With Reinforced Concrete Deck and Reinforced Concrete Piers on Spread Footings and Reinforced Concrete, Closed Abutments. Total Structure Length=350' Back to Back of Abutments. Structure To Be Removed and Replaced Traffic To Be Detoured No Salvage.

El. 719.52 - West Sect.
El. 717.71 - East Sect.

El. 715.72 - West Sect.
El. 717.60 - East Sect.

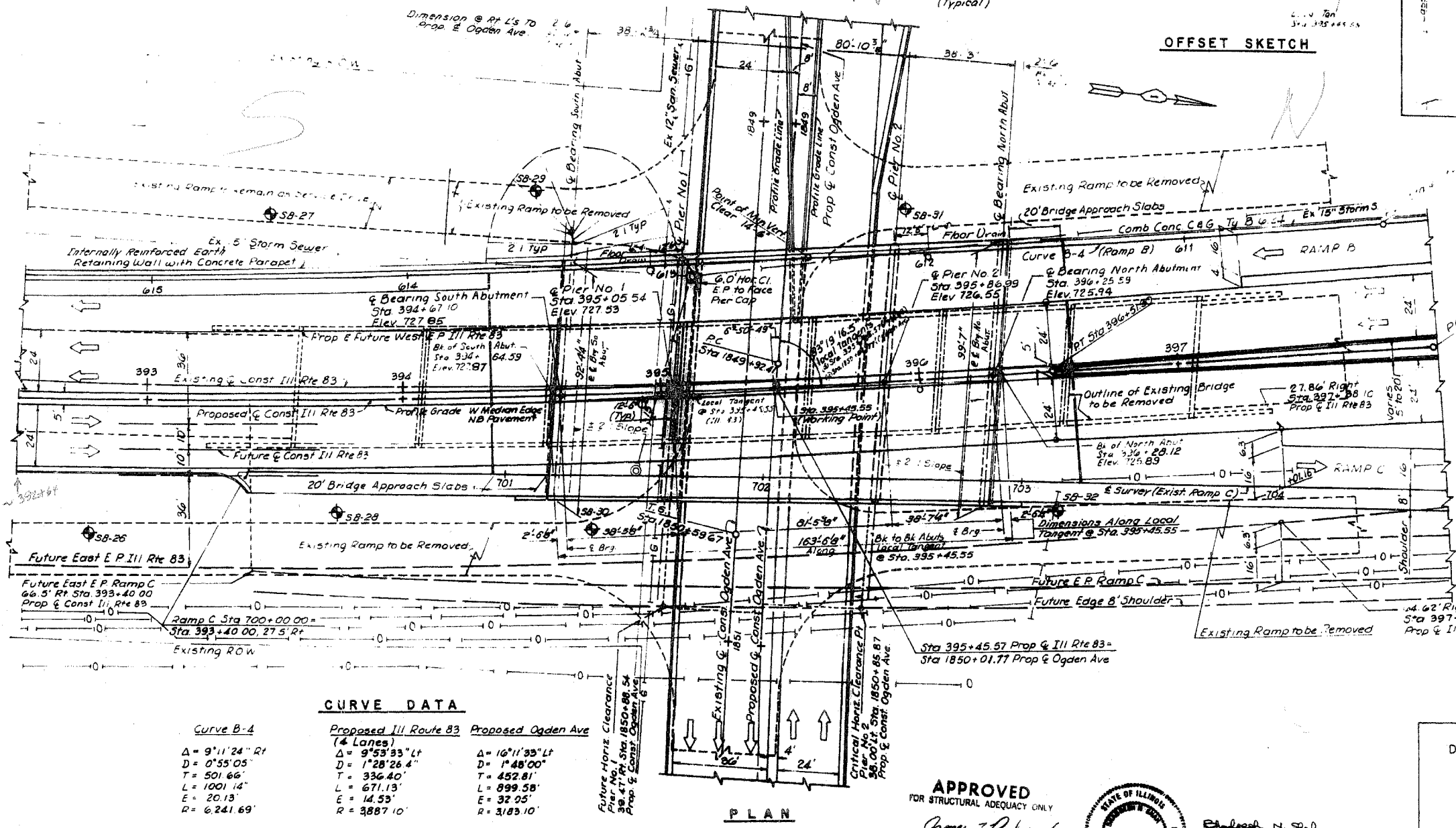
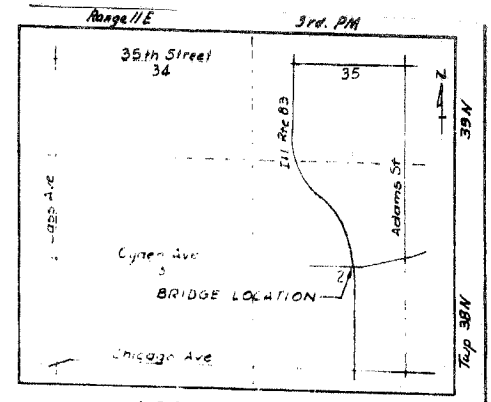
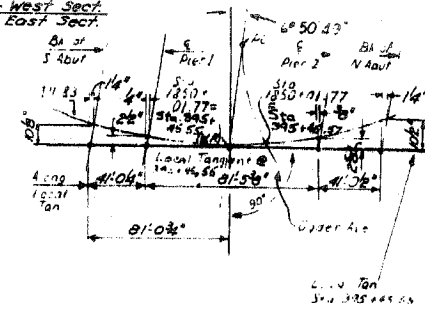
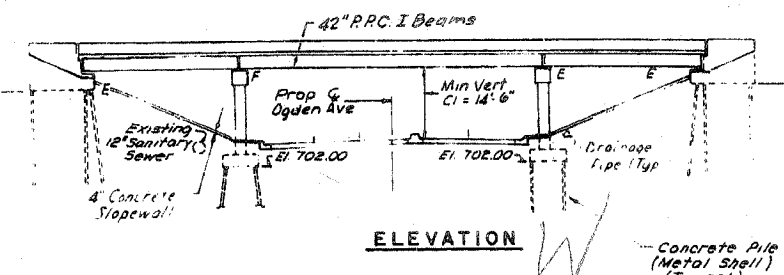

CURVE DATA

Curve B-4	Proposed Ill Route 83 (4 Lanes)	Proposed Ogden Ave
$\Delta = 9^{\circ}11'24''$ Rt	$\Delta = 9^{\circ}53'33''$ Lt	$\Delta = 16^{\circ}11'35''$ Lt
$D = 0^{\circ}55'05''$	$D = 1^{\circ}28'26.4''$	$D = 1^{\circ}48'00''$
$T = 501.66'$	$T = 336.40'$	$T = 452.81'$
$L = 1001.14'$	$L = 671.13'$	$L = 899.58'$
$E = 20.13'$	$E = 14.53'$	$E = 32.05'$
$R = 6241.69'$	$R = 3887.10'$	$R = 3183.10'$
PI Sta 615+24.33	PI Sta 393+16.57	PI Sta 1854+45.22
PC Sta 610+22.68	PC Sta 389+80.17	PC Sta 1849+92.41
PT Sta 620+23.82	PT Sta 396+51.30	PT Sta 1858+91.99 Back = Sta 1858+96.08 Ahead
Sta 620+70.76 Ramp B = Sta 587+75.15, 28.38' Lt. SE = 0.036%		SE = 0.017%

APPROVED
FOR STRUCTURAL ADEQUACY ONLY
Jamaal Rashid
Director of Bridges & Structures



Bhadrash N. Shah
BHADRASH N. SHAH
REGISTERED STRUCTURAL ENGINEER
STATE OF ILLINOIS LIC. NO. 081-004476

FEB. 22, 2008

FOR INFORMATION ONLY

STATE OF ILLINOIS
DEPARTMENT OF TRANSPORTATION
GENERAL PLAN
ILLINOIS ROUTE 83
OVER
OGDEN AVENUE
STATION 395 + 45.57
F.A.P. RT. 29 DUPAGE COUNTY SECTION 543R-4(83)
CHRISTIAN-ROGE AND ASSOC
ENGINEERS
CHICAGO, ILLINOIS

REVISIONS	
NAME	DATE

ILLINOIS DEPARTMENT OF TRANSPORTATION

EXIST. BRIDGE PLANS
STRUCTURE NO. 022-0157

SCALE: VERT.
HORIZ.
DATE 4/23/2006

DRAWN BY
CHECKED BY