

F.A.P. RTE.	SECTION	COUNTY	TOTAL SHEETS	SHEET NO.
344	2005-0171	DUPAGE	15	1

CONTRACT NO. 62940

STATE OF ILLINOIS  
DEPARTMENT OF TRANSPORTATION

DIVISION OF HIGHWAYS  
**PROPOSED HIGHWAY PLANS**

FAP 344 (ILL. ROUTE 83)  
LOCATION 1 - AT U.S. ROUTE 34  
LOCATION 2 - AT B.N. RAILROAD

SECTION: 2005-017 I  
BRIDGE APPROACH RESURFACING AND JOINT REPAIR  
DuPAGE COUNTY  
C-91-179-05

FOR INDEX OF SHEETS, SEE SHEET NO. 2

IMPROVEMENT LOCATED  
IN THE VILLAGES OF HINSDALE  
CLARENDON HILLS AND WESTMONT

TRAFFIC DATA  
IL 83 SOUTH OF US 34  
2003 ADT = 71,800  
SPEED LIMIT = 40 MPH



LOCATION OF SECTION INDICATED THUS: - [black rectangle] -

IMPROVEMENT LOCATION 1  
IL 83 OVER US 34  
(SN 022-0157)

IMPROVEMENT LOCATION 2  
OVER BN RR  
(SN 022-0155)

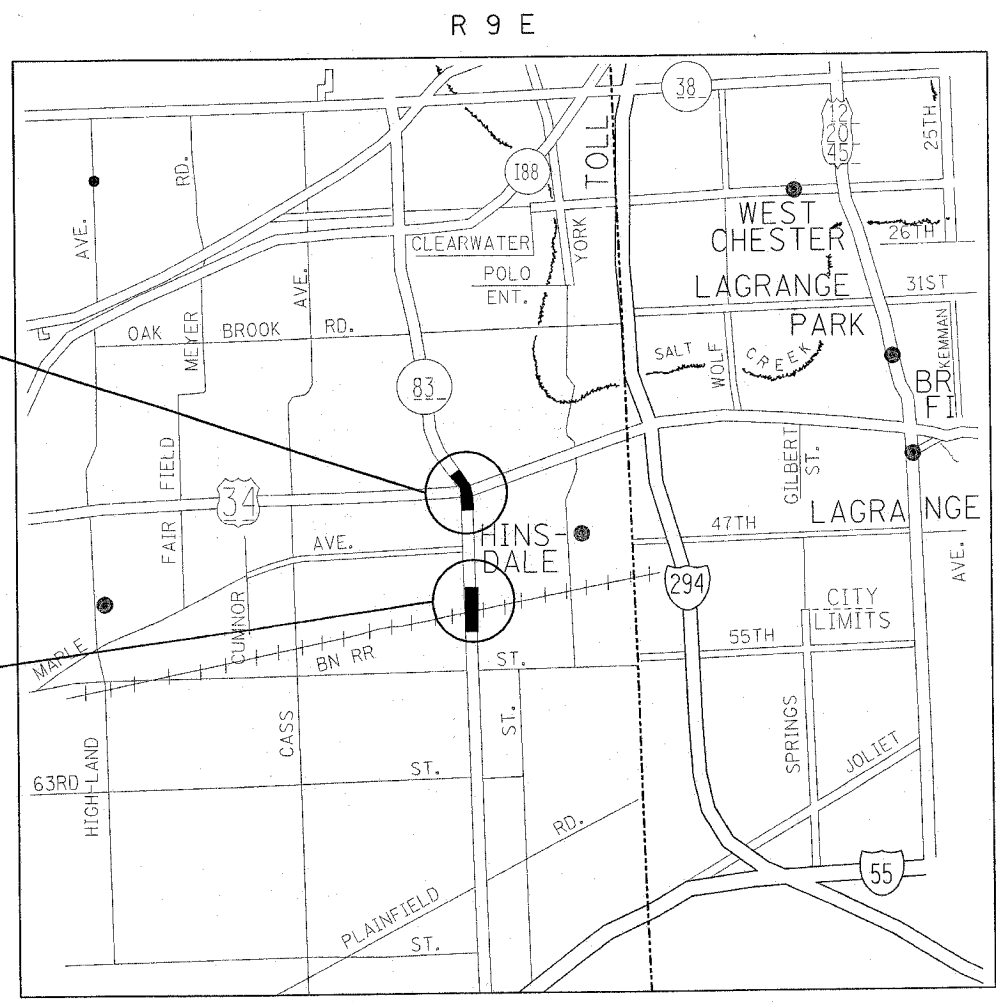

T 44 N

DOWNERS GROVE TOWNSHIP

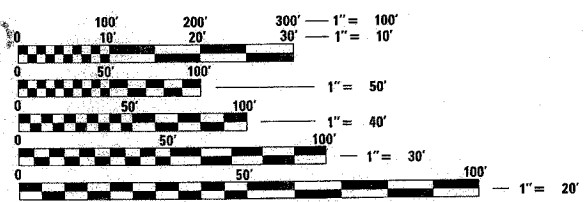

FULL SIZE PLANS HAVE BEEN PREPARED USING STANDARD ENGINEERING SCALES. REDUCED SIZED PLANS WILL NOT CONFORM TO STANDARD SCALES. IN MAKING MEASUREMENTS ON REDUCED PLANS, THE ABOVE SCALES MAY BE USED.

J.U.L.I.E.  
JOINT UTILITY LOCATION INFORMATION FOR EXCAVATION  
1-800-892-0123

CONTRACT NO. 62940

STATE OF ILLINOIS  
DEPARTMENT OF TRANSPORTATION  
DIVISION OF HIGHWAYS

SUBMITTED *March 29, 2006*

*Ernie M. O'Keefe, III*  
DEPUTY DIRECTOR OF HIGHWAYS, REGION ENGINEER

*Mike June*  
ENGINEER OF DESIGN AND ENVIRONMENT

*Michael P. Sorensen, P.E.*  
DIRECTOR OF HIGHWAYS, CHIEF ENGINEER

**PRINTED BY THE AUTHORITY  
OF THE STATE OF ILLINOIS**

DISTRICT ONE/BUREAU OF DESIGN  
PLAN PREPARATION ENGINEER: K. ENG / R. BORO - (847) 705-4178

INDEX OF SHEETS

SHEET NO.	DESCRIPTION
1	TITLE SHEET
2	INDEX OF SHEETS, GENERAL NOTES, STATE STANDARDS AND MIXTURE REQUIREMENTS
3	SUMMARY OF QUANTITIES
4 & 5	TYPICAL SECTIONS
6	ROADWAY PLAN (LOC 1- ILL.83 @ U.S. 34)
7	ROADWAY PLAN (LOC 2- ILL. 83 AT B.N. R.R.)
8	BRIDGE PLANS (LOC 1: SN 022-0157)
9	BRIDGE PLANS (LOC 2: SN 022-0155)
10	JOINT DETAILS
11	TRAFFIC CONTROL AND PROTECTION FOR SIDE ROADS, INTERSECTIONS AND DRIVEWAYS
12	DISTRICT ONE TYPICAL PAVEMENT MARKINGS
13	FREEWAY SHOULDER CLOSURES AND PARTIAL RAQMP CLOSURES
14	SIGNING FOR FLAGGING OPERATIONS AT WORK ZONE OPENINGS
15	RAISED REFLECTIVE PAVEMENT MARKERS

STATE STANDARDS

STANDARDS	DESCRIPTION
701301-02	LANE CLOSURE 2L, 2W SHORT TIME OPERATIONS
701411-03	MULTI-LANE, TRAFFIC CONTROL AT ENTRANCE OR EXIT RAMP
701421-01	LANE CLOSURE, MULTILANE, DAY OPERATIONS ONLY, FOR SPEEDS > 45 MPH
701426-02	LANE CLOSURE, MULTILANE, INTERMITTENT OR MOVING
702001-06	TRAFFIC CONTROL DEVICES

MIXTURE REQUIREMENTS

MIXTURE TYPE	AC/PG	AIR VOIDS	RAP% (MAX)	THICKNESS IN
POLYMERIZED BITUMINOUS CONCRETE SURFACE COARSE, SUPERPAVE, MIX "F", N90	SBS/SBR PG 76-22	4% @ 90 GYR	0	1-3/4"
LEVELING BINDER (MACHINE METHOD), SUPERPAVE, N70	PG 64-22	4% @ 70 GYR	10	VARIOUS

UNIT WEIGHT OF 112 LBS/SQ YD/IN USED TO CALCULATE ALL BITUMINOUS SURFACE MIXTURE QUANTITIES

GENERAL NOTES

- BEFORE STARTING ANY EXCAVATION, THE CONTRACTOR SHALL CALL "J.U.L.I.E." AT (800) 892-0123 FOR FIELD LOCATIONS OF BURIED ELECTRIC, TELEPHONE AND GAS UTILITIES. 48 HOUR NOTIFICATION IS REQUIRED.
- THE CONTRACTOR SHALL COORDINATE CONSTRUCTION ACTIVITIES WITH UTILITY COMPANIES.
- THE CONTRACTOR WILL NOT BE ALLOWED TO SET UP A YARD OR FIELD OFFICE ON STATE (or TOLLWAY) PROPERTY WITHOUT WRITTEN PERMISSION FROM THE DEPARTMENT (or ISTHA).
- ALL DAMAGE TO EXISTING PAVEMENT MARKINGS OR RAISED REFLECTIVE PAVEMENT MARKERS OUTSIDE THE REMOVAL LINE SHOWN ON THE PLANS SHALL BE REPLACED AT THE CONTRACTOR'S EXPENSE.
- DRAINAGE STRUCTURE ADJUSTMENT OR RECONSTRUCTION LOCATIONS WILL BE DETERMINED IN THE FIELD BY THE ENGINEER.
- IT SHALL BE THE CONTRACTOR'S RESPONSIBILITY TO VERIFY ALL DIMENSIONS AND CONDITIONS EXISTING IN THE FIELD PRIOR TO CONSTRUCTION AND ORDERING OF MATERIALS.
- THE CONTRACTOR SHALL CONTACT THE DISTRICT ONE TRAFFIC CONTROL SUPERVISOR AT (847)705-4470 A MINIMUM OF 72 HOURS IN ADVANCE OF BEGINNING WORK.
- THESE PLANS HAVE BEEN PREPARED FROM NOTES RECEIVED FROM THE BUREAU OF MAINTENANCE BRIDGE INSPECTORS.
- THE THICKNESS OF BITUMINOUS MIXTURE SHOWN ON THE PLANS IS THE NOMINAL THICKNESS. DEVIATIONS FROM THE NOMINAL THICKNESS WILL BE PERMITTED WHEN SUCH DEVIATIONS OCCUR DUE TO IRREGULARITIES IN THE EXISTING SURFACE OR BASE ON WHICH THE BITUMINOUS MIXTURE IS PLACED.
- THE CONTRACTOR SHALL BE REQUIRED TO PROVIDE ACCESS TO ABUTTING PROPERTY AT ALL TIMES DURING THE CONSTRUCTION OF THIS PROJECT.
- THE PROPOSED BITUMINOUS CONCRETE RESURFACING SHALL BE TAPERED OUT AT A RATE OF TWENTY (20) FEET PER INCH OF THICKNESS AT MAINLINE AND MAJOR SIDE STREET LOCATIONS, EXCEPT WHERE BUTT JOINTS ARE INDICATED. AT MINOR STREETS AND ENTRANCES, TAPER OUT IN TEN (10) FEET EXCEPT WHERE BUTT JOINTS ARE INDICATED. AT SEAL COATED STREETS AND ENTRANCES, TAPER OUT IN THREE (3) FEET UNLESS OTHERWISE SHOWN ON THE PLANS.
- DO NOT SCALE PLANS FOR CONSTRUCTION DIMENSIONS.
- DOUBLE LANE MARKERS ARE TO BE USED AS SHOWN ON THE DISTRICT ONE DETAIL "TYPICAL APPLICATIONS - RAISED REFLECTIVE PAVEMENT MARKERS (SNOW-PLOW RESISTANT)" SHOWN IN THE PLANS.
- PAVEMENT MARKING TAPE, TYPE III SHALL BE USED FOR SHORT TERM PAVEMENT MARKINGS ON ALL FINAL SURFACES. THE COST OF THE PAVEMENT MARKING TAPE, TYPE III AND ITS REMOVAL SHALL BE INCLUDED IN THE COST OF SHORT TERM PAVEMENT MARKING.
- BEFORE BEGINNING ANY WORK, THE CONTRACTOR SHALL RETAIN AND RECORD FOR FUTURE REFERENCE, ALL EXISTING PAVEMENT MARKING LINES (AND RAISED REFLECTIVE PAVEMENT MARKERS) IN ORDER THAT THESE LOCATIONS CAN BE RE-ESTABLISHED FOR STRIPING. EXACT LOCATIONS OF ALL PAVEMENT MARKINGS SHALL BE AS DIRECTED BY THE ENGINEER.

GENERAL NOTES (Bridge)

- THE CONTRACTOR SHALL TAKE NECESSARY PRECAUTIONS TO INSURE THAT NO DEBRIS WILL ENDANGER OR INTERFERE WITH TRAFFIC ON THE ROADWAY BENEATH THE BRIDGE ACCORDING TO ARTICLE 107.09 OF THE STANDARD SPECIFICATIONS. THIS WORK WILL NOT BE PAID FOR SEPERATELY, BUT SHALL BE INCLUDED IN THE CONTRACT UNIT PRICE FOR THE APROPRIATE PAYITEM INVOLVED AND NO ADDITIONAL COMPENSATION WILL BE ALLOWED.

CONTRACT NO. 62940

REVISIONS	
NAME	DATE

ILLINOIS DEPARTMENT OF TRANSPORTATION  
INDEX OF SHEETS  
STATE STANDARDS  
GENERAL NOTES  
MIXTURE REQUIEMENTS  
SCALE: NONE  
DATE 4/26/2006  
DRAWN BY  
CHECKED BY

ROUTE	SECTION	COUNTY	TOTAL SHEETS	SHEET NO.
344	2005-017 I	DUPAGE	15	3

**CONTRACT NO. 62940**

Pay Item	Description	Unit	Total	URBAN 100% STATE SFTY-2A	
				LOC. NO. 1 022-0157	LOC. NO. 2 022-0155
40400200	BITUMINOUS MATERIALS (PRIME COAT)	TON	4.40	1.70	2.70
40600300	AGGREGATE (PRIME COAT)	TON	22.00	9.00	13.00
40600400	MIXTURE FOR CRACKS, JOINTS, AND FLANGEWAYS	TON	1.80	0.70	1.10
40600980	BITUMINOUS SURFACE REMOVAL - BUTT JOINT	SQ YD	346.00	186.00	160.00
40600985	PORTLAND CEMENT CONCRETE SURFACE REMOVAL - BUTT JOINT	SQ YD	144.00	116.00	28.00
44000008	BITUMINOUS SURFACE REMOVAL 2 1/2"	SQ YD	4344.00	1058.00	3286.00
45000130	RELIEF JOINT 4"	FOOT	300.00	170.00	130.00
60255500	MANHOLES TO BE ADJUSTED	EACH	1.00	1.00	0.00
67100100	MOBILIZATION	L SUM	1.00	0.50	0.50
70100330	TRAFFIC CONTROL AND PROTECTION, STANDARD 701426	L SUM	1.00	0.50	0.50
70100310	TRAFFIC CONTROL AND PROTECTION, STANDARD 701421	EACH	4.00	4.00	0.00
70100800	TRAFFIC CONTROL AND PROTECTION, STANDARD 701401	L SUM	1.00	0.50	0.50
*78000200	THERMOPLASTIC PAVEMENT MARKING - LINE 4"	FOOT	4300.00	1360.00	2940.00
*78000500	THERMOPLASTIC PAVEMENT MARKING - LINE 8"	FOOT	800.00	800.00	0.00
*78000600	THERMOPLASTIC PAVEMENT MARKING - LINE 12"	FOOT	240.00	240.00	0.00
*78100100	RAISED REFLECTIVE PAVEMENT MARKER	EACH	70.00	34.00	36.00
78300200	RAISED REFLECTIVE PAVEMENT MARKER REMOVAL	EACH	70.00	34.00	36.00
X0301424	SILICONE JOINT SEALER	FOOT	330.00	200.00	130.00
X0320887	POLYMER CONCRETE	CU FT	12.00	0.00	12.00
X0322467	TEMPORARY INFORMATION SIGNING FOR LANE CLOSURE	SQ FT	96.00	48.00	48.00
X0329907	PORTLAND CEMENT CONCRETE SURFACE REMOVAL 2 1/2"	SQ YD	832.00	832.00	0.00
X4066548	POLYMERIZED BITUMINOUS CONCRETE SURFACE COURSE, SUPERPAVE, MIX "F", N90	TON	580.00	240.00	340.00
X4066770	LEVELING BINDER (MACHINE METHOD), SUPERPAVE N70	TON	226.00	80.00	146.00
X4409400	BITUMINOUS SURFACE REMOVAL 1 3/4"	SQ YD	377.00	377.00	0.00
X0325424	PORTLAND CEMENT CONCRETE SURFACE REMOVAL 1-3/4"	SQ. YD.	158.00	158.00	0.00

\*SPECIALTY ITEMS

REVISIONS		ILLINOIS DEPARTMENT OF TRANSPORTATION
NAME	DATE	
		<b>SUMMARY OF QUANTITIES</b>  SCALE: VERT. SCALE: HORIZ. DATE 4/23/2006  DRAWN BY CHECKED BY

Rev.

CONTRACT NO. 62940

EXISTING

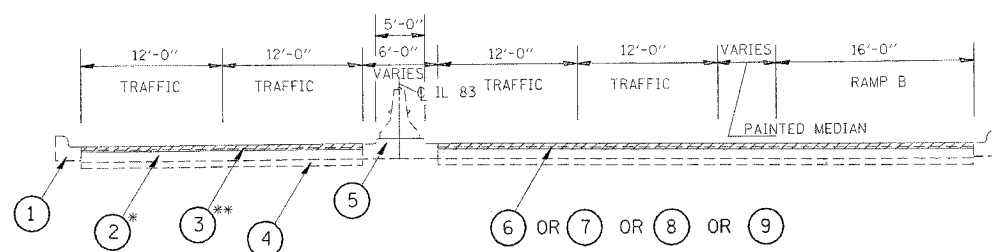

\* STA. 393+64 TO STA. 394+44 ONLY  
 \*\* STA. 394+44 TO STA. 394+64 ONLY

ILLINOIS ROUTE 83  
 STA 392+64.00 TO 394+64.00  
 LOOKING SOUTH

PROPOSED

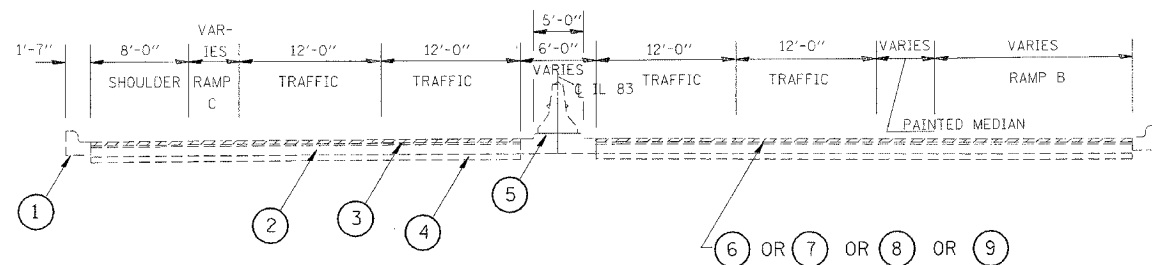
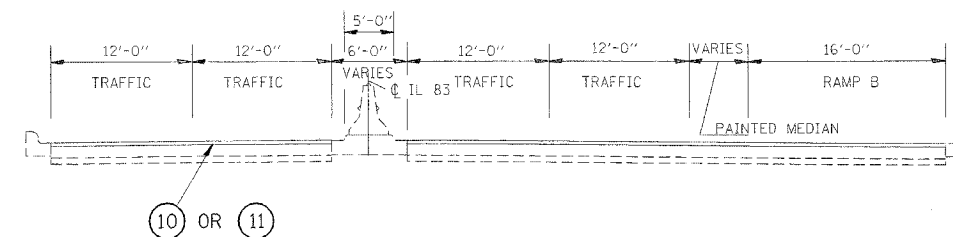

ILLINOIS ROUTE 83  
 STA 396+28.00 TO 397+28.00  
 LOOKING SOUTH

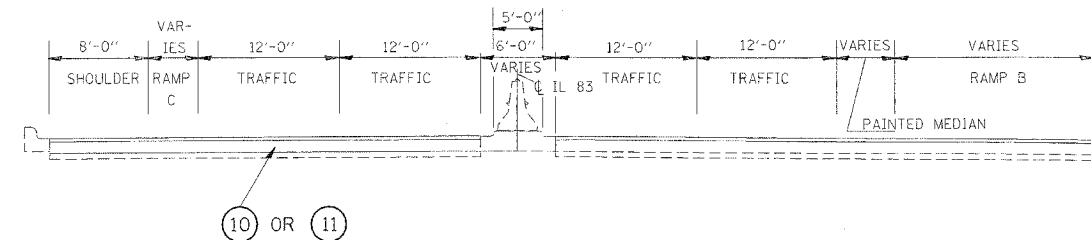

NOTES:

EXISTING APPROACH PAVEMENT SHALL BE MILLED AND RESURFACED 1-3/4" DEEP  
 EXISTING PAVEMENT SHALL BE MILLED AND RESURFACED 2-1/2"  
 SEE PLAN SHEETS FOR LIMITS AND DEPTHS OF SURFACE REMOVAL AND RESURFACING

- |  |   |
|--|---|
| ① EXISTING CONCRETE COMBINATION CURB AND GUTTER, TYPE B 6.12 | ⑧ PROPOSED P.C.C. SURFACE REMOVAL 1-3/4"  |
| ② EXISTING PCC PAVEMENT 10"                                  | ⑨ PROPOSED P.C.C. SURFACE REMOVAL 2-1/2"  |
| ③ EXISTING BITUMINOUS SURFACE 1-1/2"                         | ⑩ PROPOSED POLYMERIZED BITUMINOUS CONCRETE SURFACE COARSE, SUPERPAVE, MIX. F, N 90 - 1-3/4" (NOMINAL) |
| ④ EXISTING GRANULAR SUBGRADE 12"                             | ⑪ PROPOSED LEVELING BINDER (MACHINE METHOD). SUPERPAVE IL -19 N70 (VARIABLE)                          |
| ⑤ EXISTING BITUMINOUS CONCRETE MEDIAN 12"                    |   |
| ⑥ PROPOSED BITUMINOUS SURFACE 2-1/2"                         |   |
| ⑦ PROPOSED BITUMINOUS SURFACE REMOVAL 1-3/4"                 |   |

REVISIONS	
NAME	DATE

ILLINOIS DEPARTMENT OF TRANSPORTATION  
 ROADWAY TYPICAL SECTIONS  
 LOC 1: IL 83/ US 34  
 (OGDEN AVE)

SCALE: VERT. HORIZ.  
 DATE 4/27/2006

DRAWN BY  
 CHECKED BY

CONTRACT NO. 62940

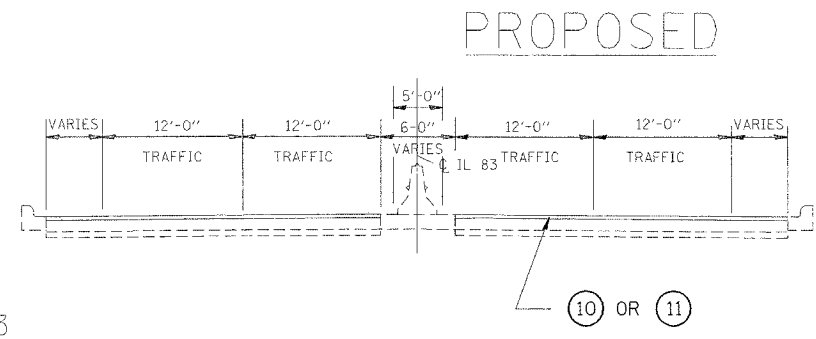
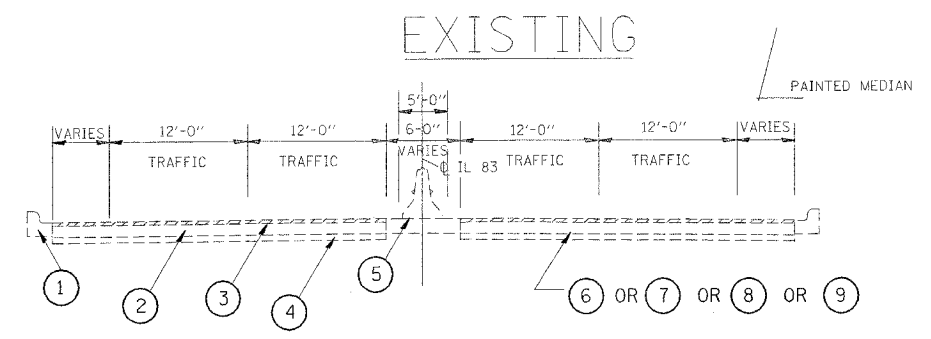

ILLINOIS ROUTE 83  
STA 392+64.00 TO 394+64.00  
SOUTH APPROACH PAVEMENT  
LOOKING SOUTH

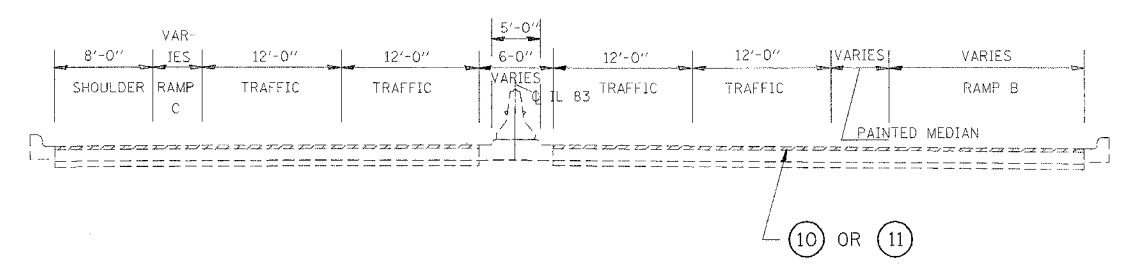
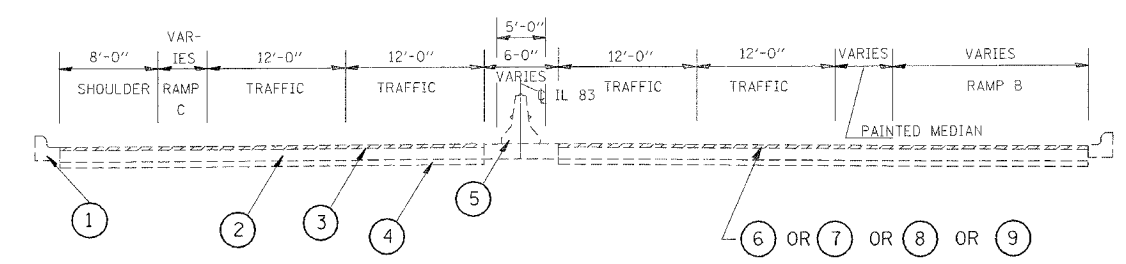

ILLINOIS ROUTE 83  
STA 396+28.00 TO 397+28.00  
NORTH APPROACH PAVEMENT  
LOOKING SOUTH

NOTES:  
EXISTING APPROACH PAVEMENT SHALL BE MILLED AND RESURFACED 1-3/4" DEEP  
EXISTING PAVEMENT SHALL BE MILLED AND RESURFACED 2-1/2"  
SEE PLAN SHEETS FOR LIMITS AND DEPTHS OF SURFACE REMOVAL AND RESURFACING

- |  |  |
|--|--|
| ① EXISTING CONCRETE COMBINATION CURB AND GUTTER, TYPE B 6.12 | ⑧ PROPOSED P.C.C. SURFACE REMOVAL 1-3/4"   |
| ② EXISTING PCC PAVEMENT 10"                                  | ⑨ PROPOSED P.C.C. SURFACE REMOVAL 2-1/2"   |
| ③ EXISTING BITUMINOUS SURFACE 1-1/2"                         | ⑩ PROPOSED POLYMERIZED BITUMINOUS CONCRETE SURFACE<br>COARSE, SUPERPAVE, MIX. F, N 90 - 1-3/4" (NOMINAL) |
| ④ EXISTING GRANULAR SUBGRADE 12"                             | ⑪ PROPOSED LEVELING BINDER (MACHINE METHOD). SUPERPAVE<br>IL -19 N70 (VARIABLE)                          |
| ⑤ EXISTING BITUMINOUS CONCRETE MEDIAN 12"                    |  |
| ⑥ PROPOSED BITUMINOUS SURFACE 2-1/2"                         |  |
| ⑦ PROPOSED BITUMINOUS SURFACE REMOVAL 1-3/4"                 |  |

REVISIONS	
NAME	DATE

ILLINOIS DEPARTMENT OF TRANSPORTATION  
ROADWAY TYPICAL SECTIONS  
LOC 2: IL 83/ BN RR



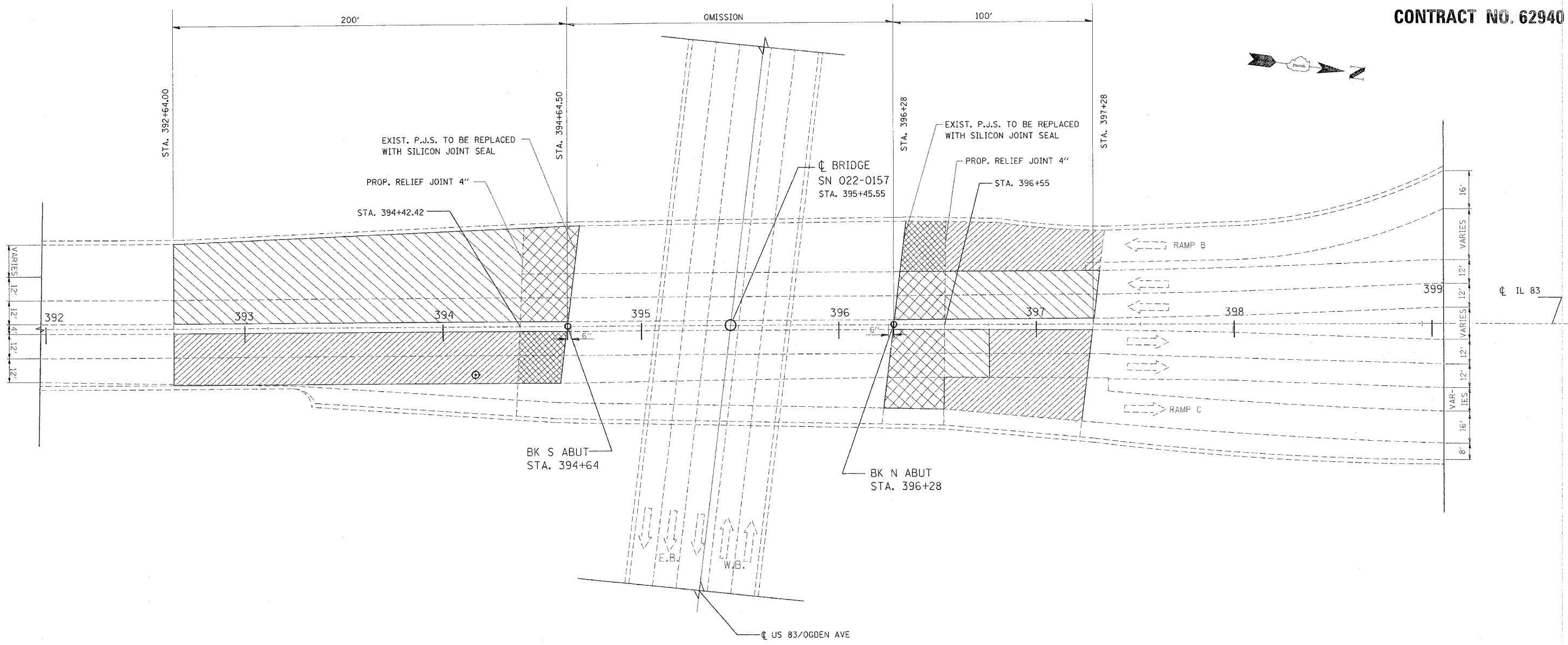

SCALE: VERT. \_\_\_\_\_  
HORIZ. \_\_\_\_\_  
DATE 4/27/2006

DRAWN BY \_\_\_\_\_  
CHECKED BY \_\_\_\_\_

**CONTRACT NO. 62940**



**LEGEND**

-  BITUMINOUS SURFACE REMOVAL 2-1/2"
-  BITUMINOUS SURFACE REMOVAL 1-3/4"
-  P.C.C. SURFACE REMOVAL 2-1/2"
-  P.C.C. SURFACE REMOVAL 1-3/4"

**PLAN**

NOTE: LOCATION OF PROP. THERMOPLASTIC PAVEMENT MARKING SHALL BE MATCH EXIST. LOCATIONS

REVISIONS		ILLINOIS DEPARTMENT OF TRANSPORTATION ROADWAY PLAN LOC 1: IL 83 AT US 34 (OGDEN AVE.)
NAME	DATE	



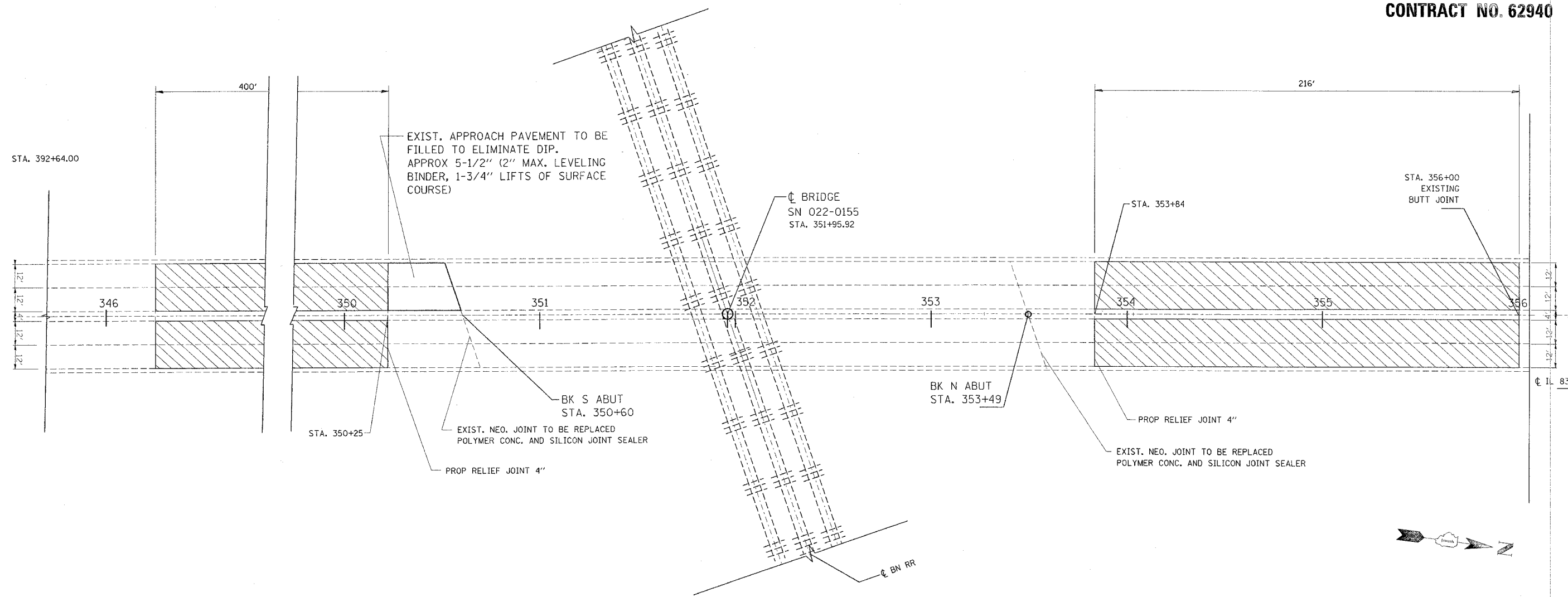

SCALE: VERT. \_\_\_\_\_  
 HORIZ. \_\_\_\_\_  
 DATE: 4/26/2006  
 DRAWN BY \_\_\_\_\_  
 CHECKED BY \_\_\_\_\_

F.A.P. RTE.	SECTION	COUNTY	TOTAL SHEETS	SHEET NO.
344	2005-017I	DUPAGE	15	7

**CONTRACT NO. 62940**

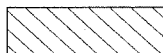

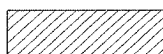
**LEGEND**

-  BITUMINOUS SURFACE REMOVAL 2-1/2"
-  BITUMINOUS SURFACE REMOVAL 1-3/4"
-  P.C.C. SURFACE REMOVAL 2-1/2"
-  P.C.C. SURFACE REMOVAL 1-3/4"

**PLAN**

NOTE: LOCATION OF PROP. THERMOPLASTIC PAVEMENT MARKING SHALL BE MATCH EXIST. LOCATIONS

REVISIONS		ILLINOIS DEPARTMENT OF TRANSPORTATION ROADWAY PLAN
NAME	DATE	
		LOC 2: IL 83 AT BN RR
SCALE: VERT. _____		DRAWN BY _____
DATE 4/26/2006		

CONTRACT NO. 62940

**BENCH MARK**  
Bolt on Base of Electric Box North Side of Ogden Ave and West Side of Illinois Route 83 Elevation 705.79

**EXISTING STRUCTURE DATA**  
STRUCTURE NO. 022-0049  
Seven Span Simple Concrete Girders With Reinforced Concrete Deck and Reinforced Concrete Piers on Spread Footings and Reinforced Concrete, Gased Abutments. Total Structure Length=350' Back To Back of Abutments. Structure To Be Removed and Replaced Traffic To Be Detoured No Salvage.

El. 719.52 - West Sect.  
El. 717.71 - East Sect.

El. 715.72 - West Sect.  
El. 717.60 - East Sect.

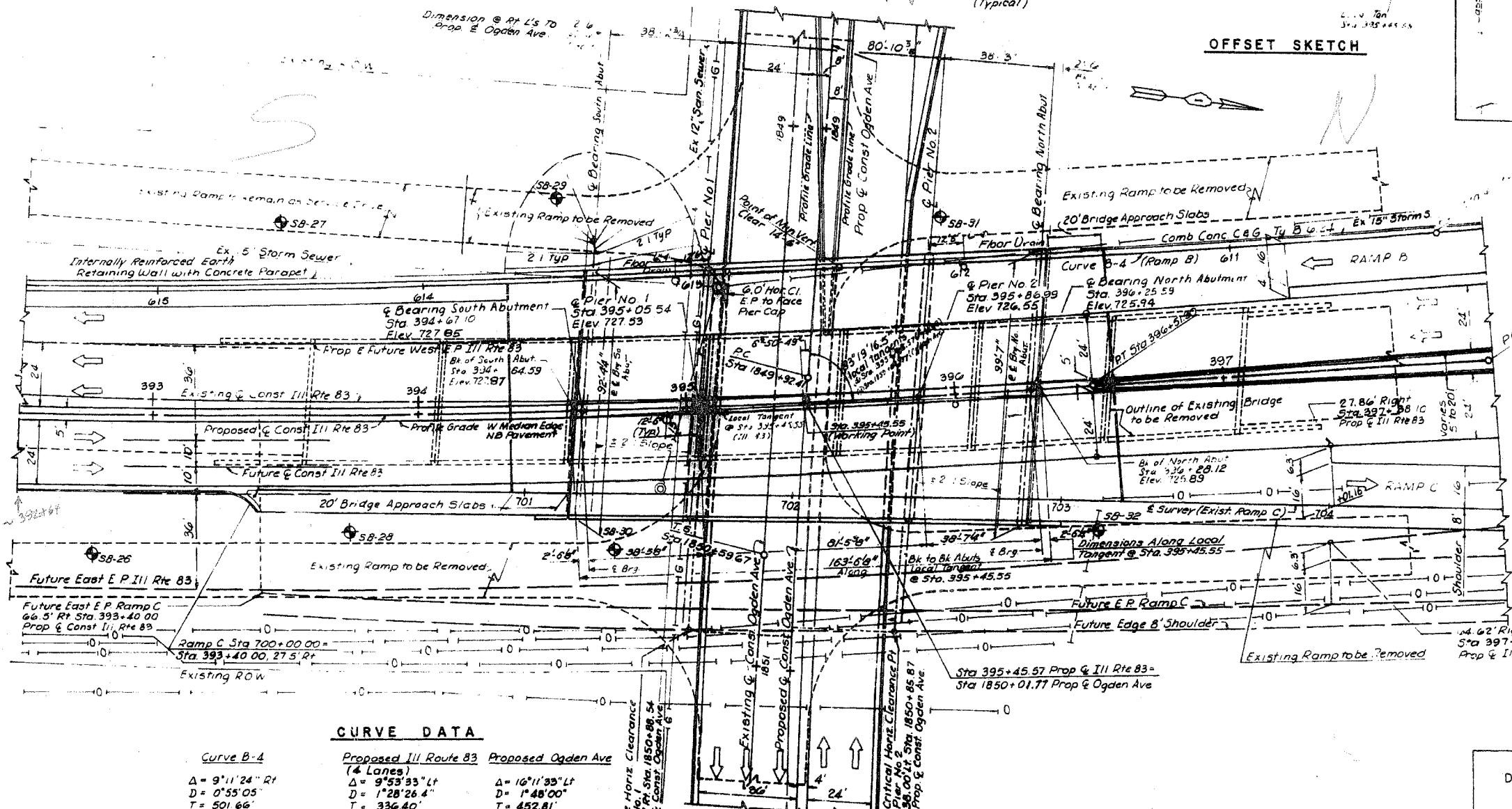
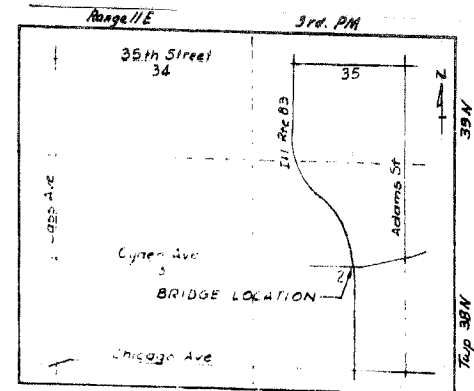
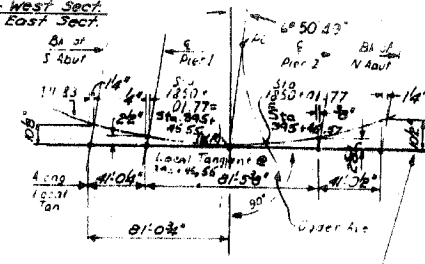
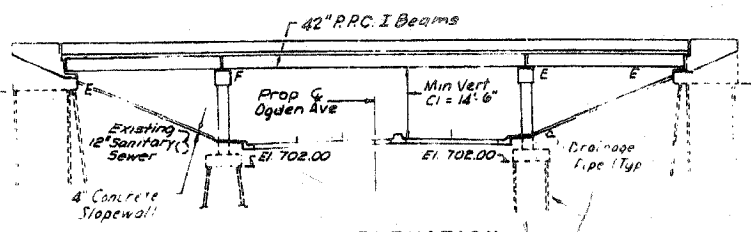

Width in all cases linearly from 5.00' to 20.00' between Sta 394+51.30 and Sta 401+29.92

FOR INFORMATION ONLY

**CURVE DATA**

Curve B-4 (4 Lanes)	Proposed Ill Route 83 (4 Lanes)	Proposed Ogden Ave
$\Delta = 9^{\circ}11'24''$ Rt	$\Delta = 9^{\circ}53'33''$ Lt	$\Delta = 16^{\circ}11'35''$ Lt
$D = 0^{\circ}55'05''$	$D = 1^{\circ}28'26.4''$	$D = 1^{\circ}48'00''$
$T = 501.66'$	$T = 336.40'$	$T = 452.81'$
$L = 1001.14'$	$L = 671.13'$	$L = 899.58'$
$E = 20.13'$	$E = 14.53'$	$E = 32.05'$
$R = 6241.69'$	$R = 3887.10'$	$R = 3183.10'$
PI Sta 615+24.33	PI Sta 393+16.57	PI Sta 1854+45.22
PC Sta 610+22.68	PC Sta 389+80.17	PC Sta 1849+92.41
PT Sta 620+23.82	PT Sta 396+51.30	PT Sta 1858+91.99 Back = Sta 1858+96.08 Ahead
Sta 620+70.76 Ramp B = Sta 587+75.15, 28.38' Lt.	SE = 0.036%	SE = 0.017%

APPROVED  
FOR STRUCTURAL ADEQUACY ONLY

*Jama R. ...*  
Structural Engineer



**Bhadrash N. Shah**  
BHADRASH N. SHAH  
REGISTERED STRUCTURAL ENGINEER  
STATE OF ILLINOIS LIC. NO. 081-004476

FEB. 22, 2008

STATE OF ILLINOIS  
DEPARTMENT OF TRANSPORTATION  
GENERAL PLAN  
ILLINOIS ROUTE 83  
OVER  
OGDEN AVENUE  
STATION 395+45.57  
F.A.P. RT. 29 DUPAGE COUNTY SECTION 543R-4(83)  
CHRISTIAN-ROGE AND ASSOC  
ENGINEERS  
CHICAGO, ILLINOIS

REVISIONS	
NAME	DATE

ILLINOIS DEPARTMENT OF TRANSPORTATION

**EXIST. BRIDGE PLANS**  
STRUCTURE NO. 022-0157

SCALE: VERT.  
HORIZ.  
DATE 4/23/2006

DRAWN BY  
CHECKED BY



**CONTRACT NO. 62940**

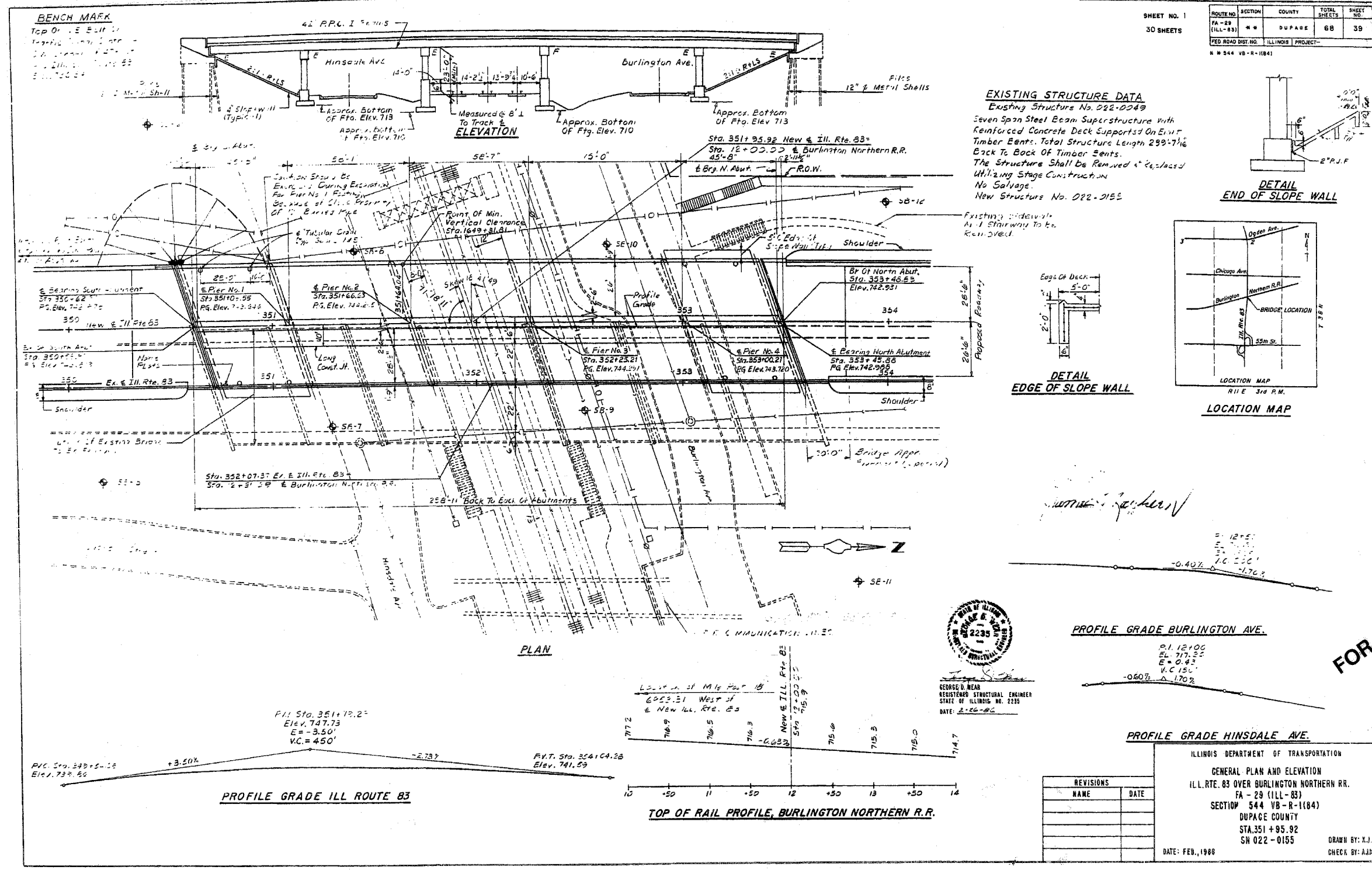

**FOR INFORMATION ONLY**

CONTRACT NO. 62940

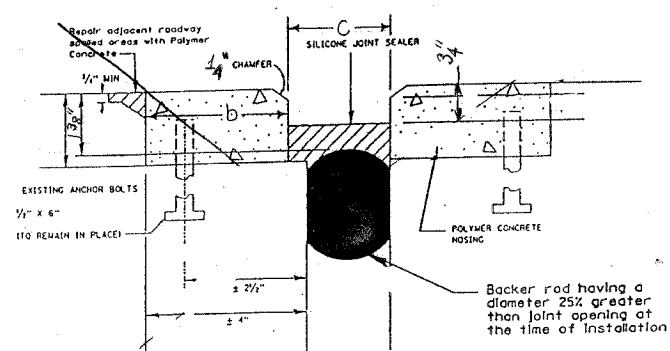

EXISTING NEOPRENE  
(SN. 022-0155)

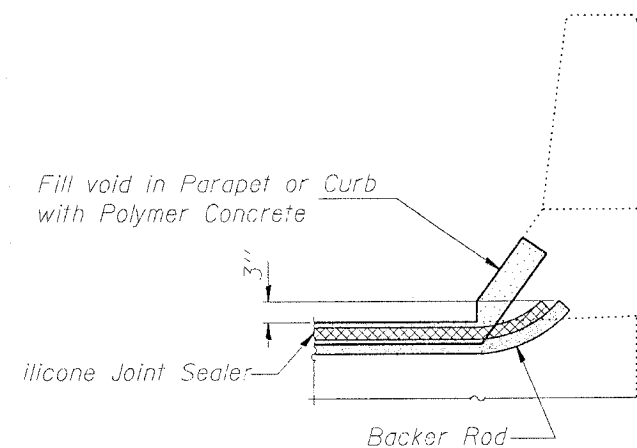

TYPICAL END OF SEAL TREATMENT

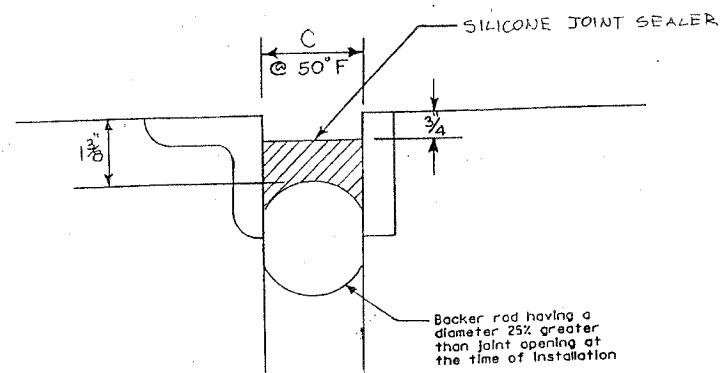

EXISTING PJS  
(SN. 022-0157)

DESIGN CHART

SN. 022-0157	SN. 022-0155	"C" Joint Opening at 50° F.	Length Contributing to Expansion	QUANTITY
		inch	feet	—
		1	0 - 40	—
S. ABUT.		1 1/2	40 - 80	36'
		2	80 - 120	—
N. ABUT.	N. ABUT.	2 1/2	120 - 160	169'
	S. ABUT.	3	160 - 200	65'

Note: Cost of removal of existing expansion joint anchor blocks and seals is included with Silicone Joint Sealer.

REVISIONS	
NAME	DATE

ILLINOIS DEPARTMENT OF TRANSPORTATION

**BRIDGE JOINT DETAILS**

SCALE: VERT.  
HORIZ.  
DATE 4/23/2006

DRAWN BY  
CHECKED BY

F.A. RTE.	SECTION	COUNTY	TOTAL SHEETS	SHEET NO.
314	2005-017 I	DUPAGE	15	11
STA.	TO STA.			
FED. ROAD DIST. NO. 1	ILLINOIS	FED. AID PROJECT		

CONTRACT NO. 62940

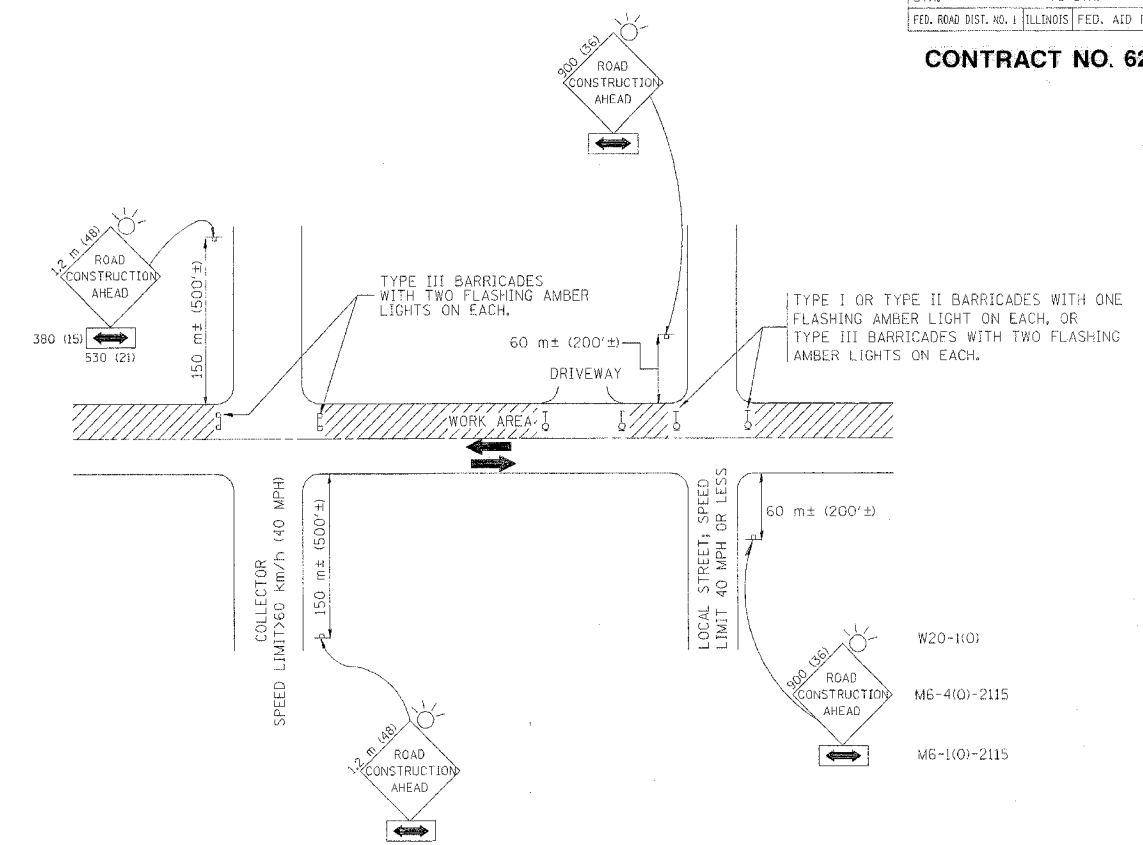

TRAFFIC CONTROL AND PROTECTION FOR SIDE ROADS, INTERSECTIONS, AND DRIVEWAYS

NOTES:

- A. FOR NO LANE RESTRICTION ON THE SIDE ROAD OR DRIVEWAYS
- SIDE ROAD WITH A SPEED LIMIT OF 60 km/h (40 MPH) OR LESS AS SHOWN ON THE DRAWING AND AS DIRECTED BY THE ENGINEER:
    - ONE **ROAD CONSTRUCTION AHEAD** SIGN 900x900 (36x36) WITH A FLASHER AND FLAG MOUNTED ON IT APPROXIMATELY 60 m (200') IN ADVANCE OF THE MAIN ROUTE.
    - THE CLOSED PORTION OF THE MAIN ROUTE SHALL BE PROTECTED BY BLOCKING WITH TYPE I, TYPE II OR TYPE III BARRICADES, 1/3 OF THE CROSS SECTION OF THE CLOSED PORTION.
  - SIDE ROAD WITH A SPEED LIMIT GREATER THAN 60 km/h (40 MPH) AS SHOWN ON THE DRAWING AND AS DIRECTED BY THE ENGINEER:
    - ONE **ROAD CONSTRUCTION AHEAD** SIGN 1.2 m x 1.2 m (48x48) WITH A FLASHER MOUNTED ON IT APPROXIMATELY 150 m (500') IN ADVANCE OF THE MAIN ROUTE.
    - THE CLOSED PORTION OF THE MAIN ROUTE SHALL BE PROTECTED BY BLOCKING WITH TYPE III BARRICADES, 1/2 OF THE CROSS SECTION OF THE CLOSED PORTION.
  - WHEN THE SIDE ROAD LIES BETWEEN THE BEGINNING OF THE MAINLINE SIGNING AND THE WORK ZONE, A SINGLE HEADED ARROW (M6-1) SHALL BE USED IN LIEU OF THE DOUBLE HEADED ARROW (M6-4).
- B. FOR A LANE CLOSURE ON A SIDE ROAD OR DRIVEWAY:
- USE APPLICABLE PORTIONS OF THE TYPICAL APPLICATION OF TRAFFIC CONTROL DEVICES (STD. T01501, STD. T01606 OR THE APPROPRIATE STANDARD). THE SPACING OF SIGNS AND BARRICADES SHALL BE ADJUSTED FOR FIELD CONDITIONS AS DIRECTED BY THE ENGINEER. THE DIRECTIONAL ARROW SHALL BE COVERED OR REMOVED WHEN NO LONGER CONSISTENT WITH THE SIDE ROAD LANE CLOSURE.
- C. ADVANCE WARNING SIGNS ARE TO BE OMITTED ON DRIVEWAY UNLESS OTHERWISE NOTED.
- D. THE TRAFFIC CONTROL AND PROTECTION FOR SIDE ROADS, INTERSECTIONS, AND DRIVEWAYS SHALL BE INCIDENTAL TO THE COST OF SPECIFIED TRAFFIC CONTROL STANDARDS OR ITEMS.

REVISIONS	
NAME	DATE
LHA	6/89
T. RAMMACHER	09/08/94
J. OBERLE	10/18/95
A. HOUSEH	03/06/96
A. HOUSEH	10/15/96
T. RAMMACHER	01/06/00

ILLINOIS DEPARTMENT OF TRANSPORTATION  
 TRAFFIC CONTROL AND PROTECTION  
 FOR  
 SIDE ROADS, INTERSECTIONS, AND  
 DRIVEWAYS

SCALE: VERT. DATE 10/18/2002  
 HORIZ. DRAWN BY  
 CHECKED BY  
 TC-10  
 REVISION DATE: 01/06/00

**CONTRACT NO. 62940**

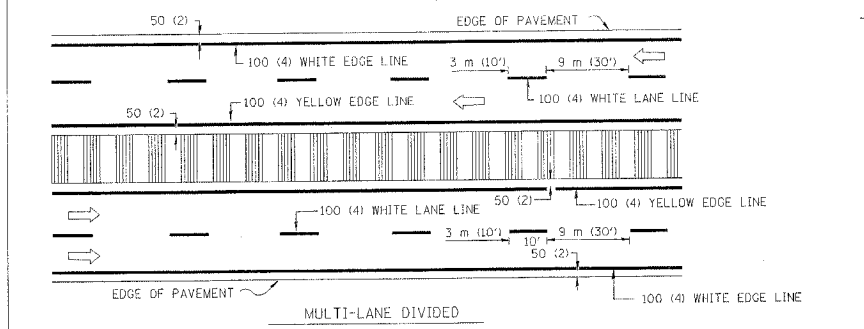
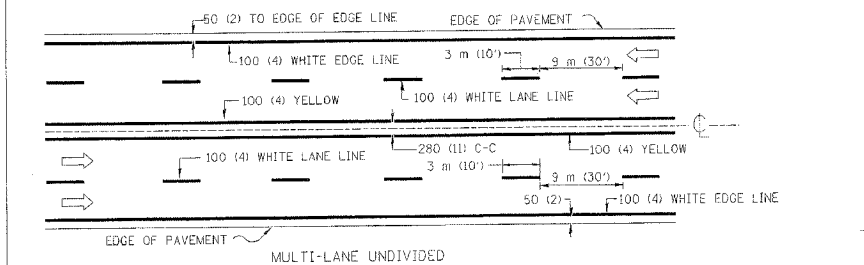
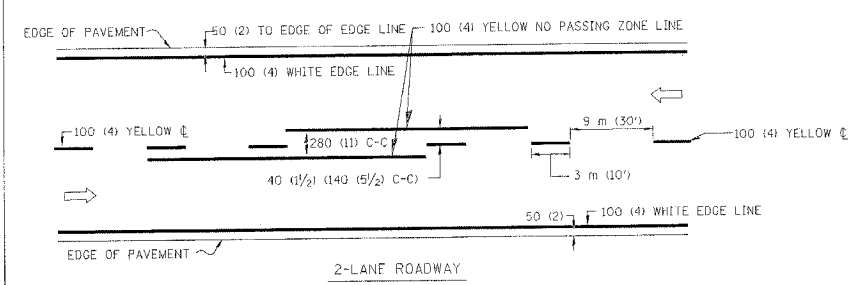

NOTE: MEDIANS WITH BARRIER CURB DO NOT REQUIRE AN EDGE LINE

**TYPICAL LANE AND EDGE LINE MARKING**

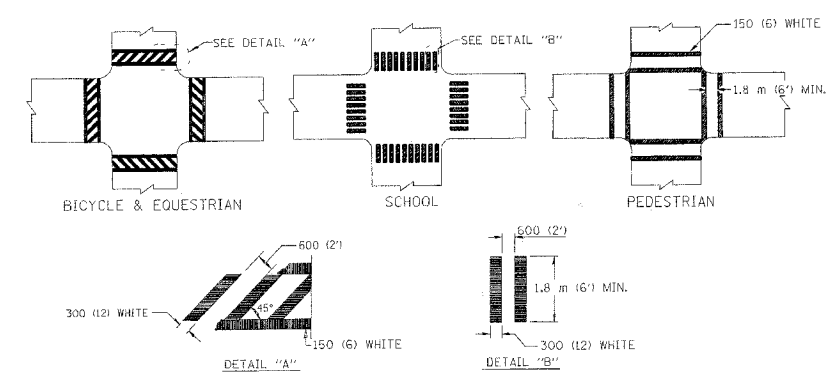

**TYPICAL CROSSWALK MARKING**

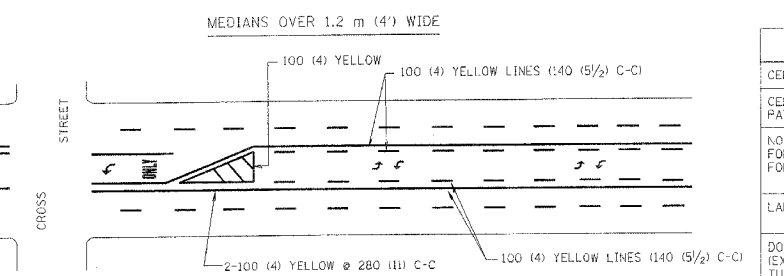
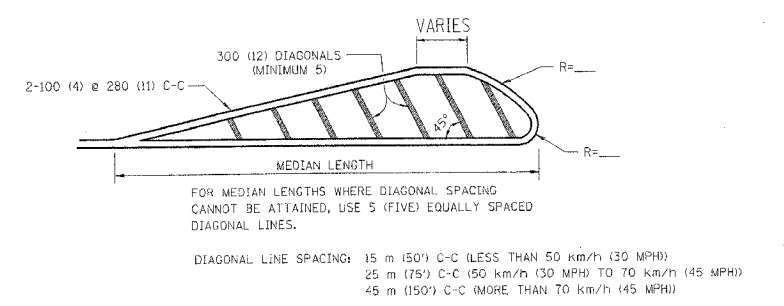
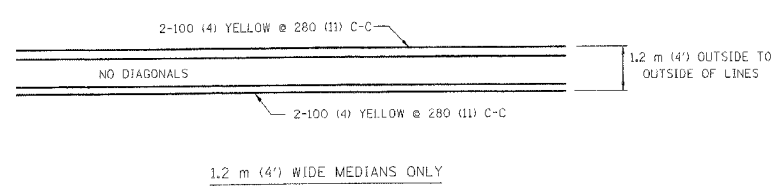

**TYPICAL PAINTED MEDIAN MARKING**

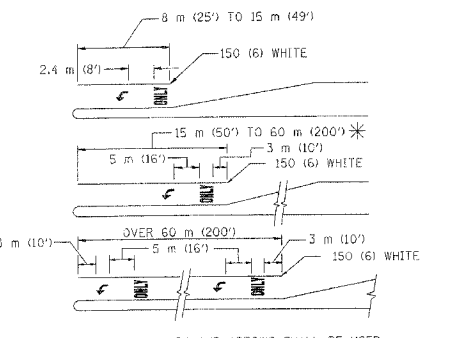

FULL SIZE LETTERS 2.4 m (8') AND ARROWS SHALL BE USED.  
AREA = 1.5 m<sup>2</sup> (15.6 SQ. FT.) ONLY AREA = 1.9 m<sup>2</sup> (20.8 SQ. FT.)

\* TURN LANES IN EXCESS OF 120 m (400') IN LENGTH MAY HAVE AN ADDITIONAL SET OF ARROW - "ONLY" INSTALLED MIDWAY BETWEEN THE OTHER TWO SETS OF ARROW - "ONLY".

**TYPICAL LEFT (OR RIGHT) TURN LANE**

**TYPICAL TURN LANE MARKING**

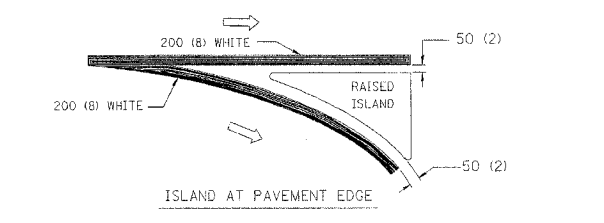
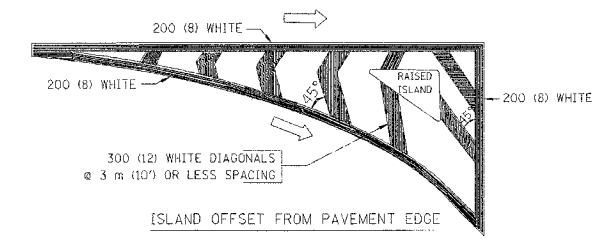

**TYPICAL ISLAND MARKING**

TYPE OF MARKING	WIDTH OF LINE	PATTERN	COLOR	SPACING / REMARKS
CENTERLINE ON 2 LANE PAVEMENT	100 (4)	SKIP-DASH	YELLOW	3 m (10') LINE WITH 9 m (30') SPACE
CENTERLINE ON MULTI-LANE UNDIVIDED PAVEMENT	2 @ 100 (4)	SOLID	YELLOW	280 (11) C-C
NO PASSING ZONE LINES FOR ONE DIRECTION FOR BOTH DIRECTIONS	100 (4) 2 @ 100 (4)	SOLID SOLID	YELLOW YELLOW	140 (5 1/2) C-C FROM SKIP-DASH CENTERLINE 280 (11) C-C OMIT SKIP-DASH CENTERLINE BETWEEN
LANE LINES	100 (4) 125 (5) ON FREEWAYS	SKIP-DASH SKIP-DASH	WHITE WHITE	3 m (10') LINE WITH 9 m (30') SPACE
DOTTED LINES (EXTENSIONS OF CENTER, LANE OR TURN LANE MARKINGS)	SAME AS LINE BEING EXTENDED	SKIP-DASH	SAME AS LINE BEING EXTENDED	600 (2') LINE WITH 1.8 m (6') SPACE
EDGE LINES	100 (4)	SOLID	YELLOW-LEFT WHITE-RIGHT	OUTLINE MOUNTABLE MEDIANS IN YELLOW; EDGE LINES ARE NOT USED NEXT TO BARRIER CURB
TURN LANE MARKINGS	150 (6) LINE; FULL SIZE LETTERS & SYMBOLS (2.4 m (8'))	SOLID	WHITE	SEE TYPICAL TURN LANE MARKING DETAIL
TWO WAY LEFT TURN MARKING	2 @ 100 (4) EACH DIRECTION 2.4 m (8') LEFT ARROW	SKIP-DASH AND SOLID IN PAIRS	YELLOW WHITE	3 m (10') LINE WITH 9 m (30') SPACE FOR SKIP-DASH; 140 (5 1/2) C-C BETWEEN SOLID LINE AND SKIP-DASH LINE SEE TYPICAL TWO-WAY LEFT TURN MARKING DETAIL
CROSSWALK LINES (PEDESTRIAN & BIKE & EQUESTRIAN) A. DIAGONALS (BIKE & EQUESTRIAN) B. LONGITUDINAL BARS (SCHOOL)	2 @ 150 (6) 300 (12) @ 45° 300 (12) @ 90°	SOLID SOLID SOLID	WHITE WHITE WHITE	NOT LESS THAN 1.8 m (6') APART 600 (2') APART SEE TYPICAL CROSSWALK MARKING DETAILS.
STOP LINES	600 (24)	SOLID	WHITE	PLACE 1.2 m (4') IN ADVANCE OF AND PARALLEL TO CROSSWALK, IF PRESENT. OTHERWISE, PLACE AT DESIRED STOPPING POINT. PARALLEL TO CROSSROAD CENTERLINE, WHERE POSSIBLE.
PAINTED MEDIANS	2 @ 100 (4) WITH 300 (12) DIAGONALS @ 45° NO DIAGONALS USED FOR 1.2 m (4') WIDE MEDIANS	SOLID	YELLOW: TWO WAY TRAFFIC WHITE: ONE WAY TRAFFIC	280 (11) C-C FOR THE DOUBLE LINE SEE TYPICAL PAINTED MEDIAN MARKING.
GORE MARKING AND CHANNELIZING LINES	200 (8) WITH 300 (12) DIAGONALS @ 45°	SOLID	WHITE	DIAGONALS: 4.5 m (15') C-C (LESS THAN 50 km/h (30 MPH)) 6 m (20') C-C (50 km/h (30 MPH) TO 70 km/h (45 MPH)) 9 m (30') C-C (OVER 70 km/h (45 MPH))
RAILROAD CROSSING	600 (24) TRANSVERSE LINES; "RR" IS 1.8 m (6') LETTERS; 400 (16) LINE FOR "X"	SOLID	WHITE	SEE STATE STANDARD 780001 AREA OF: "R"=0.33m <sup>2</sup> (3.6 SQ. FT.) EACH "X"=5.0 m <sup>2</sup> (54.0 SQ. FT.)
SHOULDER DIAGONALS	15 m (50') C-C (LESS THAN 50 km/h (30 MPH)) 25 m (75') C-C (50 km/h (30 MPH) TO 70 km/h (45 MPH)) 45 m (150') C-C (OVER 70 km/h (45 MPH))	SOLID	WHITE - RIGHT YELLOW - LEFT	

FOR FURTHER DETAILS ON PAVEMENT MARKING REFER TO STANDARD SPECIFICATIONS FOR ROAD AND BRIDGE CONSTRUCTION AND STATE STANDARD 780001.

All dimensions are in millimeters (inches) unless otherwise shown.

REVISIONS	
NAME	DATE
EVERS	03-19-90
T. RAMMACHER	10-27-94
ALEX HOUSEH	10-09-96
ALEX HOUSEH	10-17-96
T. RAMMACHER	01-06-00

ILLINOIS DEPARTMENT OF TRANSPORTATION  
DISTRICT ONE  
TYPICAL PAVEMENT MARKINGS

SCALE: NONE  
DATE 10/18/2002  
DRAWN BY CADB  
CHECKED BY TC-13

REVISION DATE: 01/06/00

F.A. RTE.	SECTION	COUNTY	TOTAL SHEETS	SHEET NO.
344	2005-017 I	DU PAGE	15	13

STA. TO STA.

FED. ROAD DIST. NO. ILLINOIS FED. AID PROJECT

CONTRACT NO. 62940

PARTIAL RAMP CLOSURE DETAILS

SHOULDER CLOSURE DETAILS

REFLECTIVE 150 (6) EDGE LINE ON LOWER SLOPE OF WALL (LEFT EDGE YELLOW, RIGHT EDGE WHITE)

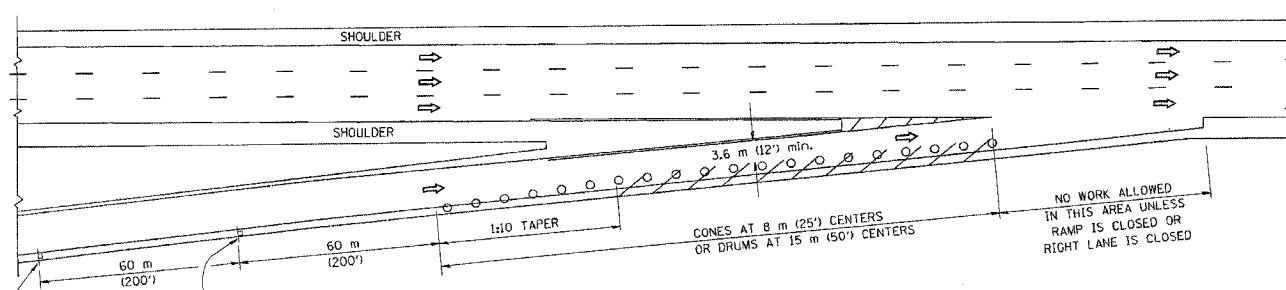

TYPICAL ENTRANCE RAMP

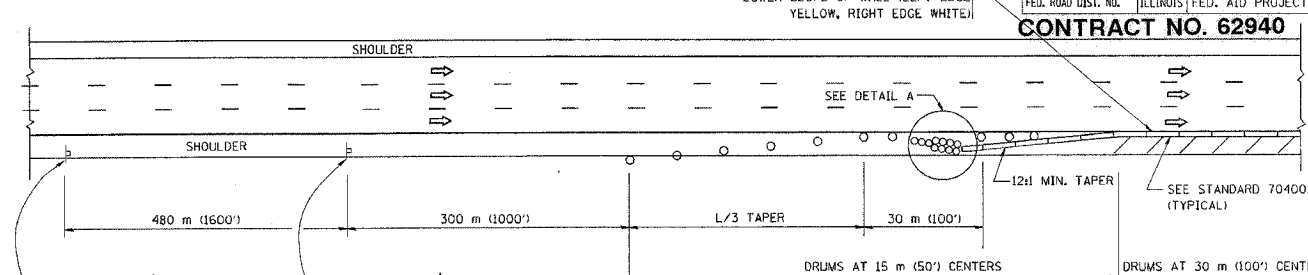

PERMANENT SHOULDER CLOSURE

OR WHEN SPECIFIED INSTALL TEMPORARY CONCRETE BARRIER WALL WITH BARRIER WALL REFLECTORS PER TRAFFIC CONTROL AND PROTECTION (EXPRESSWAYS)

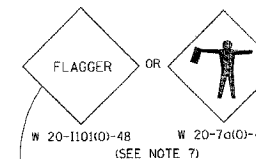

THIS DETAIL IS USED WHERE:  
1. VEHICLES, EQUIPMENT, WORKERS OR THEIR ACTIVITIES ENCR OACH IN AN AREA CLOSER THAN 4.5 m (15') TO THE EDGE OF PAVEMENT FOR A PERIOD IN EXCESS OF 15 MINUTES.

DAYTIME SHOULDER CLOSURE

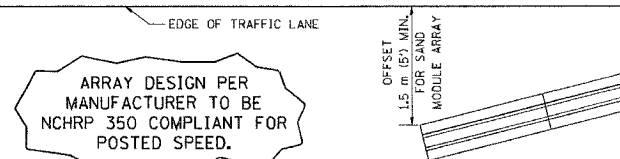

ARRAY DESIGN PER MANUFACTURER TO BE NCHRP 350 COMPLIANT FOR POSTED SPEED.

DETAIL "A"  
IMPACT ATTENUATOR, TEMPORARY  
(SEE NOTE 5)

ALL DIMENSIONS ARE IN MILLIMETERS (INCHES) UNLESS OTHERWISE SHOWN.

REVISIONS	
NAME	DATE
DWS	11/95
JAF	12/02
NCHRP 350	04/03
JAF	2/06

ILLINOIS DEPARTMENT OF TRANSPORTATION  
TRAFFIC CONTROL DETAILS  
FOR FREEWAY  
SHOULDER CLOSURES  
PARTIAL RAMP CLOSURES  
DESIGNED BY: DWS  
DRAWN BY  
CHECKED BY  
TC-17  
REVISION DATE: 02/28/06

SCALE: NONE  
DATE: 3/1/2006

PLOT DATE: 3/1/2006  
FILE NAME: K:\nchrdet\trc17.dgn  
PLOT SCALE: 500000 : 1 IN.  
USER NAME: jaf

SYMBOLS

- ARROWBOARD
- WORK AREA
- SIGN ON PORTABLE OR PERMANENT SUPPORT
- FLAGGER WITH CONTROL SIGN
- DRUM WITH MONO-DIRECTIONAL STEADY BURNING LIGHT
- CONES - 700 (28) IN HEIGHT

GENERAL NOTES

1. THE "L" DISTANCE EQUALS:  
SPEED LIMIT FORMULAS  
80 km/h (45 mph) METRIC ENGLISH  
OR GREATER:  $L=0.65(W)(S)$   $L=(W)(S)$   
W = WIDTH OF OFFSET IN METERS (FEET)  
S = NORMAL POSTED SPEED KM/H (MPH)
2. PLASTIC DRUMS WITH HIGH PERFORMANCE REFLECTIVE SHEETING AND STEADY BURNING LIGHTS ARE REQUIRED FOR ALL NIGHTTIME CLOSURES.
3. ALL SIGNS SHALL BE POST MOUNTED IF THE CLOSURE TIME EXCEEDS FOUR DAYS.
4. FLASHING LIGHTS SHALL BE USED DURING THE HOURS OF DARKNESS AND SHALL BE INSTALLED ABOVE THE FIRST TWO SETS OF SIGNS.
5. THE IMPACT ATTENUATOR, TEMPORARY IS NOT REQUIRED WHEN THE TEMPORARY CONCRETE BARRIER WALL IS PROTECTED BY OR IS TIED INTO THE EXISTING GUARDRAIL. IF OFFSET IS LESS THAN 5 FEET USE "TRAFFIC BARRIER TERMINAL, TYPE III, TEMPORARY" DEVICE TO MEET NCHRP 350 FOR POSTED SPEED.
6. AUTHORIZATION FROM THE DISTRICT'S BUREAU OF TRAFFIC IS REQUIRED FOR ALL FREEWAY CLOSURES.
7. THE FLAGGER AND FLAGGER SIGN ARE REQUIRED AT THE ABOVE WORK SITES WHEN:
  - a. FOUR OR MORE WORK VEHICLES ENTER THE TRAFFIC LANES IN A ONE HOUR PERIOD.
  - b. THE WORK ACTIVITY REQUIRES FREQUENT ENCR OACHMENT INTO THE LANE OPEN TO TRAFFIC.
 THE FLAGGER SHALL BE STATIONED APPROXIMATELY 30 m (100') TO 60 m (200') IN ADVANCE OF THE WORKERS.

CONTRACT NO.				
F.A. RTE.	SECTION	COUNTY	TOTAL SHEETS	SHEET NO.
214	2005-017	DuPage	15	14
STA.		TO STA.		
FED. ROAD DIST. NO. ILLINOIS FED. AID PROJECT				

**CONTRACT NO. 62940**

**SIGNING FOR FLAGGING OPERATIONS AT WORK ZONE OPENINGS**

**WORK ZONE EXIT OPENING**

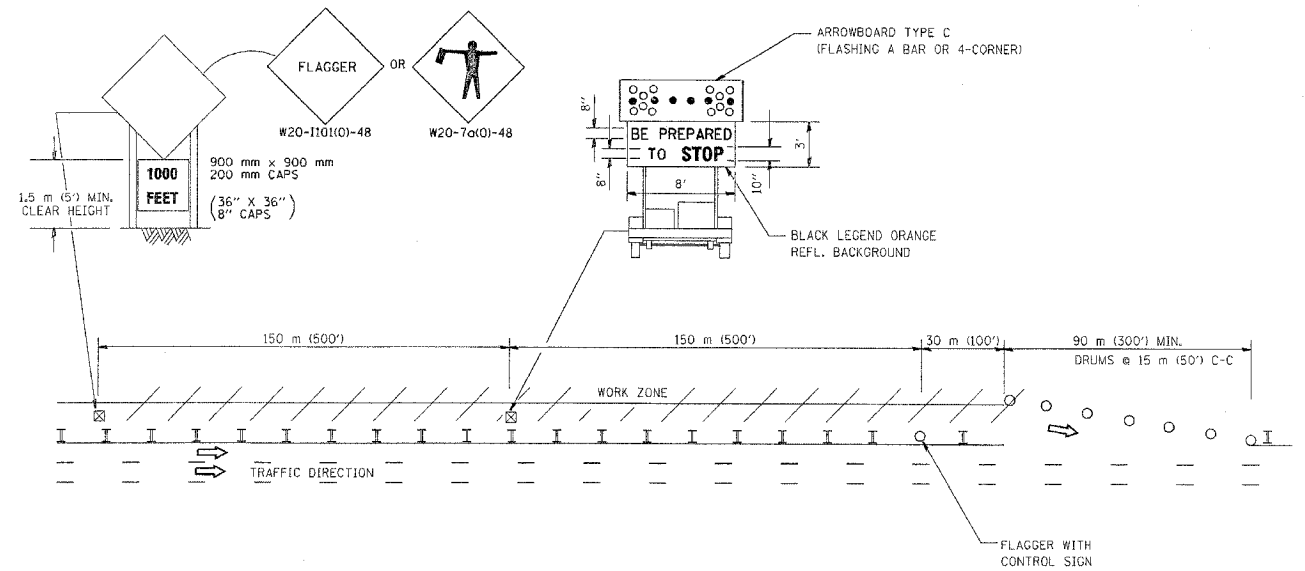

**WORK ZONE ENTRY OPENING**

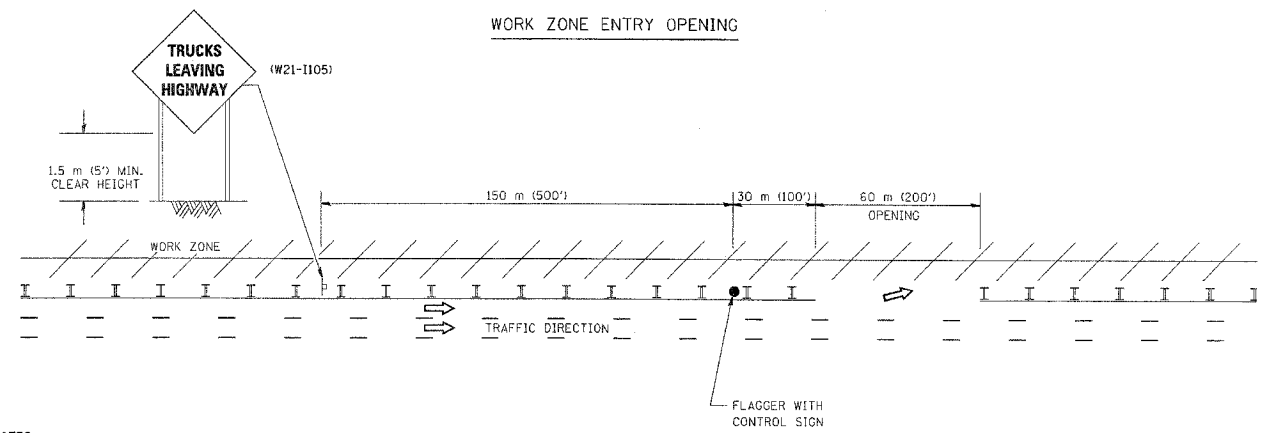

**NOTES:**

1. The Arrowboard, the Flagger Ahead trailer mounted sign, and the Trucks Leaving Highway sign shall be removed or turned away from traffic and the exit and entry openings shall be closed when the flagging operation ceases.
2. Work Zone Exit Openings should be a minimum of one half mile apart.
3. Exiting the work zone at any place other than at a Work Zone Exit Opening will be prohibited.
4. All vehicles shall enter the work zone at entry openings, using their turn signals to warn motorists

ALL DIMENSIONS ARE IN MILLIMETERS (INCHES) UNLESS OTHERWISE SHOWN

REVISIONS	
NAME	DATE
DWS	8/98
JAF	4/03
JAF	2/06

ILLINOIS DEPARTMENT OF TRANSPORTATION  
**SIGNING FOR FLAGGING OPERATIONS AT WORK ZONE OPENINGS**

SCALE: NONE  
DATE: 3/1/2006

DRAWN BY CADD  
CHECKED BY TC-18

REVISION DATE: 02/28/06

PLOT DATE = 2/1/2006  
PLOT SCALE = 50:1  
USER NAME = jaygo

**CONTRACT NO. 62940**

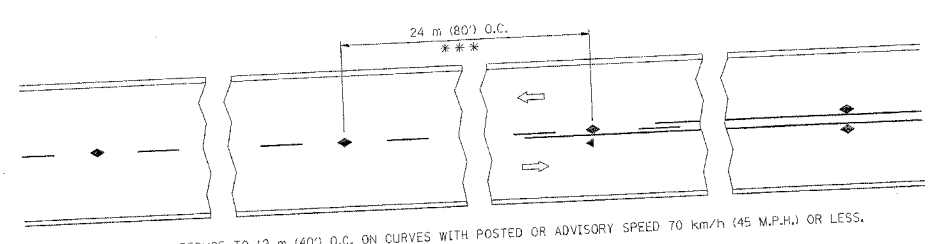

TWO-LANE/TWO-WAY

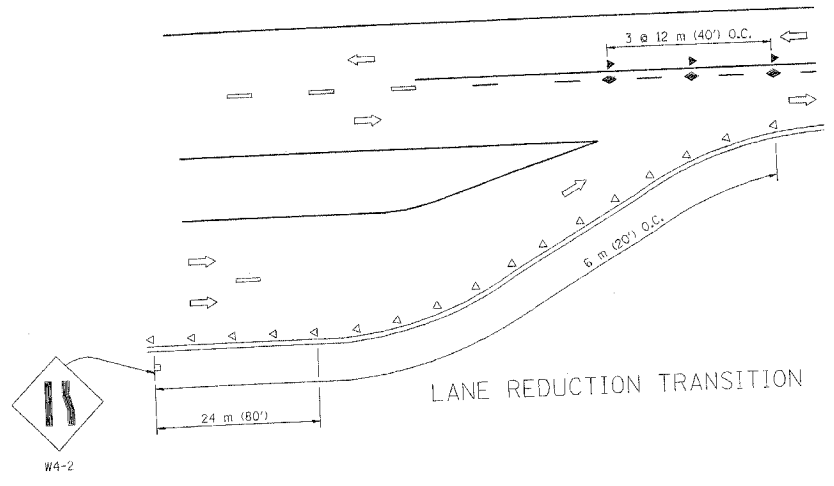

LANE REDUCTION TRANSITION

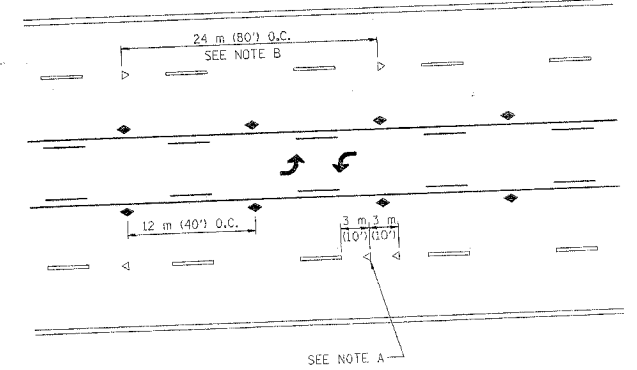

TWO-WAY LEFT TURN

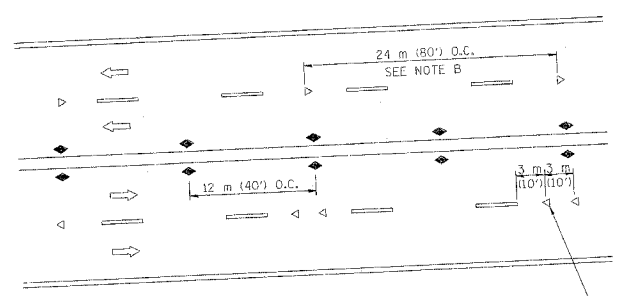

MULTI-LANE/UNDIVIDED

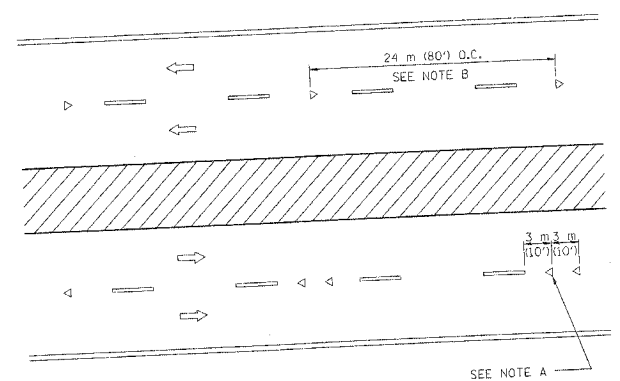

MULTI-LANE/DIVIDED

**GENERAL NOTES**

1. MARKERS USED WITH DASHED LINES SHALL BE CENTERED IN THE GAP BETWEEN SEGMENTS.
2. MARKERS USED ADJACENT TO SOLID LINES SHALL BE OFFSET 50 TO 75 (12 TO 31) TOWARD TRAFFIC AS SHOWN.
3. MARKERS THROUGH TANGENTS LESS THAN 150 m (500') IN LENGTH BETWEEN CURVES SHALL BE INSTALLED AT THE LESSER OF THE TWO CURVE SPACINGS.

**LANE MARKER NOTES**

- A. USE DOUBLE LANE LINE MARKERS SPACED AS SHOWN.
- B. REDUCE TO 12 m (40') O.C. ON CURVES WHERE ADVISORY SPEEDS ARE 20 km/h (10 M.P.H.) LOWER THAN POSTED SPEEDS.

**SYMBOLS**

- YELLOW STRIPE
- WHITE STRIPE
- ◄ ONE-WAY AMBER MARKER
- ◄ ONE-WAY CRYSTAL MARKER (W/O)
- ◆ TWO-WAY AMBER MARKER

**DESIGN NOTES**

1. DOUBLE LANE LINE MARKERS SHALL BE USED UNLESS SPECIFIED OTHERWISE.
2. EXCEPT AS SHOWN ON THE LANE REDUCTION TRANSITION AND FREEWAY EXIT RAMP DETAIL, MARKERS ARE NOT TO BE SPECIFIED ON RIGHT EDGE LINES.
3. THE EXACT MARKER LIMITS, SPACING, AND COLOR SHOULD BE INCLUDED IN THE PLANS.
4. MARKERS SHOULD NOT BE USED ALONGSIDE CURBS EXCEPT FOR EXTREMELY SHORT SECTIONS OF CURBS WHERE NOT MORE THAN TWO MARKERS WOULD BE INVOLVED.

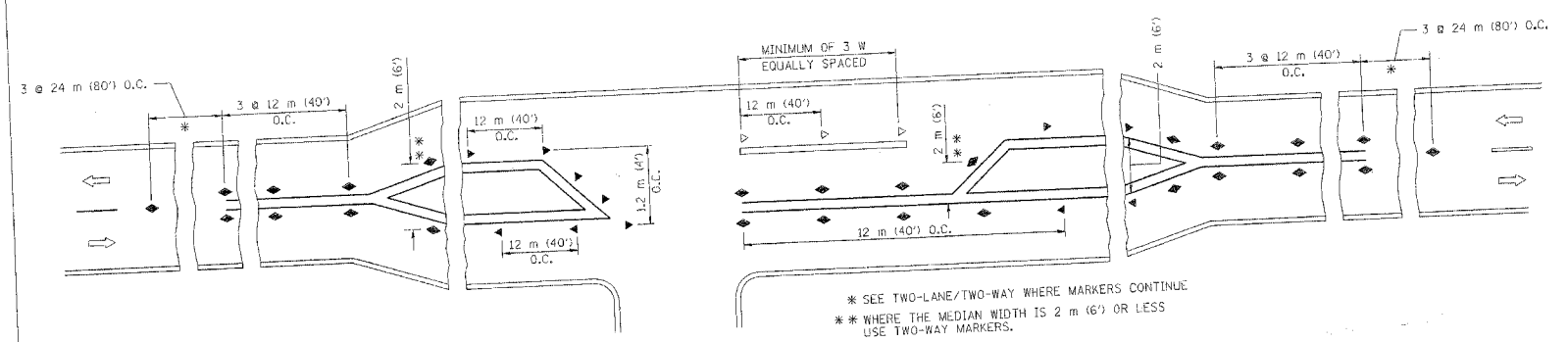

LEFT TURN

All dimensions are in millimeters (inches) unless otherwise shown.

ILLINOIS DEPARTMENT OF TRANSPORTATION  
**TYPICAL APPLICATIONS**  
**RAISED REFLECTIVE PAVEMENT MARKERS**  
**(SNOW-PLOW RESISTANT)**

REVISIONS	
NAME	DATE
T. RAMMACHER	09-19-94
T. RAMMACHER	03-12-99
T. RAMMACHER	01-06-00

SCALE: NONE  
 DATE: 10/18/2002

DRAWN BY CADD  
 CHECKED BY TC-11  
 REVISION DATE: 01/06/00