

F.A.P. RTE.	SECTION	COUNTY	TOTAL SHEETS	SHEET NO.
301	28BR-1	JO DAVIESS	53	8
STA.		TO STA.		
FED. ROAD DIST. NO.		ILLINOIS FED. AID PROJECT		

# HORIZONTAL VERTICAL CONTROL SHEETS

Chain US20@APPL contains:  
133 202

Beginning chain US20@APPL description

Point 133 N 2,060,183.3800 E 2,270,379.3120 Sta 1405+67.44

Course from 133 to 202 120° 31' 20.5224" Dist 6,780.7136'

Point 202 N 2,056,739.6272 E 2,276,220.4286 Sta 1473+48.15

Ending chain US20@APPL description

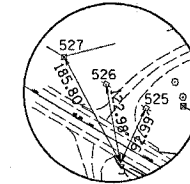

HORIZONTAL CONTROL POINT No. 3

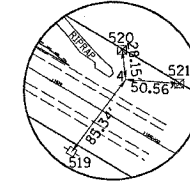

HORIZONTAL CONTROL POINT No. 4

## HORIZONTAL CONTROL POINTS

POINT	NORTH	EAST	ELEVATION	CHAIN	STATION	OFFSET	DESCRIPTION
3	2058938.58	2272440.44	645.961	US20	1429+75.17	25.5145' RT	NAIL
4	2058492.321	2273320.003	643.103	US20	1439+59.49	36.772' LT	NAIL

## SURVEY WORK POINTS

POINT	NORTH	EAST	ELEVATION	CHAIN	STATION	OFFSET	DESCRIPTION
128	2058485.45	2273260.197	644.154	US20	1439+11.46	0.4791' LT	POT
129	2058643.06	2272991.857	643.839	US20	1436+00.26	0.0339' RT	POT
130	2058787.64	2272746.002	643.359	US20	1433+15.04	0.3517' RT	POT
131	2058837.82	2272660.661	643.197	US20	1432+16.04	0.4676' RT	POT
132	2059566.24	2271426.3	722.984	US20	1417+82.78	0.1152' LT	POT
133	2060183.38	2270379.312	737.969	US20	1405+67.44	0.0000'	POT

## BENCH MARKS

POINT	NORTH	EAST	ELEVATION	CHAIN	STATION	OFFSET	DESCRIPTION
400	2058657.509	2273001.155	643.525	US20	1436+00.93	17.1352' LT	CHISELED SQUARE

## REFERENCE TIES

POINT	CHAIN	STATION	OFFSET	DESCRIPTION
519	US20	1439+50.12	47.5808' RT	POWER POLE
520	US20	1439+42.25	58.9958' LT	R.O.W. MARKER
521	US20	1440+04.42	59.1953' LT	R.O.W. MARKER
525	US20	1429+66.02	67.0285' LT	POWER POLE
526	US20	1428+94.52	66.9302' LT	POWER POLE
527	US20	1428+16.19	70.6476' LT	R.O.W. MARKER

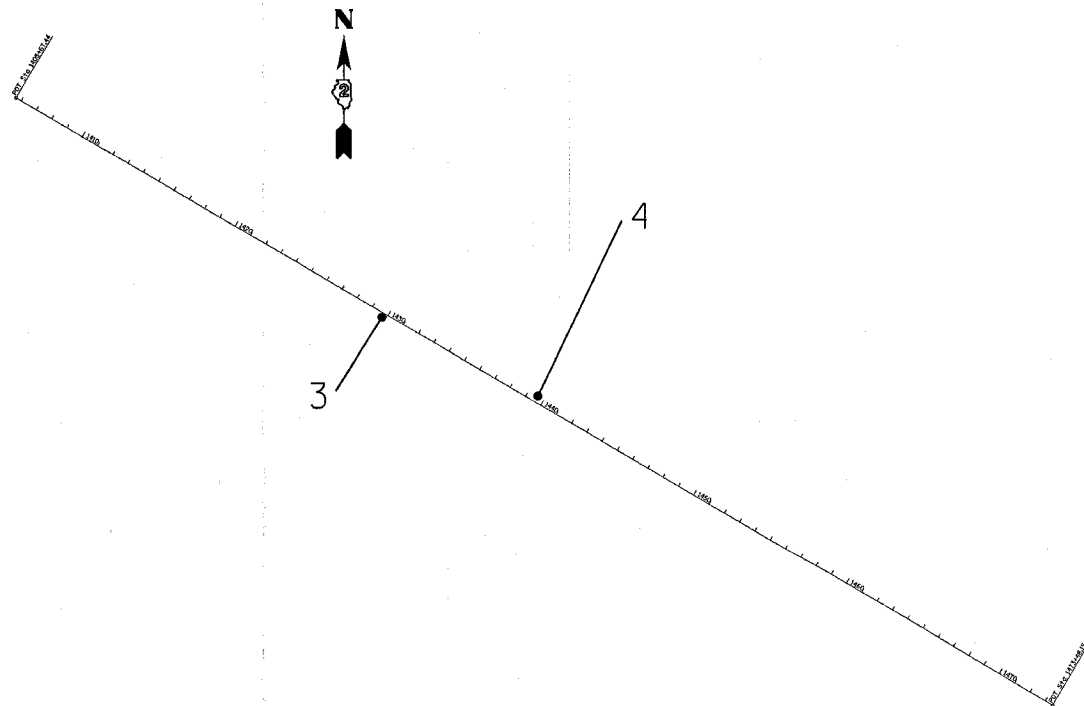

PLOT DATE = Thu Mar 30 07:54:25 2006  
 FILE NAME = c:\nrc\proj\1405200305\14052003hvc.dgn  
 USER NAME = meg11j

REVISIONS	
NAME	DATE

ILLINOIS DEPARTMENT OF TRANSPORTATION

SCALE: VERT.  
HORIZ.  
DATE

DRAWN BY  
CHECKED BY