

F.A.P. RTE.	SECTION	COUNTY	TOTAL SHEETS	SHEET NO.
549	117BR-M	OGLE	12	1

INDEX OF SHEETS

- Cover Sheet, Index of Sheets, Standards
- Summary of Quantities
- General Notes
- Roadway Plan
- Traffic Control Plan - Stage I
- Traffic Control Plan - Stage II
Bridge Plans
- General Plan and Elevation
- Deck Plan and Cross Section
- Partial Joint Plan
- Joint Details
- Type SM (Modified) Bridge Rail
- Bar Splicer Assembly Details
- 12A. STOP LINE SIGN FOR TEMPORARY SIGNALS

STATE OF ILLINOIS
DEPARTMENT OF TRANSPORTATION
DIVISION OF HIGHWAYS
**PROPOSED
HIGHWAY PLANS**

FAP ROUTE 549 (IL 72)

SECTION 117BR-M

OGLE COUNTY

D-92-025-06



Project Location
Structure No. 071-0068

C-92-133-06

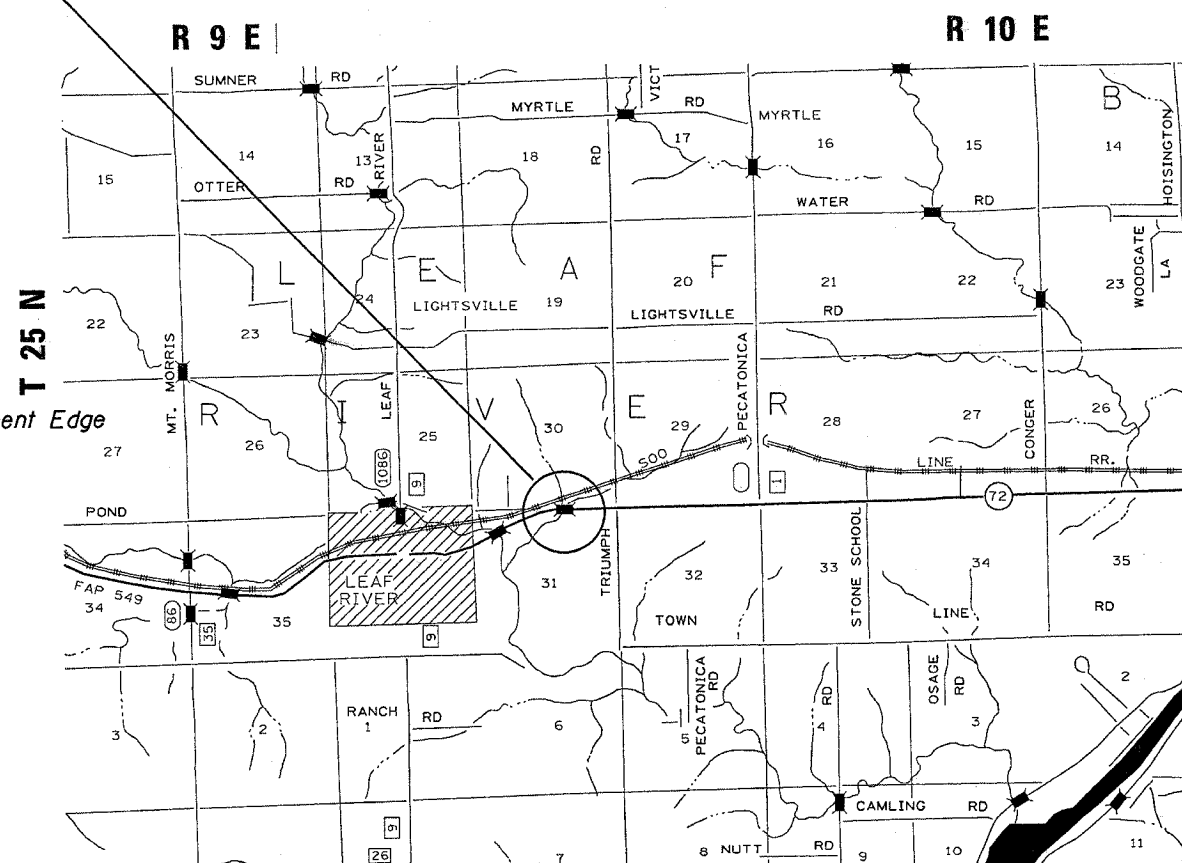

STANDARDS

- District Standard 99.4 Stop Line Sign for Temporary Signals
- 630001-06 Steel Plate Beam Guardrail
- 630301-03 Shoulder Widening for Type 1 (Special) Guardrail Terminals
- 631032-02 Traffic Barrier Terminal, Type 6A
- 635001 Delineators
- 635006-02 Reflector and Terminal Marker Placement
- 635011-01 Reflector Marker and Mounting Details
- 701006-02 Off-Road Operations, 2L, 2W, 4.5 m (15') to 600 mm (24") From Pavement Edge
- 701201-02 Lane Closure, 2L, 2W, Day Only, for Speeds > 45 MPH
- 701316-03 Lane Closure, 2L, 2W, Bridge Repair, for Speeds > 45 MPH
- 701321-08 Lane Closure, 2L, 2W, Bridge Repair with Barrier
- 702001-06 Traffic Control Devices
- 704001-02 Temporary Concrete Barrier

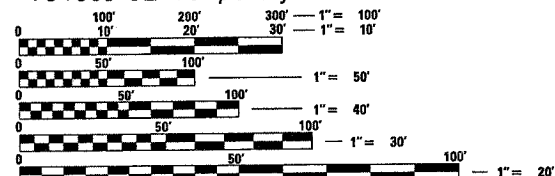

FULL SIZE PLANS HAVE BEEN PREPARED USING STANDARD ENGINEERING SCALES. REDUCED SIZED PLANS WILL NOT CONFORM TO STANDARD SCALES. IN MAKING MEASUREMENTS ON REDUCED PLANS, THE ABOVE SCALES MAY BE USED.

J.U.L.I.E.
JOINT UTILITY LOCATION INFORMATION FOR EXCAVATION
1-800-892-0123

STATE OF ILLINOIS
DEPARTMENT OF TRANSPORTATION
DIVISION OF HIGHWAYS

SUBMITTED March 27, 2006
Gregory D. Mountain
DEPUTY DIRECTOR OF HIGHWAYS, REGION ENGINEER

May 12, 2006
Mike Hine
ENGINEER OF DESIGN AND ENVIRONMENT

May 12, 2006
William R. Sees, P.E.
DIRECTOR OF HIGHWAYS, CHIEF ENGINEER

PRINTED BY THE AUTHORITY
OF THE STATE OF ILLINOIS