

F.A.P. RTE.	SECTION	COUNTY	TOTAL SHEETS	SHEET NO.
549	117BR-M	Ogle	12	5
STA.	TO STA.			
FED. ROAD DIST. NO.	ILLINOIS	FED. AID PROJECT		

Traffic Control Plan

Stage I

Refer to Traffic Control & Protection Std 701321 for additional requirements.

Proposed Sequence of Operations

1. Install Stage I Std 701321
2. Build Stage I Deck Overlay and Bridge Rail
3. Remove Barrier Wall and Install Stage I Std 701316
4. Construct Furnished Excavation, Guardrail, and Temporary Ramps
5. Remove Std 701316 and Install Std 701321 for Stage II
6. Build Stage II Deck Overlay and Guardrail
7. Remove Barrier Wall and Install Stage II Std 701316
8. Construct Furnished Excavation, Guardrail, and Temporary Ramps
9. Remove Standard 701316
10. Complete Project using Standard 701201

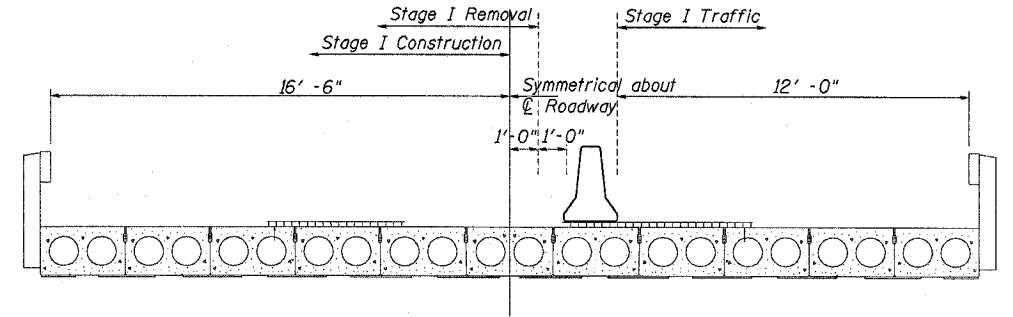

CROSS SECTION
(Looking East)

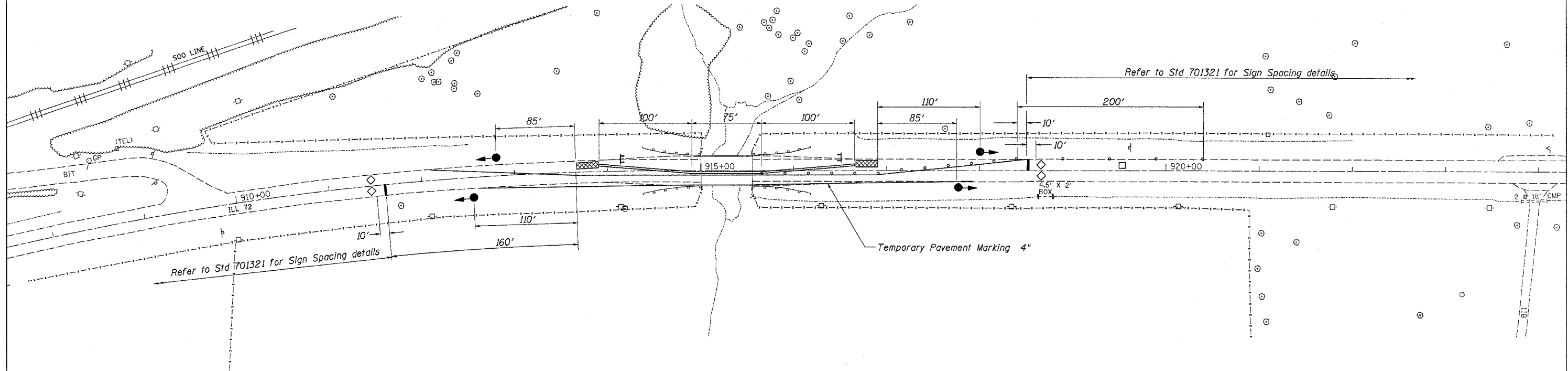

Temporary Bridge Traffic Signals	
	Each
Standard 701321	1
Total	1

Temporary Concrete Barrier	
	Foot
Standard 701321	275
Total	275

Pavement Marking Tape, Type III 24"	
	Foot
Stop Bars	24
Total	24

Short Term Pavement Marking	
	Foot
Post Stage II	64
Total	64

Traffic Control & Protection Std 701321	
	Each
Entire Project	1
Total	1

Temporary Impact Attenuators	
	Each
Standard 701321	2
Total	2

Temporary Pavement Marking 4"	
	Foot
Sta 912+05 to 918+50 Stage I	1290
Sta 912+05 to 918+50 Stage II	1290
Total	2580

Pavement Marking Removal	
	Sq Ft
Stage I	100
Stage II	50
Total	150

Traffic Control Plan
Illinois Route 72 over Tributary to Mud Creek
FAP Route 549
Section 117BR-M
Ogle County
Structure No. 071-0068

PLOT DATE = Wed Mar 22 09:13:59 2006
 FILE NAME = D:\v\volens\Ogle County\0710068\0710068.dgn
 PLOT SCALE = 1/8"=1'-0"
 USER NAME = [unreadable]