

F.A.P. RTE.	SECTION	COUNTY	TOTAL SHEETS	SHEET NO.
315	55-2	McDONOUGH	1025	81
STA. 117+00		TO STA. 139+00		
FED. ROAD DIST. NO. 4 ILLINOIS FED. AID PROJECT				

DIRECTION OF TRAFFIC FLOW

TYPE III BARRICADE

ROAD CLOSURE

- CONSTRUCTION:
1. INSTALL SIGNING AND PAVEMENT STRIPING. SHIFT TRAFFIC TO CROSSOVER AND NEW PAVEMENT.
  2. REMOVE U.S. ROUTE 136 PAVEMENT.
  3. COMPLETE SHOULDER ON EASTBOUND LANES. STA. 133+50 TO STA. 141+00
  4. CONSTRUCT PERMANENT DRAINAGE.
  5. CONSTRUCT DRIVEWAYS.

TRAFFIC:  
1. TRAFFIC MOVED TO NEW PAVEMENT AND U.S. ROUTE 136 (RELOCATED).

TRAFFIC CONTROL  
HIGHWAY STANDARD:  
701006

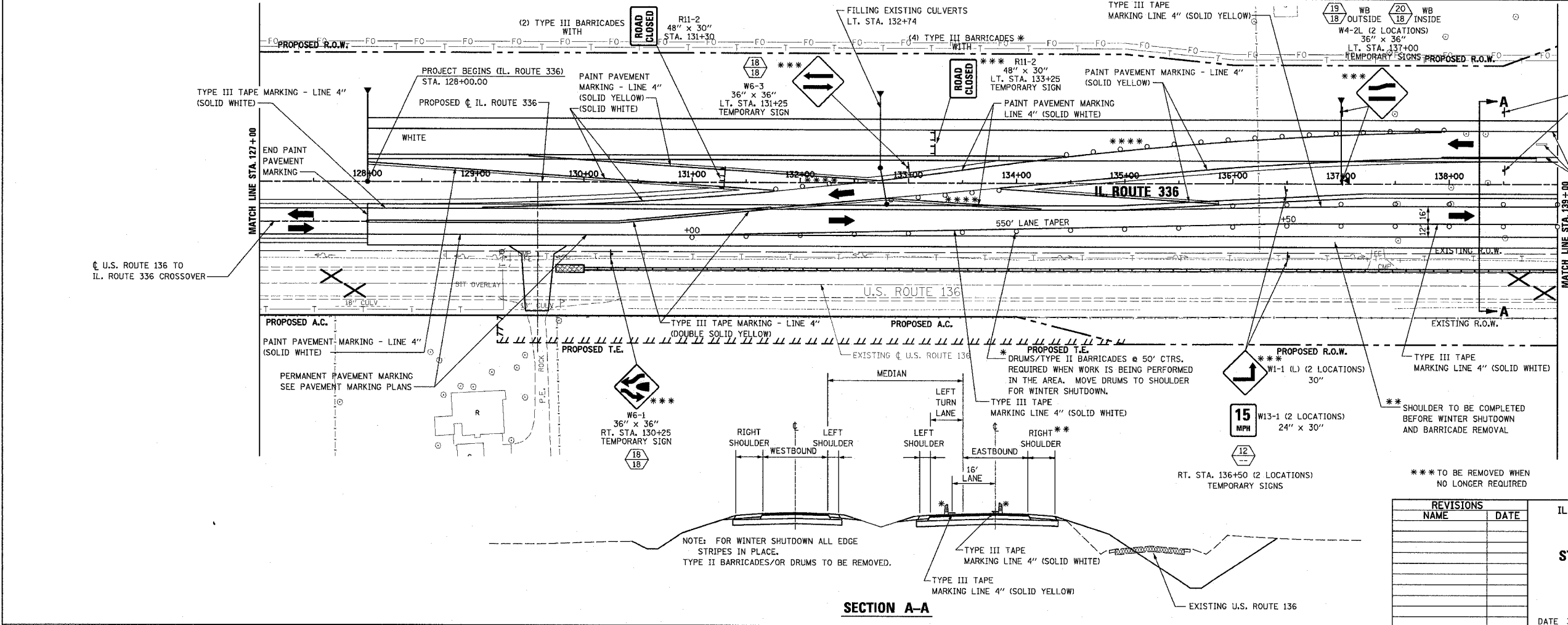
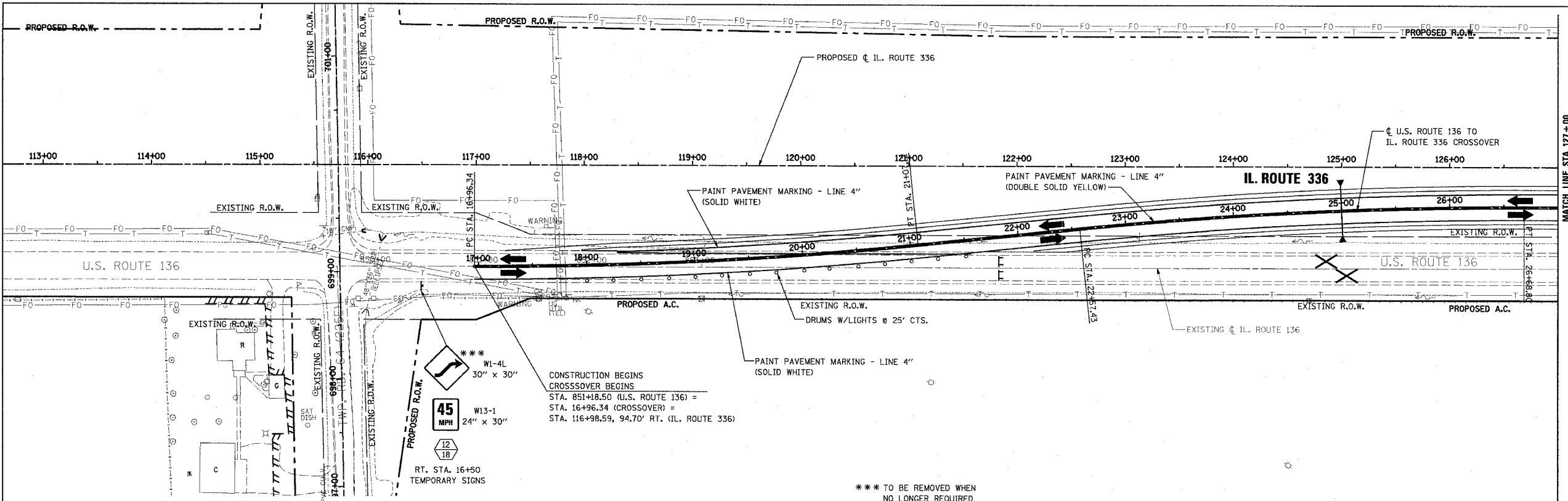

- W9-1 (2 LOCATIONS) 36" x 36" LT. STA. 138+50 TEMPORARY SIGNS
- W4-2L (2 LOCATIONS) 36" x 36" LT. STA. 137+00 TEMPORARY SIGNS
- W18/19 WB OUTSIDE
- W18/19 WB INSIDE
- PERMANENT PAVEMENT MARKING SEE PAVEMENT MARKING PLANS

NOTE:  
USE TYPE III TAPE ON FINAL SURFACE OF 4 LANE PAVEMENT WHERE PAVEMENT MARKING CONFLICTS WITH THERMOPLASTIC PAVEMENT MARKINGS.

\*\*\*\* DRUMS @ 25' CTRS. AND TYPE III TAPE MARKING LINE AS REQUIRED

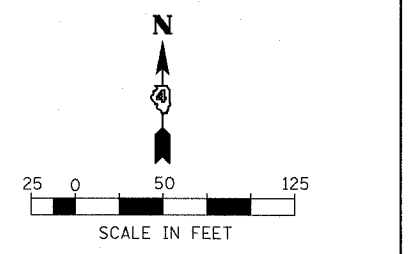

REVISIONS	
NAME	DATE

ILLINOIS DEPARTMENT OF TRANSPORTATION

**MAINTENANCE OF TRAFFIC**

**STAGE I - PHASE 2 AND STAGE II**

**IL. ROUTE 336**

**STA. 117+00 TO STA. 139+00**

DRAWN BY

CHECKED BY

DATE 3/30/06

SECTION A-A