

F.A.P. R.T.E.	SECTION	COUNTY	TOTAL SHEETS	SHEET NO.
315	55-2	McDONOUGH	1025	91
STA. 120+00		TO STA. 135+00		
FED. ROAD DIST. NO. 4 ILLINOIS FED. AID PROJECT				

PROP. CURVE SP2 DATA
 PI STA. = 15+25.36
 $\Delta = 2^\circ 57' 54''$ (LT)
 $D = 0^\circ 59' 16''$
 $R = 5,800.00'$
 $T = 150.10'$
 $L = 300.14'$
 $E = 1.94'$
 P.C. STA. = 13+75.25
 P.T. STA. = 16+75.39

PROP. SPIRAL SP2B DATA
 PI STA 12+78.59
 $f_s = 1^\circ 25' 56.62''$
 $L_s = 290.00'$
 $R_c = 5,800.00'$
 $D_c = 0^\circ 59' 16.29''$
 $Y_s = 2.42'$
 $X_s = 289.98'$
 $P = 0.60$
 $K = 145.00'$
 $LT = 193.34'$
 $ST = 96.67'$
 TS STA 10+85.25
 SC STA 13+75.25

PROP. SPIRAL SP2A DATA
 PI STA 17+27.07
 $f_s = 1^\circ 25' 56.62''$
 $L_s = 290.00'$
 $R_c = 5,800.00'$
 $D_c = 0^\circ 59' 16.29''$
 $Y_s = 2.42'$
 $X_s = 289.98'$
 $P = 0.60$
 $K = 145.00'$
 $LT = 193.34'$
 $ST = 96.67'$
 CS STA 16+75.39
 ST STA 19+65.39

PROP. SPIRAL SP3B DATA
 PI STA 23+81.09
 $f_s = 1^\circ 25' 56.62''$
 $L_s = 290.00'$
 $R_c = 5,800.00'$
 $D_c = 0^\circ 59' 16.29''$
 $Y_s = 2.42'$
 $X_s = 289.98'$
 $P = 0.60$
 $K = 145.00'$
 $LT = 193.34'$
 $ST = 96.67'$
 TS STA 21+87.75
 SC STA 24+77.75

PROP. CURVE SP3 DATA
 PI STA. = 26+26.01
 $\Delta = 2^\circ 55' 43''$ (LT)
 $D = 0^\circ 59' 16''$
 $R = 5,800.00'$
 $T = 148.26'$
 $L = 296.45'$
 $E = 1.89'$
 P.C. STA. = 24+77.75
 P.T. STA. = 27+74.20

MAINTENANCE OF TRAFFIC STAGING FOR RAILROAD BRIDGE CONSTRUCTION

1. CONSTRUCT EMBANKMENT AND SUB-BALLAST FOR SHOO-FLY ALIGNMENT.
2. CONSTRUCT SHOO-FLY BALLAST AND RAIL (BY OTHERS).
3. ACTIVATE SHOO-FLY.
4. CONSTRUCT DRAINAGE DITCH FROM MAINLINE IL. ROUTE 336 LT. STA. 535+00 TO MAINLINE IL. ROUTE 336 LT. STA. 543+50 AND RAMP J DITCH RT. STA. 150+00 TO RAMP J RT. STA. 158+00. (INCLUDING TEMPORARY DITCH AS NEEDED)
5. REMOVE BNSF MAINLINE TRACK AT PROPOSED BRIDGE LOCATIONS (BY OTHERS).
6. EXCAVATE RECEIVING PIT FOR PIPE JACKING.
7. CONSTRUCT JACKED 24" STEEL PIPE UNDER SHOO-FLY.
8. CONSTRUCT RAILROAD BRIDGES.
9. CONSTRUCT BNSF MAINLINE TRACK (BY OTHERS).
10. ACTIVATE BNSF MAINLINE TRACK OVER BRIDGES.
11. REMOVE SHOO-FLY TURNOUTS (BY OTHERS).
12. REMOVE SHOO-FLY TRACKS AND BALLAST.
13. EXCAVATE FOR RAMP CONSTRUCTION.
14. CONSTRUCT RAMPS AND PERMANENT DRAINAGE.

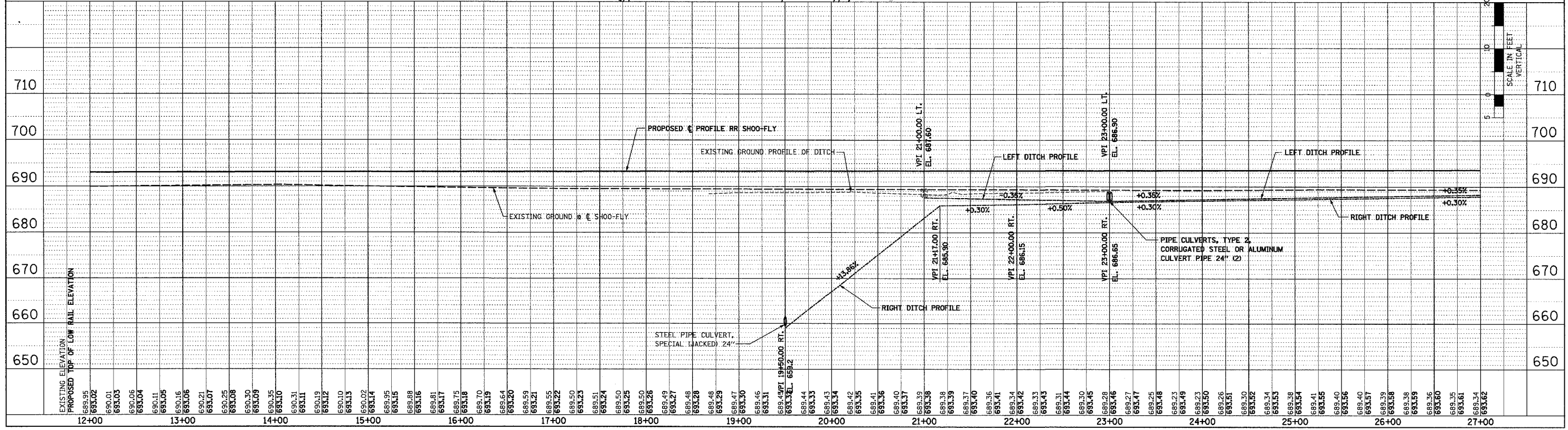

MAINTENANCE OF TRAFFIC - PLAN AND PROFILE - RAILROAD SHOO-FLY - IL. ROUTE 336 - STA. 12+00 TO STA. 27+00

PLAN	REVISION	DATE
NO.	BY	
1		

PROFILE	REVISION	DATE
NO.	BY	
1		

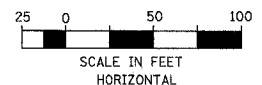

DATE PLOTTED: 08/13/2008 10:00 AM