

F.A.P. RTE.	SECTION	COUNTY	TOTAL SHEETS	SHEET NO.
315	55-2	McDONOUGH	1025	103
STA. 305+00		TO STA. 329+00		
FED. ROAD DIST. NO. 4 ILLINOIS FED. AID PROJECT				

③ TREE REMOVAL, ACRES  
LT. STA. 305+00 TO LT. STA. 306+15  
RT. STA. 316+10 TO RT. STA. 317+00

④ FENCE REMOVAL  
RT. STA. 312+47 TO LT. STA. 314+42

③ TREE REMOVAL, ACRES  
RT. STA. 317+00 TO LT. STA. 318+70  
RT. STA. 321+40 TO LT. STA. 322+60

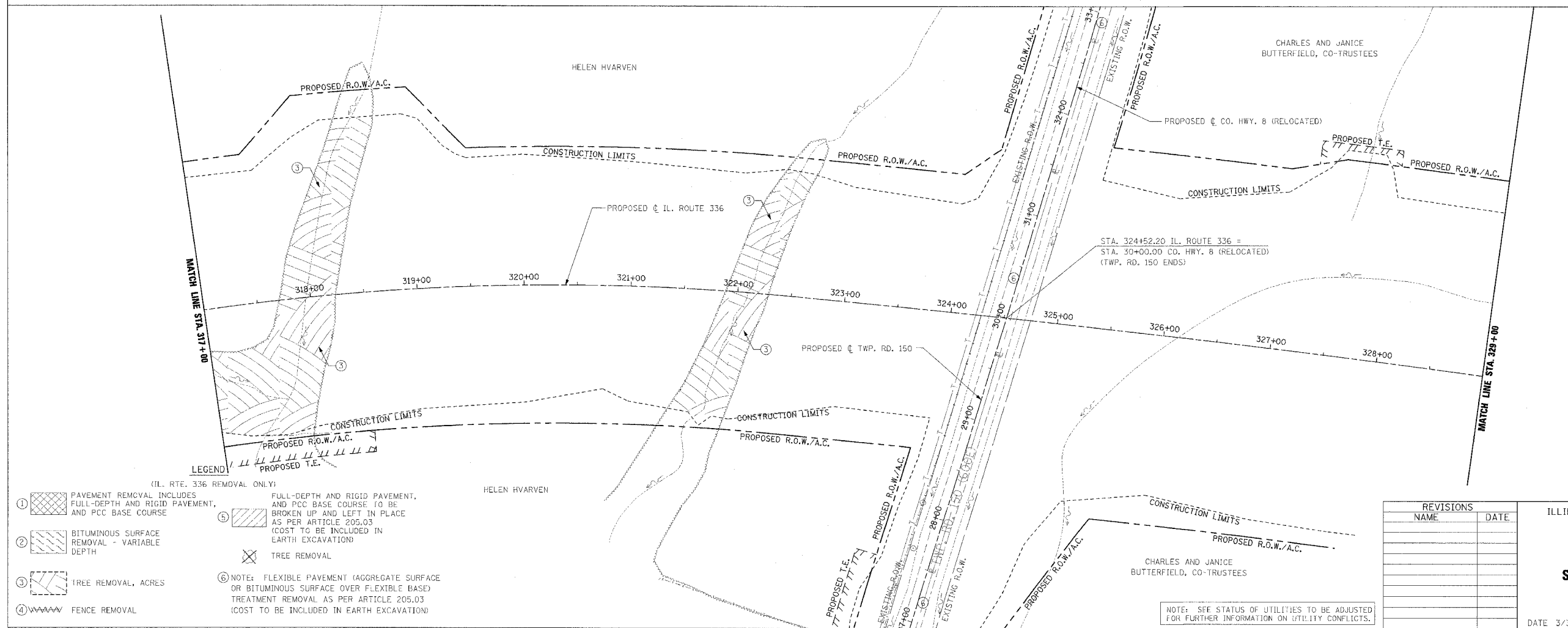
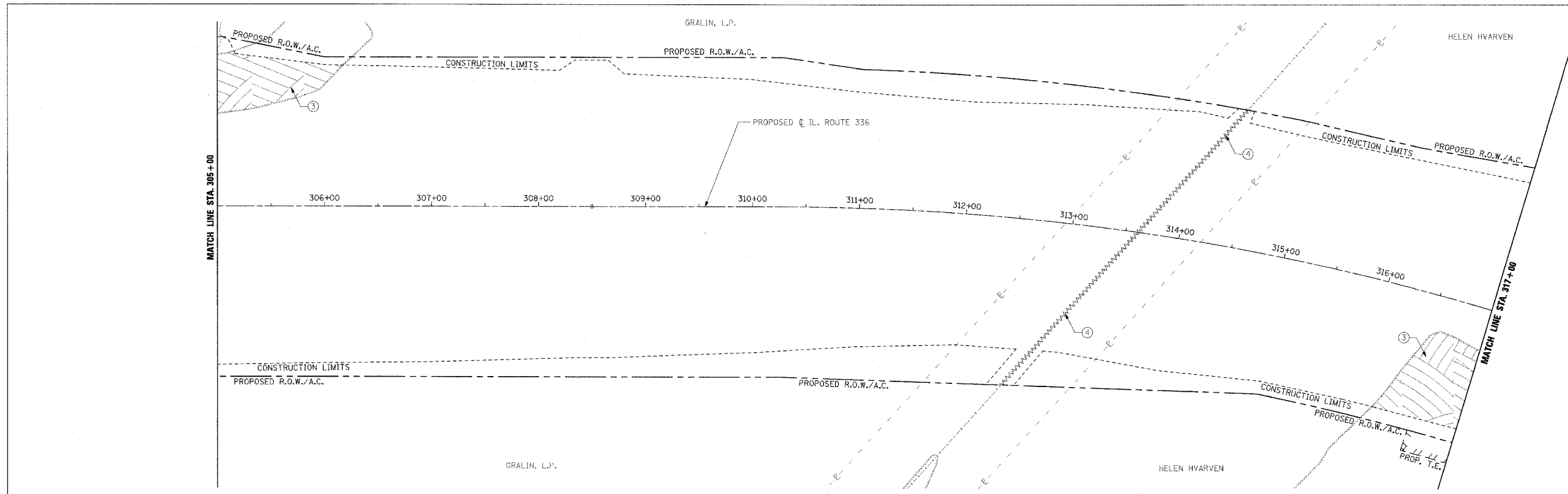

- LEGEND
- ① [Symbol] PAVEMENT REMOVAL INCLUDES FULL-DEPTH AND RIGID PAVEMENT, AND PCC BASE COURSE
  - ② [Symbol] BITUMINOUS SURFACE REMOVAL - VARIABLE DEPTH
  - ③ [Symbol] TREE REMOVAL, ACRES
  - ④ [Symbol] FENCE REMOVAL
  - ⑤ [Symbol] FULL-DEPTH AND RIGID PAVEMENT, AND PCC BASE COURSE TO BE BROKEN UP AND LEFT IN PLACE AS PER ARTICLE 205.03 (COST TO BE INCLUDED IN EARTH EXCAVATION)
  - [Symbol] TREE REMOVAL
  - ⑥ NOTE: FLEXIBLE PAVEMENT (AGGREGATE SURFACE OR BITUMINOUS SURFACE OVER FLEXIBLE BASE) TREATMENT REMOVAL AS PER ARTICLE 205.03 (COST TO BE INCLUDED IN EARTH EXCAVATION)

REVISIONS	
NAME	DATE

ILLINOIS DEPARTMENT OF TRANSPORTATION

**REMOVAL ITEMS**  
**IL ROUTE 336**  
**STA. 305+00 TO STA. 329+00**

DATE 3/30/06

DRAWN BY \_\_\_\_\_  
CHECKED BY \_\_\_\_\_

NOTE: SEE STATUS OF UTILITIES TO BE ADJUSTED FOR FURTHER INFORMATION ON UTILITY CONFLICTS.