

F.A.P. RTE.	SECTION	COUNTY	TOTAL SHEETS	SHEET NO.
315	55-2	MCDONOUGH	1025	105
STA. 353+00		TO STA. 375+00		
FED. ROAD DIST. NO. 4		ILLINOIS FED. AID PROJECT		

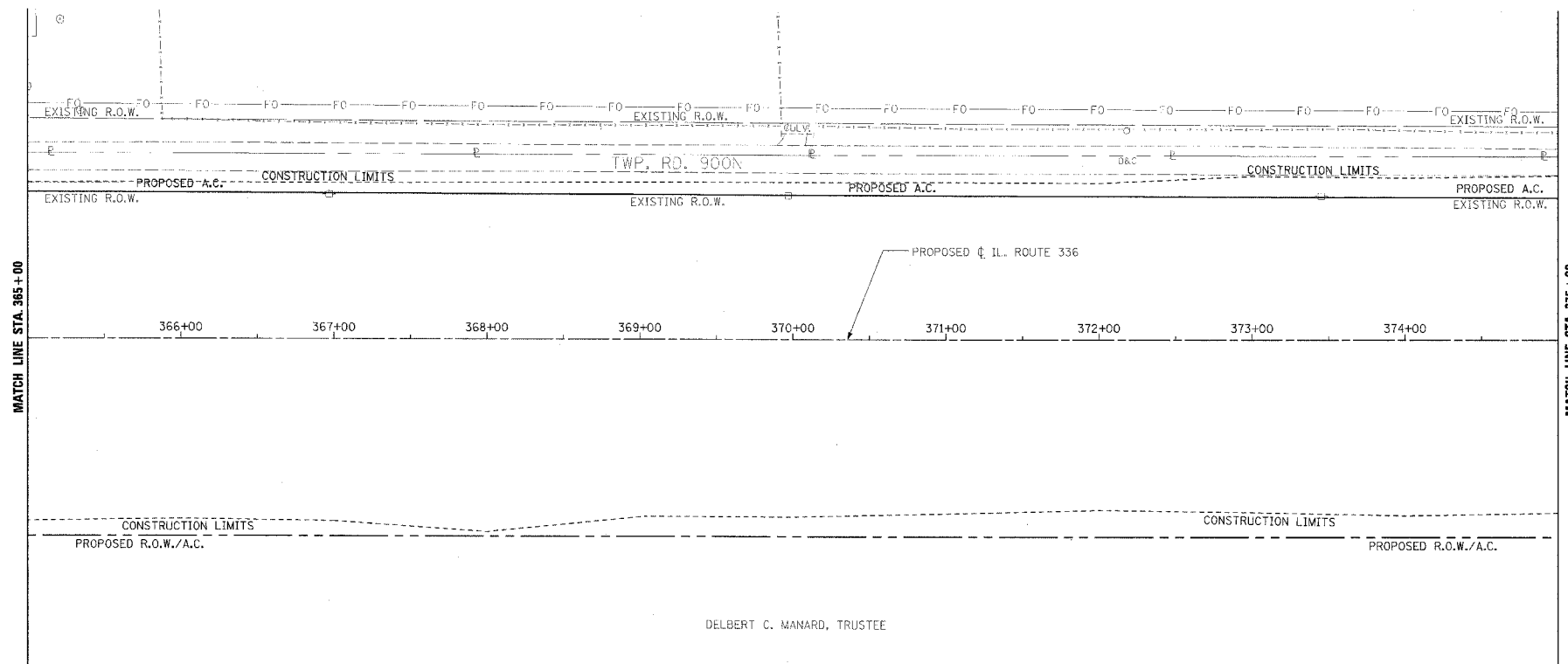
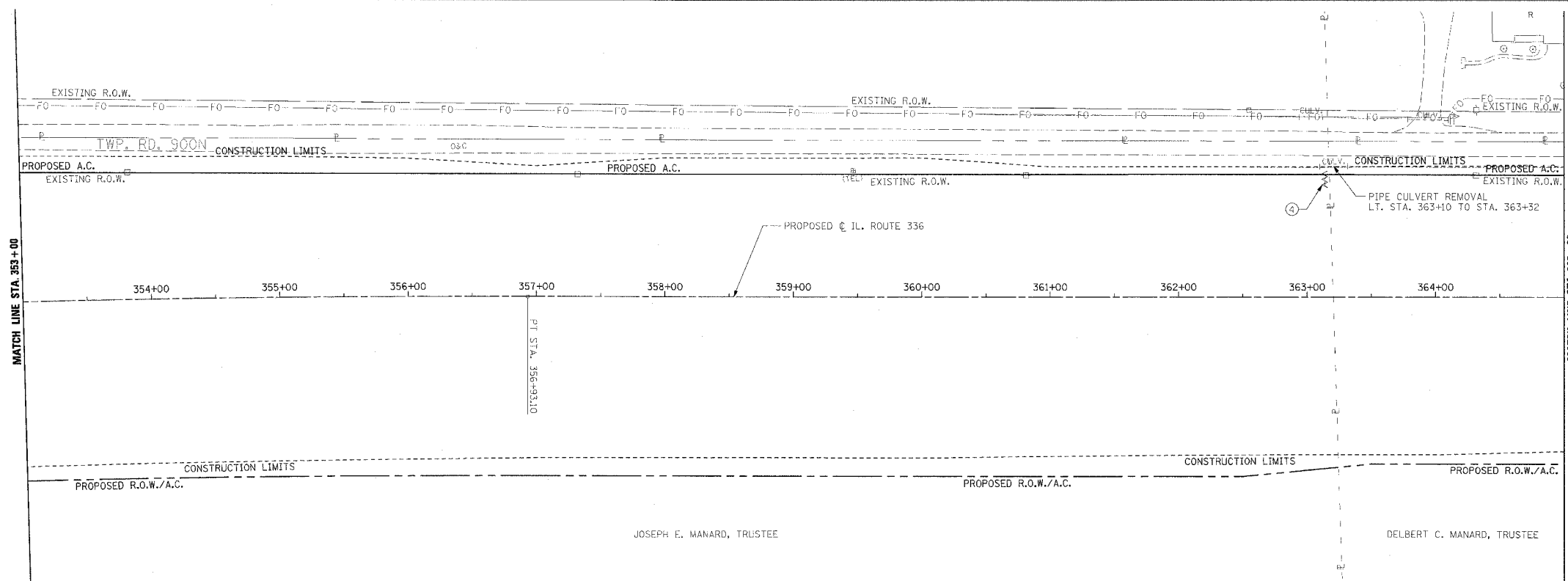

**LEGEND**

- ① [Symbol] PAVEMENT REMOVAL INCLUDES FULL-DEPTH AND RIGID PAVEMENT, AND PCC BASE COURSE
- ② [Symbol] BITUMINOUS SURFACE REMOVAL - VARIABLE DEPTH
- ③ [Symbol] TREE REMOVAL, ACRES
- ④ [Symbol] FENCE REMOVAL
- ⑤ [Symbol] FULL-DEPTH AND RIGID PAVEMENT, AND PCC BASE COURSE TO BE BROKEN UP AND LEFT IN PLACE AS PER ARTICLE 205.03 (COST TO BE INCLUDED IN EARTH EXCAVATION)
- ⑥ [Symbol] TREE REMOVAL
- ⑦ [Symbol] NOTE: FLEXIBLE PAVEMENT (AGGREGATE SURFACE OR BITUMINOUS SURFACE OVER FLEXIBLE BASE) TREATMENT REMOVAL AS PER ARTICLE 205.03 (COST TO BE INCLUDED IN EARTH EXCAVATION)

NOTE: SEE STATUS OF UTILITIES TO BE ADJUSTED FOR FURTHER INFORMATION ON UTILITY CONFLICTS.

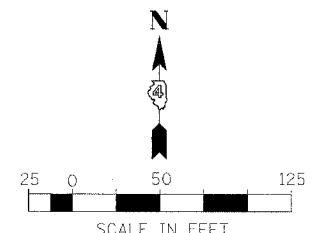

REVISIONS	
NAME	DATE

ILLINOIS DEPARTMENT OF TRANSPORTATION  
**REMOVAL ITEMS**  
**IL. ROUTE 336**  
**STA. 353+00 TO STA. 375+00**  
 DATE: 3/30/06  
 DRAWN BY: \_\_\_\_\_  
 CHECKED BY: \_\_\_\_\_