

F.A.P. SECTION	COUNTY	TOTAL SHEETS	SHEET NO.
315 55-2	McDONOUGH	1025	117
STA. 23+00 TO STA. 36+00			
FED. ROAD DIST. NO. 4 ILLINOIS		FED. AID PROJECT	

① PAVEMENT REMOVAL (EST. 16" DEPTH)
RT. STA. 23+00 TO STA. 31+74.65

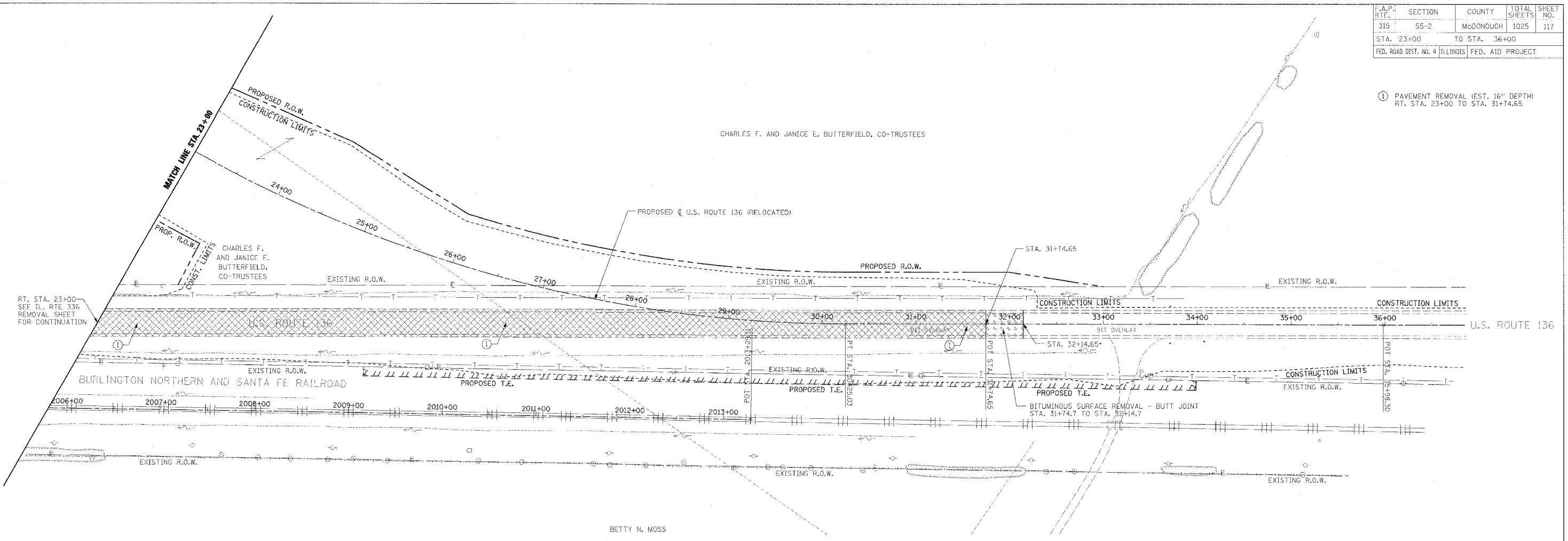

- LEGEND**
- (U.S. RTE. 136 (RELOCATED) REMOVAL ONLY)
- ① [Cross-hatched symbol] PAVEMENT REMOVAL INCLUDES FULL-DEPTH AND RIGID PAVEMENT, AND PCC BASE COURSE
 - ② [Wavy symbol] BITUMINOUS SURFACE REMOVAL - VARIABLE DEPTH
 - ③ [Dotted symbol] TREE REMOVAL, ACRES
 - ④ [Wavy symbol] FENCE REMOVAL
 - ⑤ [Diagonal lines symbol] FULL-DEPTH AND RIGID PAVEMENT, AND PCC BASE COURSE TO BE BROKEN UP AND LEFT IN PLACE AS PER ARTICLE 205.03 (COST TO BE INCLUDED IN EARTH EXCAVATION)
 - ⑥ [Cross-hatched symbol] TREE REMOVAL
 - ⑦ [Dotted symbol] NOTE: FLEXIBLE PAVEMENT (AGGREGATE SURFACE OR BITUMINOUS SURFACE OVER FLEXIBLE BASE) TREATMENT REMOVAL AS PER ARTICLE 205.03 (COST TO BE INCLUDED IN EARTH EXCAVATION)

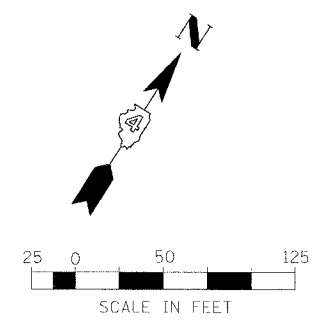

REVISIONS	
NAME	DATE

ILLINOIS DEPARTMENT OF TRANSPORTATION

REMOVAL PLAN
U.S. ROUTE 136 (RELOCATED)
STA. 23+00.00 TO STA. 36+00

DATE 3/30/06

DRAWN BY
CHECKED BY