

F.A.P. RTE.	SECTION	COUNTY	TOTAL SHEETS	SHEET NO.
315	55-2	McDONOUGH	1025	412
STA. 18+50.00		TO STA. 33+50.00		
FED. ROAD DIST. NO. 4 ILLINOIS FED. AID PROJECT				

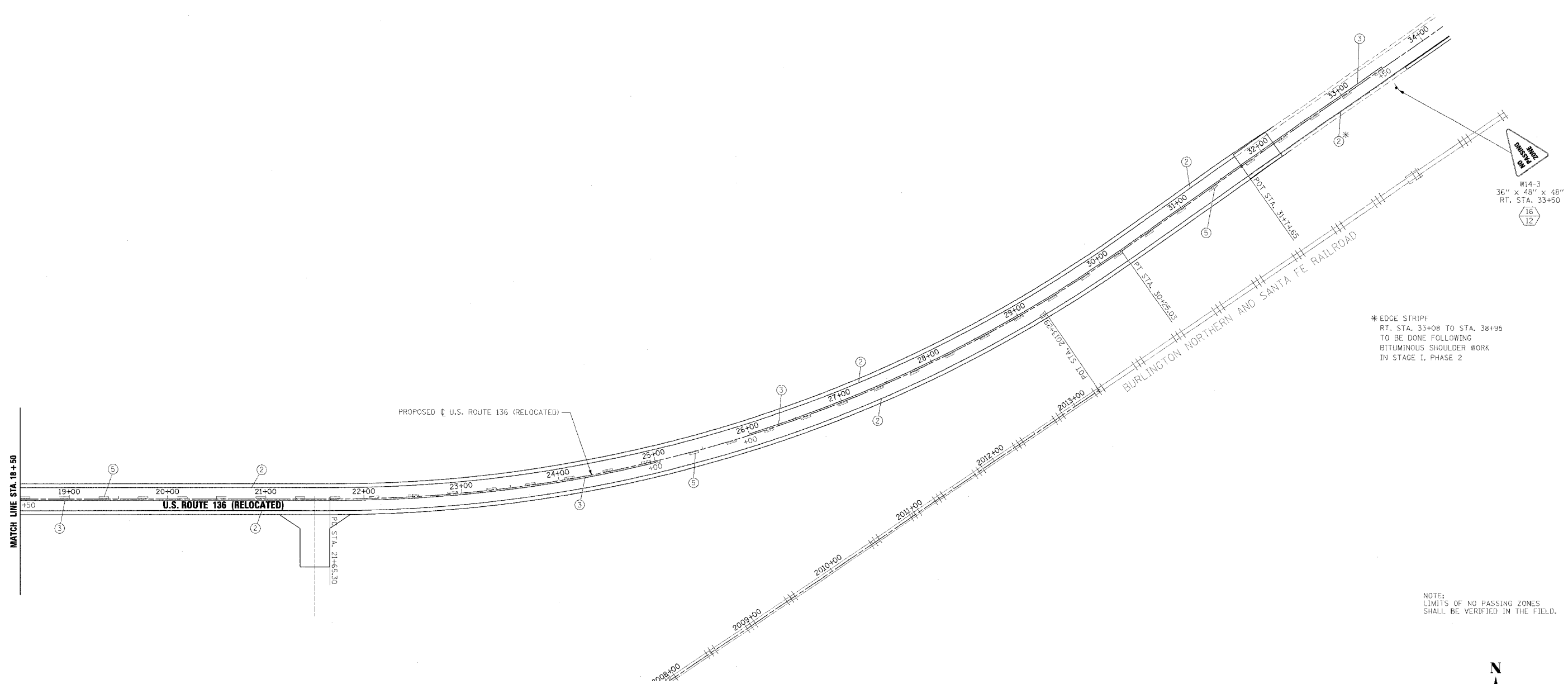

\* EDGE STRIP  
 RT. STA. 33+08 TO STA. 38+95  
 TO BE DONE FOLLOWING  
 BITUMINOUS SHOULDER WORK  
 IN STAGE 1, PHASE 2

NOTE:  
 LIMITS OF NO PASSING ZONES  
 SHALL BE VERIFIED IN THE FIELD.

PAVEMENT MARKING LEGEND	
①	EPOXY PAVEMENT MARKING - LETTERS AND SYMBOLS
②	EPOXY PAVEMENT MARKING - LINE 4" WHITE SOLID
③	EPOXY PAVEMENT MARKING - LINE 4" YELLOW SOLID
④	EPOXY PAVEMENT MARKING - LINE 4" YELLOW SOLID (DOUBLE LINE)
⑤	EPOXY PAVEMENT MARKING - LINE 4" YELLOW SKIP DASH
⑥	PREFORMED PLASTIC PAVEMENT MARKING - LINE 6" WHITE SKIP DASH
⑦	EPOXY PAVEMENT MARKING - LINE 8" WHITE SOLID
⑧	EPOXY PAVEMENT MARKING - LINE 8" WHITE SKIP DASH
⑨	EPOXY PAVEMENT MARKING - LINE 12" WHITE SOLID
⑩	EPOXY PAVEMENT MARKING - LINE 12" YELLOW SOLID
⑪	EPOXY PAVEMENT MARKING - LINE 24" WHITE SOLID (STOP BAR)

RAISED REFLECTIVE PAVEMENT MARKERS (RRPM) LEGEND	
①	▲ ONE-WAY CRYSTAL MARKER AT 80' CENTERS
②	▲ ONE-WAY CRYSTAL MARKER AT 40' CENTERS
③	▲ ONE-WAY CRYSTAL MARKER AT 20' CENTERS
④	▲ ONE-WAY AMBER MARKER AT 40' CENTERS
⑤	▲ ONE-WAY AMBER MARKER AT 20' CENTERS
⑥	◆ TWO-WAY AMBER MARKER AT 40' CENTERS

SIGN POST LEGEND	
	WOOD POST LENGTH
	OFFSET FROM EDGE OF PAVEMENT

1. PAVEMENT MARKINGS SHALL BE IN ACCORDANCE WITH DISTRICT CADD DETAILS - STANDARD T80001.

REVISIONS	
NAME	DATE

ILLINOIS DEPARTMENT OF TRANSPORTATION  
**PAVEMENT MARKING AND SIGNING**  
**U.S. ROUTE 136 (RELOCATED)**  
**STA. 18+50.00 TO STA. 33+50.00**

DATE 3/30/06

DRAWN BY \_\_\_\_\_  
 CHECKED BY \_\_\_\_\_