

F.A.P.:	SECTION	COUNTY	TOTAL SHEETS	SHEET NO.
315	55-2	MCDONOUGH	1025	415
STA.		TO STA.		
FED. ROAD DIST. NO. 4		ILLINOIS FED. AID PROJECT		

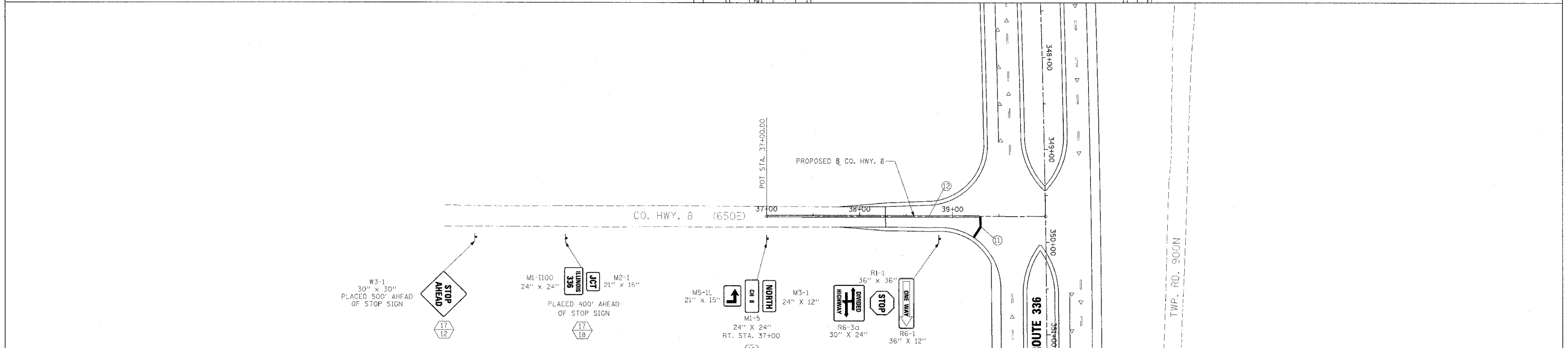
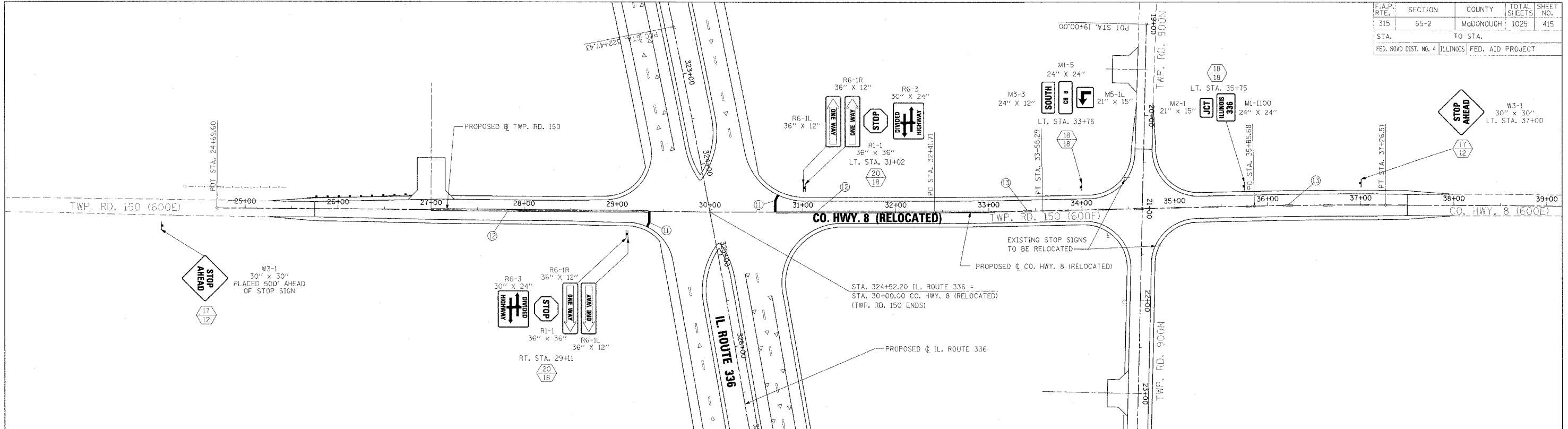

PAVEMENT MARKING LEGEND

① EPOXY PAVEMENT MARKING - LINE 24" WHITE SOLID (STOP BAR)

② PAINT PAVEMENT MARKING - LINE 4" YELLOW SOLID (DOUBLE LINE)

③ PAINT PAVEMENT MARKING - LINE 4" YELLOW SKIP DASH

1. PAVEMENT MARKINGS SHALL BE IN ACCORDANCE WITH DISTRICT CADD DETAILS - STANDARD 780001.

RAISED REFLECTIVE PAVEMENT MARKERS (RRPM) LEGEND

① ▲ ONE-WAY CRYSTAL MARKER AT 80' CENTERS

② ▲ ONE-WAY CRYSTAL MARKER AT 40' CENTERS

③ ▲ ONE-WAY CRYSTAL MARKER AT 20' CENTERS

④ ▲ ONE-WAY AMBER MARKER AT 40' CENTERS

⑤ ▲ ONE-WAY AMBER MARKER AT 20' CENTERS

⑥ ◆ TWO-WAY AMBER MARKER AT 40' CENTERS

SIGN POST LEGEND

WOOD POST LENGTH

OFFSET FROM EDGE OF PAVEMENT

ILLINOIS DEPARTMENT OF TRANSPORTATION

PAVEMENT MARKING AND SIGNING

TWP. RD. 150 /CO. HWY. 8 (RELOCATED)

AND

CO. HWY. 8 (EAST)

DATE 3/30/06

DRAWN BY

CHECKED BY

REVISIONS	
NAME	DATE

SCALE IN FEET