

F.A.P. RTE.	SECTION	COUNTY	TOTAL SHEETS	SHEET NO.
315	55-2	McDONOUGH	1025	426
STA. 139+00		TO STA. 151+00		
FED. ROAD DIST. NO. 4 ILLINOIS FED. AID PROJECT				

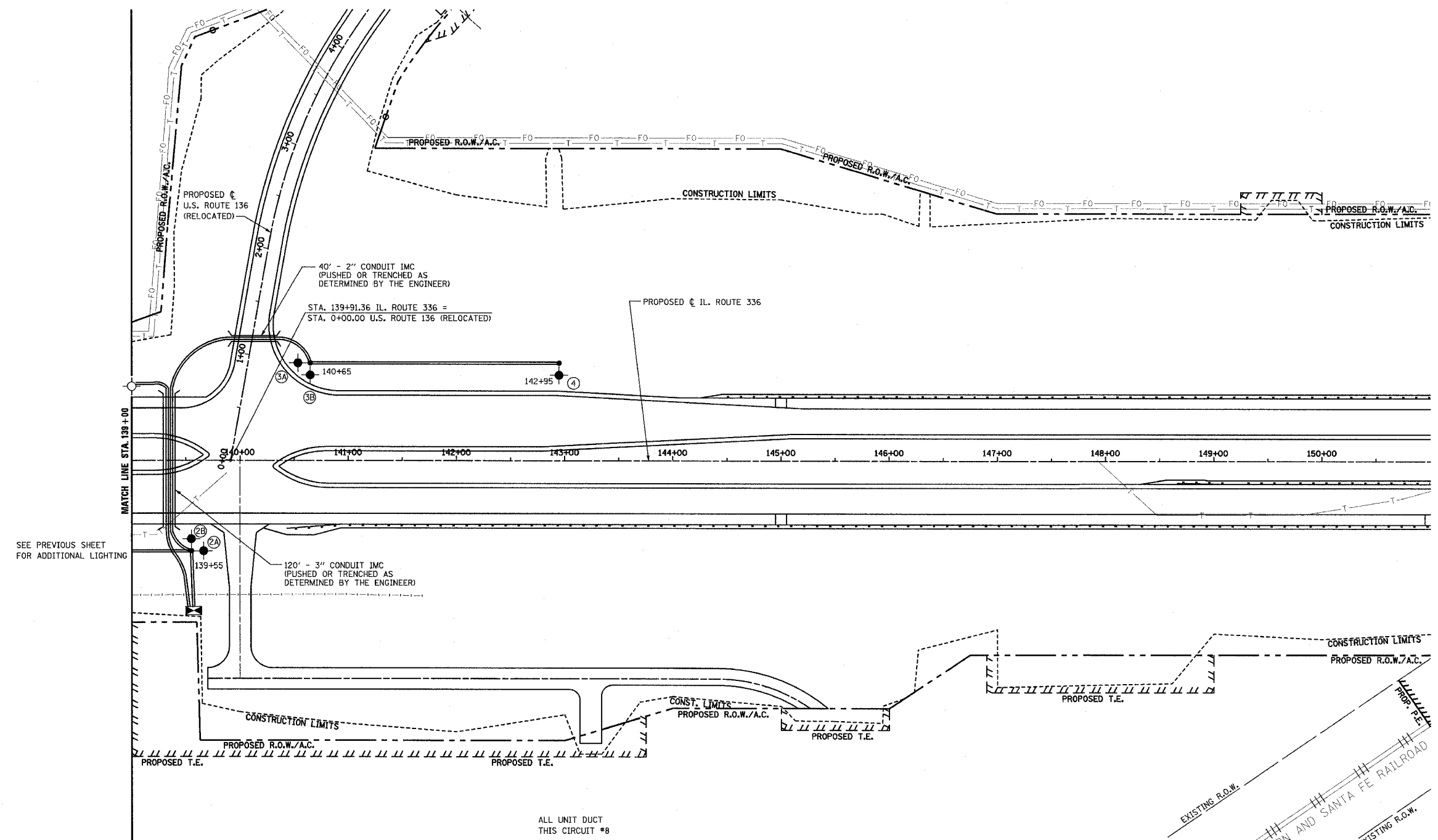

SEE PREVIOUS SHEET FOR ADDITIONAL LIGHTING

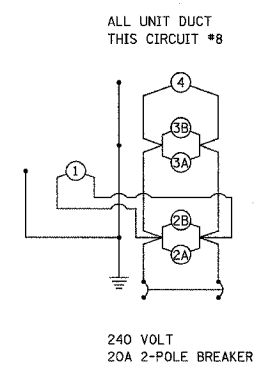

LEGEND

- WOOD LIGHTING POLE 55', CLASS 3 W/250 WATT HPS MULTI-MOUNT LUMINAIRE
- LIGHT POLE, STEEL GALVANIZED, 45' M.H., TENON MOUNT, W/250W HPS MULTI-MOUNT LUMINAIRE ON 6'x8\"/>

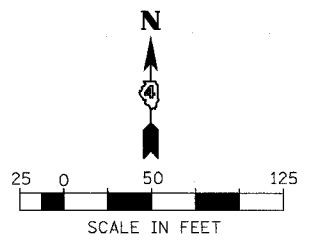
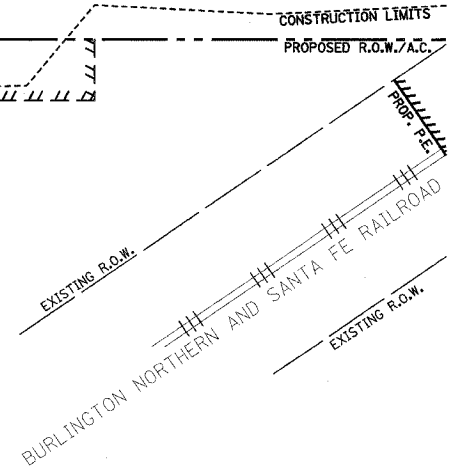

REVISIONS	
NAME	DATE

ILLINOIS DEPARTMENT OF TRANSPORTATION
LIGHTING PLAN
IL. ROUTE 336
STA. 139+00 TO STA. 150+00

DATE 3/30/06

DRAWN BY
CHECKED BY