

STATE OF ILLINOIS
DEPARTMENT OF TRANSPORTATION

ROUTE NO.	SECTION	COUNTY	JOB NO.	SHEET NO.	SHEET NO. 11
FAP 315	55-2	McDONOUGH	1025	546	16 SHEETS
FED. ROAD DIST. NO. 7	ILLINOIS	FED. AID PROJECT	Contract #68205		

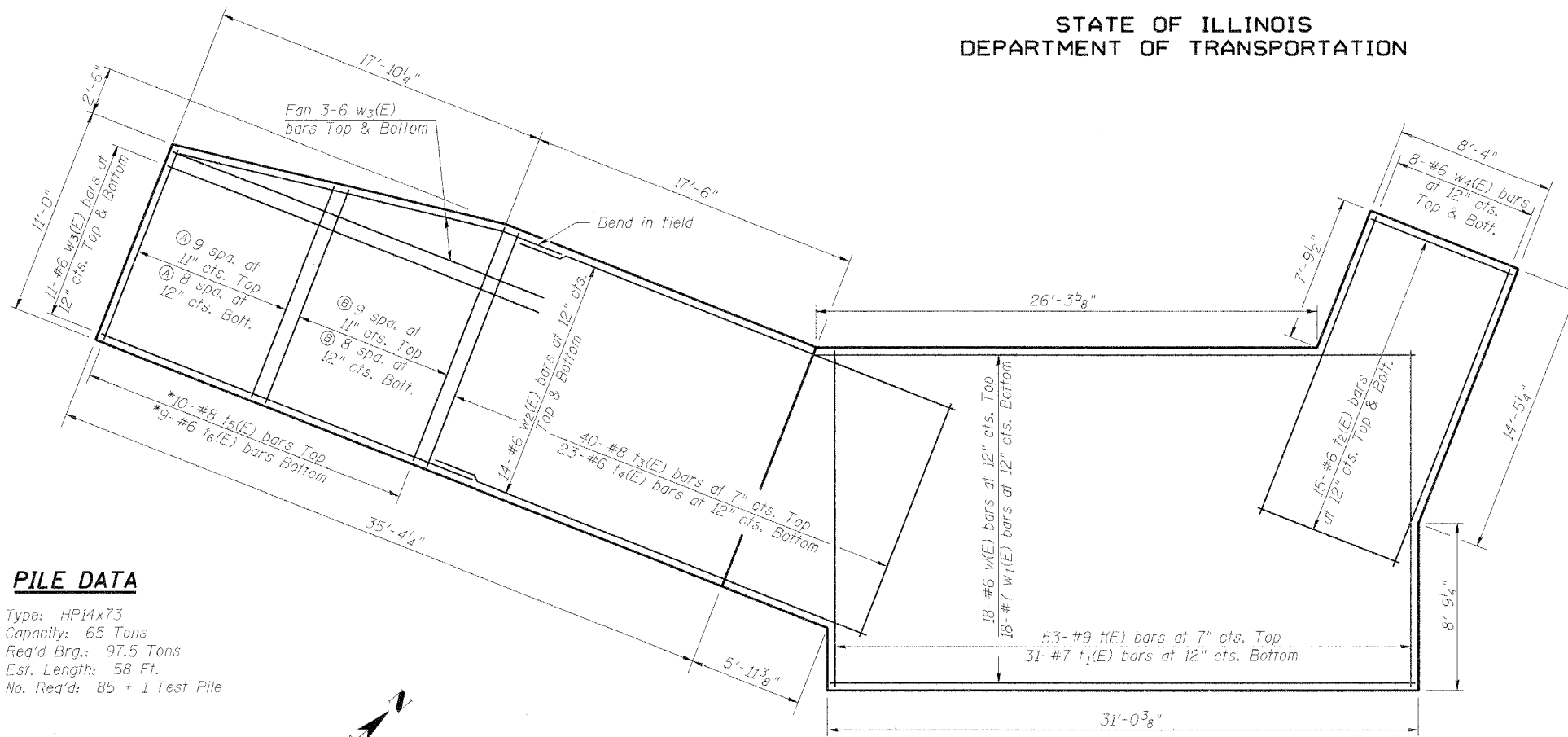

WEST ABUTMENT FOOTING PLAN
(Showing Reinforcement)

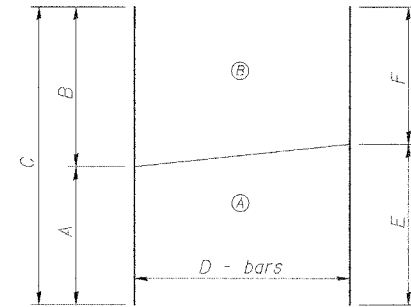

FIELD CUTTING DIAGRAM

* Cut 1/2(E) and 1/6(E) bars in field as shown. Place patterns A and B side by side as shown on plans.

Bar	A	B	C	D	E	F
1/2(E)	10'-9"	13'-3"	24'-0"	10	11'-11"	12'-1"
1/6(E)	10'-9"	13'-3"	24'-0"	9	11'-11"	12'-1"

PILE DATA

Type: HP14x73
Capacity: 65 Tons
Req'd Brg.: 97.5 Tons
Est. Length: 58 Ft.
No. Req'd: 85 + 1 Test Pile

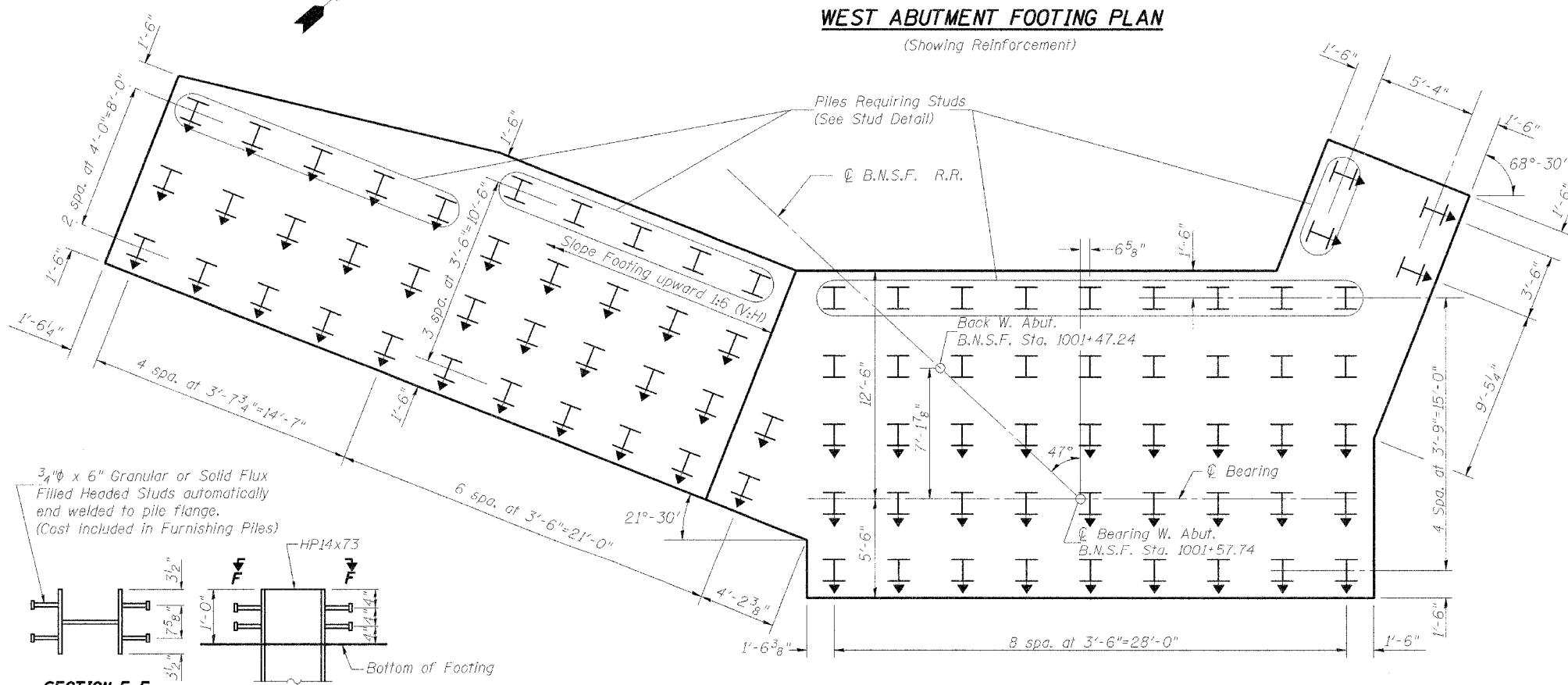

WEST ABUTMENT FOOTING PLAN
(Showing Piles)

MIN. BAR LAP

#6 Bars = 2'-7"

NOTES

1. Space bottom footing reinforcement to miss piles.
2. Reinforcement designated (E) shall be epoxy coated.
3. See Sheet 14 of 16 for Bill of Material.
4. Work this sheet with Sheet 9 of 16.

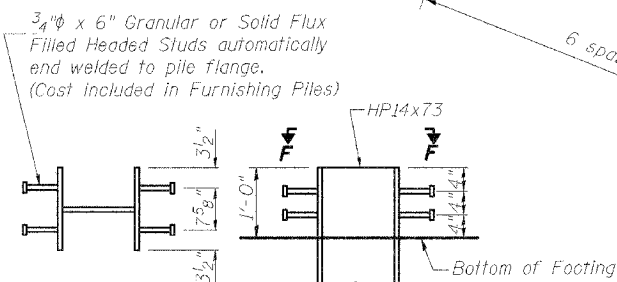

SECTION F-F
STUD DETAIL

LIN ENGINEERING, LTD.
20 W. Chestnut
Chatham, Illinois 62629
1075 451-4888 FAX 1075 463-1106
Designed By: DLS Checked By: MTK Drawn By: JML
Date: 02/05 File: 0559903.DWG

REVISIONS	
NAME	DATE

ILLINOIS DEPARTMENT OF TRANSPORTATION
WEST ABUTMENT FOOTING
BURLINGTON NORTHERN
SANTA FE RAILROAD OVER RAMP J
F.A.P. ROUTE 315 SECT. 55-2
McDONOUGH COUNTY
STATION 162+14.00
STRUCTURE NO. 055-9903
B.N.S.F. LINE SEGMENT 0011
B.N.S.F. BRIDGE NO. 206.00