

F.A.P. RTEL.	SECTION	COUNTY	TOTAL SHEETS	SHEET NO.
315	55-2	McDONOUGH	1025	562
STA.		TO STA.		
FED. ROAD DIST. NO. 4 ILLINOIS		FED. AID PROJECT		

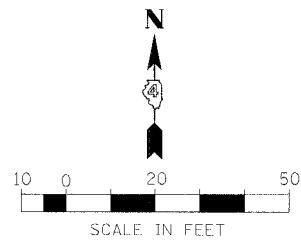
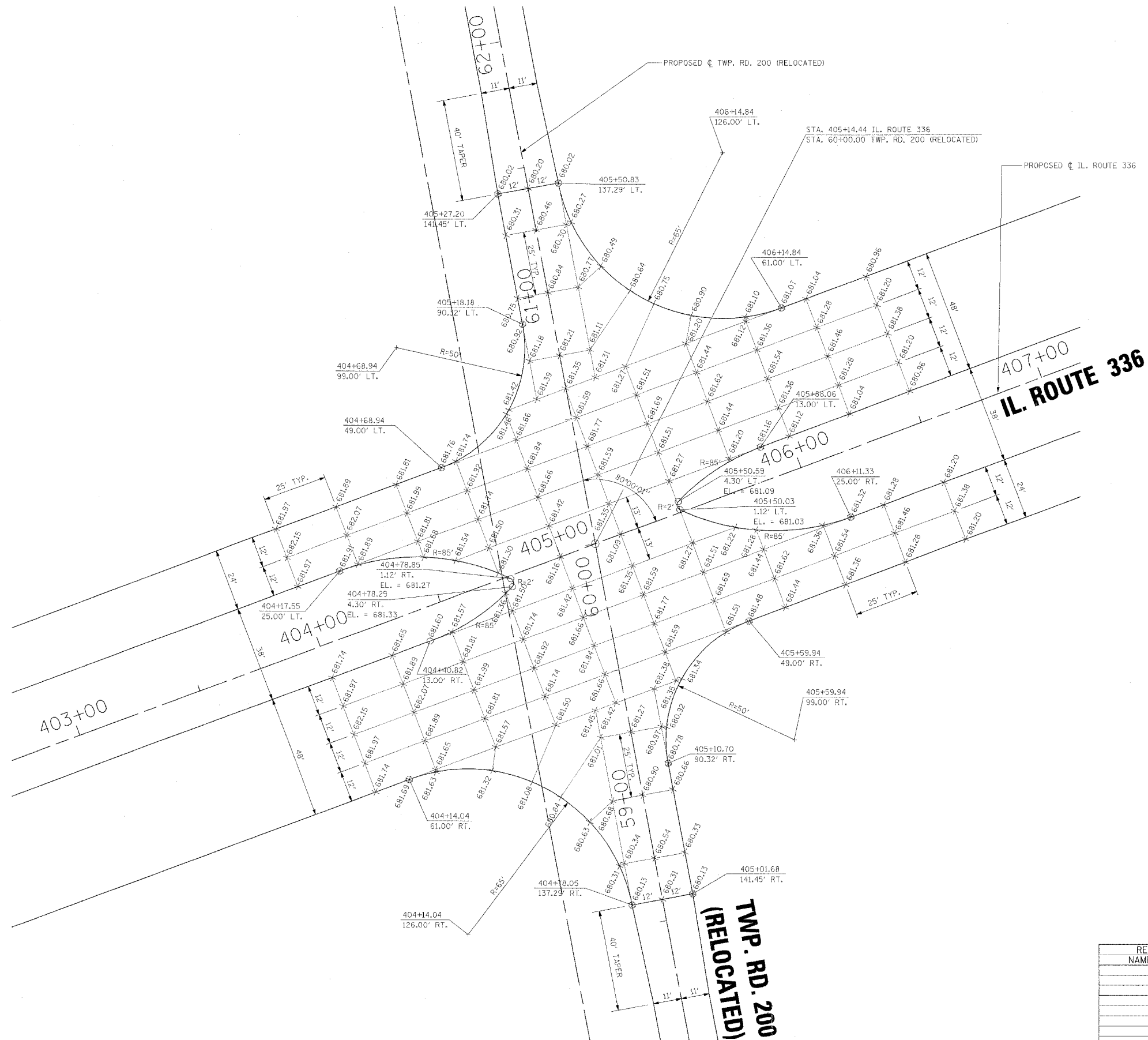

REVISIONS	
NAME	DATE

ILLINOIS DEPARTMENT OF TRANSPORTATION

**INTERSECTION DETAILS  
IL. ROUTE 336 WITH  
TWP. RD. 200 (RELOCATED)**

DATE 3/30/06  
DRAWN BY  
CHECKED BY