

F.A.P. R.T.E.	SECTION	COUNTY	TOTAL SHEETS	SHEET NO.
315	55-2	McDONOUGH	1025	563
STA.		TO STA.		
FED. ROAD DIST. NO. 4 ILLINOIS		FED. AID PROJECT		

PROPOSED CURVE 336-8 DATA
P.I. STA. = 451+74.90
 $\Delta = 34^\circ 14' 13.54''$ (LT)
R = 4,250'
T = 1,308.98'
L = 2,539.59'
E = 197.01'
S.E. = 4.20%
TRANSITION IN = 437+02 TO 439+27
TRANSITION OUT = 463+45 TO 465+68
P.C. STA. = 438+65.92
P.T. STA. = 464+05.51

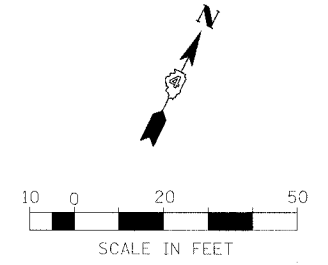
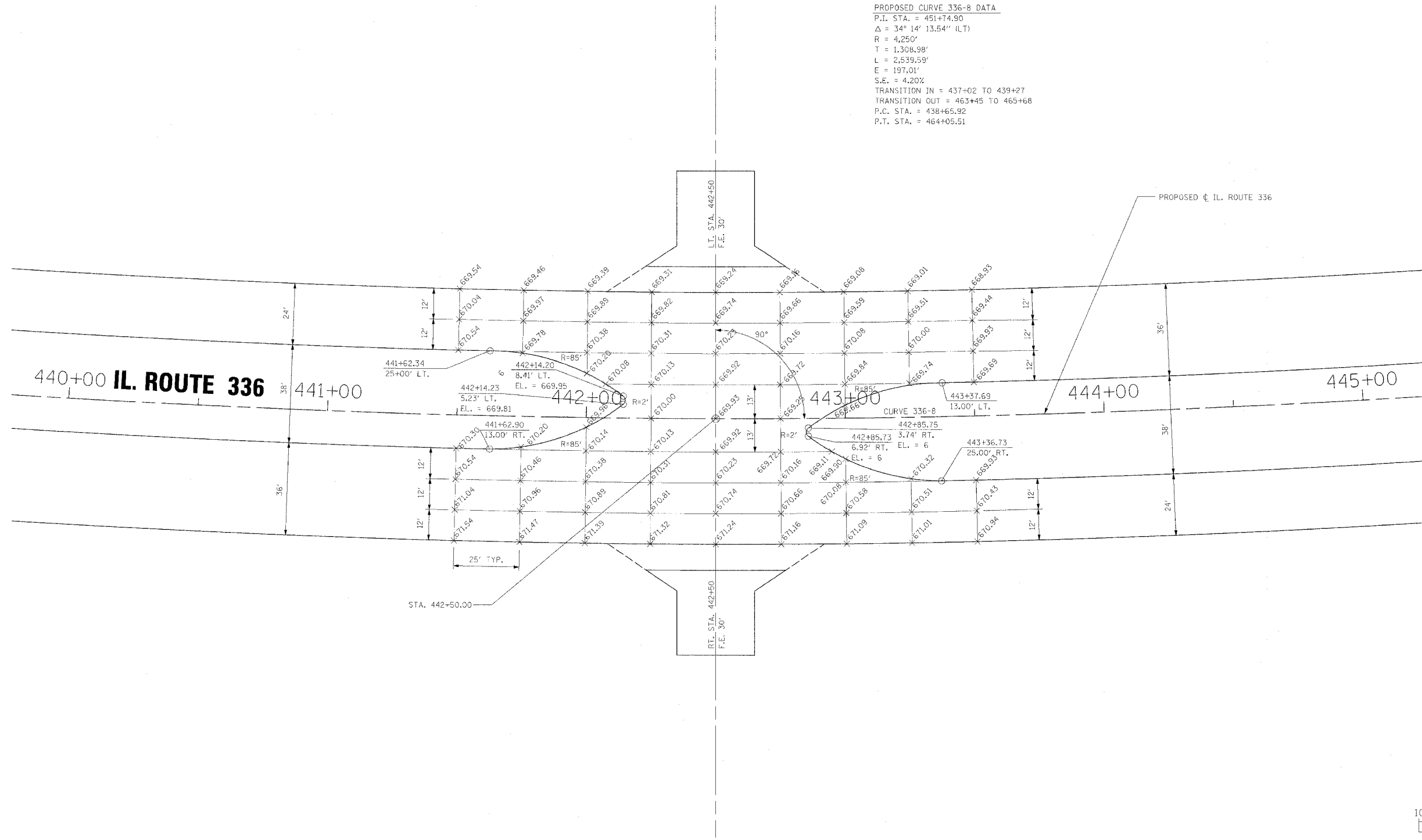

REVISIONS	
NAME	DATE

ILLINOIS DEPARTMENT OF TRANSPORTATION
INTERSECTION DETAILS
IL. ROUTE 336 WITH
F.E.'S AT STA. 442 + 50
DATE 3/30/06
DRAWN BY
CHECKED BY