

F.A.P. RTE.	SECTION	COUNTY	TOTAL SHEETS	SHEET NO.
315	55-2	McDONOUGH	1025	586
STA.		TO STA.		
FED. ROAD DIST. NO. 4 ILLINOIS		FED. AID PROJECT		

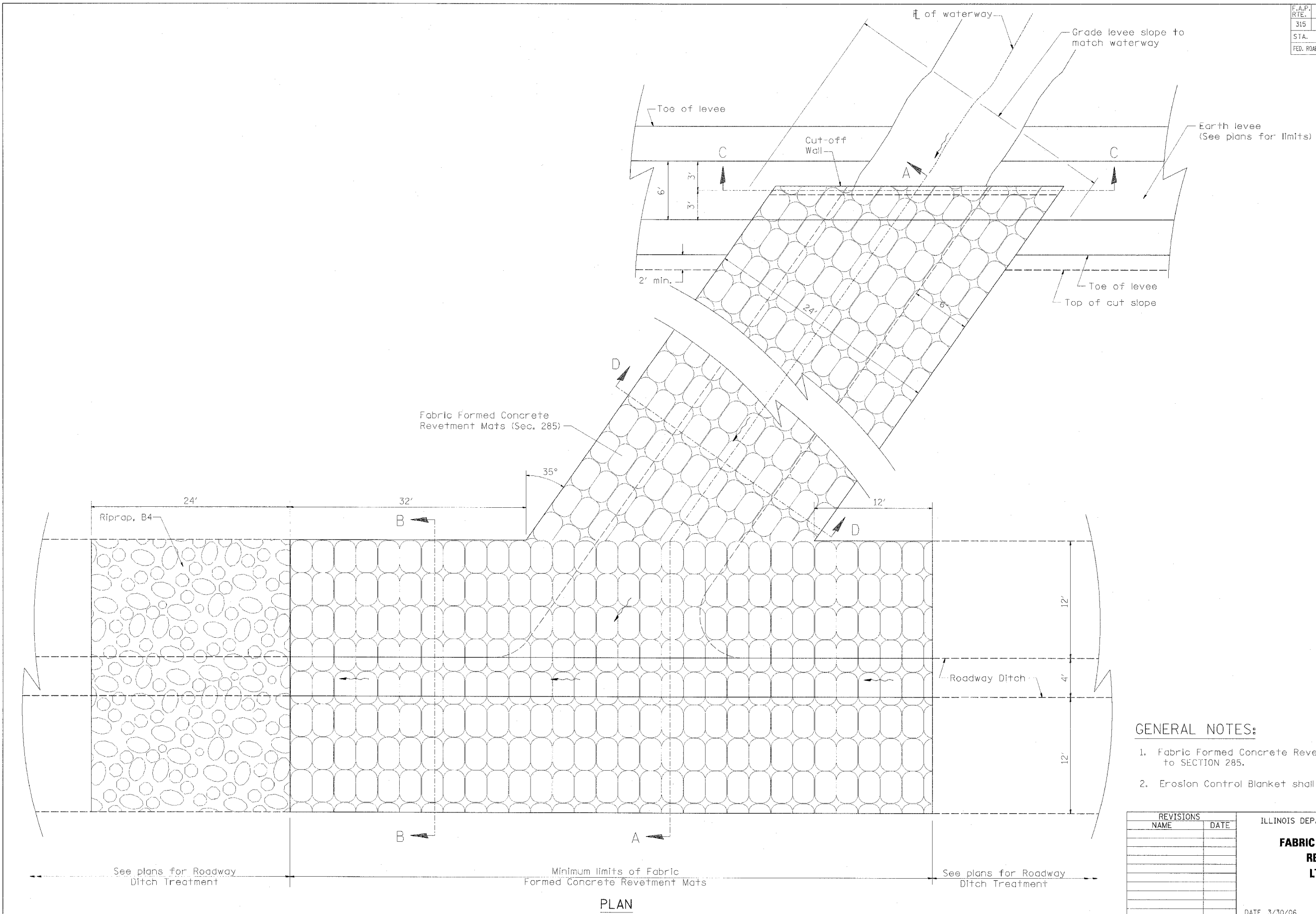

GENERAL NOTES:

1. Fabric Formed Concrete Revetment Mats shall conform to SECTION 285.
2. Erosion Control Blanket shall conform to Article 251.04.

REVISIONS	
NAME	DATE

ILLINOIS DEPARTMENT OF TRANSPORTATION
**FABRIC FORMED CONCRETE
 REVETMENT MAT**
LT. STA. 330 + 50
 1 of 3
 DATE 3/30/06
 DRAWN BY
 CHECKED BY

PLAN