

APPROVED
 DRAWN BY RB
 CHECKED BY RB
 RANDOLPH ASSOCIATES, INC.
 136.115
 February 2004
 CONSULTING ENGINEERS & LAND SURVEYORS

UNLESS ELEVATIONS ARE SHOWN ---
 ALL UTILITY LOCATIONS SHOWN ON THE CROSS SECTIONS
 ARE BASED ON THE APPROXIMATE DEPTH SUPPLIED BY
 THE UTILITY COMPANY

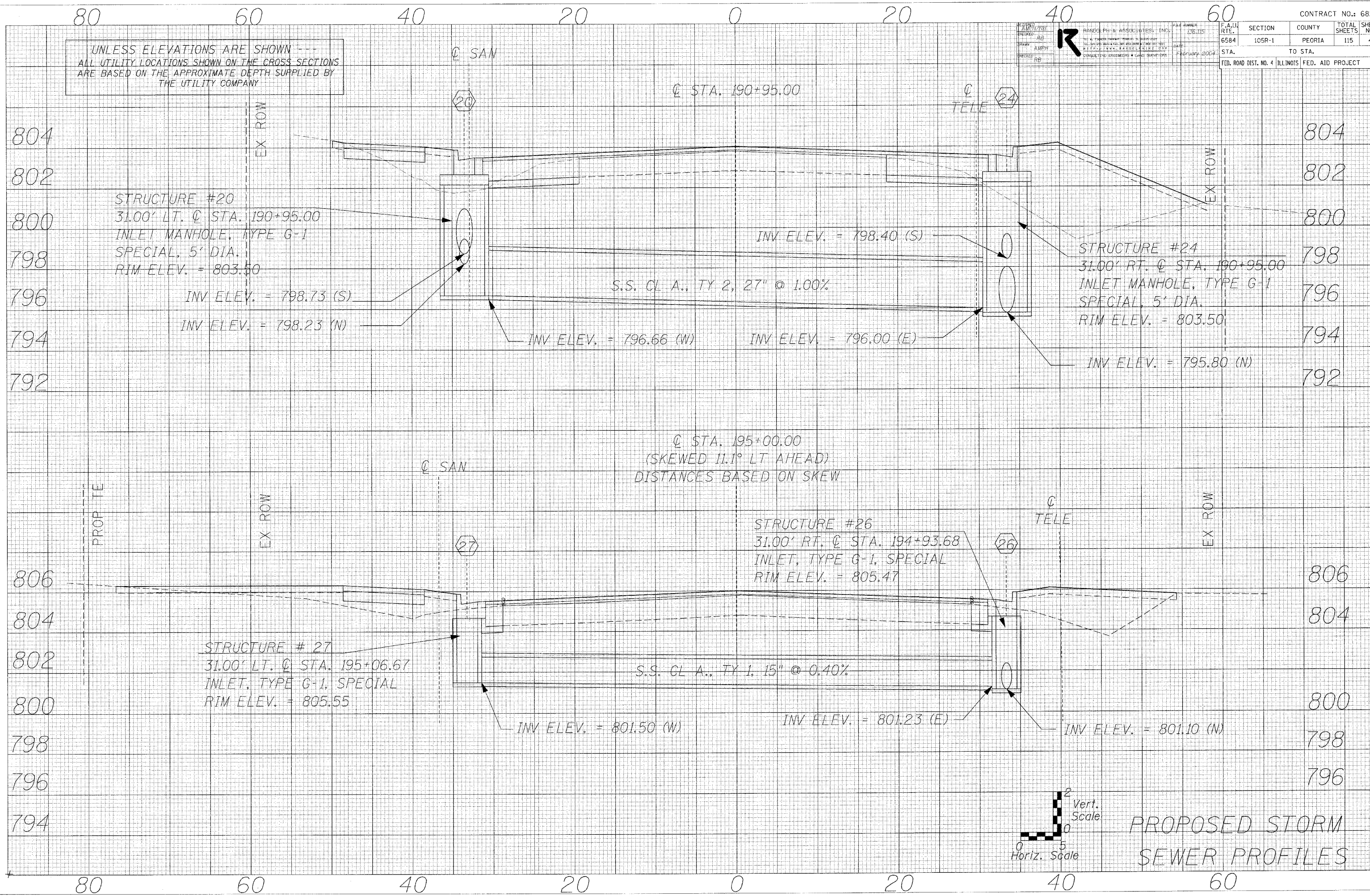

STRUCTURE #20
 31.00' LT. @ STA. 190+95.00
 INLET MANHOLE, TYPE G-1
 SPECIAL, 5' DIA.
 RIM ELEV. = 803.50

STRUCTURE #24
 31.00' RT. @ STA. 190+95.00
 INLET MANHOLE, TYPE G-1
 SPECIAL, 5' DIA.
 RIM ELEV. = 803.50

INV ELEV. = 798.73 (S)
 INV ELEV. = 798.23 (N)

S.S. CL. A., TY 2, 27" @ 1.00%

@ STA. 195+00.00
 (SKEWED 11.1° LT AHEAD)
 DISTANCES BASED ON SKEW

STRUCTURE #27
 31.00' LT. @ STA. 195+06.67
 INLET, TYPE G-1, SPECIAL
 RIM ELEV. = 805.55

STRUCTURE #26
 31.00' RT. @ STA. 194+93.68
 INLET, TYPE G-1, SPECIAL
 RIM ELEV. = 805.47

S.S. CL. A., TY 1, 15" @ 0.40%

INV ELEV. = 801.50 (W)

INV ELEV. = 801.23 (E)

INV ELEV. = 801.10 (N)

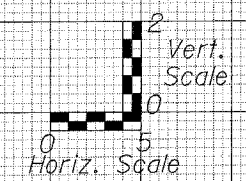

PROPOSED STORM
 SEWER PROFILES

DATE
 BY
 SUPERVISOR
 CHECKED
 ORIGINAL SURVEY
 NOTE BOOK
 NO.

DATE
 BY
 SUPERVISOR
 CHECKED
 ORIGINAL SURVEY
 NOTE BOOK
 NO.