

80 60 40 20 0 20 40 60

UNLESS ELEVATIONS ARE SHOWN
ALL UTILITY LOCATIONS SHOWN ON THE CROSS SECTIONS
ARE BASED ON THE APPROXIMATE DEPTH SUPPLIED BY
THE UTILITY COMPANY

FAU 6584
(ALLEN ROAD)

DESIGNED BY: [Signature]
 CHECKED BY: [Signature]
 DRAWN BY: [Signature]
 PROJECT: [Signature]

RANDOLPH & ASSOCIATES, INC.
 1101 W. BROADWAY, SUITE 100, PEORIA, ILLINOIS 61604
 TEL: (312) 686-1100 FAX: (312) 686-1101
 WWW.RANDOLPH-INC.COM
 CONSULTING ENGINEERS & LAND SURVEYORS

P&E NUMBER: 136215
 DATE: February 2002

F.A.U. RTE.	SECTION	COUNTY	TOTAL SHEETS	SHEET NO.
6584	105R-1	PEORIA	115	73
STA.		TO STA.		
FED. ROAD DIST. NO. 4		ILLINOIS		FED. AID PROJECT

DATE	BY	REVISION

DATE	BY	REVISION

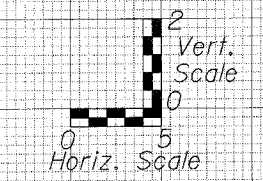
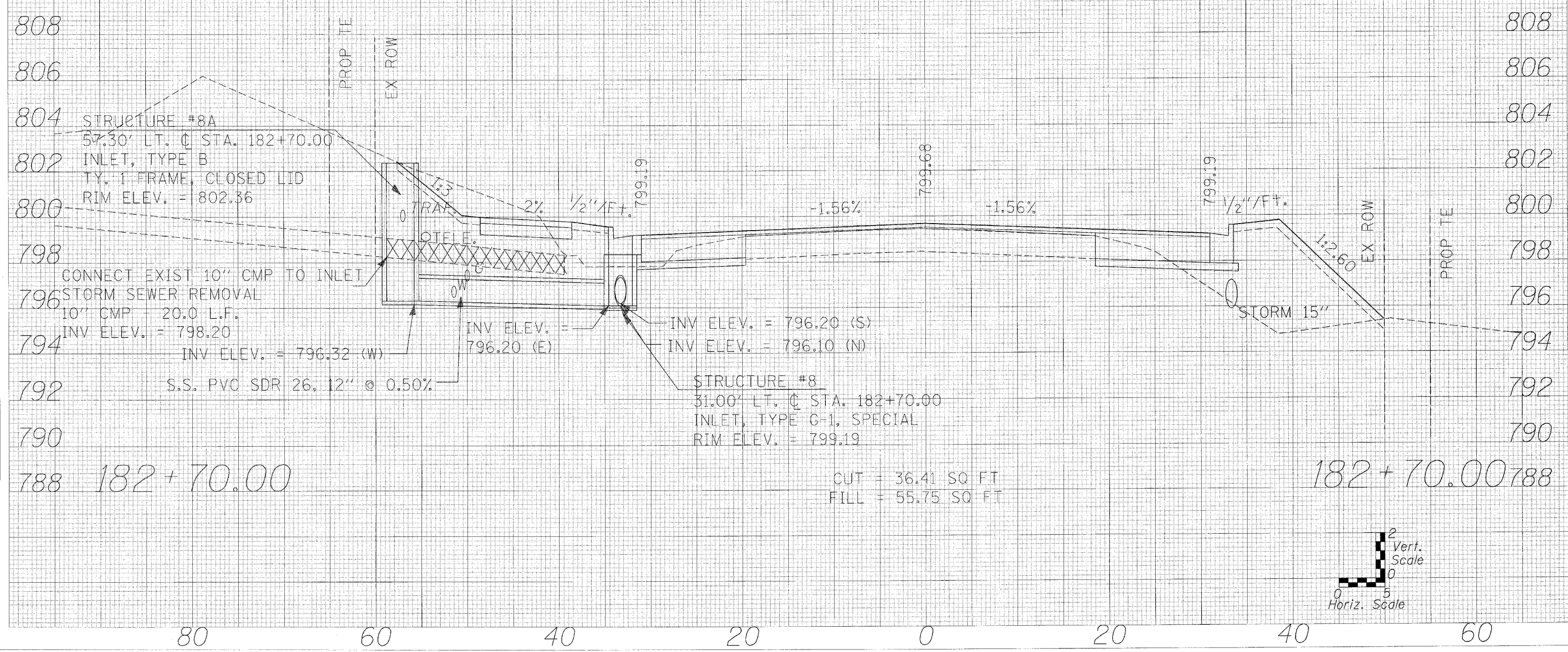

80 60 40 20 0 20 40 60