

80

60

40

20

0

20

40

60

UNLESS ELEVATIONS ARE SHOWN ---
ALL UTILITY LOCATIONS SHOWN ON THE CROSS SECTIONS
ARE BASED ON THE APPROXIMATE DEPTH SUPPLIED BY
THE UTILITY COMPANY.

FAU 6584
(ALLEN ROAD)

DESIGNED BY: AMH/TRE
CHECKED BY: FHS
DRAWN BY: AMPH
CHECKED BY: HSB

MANICLPH & ASSOCIATES, INC.
136315
CONSULTING ENGINEERS • LAND SURVEYORS
February 2009

F.A.U. RTE.	SECTION	COUNTY	TOTAL SHEETS	SHEET NO.
6584	105R-1	PEORIA	115	77

STA. TO STA.
FED. ROAD DIST. NO. 4 ILLINOIS FED. AID PROJECT

DATE	BY

FINAL SURVEY NOTE BOOK NO. 2195 CHECKED

DATE	BY

ORIGINAL SURVEY NOTE BOOK NO. AREAS CHECKED

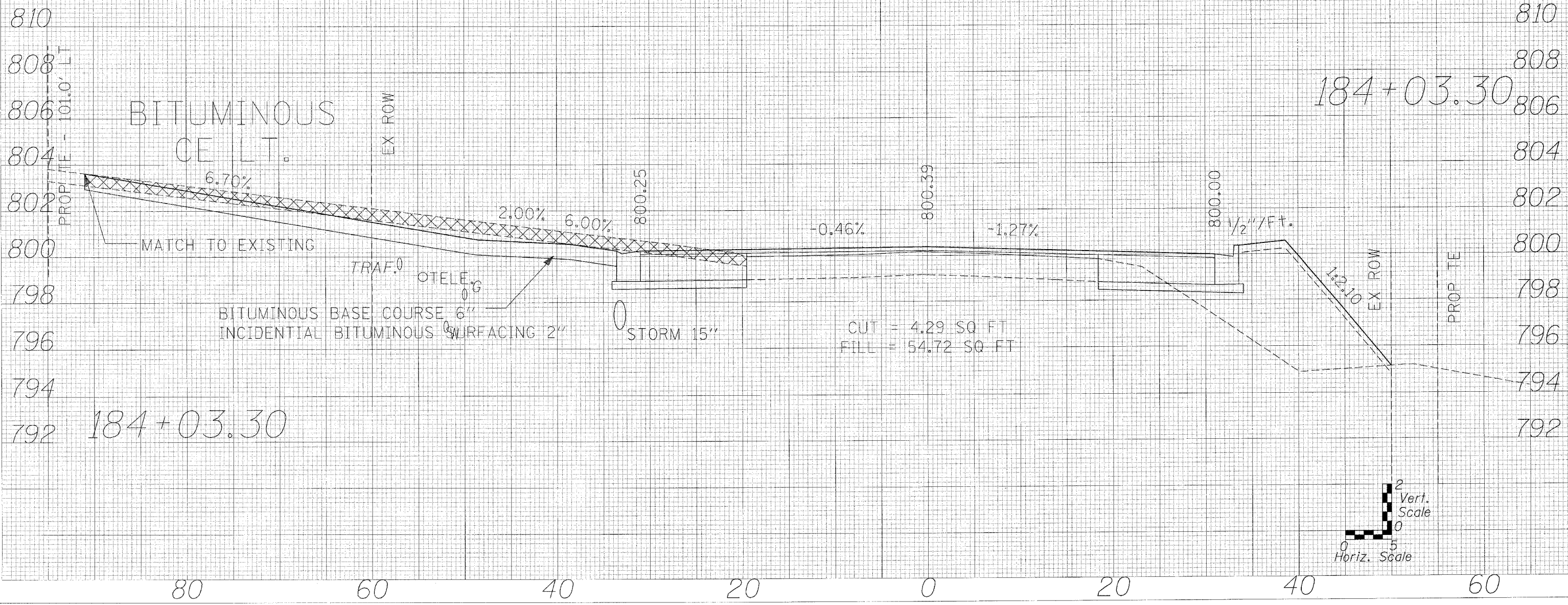

184+03.30

184+03.30

