

80

60

40

20

0

20

40

60

UNLESS ELEVATIONS ARE SHOWN
ALL UTILITY LOCATIONS SHOWN ON THE CROSS SECTIONS
ARE BASED ON THE APPROXIMATE DEPTH SUPPLIED BY
THE UTILITY COMPANY

E. FAU 6584
(ALLEN ROAD)

DESIGNED BY CHECKED BY FRANK AMPH CHECKED BY	REGISTERED PROFESSIONAL ENGINEER NO. 136225 ILLINOIS	DATE February 2004	F.A.I.D. RTE. 6584	SECTION 105R-1	COUNTY PEORIA	TOTAL SHEETS 115	SHEET NO. 87
STA.			TO STA.		FED. ROAD DIST. NO. 4 ILLINOIS FED. AID PROJECT		

DATE	BY
DATE	BY
DATE	BY

DATE	BY
DATE	BY
DATE	BY

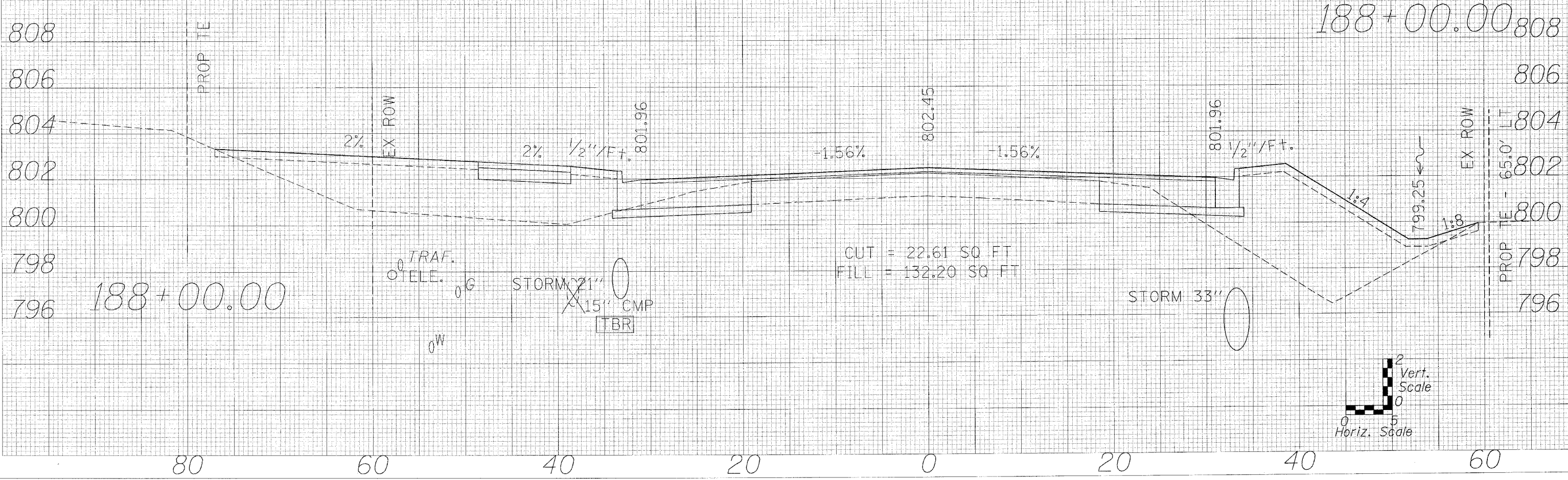

CUT = 22.61 SQ FT
FILL = 132.20 SQ FT

