

60 40 20 0 20 40 60 80

|                  |                        |                     |                      |                  |   |                 |
|------------------|------------------------|---------------------|----------------------|------------------|---|-----------------|
| DESIGNED BY<br>R | PROJECT NO.<br>138-215 | F.A.U. RTE.<br>6584 | SECTION<br>105R-1    | COUNTY<br>PEORIA | TOTAL SHEETS<br>115                             | SHEET NO.<br>88 |
| CHECKED BY<br>RB | DATE<br>February 2009  | STA.<br>188+66.47   | TO STA.<br>188+50.00 |                  | FED. ROAD DIST. NO. 4 ILLINOIS FED. AID PROJECT |                 |

UNLESS ELEVATIONS ARE SHOWN  
ALL UTILITY LOCATIONS SHOWN ON THE CROSS SECTIONS  
ARE BASED ON THE APPROXIMATE DEPTH SUPPLIED BY  
THE UTILITY COMPANY.

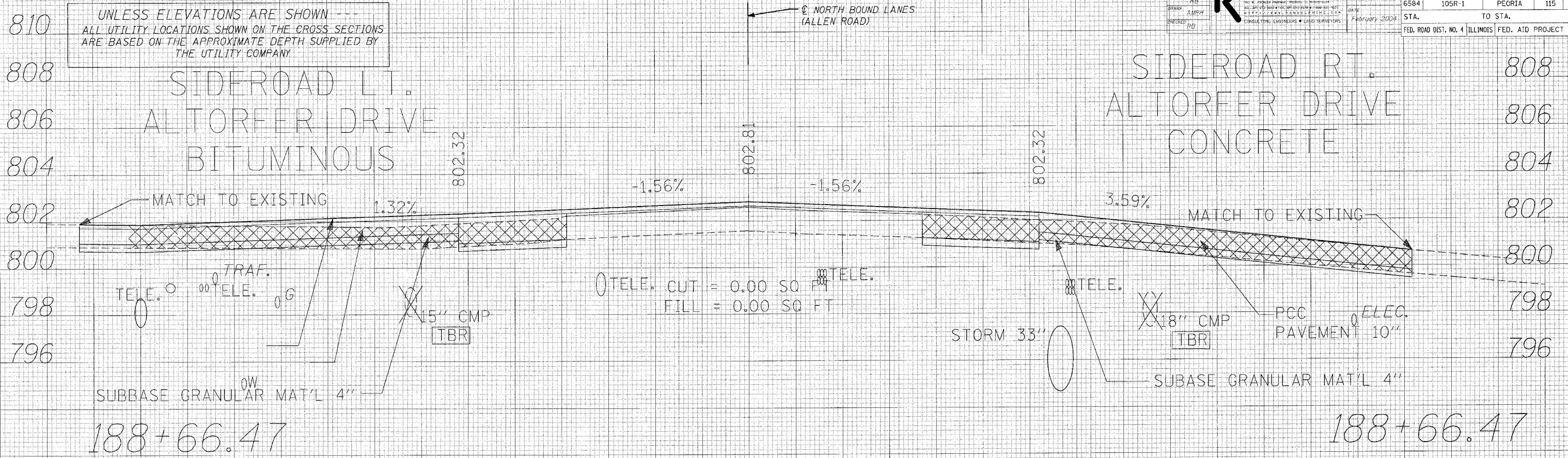

188+66.47

188+66.47

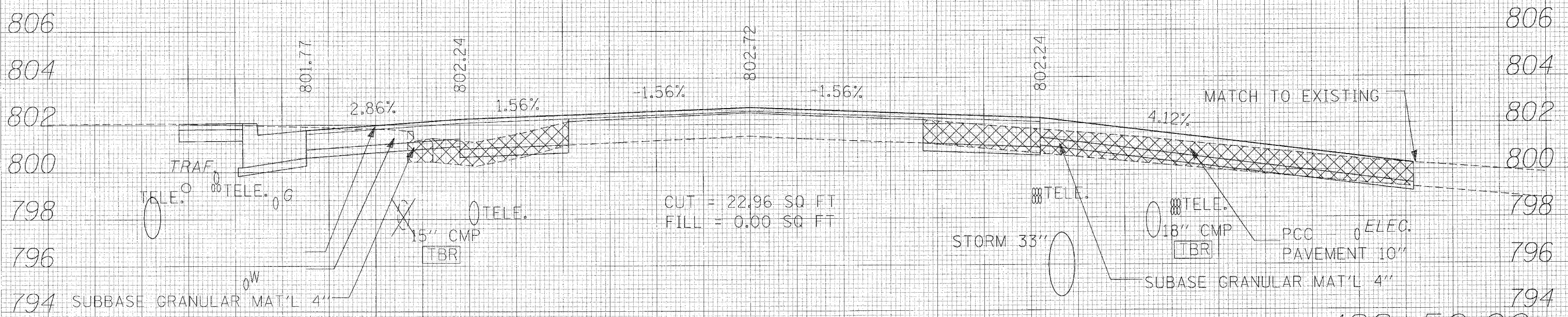

188+50.00

188+50.00

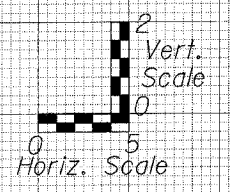

60 40 20 0 20 40 60 80

|        |  |
|--------|--|
| DATE   |  |
| BY     |  |
| NO. 1  |  |
| NO. 2  |  |
| NO. 3  |  |
| NO. 4  |  |
| NO. 5  |  |
| NO. 6  |  |
| NO. 7  |  |
| NO. 8  |  |
| NO. 9  |  |
| NO. 10 |  |

|        |  |
|--------|--|
| DATE   |  |
| BY     |  |
| NO. 1  |  |
| NO. 2  |  |
| NO. 3  |  |
| NO. 4  |  |
| NO. 5  |  |
| NO. 6  |  |
| NO. 7  |  |
| NO. 8  |  |
| NO. 9  |  |
| NO. 10 |  |

DATE